

STATE OF ILLINOIS  
DEPARTMENT OF TRANSPORTATION

NOTES:

1. Work this sheet with sheets 40 & 113 through 132.
2. Structural steel for beams, girders, splice plates, and connection plates shall conform to the requirements of AASHTO M270 GR 50. All other steel shall conform to the requirements of AASHTO M270 GR 36.
3. F.S. denotes field splice.
4. FB denotes floor beam.
5. F.P. denotes framing point.

ANGLE "A"

Girder	Angle "A"
Carrier Girder	35°34'48"
FB-4.1	59°3'0"
FB-4.2	60°25'24"
FB-4.3	62°13'34"
FB-4.4	64°26'18"
FB-4.5	66°36'38"
FB-4.6	68°44'51"
FB-4.7	70°51'15"
FB-4.8	72°56'13"
Crosshead	74°34'53"
FB-4.9	76°37'21"
FB-4.10	78°38'47"
FB-4.11	80°39'21"
FB-4.12	82°39'15"
FB-4.13	84°38'36"
FB-4.14	86°29'38"

MEMBER SIZE

Girder	Size
G4.1-G4.7	54" I <sub>P</sub> Girder
G4.8	60" I <sub>P</sub> Girder
G4.9	W36x150
G4.10	W36x150
G4.10A	W36x150
G4.11	W36x231
G4.12	60" I <sub>P</sub> Girder
G4.13	W36x150
G4.14	W36x150
G4.15	W36x150
G4.16	W36x231
G4.17	W36x231
G4.18	W36x231
G4.19	54" I <sub>P</sub> Girder
G4.20	54" I <sub>P</sub> Girder
FB4.1-FB4.7	W36x231
FB4.8, FB4.9, FB4.12	54" I <sub>P</sub> Girder
FB4.10, FB4.11, FB4.13, FB4.14	W36x231

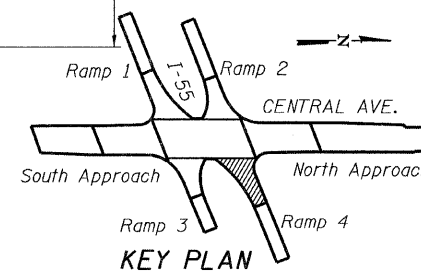

FRAMING PLAN  
RAMP 4 FLARE  
STRUCTURE NO. 016-0724

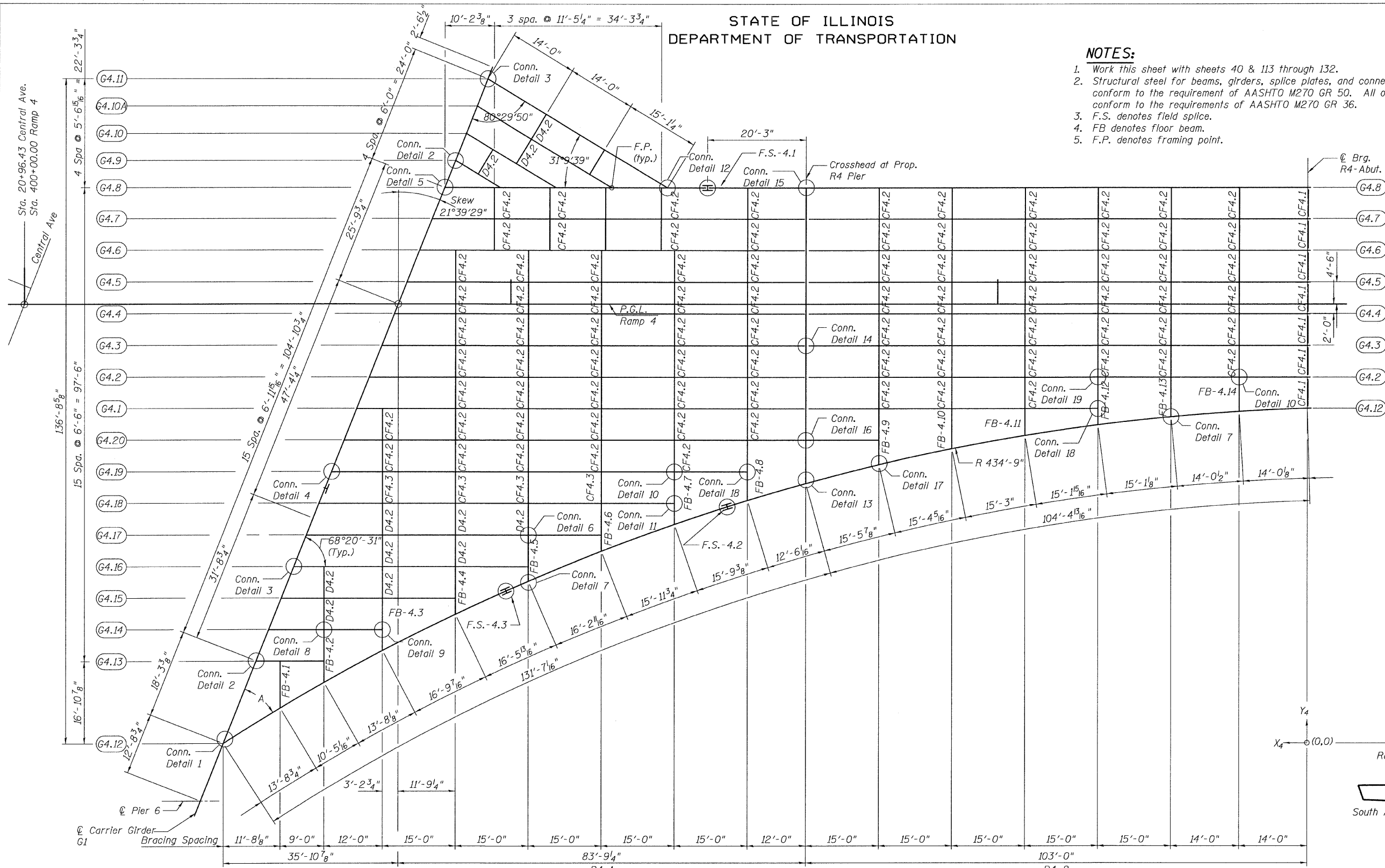

FRAMING PLAN - RAMP 4 FLARE

	Carrier Girder G1	F.S.-4.2	Crosshead	Brg. R4-Abut.
X <sub>4</sub>	222'-7 <sup>1</sup> / <sub>4</sub> "	119'-1 <sup>11</sup> / <sub>16</sub> "	102'-11 <sup>1</sup> / <sub>8</sub> "	0'-0"
Y <sub>4</sub>	0'-0"	48'-8 <sup>5</sup> / <sub>8</sub> "	53'-6 <sup>5</sup> / <sub>8</sub> "	68'-11 <sup>1</sup> / <sub>16</sub> "

BEARING SEAT ELEVATIONS

Girder Location	G4.8	G4.7	G4.6	G4.5	G4.4	G4.3	G4.2	G4.12
R4-Abut.	619.06	619.74	619.65	619.55	619.45	619.35	619.26	618.64

(For Information Only)

TYLIN INTERNATIONAL

DESIGNED	PK	REVISIONS	NAME	DATE
CHECKED	AMD,			
DRAWN	PK			
CHECKED	AMD,			
DATE	08/02/10			

SHEET NO. 44

137 SHEETS

F.A.I. RTE.	SECTION	COUNTY	TOTAL SHEETS	SHEET NO.
55	0711.2R & 1011.1BR	COOK	200	74
CONTRACT NO. 60L39				
FED. ROAD DIST. NO. 1 ILLINOIS FED. AID PROJECT				

8/13/2010