

STATE OF ILLINOIS
DEPARTMENT OF TRANSPORTATION

BORING LOCATIONS

No.	Station	*Offset
BR-6	4+994.3	39.9m R

* Offset from PGL NB Ramps

LEGEND

Boring Location

Sta. 18+76.41 Central Ave.
Sta. 200+00.00 NB Ramps

⊙ Exist. Pier 1
to be removed

⊙ Carrier Girder G1
Sta. 200+76.57
El. 627.60

VPI Sta. 201+80.00
Elevation 625.59

P.T. Sta. 202+40.00
El. 623.79

-1.98%
-3.00%

⊙ Central Ave.
Sta. 200+00.00
El. 628.52

P.C. Sta. 201+20.00
El. 626.78

VC = 120.0'

RAMP 3 PROFILE GRADE

SCOPE OF WORK

- Spans 3 and 4**
- Remove and replace the existing structure with Mechanically Stabilized Earth Retaining Walls.
- Spans 1 & 2 (New Spans R3-1 & R3-2)**
- Remove existing deck and Structural Steel.
 - Remove Piers 1 and 2.
 - Construct R3-Pier.
 - Construct new Superstructure

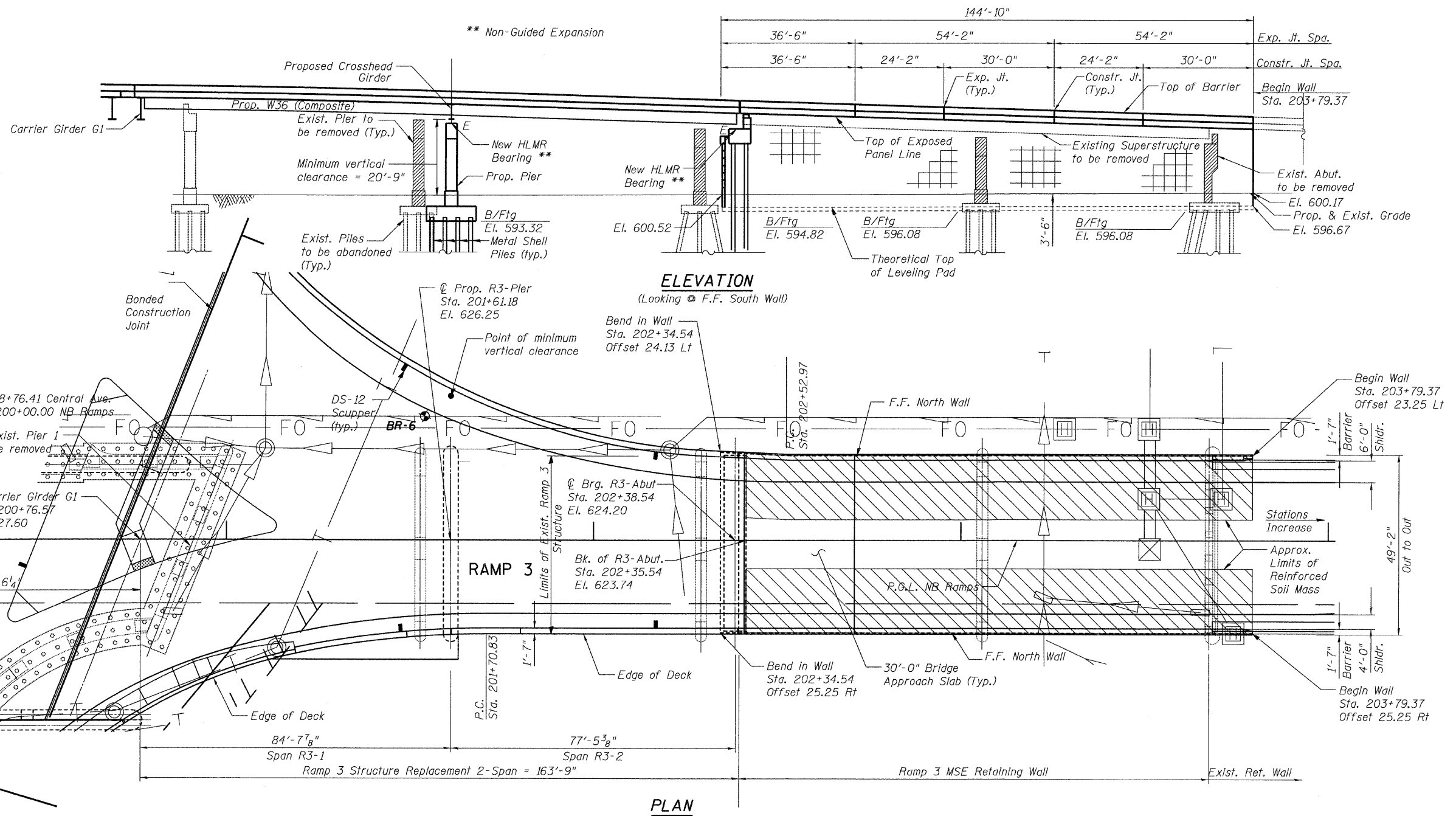

PLAN

Notes:

1. Wall stations and offsets are given to the front face of the precast concrete wall panels, and are measured from the NB Ramps Baseline

**GENERAL PLAN AND
ELEVATION - RAMP 3
STRUCTURE NO. 016-0724**

TYLIN INTERNATIONAL

DESIGNED	JMA	REVISIONS	
CHECKED	AMD,	NAME	DATE
DRAWN	JMA		
CHECKED	AMD,		
DATE	08/02/10		

SHEET NO. 6
137 SHEETS

F.A.I RTE.	SECTION	COUNTY	TOTAL SHEETS	SHEET NO.
55	0711.2R & 1011.1BR	COOK	200	36
FED. ROAD DIST. NO. 1 ILLINOIS FED. AID PROJECT			CONTRACT NO. 60L39	

p:\01345\beam and bearing fabrication\155-3ape.dgn 8/5/2010 6:00:33 PM