

STATE OF ILLINOIS
DEPARTMENT OF TRANSPORTATION

Central Ave.

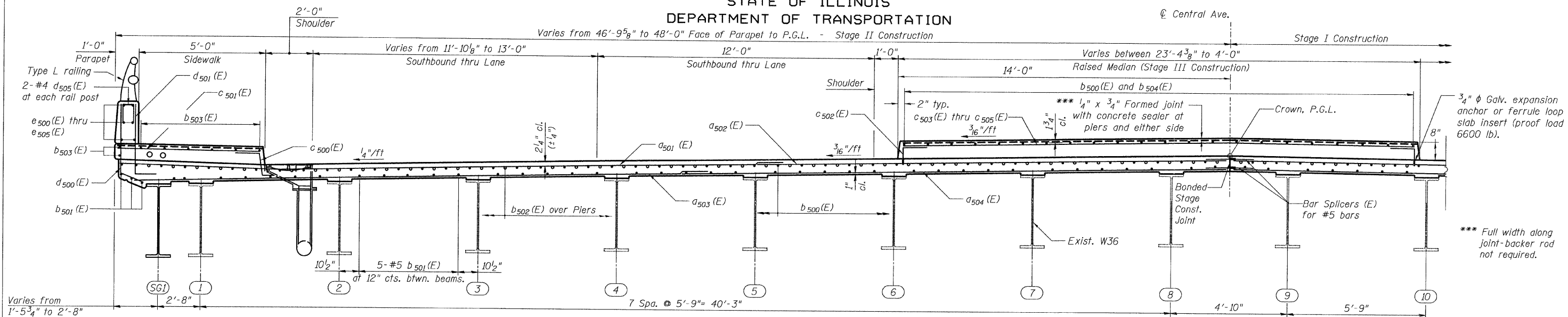

HALF SECTION C-C
(Looking North, Near Pier)

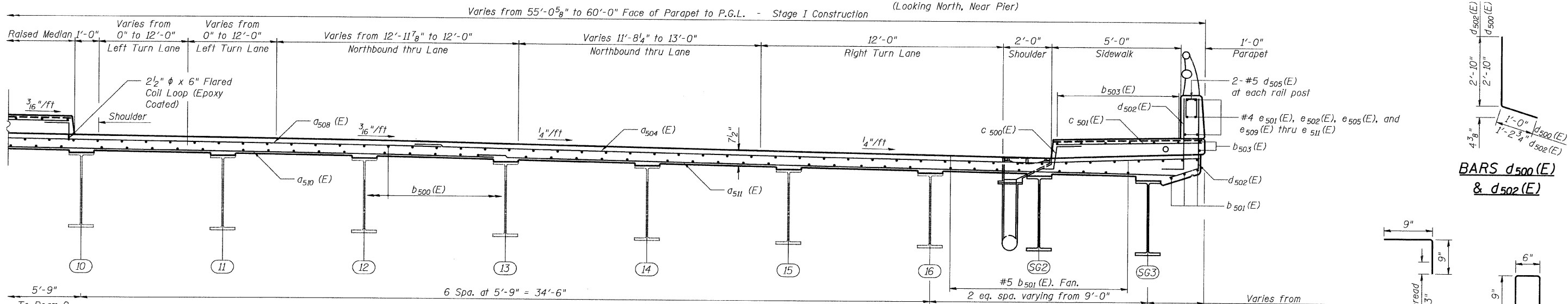

HALF SECTION C-C
(Looking North, Near Pier)

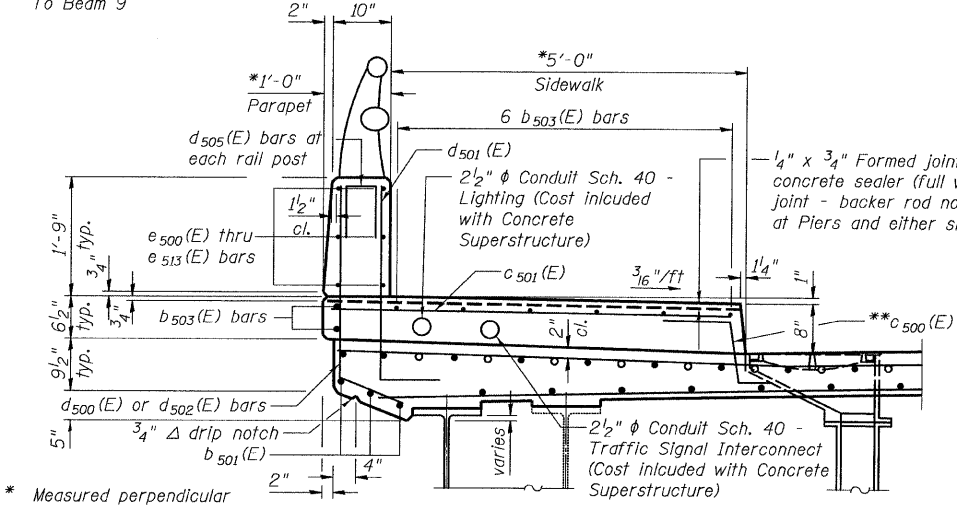

SECTION THRU SIDEWALK & PARAPET

** In lieu of bottom leg, c(E) bars may be cored and set according to Article 509.06 of the Standard Specifications. Cored holes shall be roughened or scored per manufacturer's recommendations. Maximum depth of cored hole shall not exceed 6".

THIS SHEET FOR INFORMATION ONLY

NOTES

- The cost of Epoxy Coated Flared Coil Loops/Expansion Anchors/ Inserts to be included with "Reinforcement Bars, Epoxy Coated."

SUPERSTRUCTURE CROSS SECTION - SPANS 1, 2, & 3
STRUCTURE NO. 016-3241

TYLIN INTERNATIONAL	DESIGNED - AMD, MI, DJR	REVISIONS		SHEET NO. 10	F.A.I. RTE.	SECTION	COUNTY	TOTAL SHEETS	SHEET NO.						
	CHECKED - AMD, TD, MAI	NAME	DATE							55	0711.2R & 1011.1BR	COOK	200	14	
	DRAWN - DJR, CBS									26 SHEETS					
	CHECKED - AMD														
	DATE - 08/02/10				CONTRACT NO. 60L39										
					FED. ROAD DIST. NO. 1 ILLINOIS FED. AID PROJECT										

8/2/2010