

STATE OF ILLINOIS
DEPARTMENT OF TRANSPORTATION

STAGE I REMOVAL

1. Install temporary concrete barrier as shown and divert traffic to the existing Southbound bridge.
2. Install temporary soil retention system and braced excavation at locations shown.
3. Remove Stage I limits of the existing concrete deck.
4. Remove Stage I limits of substructure units as shown on sheet.
5. Remove existing structural steel diaphragms at existing expansion joints.

STAGE I CONSTRUCTION

1. Construct widened portions of piers 1, 2, 4 and 5.
2. Reconstruct and widen the South Abutment, Pier 3 & C. Abutment 1, within the limits of Stage I.
3. Replace existing expansion bearings.
4. Paint existing structural steel beams and diaphragms, within the limits of Stage I.
5. Erect new structural steel beams and diaphragms.
6. Construct new bridge deck.

NOTES:

1. A cantilevered sheet piling design does not appear feasible and additional members or other retention systems may be necessary. The Contractor shall submit a temporary soil retention system design including plan details and calculations for review and acceptance by the Engineer.
2. The contractor shall coordinate the installation of the braced excavation piling with IC/CN Railroad.

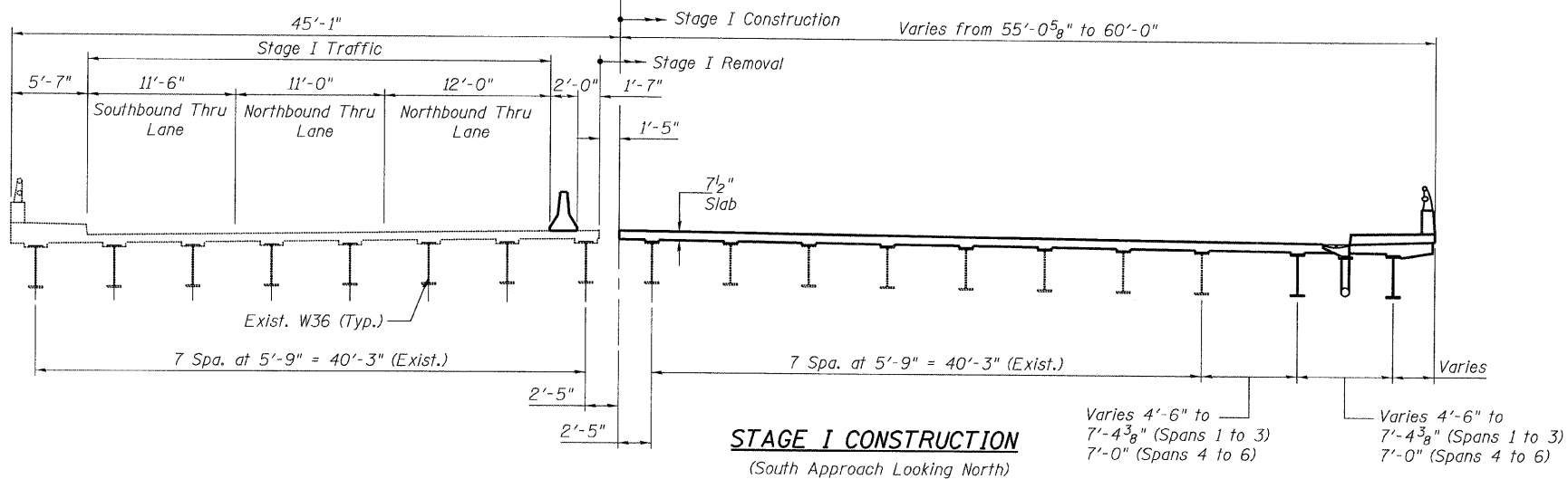

LEGEND

Stage I Removal

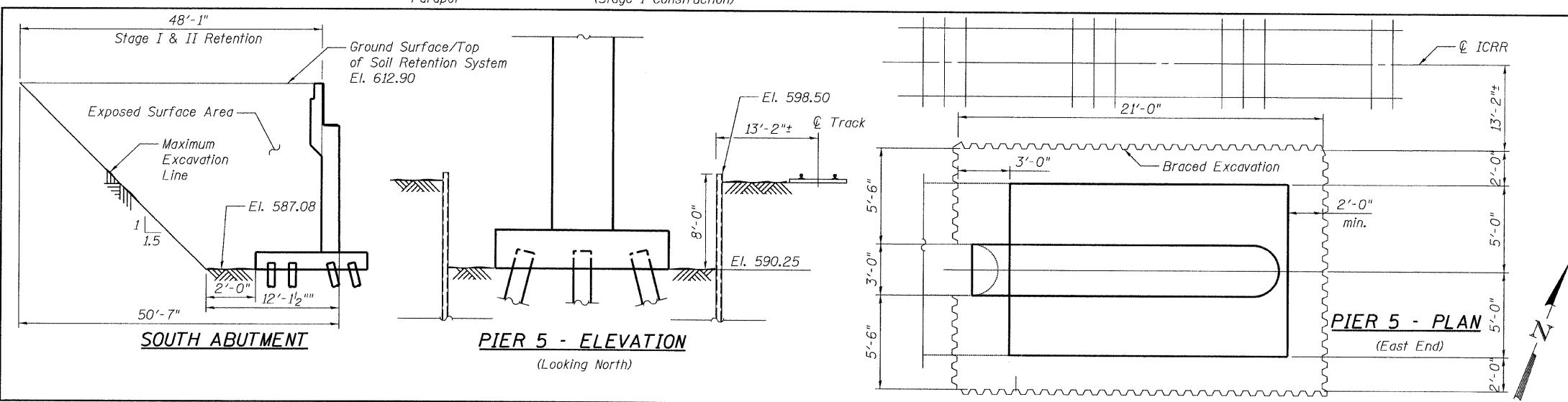
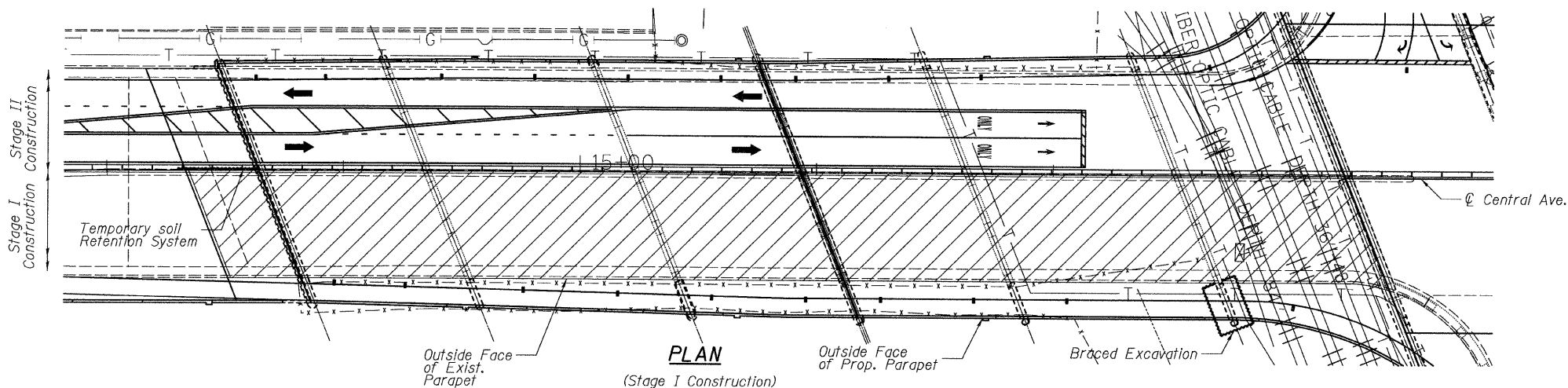

THIS SHEET FOR INFORMATION ONLY

ITEM	UNIT	TOTAL
Temporary Soil Retention System	SQ FT	518
Braced Excavation	CU YD	87

**STAGE I CONSTRUCTION
STRUCTURE NO. 016-3241**

TYLIN INTERNATIONAL	DESIGNED - PK	REVISIONS	
	CHECKED - AMD,	NAME	DATE
	DRAWN - EMK, PK		
	CHECKED - AMD,		
	DATE - 08/02/10		

SHEET NO. 3 26 SHEETS	F.A.I. RTE.	SECTION	COUNTY	TOTAL SHEETS	SHEET NO.
	55	0711.2R & 1011.1BR	COOK	200	7
CONTRACT NO. 60L39					
FED. ROAD DIST. NO. 1 ILLINOIS FED. AID PROJECT					

2:41:31 PM

es:\01345\beam and bearing fabrication\15501stage1.dgn

8/2/2010