

FINAL SURVEY	DATE	
	BY	
	SURVEYED	
	PLOTTED	
NOTE BOOK	NO.	
	AREA CHECKED	
	DATE	
	BY	

ORIGINAL SURVEY	DATE	
	BY	
	SURVEYED	
	PLOTTED	
NOTE BOOK	NO.	
	AREA CHECKED	
	DATE	
	BY	

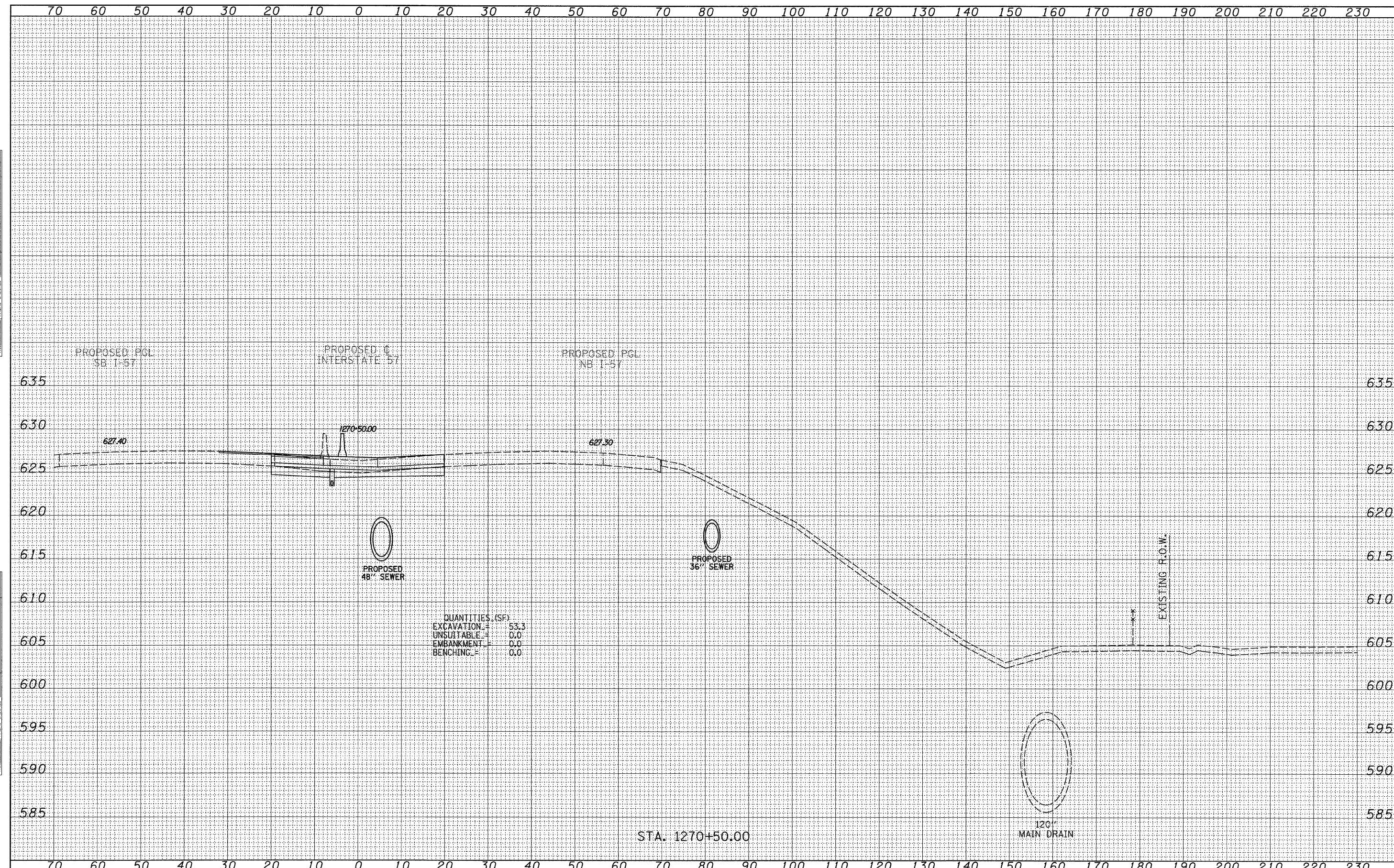

QUANTITIES (SF)
 EXCAVATION = 53.3
 UNSUITABLE = 0.0
 EMBANKMENT = 0.0
 BENCHING = 0.0

STA. 1270+50.00

120\"/>

EXISTING R.O.W.

TYLIN INTERNATIONAL

USER NAME =	DESIGNED - JDF	REVISED - 4/29/2010
PLLOT SCALE =	DRAWN - JDF	REVISED -
PLLOT DATE =	CHECKED - JPM	REVISED -
	DATE - 3/18/2010	REVISED -

STATE OF ILLINOIS
DEPARTMENT OF TRANSPORTATION

I-57 AT I-294 INTERCHANGE PROJECT
PROPOSED I-57 CROSS SECTIONS

SCALE: 1" = 10' H
SHEET NO. OF SHEETS STA. 1270+50.00 TO STA. 1270+50.00

F.A.I. RTE.	SECTION	COUNTY	TOTAL SHEETS	SHEET NO.
57	1414.2B	COOK	516	516F
CONTRACT NO. 60J27				
FED. ROAD DIST. NO. ILLINOIS FED. AID PROJECT				