

\$PENTBLS\$
\$PLTDVRS\$

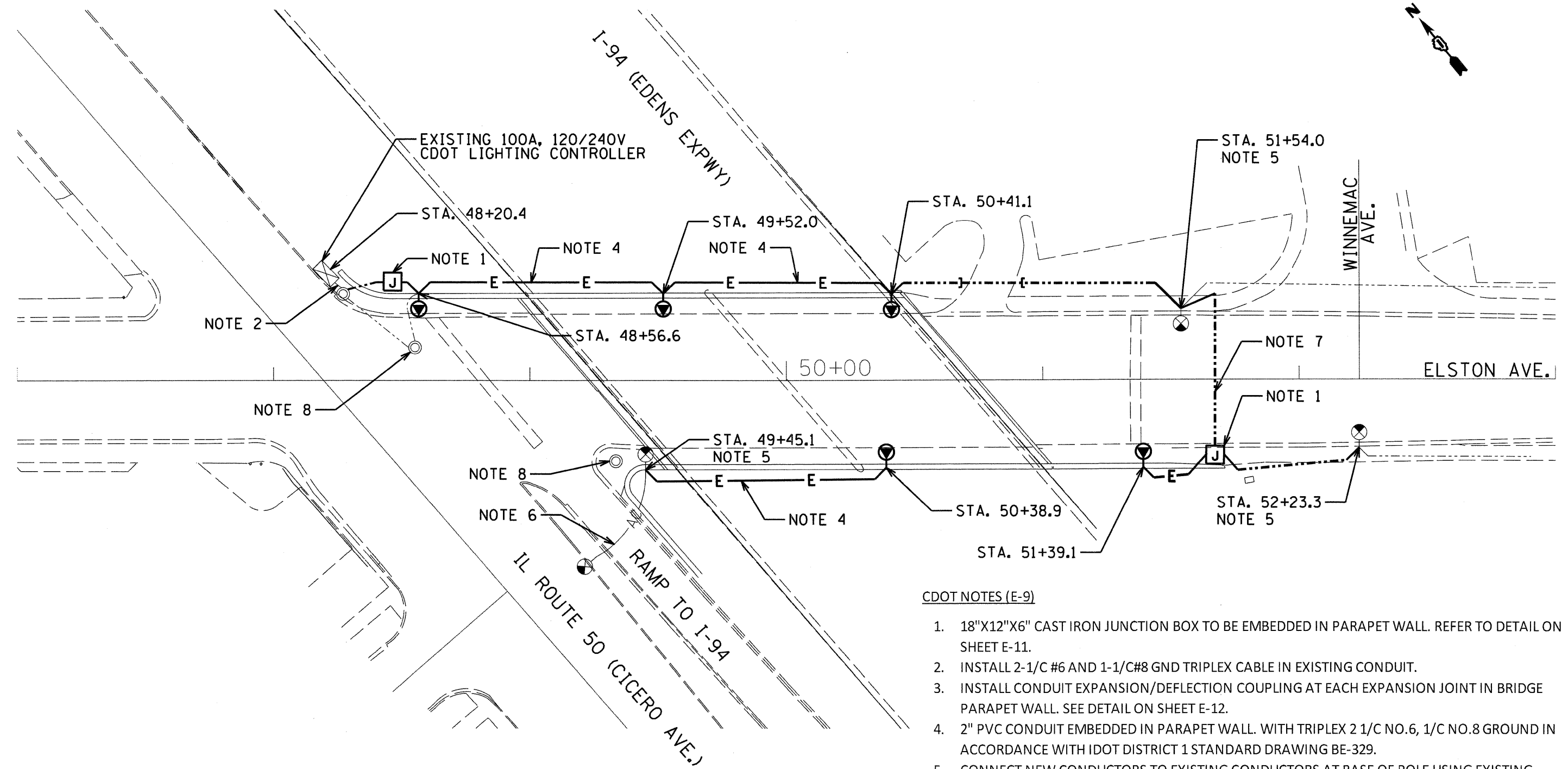

CDOT NOTES (E-9)

1. 18"X12"X6" CAST IRON JUNCTION BOX TO BE EMBEDDED IN PARAPET WALL. REFER TO DETAIL ON SHEET E-11.
2. INSTALL 2-1/C #6 AND 1-1/C#8 GND TRIPLEX CABLE IN EXISTING CONDUIT.
3. INSTALL CONDUIT EXPANSION/DEFLECTION COUPLING AT EACH EXPANSION JOINT IN BRIDGE PARAPET WALL. SEE DETAIL ON SHEET E-12.
4. 2" PVC CONDUIT EMBEDDED IN PARAPET WALL. WITH TRIPLEX 2 1/C NO.6, 1/C NO.8 GROUND IN ACCORDANCE WITH IDOT DISTRICT 1 STANDARD DRAWING BE-329.
5. CONNECT NEW CONDUCTORS TO EXISTING CONDUCTORS AT BASE OF POLE USING EXISTING CONDUIT SLEEVES IN FOUNDATION.
6. EXISTING AERIAL CABLE TO REMAIN.
7. COORDINATE CONDUIT INSTALLATION WITH PAVING FOR BRIDGE WORK.
8. ADJUST MANHOLE FRAME AND COVER FOR NEW PAVEMENT.
9. ALL CITY OF CHICAGO STREET LIGHT CONDUCTORS IN CONDUIT SHALL BE 2-1/C NO. 6 AND 1-1/C NO. 8 GROUND.
10. INSTALL CONDUIT EXPANSION/DEFLECTION COUPLING AT EACH PARAPET WALL EXPANSION JOINT. REFER TO DETAIL ON SHEET E-12.

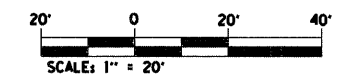

E-9

FILE NAME = \$FILES\$
PLOT DATE = \$DATES\$

SPAAN Tech, Inc.
311 S. Wacker Drive, Suite 2400
Chicago, Illinois 60606
phone: 312.277.8800
fax: 312.277.8808
web: www.SpaanTech.com

DESIGNED	I. A. B.	REVISED	-
DRAWN	R. B. G.	REVISED	-
CHECKED	A. D. O.	REVISED	-
DATE	MAY 2010	REVISED	-

**STATE OF ILLINOIS
DEPARTMENT OF TRANSPORTATION**

**PROPOSED LIGHTING PLAN - CDOT
ELSTON AVENUE OVER I-94**
SCALE: 1" = 20" SHEET NO. OF SHEETS STA. TO STA.

F.A.J. RTE.	SECTION	COUNTY	TOTAL SHEETS	SHEET NO.
94	0101.88	COOK	139	59
FED. ROAD DIST. NO. - ILLINOIS FED. AID PROJECT				
CONTRACT NO. 60C18				