

**INDEX OF SHEETS**

SEE SHEET NO. 2

**STATE OF ILLINOIS  
DEPARTMENT OF TRANSPORTATION  
DIVISION OF HIGHWAYS**

**PROPOSED  
HIGHWAY PLANS**

**FAP ROUTE 594 / FAP ROUTE 2 (ILLINOIS ROUTE 203 / ILLINOIS ROUTE 3)**

**SECTION X-3-RR-HSR, 104-RR-HSR**

**MADISON COUNTY**

*PROJECT: HSR-000V (081)*

F.A.P. RTE.	SECTION	COUNTY	TOTAL SHEETS	SHEET NO.
5942	X-3-RR-HSR, 104-RR-HSR	MADISON	16	1
ILLINOIS			CONTRACT NO. 76J51	

DOT# 294465X DOT# 294473P  
D-98-031-16 MP 270.80 MP 277.12



**C-98-026-16**

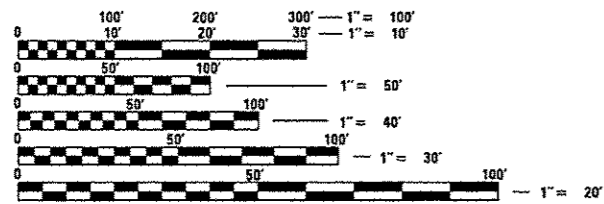

FULL SIZE PLANS HAVE BEEN PREPARED USING STANDARD ENGINEERING SCALES. REDUCED SIZED PLANS WILL NOT CONFORM TO STANDARD SCALES. IN MAKING MEASUREMENTS ON REDUCED PLANS, THE ABOVE SCALES MAY BE USED

J.U.L.I.E.  
JOINT UTILITY LOCATION INFORMATION FOR EXCAVATION  
1-800-892-0123  
OR 811

DISTRICT 8 NO. (618) 346-3100  
PROJECT ENGINEER : KIRK BROWN (618) 346-3112  
PROJECT MANAGER : BO WEDMORE (618) 346-3206  
TOWNSHIP : CHOUTEAU AND VENICE  
CONTRACT NO. 76J51

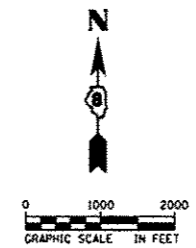
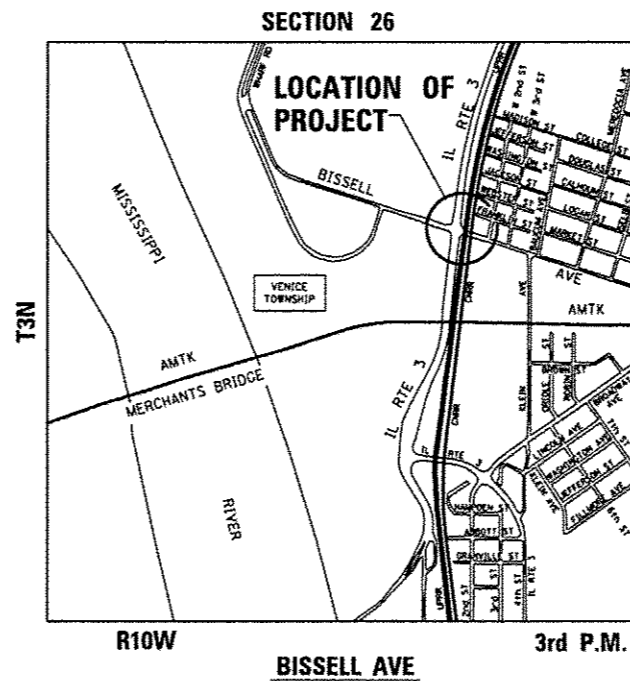
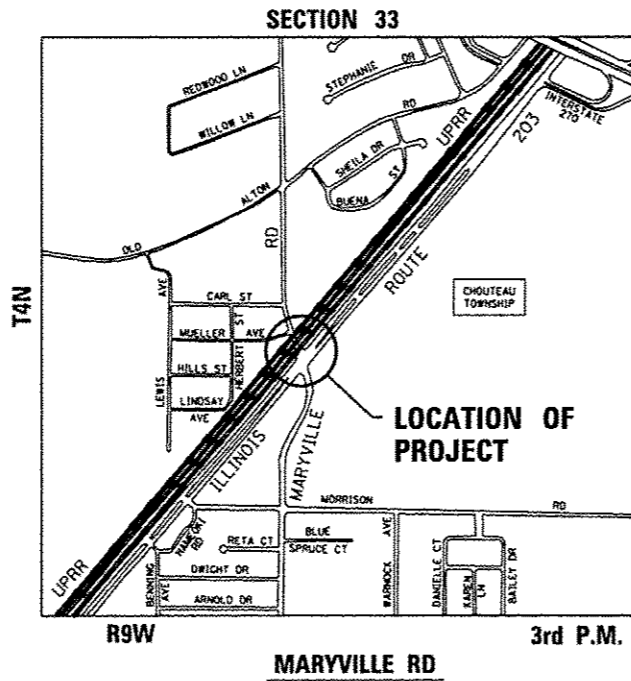

MATTHEW J. LETOURNEAU  
062-055763  
LICENSED PROFESSIONAL ENGINEER OF ILLINOIS

STATE OF ILLINOIS  
DEPARTMENT OF TRANSPORTATION

SUBMITTED *June 8 2016*  
*Jeffrey L. Kangas*  
REGION 5 ENGINEER

*Aug 12 2016*  
*Matthew M. Addis, P.E.*  
ENGINEER OF DESIGN AND ENVIRONMENT

*Aug 12 2016*  
*Aselle*  
DIRECTOR OF PROGRAM DEVELOPMENT

**PRINTED BY THE AUTHORITY  
OF THE STATE OF ILLINOIS**

**AECOM**  
AECOM  
303 EAST WACKER DRIVE, SUITE 1400  
CHICAGO, ILLINOIS 60601  
PH. 312-373-7700

DATE: 05-31-2016  
MATTHEW J. LETOURNEAU  
IL. REG. P.E. NO. 062-055763  
EXPIRES: 11-30-2017

## INDEX OF SHEETS

1	COVER SHEET
2	INDEX OF SHEETS, HIGHWAY STANDARDS, DISTRICT DETAILS, COMMITMENTS AND GENERAL NOTES
3-4	SUMMARY OF QUANTITIES <u>MARYVILLE RD</u>
5	TRAFFIC SIGNAL MODIFICATION PLAN
6	TRAFFIC SIGNAL CABLE PLAN
7	TRAFFIC SIGNAL SEQUENCE OF OPERATION
8	RAILROAD PREEMPTION SEQUENCE OF OPERATION
9-10	SIGNING AND PAVEMENT MARKING PLAN <u>BISSELL AVE</u>
11	TRAFFIC SIGNAL MODIFICATION PLAN
12	TRAFFIC SIGNAL CABLE PLAN
13	TRAFFIC SIGNAL SEQUENCE OF OPERATION
14	RAILROAD PREEMPTION SEQUENCE OF OPERATION
15-16	SIGNING AND PAVEMENT MARKING PLAN

## HIGHWAY STANDARDS

000001-06	STANDARD SYMBOLS, ABBREVIATIONS AND PATTERNS
701101-05	OFF-ROAD OPERATIONS, MULTILANE, 15 FT (4.5 M) TO 24 IN (600 MM) FROM PAVEMENT EDGE
701106-02	OFF-ROAD OPERATIONS, MULTILANE, MORE THAN 15 FT (4.5 M) AWAY
701426-08	LANE CLOSURE, MULTILANE, INTERMITTENT OR MOVING OPERATIONS, FOR SPEEDS >= 45 MPH
701901-05	TRAFFIC CONTROL DEVICES
720001-01	SIGN PANEL MOUNTING DETAILS
720006-04	SIGN PANEL ERECTION DETAILS
814001-03	HANDHOLES
814006-02	DOUBLE HANDHOLES
857006-01	SUPERVISED RAILROAD INTERCONNECT CIRCUIT
862001-01	UNINTERRUPTABLE POWER SUPPLY (UPS)
873001-02	TRAFFIC SIGNAL GROUNDING & BONDING

## DISTRICT DETAILS

TC-10	TRAFFIC CONTROL & PROTECTION FOR SIDE ROADS
TC-22	ARTERIAL ROAD INFORMATION SIGN

## COMMITMENTS

NONE: MAY 31, 2016

## GENERAL NOTES

- NO WORK SHALL COMMENCE UNTIL THE PROPOSED TRAFFIC CONTROL IS IN PLACE AND HAS BEEN APPROVED BY THE ENGINEER.
- THE CONTRACTOR SHALL VERIFY ALL DIMENSIONS AND CONDITIONS IN THE FIELD PRIOR TO CONSTRUCTION AND ORDERING MATERIALS.
- FOR STABILIZATION, ALL TYPE III BARRICADES SHALL REQUIRE A MINIMUM OF FOUR SAND BAGS PER BARRICADE.
- ABANDONED UNDERGROUND UTILITIES THAT CONFLICT WITH CONSTRUCTION SHALL BE DISPOSED OF OUTSIDE THE LIMITS OF THE RIGHT OF WAY ACCORDING TO ARTICLE 202.03 OF THE STANDARD SPECIFICATIONS AND AS DIRECTED BY THE ENGINEER. THIS WORK WILL NOT BE PAID FOR SEPARATELY, BUT SHALL BE INCLUDED IN THE COST OF THE UNDERGROUND CONDUIT.
- ANY REFERENCE TO A HIGHWAY STANDARD IN THESE PLANS SHALL BE INTERPRETED TO MEAN THE EDITION AS INDICATED BY THE REVISION NUMBER SHOWN IN THE LIST OF HIGHWAY STANDARDS OR THE COPY INCLUDED IN THESE PLANS.
- THE SCALE SHOWN ON THE DRAWINGS APPLIES ONLY TO FULL SIZE PLANS AND NOT TO THE REDUCED SIZE PLANS. REDUCED SIZE PLANS CAN BE PRINTED TO SCALE FOR USE IN THE FIELD.
- NS RAILROAD (AT MARYVILLE RD) AND UP RAILROAD (AT BISSELL AVE) FLAGGERS SHALL BE PRESENT WHEN WORKING WITHIN 25' OF THE RAILROAD TRACKS. THE CONTRACTOR SHALL COORDINATE DIRECTLY WITH NS OR THE UP RAILROAD TO ASSURE FLAGGERS ARE PRESENT DURING CONSTRUCTION. NO ADDITIONAL COMPENSATION WILL BE ALLOWED.
- BENCHMARKS FOR THE PROJECT ARE DESCRIBED IN THE PLANS AND ARE BASED ON NORTH AMERICAN VERTICAL DATUM OF 1988 (NAVD 88). ALL BEARINGS AND COORDINATES REFERENCED IN THE PLAN DRAWINGS AND ALL CONTROL COORDINATES ARE BASED ON THE ILLINOIS STATE PLANE COORDINATE SYSTEM, WEST ZONE, NAD 83 (2011).
- EXISTING UTILITIES ARE SHOWN ON THE PLANS ACCORDING TO INFORMATION OBTAINED FROM THE LOCAL AGENCIES, OWNERS, AND FIELD SURVEYS. THE ACCURACY AND COMPLETENESS OF SAID INFORMATION IS NOT GUARANTEED. IT SHALL BE THE CONTRACTOR'S RESPONSIBILITY TO VERIFY THE EXISTENCE, NATURE AND EXACT LOCATIONS OF ALL UTILITY LINES AND APPURTENANCES WITHIN THE LIMITS OF IMPROVEMENTS.
- ILLINOIS STATE LAW REQUIRES A 48-HOUR NOTICE BE GIVEN TO ALL UTILITIES WITHIN THE PROJECT AREA BEFORE DIGGING. FIELD MARKING OF FACILITIES MAY BE OBTAINED BY CONTACTING J.U.L.I.E. OR FOR NON-MEMBERS, THE UTILITY COMPANY DIRECTLY. AGENCIES KNOWN TO HAVE FACILITIES WITHIN THE PROJECT AREA ARE AS FOLLOWS:

### MARYVILLE RD

#### NON-J.U.L.I.E.

UNION PACIFIC RAILROAD COMPANY  
UNION PACIFIC RAILROAD COMPANY (NEW FIBER OPTIC LINE)

#### J.U.L.I.E.

LEVEL 3 COMMUNICATIONS  
SPRINT  
AMEREN ILLINOIS  
AT&T - DISTRIBUTION  
ZAYO/FNA 360 NETWORKS  
CHARTER COMMUNICATIONS  
STATE OF ILLINOIS - CMS  
MITCHELL PUBLIC WATER DISTRIBUTION  
CITY OF GRANITE CITY  
MADISON COUNTY SANITARY

### BISSELL AVE

#### NON-J.U.L.I.E.

UNION PACIFIC RAILROAD COMPANY  
UNION PACIFIC RAILROAD COMPANY (NEW FIBER OPTIC LINE)

#### J.U.L.I.E.

LEVEL 3 COMMUNICATIONS  
SPRINT  
AMEREN ILLINOIS  
AT&T - DISTRIBUTION  
AT&T - TRANSMISSION  
ZAYO/FNA 360 NETWORKS  
CHARTER COMMUNICATIONS  
CENTURY LINK  
CITY OF MADISON  
ENABLE MISSISSIPPI RIVER TRANSMISSION  
TRI-CITY REGIONAL PORT DISTRIBUTION  
AMERICAN WATER - GRANITE CITY  
DE REGULATED

- MEMBERS OF J.U.L.I.E. CALL TOLL FREE (800) 892-0123 OR 811. NON-J.U.L.I.E. MEMBERS MUST BE NOTIFIED INDIVIDUALLY.
- THE CONTRACTOR SHALL COORDINATE WITH THE NS RAILROAD (AT MARYVILLE RD) OR THE UP RAILROAD (AT BISSELL AVE) SIGNAL DEPARTMENT FOR ITEMS INSTALLED BY THE NS OR UP RAILROAD SIGNAL DEPARTMENT.
- ALL FIELD TILE ENCOUNTERED SHALL BE CAREFULLY PRESERVED AND REPAIRED OR CONNECTED TO THE PROPOSED DRAINAGE STRUCTURES, SEWERS OR DITCHES AS DIRECTED BY THE ENGINEER. PAYMENT FOR THIS WORK SHALL BE IN ACCORDANCE WITH ARTICLE 109.04.
- THE CONTRACTOR SHALL COORDINATE WITH UPRR FOR RIGHT OF ENTRY PERTAINING TO WORK WITHIN RAILROAD R.O.W.
- THE RESIDENT ENGINEER SHALL VERIFY THE EXISTENCE OF HIGHWAY LIGHTING AND/OR INTELLIGENT TRANSPORTATION SYSTEMS (I.T.S.) UTILITIES WITHIN THE PROJECT LIMITS. IF HIGHWAY LIGHTING AND/OR I.T.S. EXISTS WITHIN THE PROJECT LIMITS, AND IF THESE ITEMS REQUIRE LOCATING, THE CONTRACTOR SHALL BE DIRECTED TO DO SO ACCORDING TO SECTION 803 OF THE STANDARD SPECIFICATIONS. THIS WORK SHALL BE PAID FOR ACCORDING TO ARTICLE 109.04 OF THE STANDARD SPECIFICATIONS.
- THE DEPARTMENT STRONGLY ENCOURAGES THE PRIME CONTRACTOR AND THEIR APPROVED SUBCONTRACTORS TO HIRE MINORITY, WOMEN AND DISADVANTAGED INDIVIDUALS FROM ITS FEDERALLY FUNDED HIGHWAY CONSTRUCTION CAREERS TRAINING PROGRAM (HCCTP) TO HELP MEET WORKFORCE AND TRAINEE GOALS. THIS PROGRAM IS TRAINING MINORITIES, WOMEN AND DISADVANTAGED INDIVIDUALS IN HIGHWAY CONSTRUCTION-RELATED SKILLS, E.G., MATH FOR THE TRADES, JOB READINESS, TECHNICAL SKILLS COURSE WORK (CARPENTRY, CONCRETE FLATWORK, BLUEPRINT READING, SITE PLANS, SITE WORK, TOOLS USE, ETC.) AND OSHA 10 HOUR CERTIFICATION, TO PREPARE THEM FOR A CAREER IN THE HIGHWAY CONSTRUCTION TRADES. GRADUATES ARE WELL-TRAINED AND READY TO BECOME PRODUCTIVE ENTRY-LEVEL CONSTRUCTION WORKERS. CONTACT THE DISTRICT 8 EEO OFFICE AT 618-346-3360 AND/OR THE HCCTP COORDINATOR AT 618-874-6528 TO LEARN MORE ABOUT THE PROGRAM AND FOR ASSISTANCE IN MEETING WORKFORCE AND TRAINEE GOALS.
- NORFOLK SOUTHERN DOT# IS 480324A.

STATE OF ILLINOIS  
DEPARTMENT OF TRANSPORTATION

INDEX OF SHEETS, HIGHWAY STANDARDS, DISTRICT DETAILS,  
COMMITMENTS AND GENERAL NOTES

F.A.P. RTE.	SECTION	COUNTY	TOTAL SHEETS	SHEET NO.
594/2	X-3-RR-HSR, 104-RR-HSR	MADISON	16	2
CONTRACT NO. 76J51			ILLINOIS FED. AID PROJECT	

SCALE: NTS SHEET 1 OF 1 SHEETS STA. TO STA.



SUMMARY OF QUANTITIES

				CONSTRUCTION CODE	
				MARYVILLE RD	BISSELL AVE
				CROSSING NO. 294465X	CROSSING NO. 294473P
				SIGNAL	SIGNAL
				100% HSR (FED.)	100% HSR (FED.)
				URBAN	URBAN
				0021	0021
* 66900200	NON-SPECIAL WASTE DISPOSAL	CU YD	20	10	10
* 66900450	SPECIAL WASTE PLANS AND REPORTS	L SUM	1	0.5	0.5
* 66900530	SOIL DISPOSAL ANALYSIS	EACH	1	0.5	0.5
67100100	MOBILIZATION	L SUM	1	0.5	0.5
72000100	SIGN PANEL - TYPE 1	SD FT	56	24	32
73000100	WOOD SIGN SUPPORT	FOOT	60	30	30
78000100	THERMOPLASTIC PAVEMENT MARKING - LETTERS AND SYMBOLS	SO FT	244	122	122
78000200	THERMOPLASTIC PAVEMENT MARKING - LINE 4"	FOOT	796	565	231
78000400	THERMOPLASTIC PAVEMENT MARKING - LINE 6"	FOOT	2202	1173	1029
78000500	THERMOPLASTIC PAVEMENT MARKING - LINE 8"	FOOT	93	44	49
78000650	THERMOPLASTIC PAVEMENT MARKING - LINE 24"	FOOT	182	82	100
81028200	UNDERGROUND CONDUIT, GALVANIZED STEEL, 2" DIA.	FOOT	104		104
81028350	UNDERGROUND CONDUIT, PVC, 2" DIA.	FOOT	339	164	175
81400100	HANDHOLE	EACH	1		1

\*Specialty Items

FILE NAME: 76J51-SUMQUAN.DWG



USER NAME: KMD	DESIGNED: KMD	REVISED:
DRAWN: KMD	CHECKED: MJL	REVISED:
DATE: 05/31/16		REVISED:

STATE OF ILLINOIS  
DEPARTMENT OF TRANSPORTATION

SUMMARY OF QUANTITIES

SCALE: NONE SHEET 1 OF 2 SHEETS STA. TO STA.

F.A.P. RTE.	SECTION	COUNTY	TOTAL SHEETS	SHEET NO.
594/2	X-3-RR-HSR, 104-RR-HSR	MADISON	16	3
			CONTRACT NO. 76J51	
ILLINOIS FED. AID PROJECT				

SUMMARY OF QUANTITIES

				CONSTRUCTION CODE	
				MARYVILLE RD	BISSELL AVE
				CROSSING NO. 294465X	CROSSING NO. 294473P
				SIGNAL	SIGNAL
				100% HSR (FED.)	100% HSR (FED.)
				URBAN	URBAN
				0021	0021
85000200	MAINTENANCE OF EXISTING TRAFFIC SIGNAL INSTALLATION	EACH	2	1	1
87301255	ELECTRIC CABLE IN CONDUIT, SIGNAL NO. 14 7C	FOOT	453	453	
87301750	ELECTRIC CABLE IN CONDUIT, RAILROAD, NO. 14 3C	EACH	611	296	315
87900200	DRILL EXISTING HANDHOLE	EACH	5	4	1
88030070	SIGNAL HEAD, LED, 1-FACE, 4-SECTION, BRACKET MOUNTED	EACH	1	1	
88030100	SIGNAL HEAD, LED, 1-FACE, 5-SECTION, BRACKET MOUNTED	EACH	1	1	
89100400	ILLUMINATED SIGN, LED	EACH	4	2	2
89502215	MODIFY EXISTING CONTROLLER FOUNDATION	EACH	2	1	1
89502300	REMOVE EXISTING ELECTRIC CABLE FROM CONDUIT	FOOT	598	296	302
X0327980	PAVEMENT MARKING REMOVAL - WATER BLASTING	SO FT	971	877	94
X1400144	UNINTERRUPTABLE POWER SUPPLY AND CABINET, SPECIAL	EACH	2	1	1
X8571215	RAILROAD, FULL ACTUATED CONTROLLER AND TYPE IV CABINET, SPECIAL	EACH	2	1	1
X8950105	REMOVE EXISTING TRAFFIC CONTROLLER AND CABINET	EACH	2	1	1
Z0013798	CONSTRUCTION LAYOUT	L SUM	1	0.5	0.5
Z0048665	RAILROAD PROTECTIVE LIABILITY INSURANCE	L SUM	1	0.5	0.5

FILE NAME: \*FILES



USER NAME: *USERS	DESIGNED - KMO	REVISED -
	DRAWN - KMO	REVISED -
PLOT SCALE: *SCALE#	CHECKED - MJL	REVISED -
PLOT DATE: *DATE#	DATE - 05/31/16	REVISED -

STATE OF ILLINOIS  
DEPARTMENT OF TRANSPORTATION

SUMMARY OF QUANTITIES

SCALE: NONE SHEET 2 OF 2 SHEETS STA. TO STA.

F.A.P. RTE.	SECTION	COUNTY	TOTAL SHEETS	SHEET NO.
S94/2	X-3-RR-HSR, 104-RR-HSR	MADISON	16	4
			CONTRACT NO. 76J51	
ILLINOIS FED. AID PROJECT				

### TRAFFIC SIGNAL GENERAL NOTES

- IT SHALL BE THE CONTRACTOR'S RESPONSIBILITY TO VERIFY ALL DIMENSIONS AND CONDITIONS EXISTING IN THE FIELD PRIOR TO ORDERING MATERIALS AND BEGINNING CONSTRUCTION.
- THE EXACT LOCATION OF ALL UTILITIES SHALL BE FIELD VERIFIED BY THE CONTRACTOR BEFORE ORDERING ANY MATERIALS AND STARTING ANY WORK. FOR LOCATIONS OF UTILITIES, LOCALLY OWNED EQUIPMENT, AND IDOT UNDERGROUND FACILITIES, CONTACT THE LOCAL COUNTIES, MUNICIPALITIES AND IDOT FOR LOCATES. THE CONTRACTOR SHALL CALL 'JULIE' AT (800) 892-0123.
- THE CONTRACTOR SHALL CALL THE UNION PACIFIC (UPRR) "CALL BEFORE YOU DIG" OPERATION AT 1-800-336-9193 FOR FIELD LOCATIONS OF UNION PACIFIC OWNED BURIED FIBER OPTIC CABLES IN UNION PACIFIC RIGHT OF WAY. THE CONTRACTOR SHALL ALSO CONTACT THE NORFOLK SOUTHERN RAILWAY AT 1-478-832-0958 (JOEL VAN AKKEREN, C&S SUPERVISOR), JOEL.VANAKKEREN@NSCORP.COM
- THE CONTRACTOR SHALL COORDINATE WITH NORFOLK SOUTHERN (NS) RAILROAD BEFORE STARTING ANY WORK ON NS PROPERTY. CONTRACTOR SHALL BE RESPONSIBLE FOR OBTAINING AND FOLLOWING CURRENT SPECIFICATIONS FOR PIPELINE OCCUPANCY OF NORFOLK SOUTHERN CORPORATION PROPERTY. (NS DOT #480324A)
- THE CONTRACTOR SHALL COORDINATE CONSTRUCTION ACTIVITIES WITH GATEWAY EASTERN RAILWAY, A SUBSIDIARY OF KANSAS CITY SOUTHERN RAILWAY, AS NECESSARY.
- THE CONTRACTOR SHALL COORDINATE CONSTRUCTION ACTIVITIES WITH UTILITY COMPANIES, LOCAL GOVERNMENT AGENCIES, IDOT, UPRR, NS RAILWAY, AND GATEWAY EASTERN RAILWAY.
- COORDINATE ALL WORK WITH THE RAILROAD FORCES. SEE SPECIAL PROVISION "RAILROAD COORDINATION AND FLAGGERS."
- THE ILLINOIS DEPARTMENT OF TRANSPORTATION SHALL BE NOTIFIED AT LEAST 72 HOURS PRIOR TO THE REPLACING OF AND TURNING ON OF THE UPGRADED CONTROLLER UNIT.
- THE CONTRACTOR IS RESPONSIBLE FOR THE COST OF UNCOVERING OR HAND DIGGING AROUND UTILITIES, AS NECESSARY; COST TO BE INCLUDED WITH THE CONDUIT PAY ITEM.
- THE CONTRACTOR SHALL PROVIDE A SELF-ADHERED PHASE DIAGRAM ON THE INSIDE OF THE CONTROLLER CABINET DOOR.
- PROPOSED UNDERGROUND CONDUIT SHALL AVOID UNDERGROUND UTILITIES.
- RAILROAD, FULL-ACTUATED CONTROLLER AND TYPE IV CABINET, SPECIAL SHALL INCLUDE VEHICLE DETECTOR AMPS, REMOTE MONITORING, AND AN INTERSECTION MONITOR.
- IT SHALL BE THE CONTRACTOR'S RESPONSIBILITY TO MAINTAIN THE EXISTING TRAFFIC SIGNAL INSTALLATION DURING THE WORK.

THE FOLLOWING ITEMS SHALL BE REMOVED BY THE CONTRACTOR AND SHALL REMAIN THE PROPERTY OF THE AGENCY LISTED BELOW. THE CONTRACTOR SHALL SAFELY STORE AND ARRANGE FOR THE PICK UP OF ALL EQUIPMENT TO BE RETURNED TO THE LISTED AGENCY AS PER THE SPECIAL PROVISION.

AGENCY: ILLINOIS DEPARTMENT OF TRANSPORTATION DISTRICT 8

1 EACH CONTROLLER AND CABINET (COMPLETE)

NOTE: ALL TRAFFIC SIGNAL CONTROLLER EQUIPMENT FOR THIS PROJECT SHALL BE "ECONOLITE".

**RESTORATION OF WORK AREA.** RESTORATION OF THE TRAFFIC SIGNAL WORK AREA SHALL BE INCLUDED WITH THE RELATED PAY ITEM SUCH AS MODIFY EXISTING CONTROLLER FOUNDATION, CONDUIT, ETC., AND NO EXTRA COMPENSATION SHALL BE ALLOWED. ALL ROADWAY SURFACES SUCH AS SHOULDERS, MEDIANS, SIDEWALKS, PAVEMENT, ETC. SHALL BE REPLACED IN KIND. ALL DAMAGE TO MOWED LAWNS SHALL BE REPLACED WITH AN APPROVED SOD, AND ALL DAMAGE TO UNMOWED FIELDS SHALL BE SEEDED IN ACCORDANCE WITH STANDARD SPECIFICATIONS 252 AND 250 RESPECTIVELY.

**STAGING OF RAILROAD INTERCONNECT WORK.** THE EXISTING RAILROAD INTERCONNECT WILL BE MAINTAINED THROUGHOUT THE WORK UNTIL A NEW RAILROAD INTERCONNECT CABLE IS INSTALLED FROM THE NEW CONTROLLER TO THE RAILROAD BUNGALOW AS SHOWN.

ANY DAMAGE DONE TO THE EXISTING SIGNAL ITEMS OR APPURTENANCES SHALL BE REPAIRED OR REPLACED BY THE CONTRACTOR, PER SECTION 895.02 OF THE STANDARD SPECIFICATIONS.

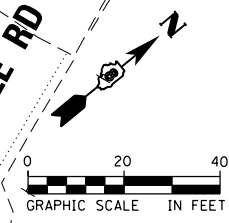
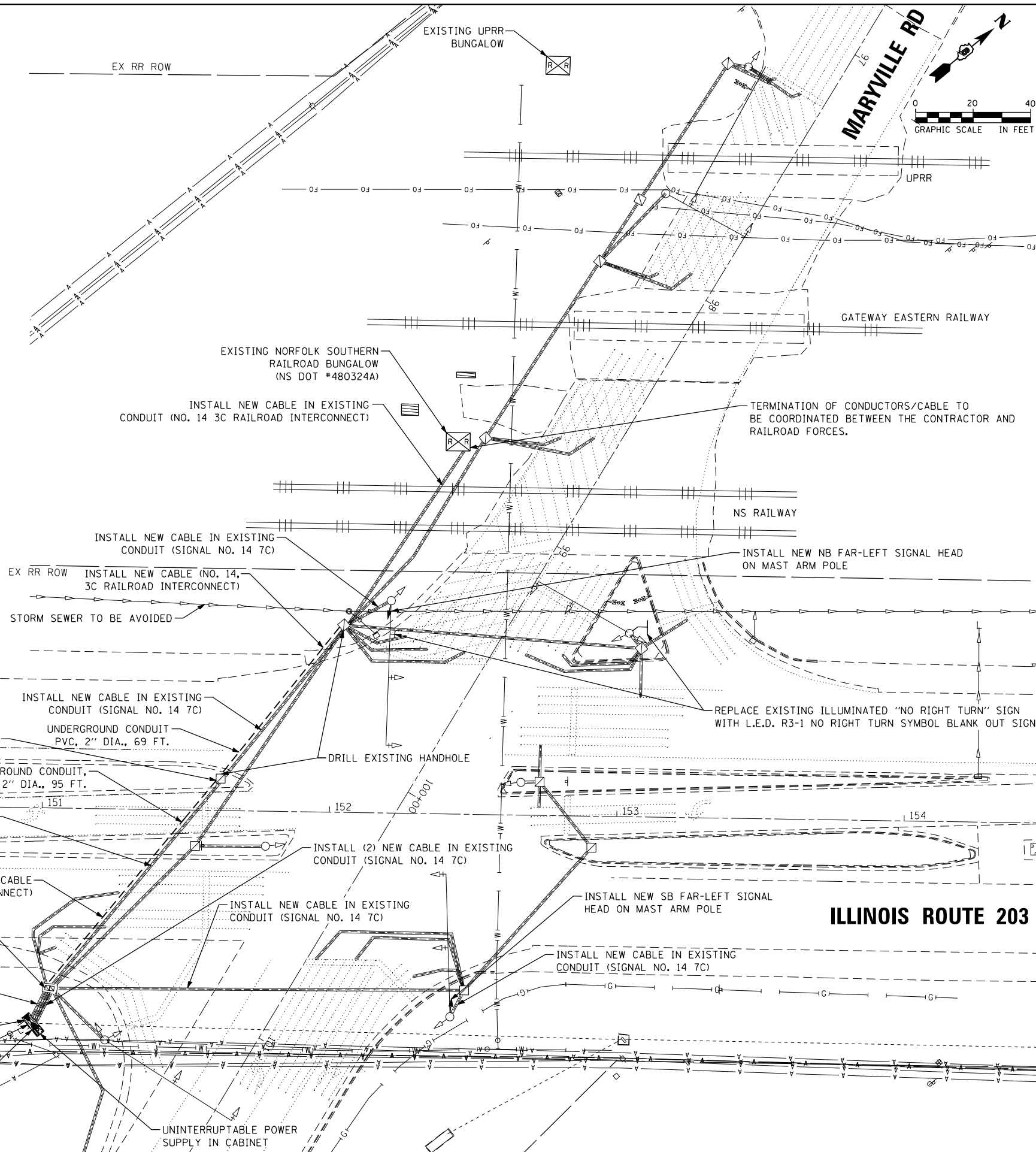

### ILLINOIS ROUTE 203

### TRAFFIC SIGNAL LEGEND

- PROPOSED CONTROLLER
- EXISTING SERVICE INSTALLATION (POLE MTD.)
- EXISTING SIGNAL HEAD
- PROPOSED SIGNAL HEAD
- EXISTING SIGNAL HEAD WITH BACKPLATE
- EXISTING TRAFFIC SIGNAL POST, PAINTED STEEL
- EXISTING STEEL MAST ARM ASSEMBLY AND POLE
- EXISTING HANDHOLE
- PROPOSED HANDHOLE
- EXISTING DOUBLE HANDHOLE
- EXISTING UNDERGROUND CONDUIT
- PROPOSED UNDERGROUND CONDUIT
- RAILROAD CONTROL CABINET (EXISTING)
- UNINTERRUPTIBLE POWER SUPPLY
- EXISTING ILLUMINATED SIGN
- PROPOSED L.E.D. BLANK OUT SIGN

### ILLINOIS ROUTE 203

FILE NAME: #FILES



USER NAME: #USER*	DESIGNED - KMO	REVISED -
PLOT SCALE: #SCALE*	DRAWN - SRS	REVISED -
PLOT DATE: #DATE*	CHECKED - MJL	REVISED -
	DATE - 05/31/16	REVISED -

STATE OF ILLINOIS  
DEPARTMENT OF TRANSPORTATION

TRAFFIC SIGNAL MODIFICATION PLAN  
MARYVILLE ROAD AND ILLINOIS ROUTE 203  
SCALE: 1" = 20'  
SHEET 1 OF 1 SHEETS STA. TO STA.

F.A.P. RTE. 594/2	SECTION X-3-RR-HSR, 104-RR-HSR	COUNTY MADISON	TOTAL SHEETS 16	SHEET NO. 5
CONTRACT NO. 76J51				
ILLINOIS FED. AID PROJECT				

D876J51-sht005-signal plan.dgn 8/9/2016 11:01:31 AM

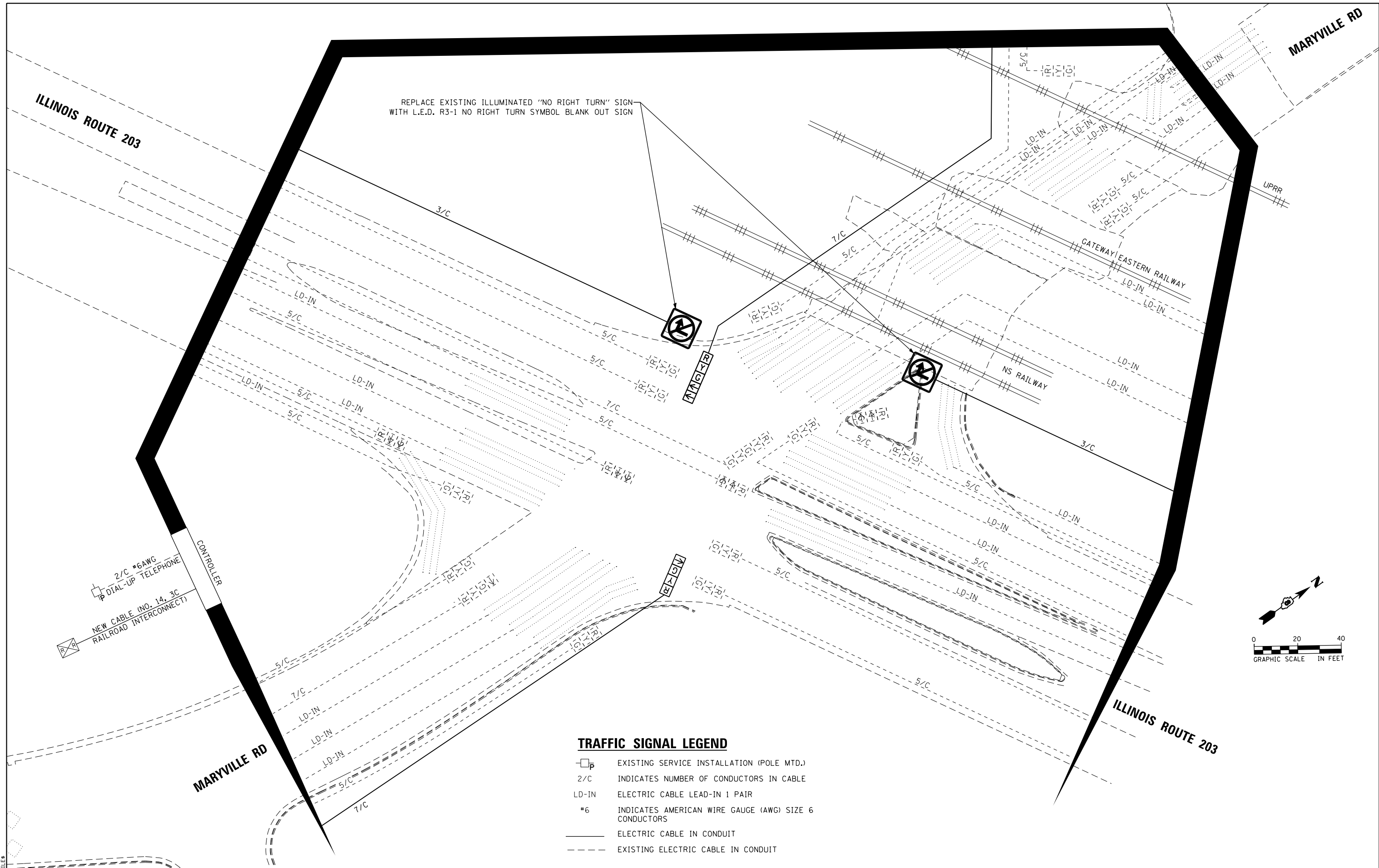

REPLACE EXISTING ILLUMINATED "NO RIGHT TURN" SIGN WITH L.E.D. R3-1 NO RIGHT TURN SYMBOL BLANK OUT SIGN

2/C #6AWG  
DIAL-UP TELEPHONE  
NEW CABLE (NO. 14, 3C  
RAILROAD INTERCONNECT)

CONTROLLER

**TRAFFIC SIGNAL LEGEND**

- EXISTING SERVICE INSTALLATION (POLE MTD.)
- 2/C INDICATES NUMBER OF CONDUCTORS IN CABLE
- LD-IN ELECTRIC CABLE LEAD-IN 1 PAIR
- #6 INDICATES AMERICAN WIRE GAUGE (AWG) SIZE 6 CONDUCTORS
- ELECTRIC CABLE IN CONDUIT
- - - EXISTING ELECTRIC CABLE IN CONDUIT

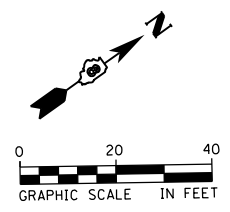

USER NAME = \$USER*	DESIGNED - KMO	REVISED -
DRAWN - SRS	REVISED -	
CHECKED - MJL	REVISED -	
DATE - 05/31/16	REVISED -	

STATE OF ILLINOIS  
DEPARTMENT OF TRANSPORTATION

**TRAFFIC SIGNAL CABLE PLAN**  
**MARYVILLE ROAD AND ILLINOIS ROUTE 203**

SCALE: 1" = 20' SHEET 1 OF 1 SHEETS STA. TO STA.

F.A.P. RTE.	SECTION	COUNTY	TOTAL SHEETS	SHEET NO.
594/2	X-3-RR-HSR, 104-RR-HSR	MADISON	16	6
CONTRACT NO. 76J51				
ILLINOIS FED. AID PROJECT				

FILE NAME = \$FILES\*  
D876J51-sht006-cable plan.dgn 5/26/2016 2:27:32 PM

# SEQUENCE OF OPERATION

							FLASH																							
MOVEMENT	1 + 5		2 + 5		1 + 6		2 + 6		3				4																	
PHASE	1 + 5		2 + 5		1 + 6		2 + 6		3				4																	
INTERVAL	1	2A	2B	3A	3B	4A	4B	5	6A	6B	7	8A	8B	9	10A	10B	11A	11B	12A	12B	13	14A	14B	14C	14D	15	16A	16B		
CHANGE TO	/	2 + 5		1 + 6		2 + 6		/	2 + 6		/	2 + 6		/	2 + 5		1 + 6		3, 4, 1 + 5		/	4, 1 + 5 2 + 5 1 + 6 2 + 6			/	1 + 5 1 + 6 2 + 6				
ILLINOIS ROUTE 203 FAR LEFT AND LEFT POST MOUNTED SIGNALS SW/B	G	G	G	Y	R	Y	R	G	Y	R	R	R	R	R	R	R	R	R	R	R	R	R	R	R	R	R	R	R	R	R
ILLINOIS ROUTE 203 LEFT AND RIGHT MAST ARM AND NEAR RIGHT SIGNALS SW/B	R	R	R	R	R	R	R	G	G	G	R	R	R	G	G	G	Y	R	Y	R	R	R	R	R	R	R	R	R	R	
ILLINOIS ROUTE 203 FAR LEFT AND LEFT POST MOUNTED SIGNALS NE/B	G	Y	R	G	G	Y	R	R	R	R	G	Y	R	R	R	R	R	R	R	R	R	R	R	R	R	R	R	R	R	R
ILLINOIS ROUTE 203 LEFT AND RIGHT MAST ARM AND NEAR RIGHT SIGNALS NE/B	R	R	R	R	R	R	R	R	R	R	G	G	G	G	Y	R	G	G	Y	R	R	R	R	R	R	R	R	R	R	
MARYVILLE ROAD FAR LEFT AND LEFT MAST ARM SIGNALS NW/B	R	R	R	R	R	R	R	R	R	R	R	R	R	R	R	R	R	R	R	R	R	R	R	R	R	R	G	Y	R	R
MARYVILLE ROAD RIGHT MAST ARM AND NEAR RIGHT SIGNALS NW/B	R	R	R	R	R	R	R	R	R	R	R	R	R	R	R	R	R	R	R	R	R	R	R	R	R	R	G	Y	R	R
MARYVILLE ROAD (PRE-SIGNAL) ALL SIGNALS SE/B	R	R	R	R	R	R	R	R	R	R	R	R	R	R	R	R	R	R	R	R	R	G	Y	R	R	R	R	R	R	R
MARYVILLE ROAD (EAST OF TRACKS) FAR LEFT AND LEFT MAST ARM SIGNALS SE/B	R	R	R	R	R	R	R	R	R	R	R	R	R	R	R	R	R	R	R	R	R	G	G	G	Y	R	R	R	R	R
MARYVILLE ROAD (EAST OF TRACKS) RIGHT MAST ARM AND NEAR RIGHT SIGNALS SE/B	R	R	R	R	R	R	R	R	R	R	R	R	R	R	R	R	R	R	R	R	R	G	G	G	Y	R	R	R	R	R

PHASES 2 AND 6 SHALL BE PLACED ON RECALL.

FILE NAME = \$FILES



USER NAME = \$USER*	DESIGNED - MJL	REVISED -
	DRAWN - MJL	REVISED -
PLOT SCALE = \$SCALE*	CHECKED - JAL	REVISED -
PLOT DATE = \$DATE*	DATE - 05/31/16	REVISED -

**STATE OF ILLINOIS  
DEPARTMENT OF TRANSPORTATION**

**TRAFFIC SIGNAL SEQUENCE OF OPERATION  
MARYVILLE ROAD AND ILLINOIS ROUTE 203**

SCALE: NTS    SHEET 1 OF 1 SHEETS    STA.    TO STA.

F.A.P. RTE.	SECTION	COUNTY	TOTAL SHEETS	SHEET NO.
594/2	X-3-RR-HSR, 104-RR-HSR	MADISON	16	7
CONTRACT NO. 76J51				
ILLINOIS FED. AID PROJECT				

D876J51-shi007-seq.dgn 5/25/2016 12:39:13 PM

# RAILROAD PREEMPTION SEQUENCE OF OPERATION

	PREEMPTOR NUMBER 2																
CHANGE FROM NORMAL SEQUENCE OF OPERATION INTERVAL NUMBER	1		5		7		9		13		15		2	3	4	5	CLEAR TO NORMAL SEQUENCE
RAILROAD PREEMPTION SEQUENCE OF OPERATION INTERVAL NUMBER	1A	1B	1C	1D	1E	1F	1G	1H	1J	1K	1L	1M	2	3	4	5	
CHANGE TO RAILROAD PREEMPTION SEQUENCE OF OPERATION INTERVAL NUMBER	1B	2	1D	2	1F	2	1H	2	1K	2	1M	2	3	4	5	5	
ILLINOIS ROUTE 203 FAR LEFT AND LEFT POST MOUNTED SIGNALS SW/B	Y ←	R	Y ←	R	R	R	R	R	R	R	R	R	R	R	R	R	△
ILLINOIS ROUTE 203 LEFT AND RIGHT MAST ARM AND NEAR RIGHT SIGNALS SW/B	R	R	Y	R	R	R	Y	R	R	R	R	R	R	R	R	G	△
ILLINOIS ROUTE 203 FAR LEFT AND LEFT POST MOUNTED SIGNALS NE/B	Y ←	R	R	R	Y ←	R	R	R	R	R	R	R	R	R	R	R	△
ILLINOIS ROUTE 203 LEFT AND RIGHT MAST ARM AND NEAR RIGHT SIGNALS NE/B	R	R	R	R	Y	R	Y	R	R	R	R	R	R	R	R	G	△
MARYVILLE ROAD FAR LEFT AND LEFT MAST ARM SIGNALS NW/B	R	R	R	R	R	R	R	R	R	R	Y	R	R	R	R	R	△
MARYVILLE ROAD RIGHT MAST ARM AND NEAR RIGHT SIGNALS NW/B	R	R	R	R	R	R	R	R	R	R	Y	R	R	R	R	R	△
MARYVILLE ROAD (PRE-SIGNAL) ALL SIGNALS SE/B	R	R	R	R	R	R	R	R	Y	R	R	R	R	R	R	R	△
MARYVILLE ROAD (EAST OF TRACKS) FAR LEFT AND LEFT MAST ARM SIGNALS SE/B	R	R	R	R	R	R	R	R	G ←	G ←	R	R	G ←	Y	R	R	△
MARYVILLE ROAD (EAST OF TRACKS) RIGHT MAST ARM AND NEAR RIGHT SIGNALS SE/B	R	R	R	R	R	R	R	R	G	G	R	R	G	Y	R	R	△
INTERNALLY ILLUMINATED NO RIGHT TURN SIGNS	NRT	NRT	NRT	NRT	NRT	NRT	NRT	NRT	NRT	NRT	NRT	NRT	NRT	NRT	NRT	NRT	△

HOLD

\* THE RAILROAD PREEMPTION SEQUENCE SHALL BE CAPABLE OF CYCLING BETWEEN PHASES 4, 2+5, AND 2+6 UNTIL PREEMPTION IS TERMINATED.

**NOTES:**

1. ONCE PREEMPTION HAS BEEN CALLED, THE TRACK CLEAR SIGNAL DISPLAY SHALL APPEAR IMMEDIATELY AFTER ALL NECESSARY VEHICULAR CLEARANCES HAVE BEEN PROVIDED.
2. THE RAILROAD PREEMPTION SEQUENCE OF OPERATION SHALL HAVE PRIORITY OVER ALL OTHER SEQUENCES OF OPERATION.

△ RAILROAD PREEMPTION SEQUENCE SHALL PROVIDE THE PROPER CLEARANCE INTERVAL TO RESUME THE NORMAL SEQUENCE OF OPERATION AFTER RAILROAD INTERVAL 5 IS TERMINATED.

FILE NAME = \$FILES\*



USER NAME = \$USER*	DESIGNED - MJL	REVISED -
	DRAWN - MJL	REVISED -
PLOT SCALE = \$SCALE*	CHECKED - JAL	REVISED -
PLOT DATE = \$DATE*	DATE - 5/31/16	REVISED -

**STATE OF ILLINOIS  
DEPARTMENT OF TRANSPORTATION**

**RAILROAD PREEMPTION SEQUENCE OF OPERATION  
MARYVILLE ROAD AND ILLINOIS ROUTE 203**

SCALE: NTS    SHEET 1 OF 1 SHEETS    STA.    TO STA.

F.A.P. RTE.	SECTION	COUNTY	TOTAL SHEETS	SHEET NO.
594/2	X-3-RR-HSR, 104-RR-HSR	MADISON	16	8
CONTRACT NO. 76J51				
ILLINOIS FED. AID PROJECT				

D876J51-shi008-rseq.dgn 5/25/2016 12:40:43 PM



**PAVEMENT MARKINGS LEGEND**

- ① THERMOPLASTIC PAVEMENT MARKING  
-LINE 4" (DOUBLE YELLOW, 11" C-C)
- ② THERMOPLASTIC PAVEMENT MARKING  
-LINE 24" (SOLID WHITE STOP BAR)
- ③ THERMOPLASTIC PAVEMENT MARKING  
-LINE 4" (SOLID WHITE)
- ④ THERMOPLASTIC PAVEMENT MARKING  
-LETTER AND SYMBOLS (WHITE)
- ⑤ THERMOPLASTIC PAVEMENT MARKING  
-LINE 6" (WHITE DIAGONALS, 8' C-C)
- ⑥ THERMOPLASTIC PAVEMENT MARKING  
-LINE 8" (SOLID WHITE)



W10-1  
36 DIA  
94+88

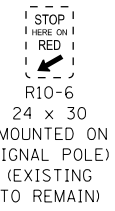

R10-6  
24 x 30  
(MOUNTED ON  
SIGNAL POLE)  
(EXISTING  
TO REMAIN)



R8-8  
24 x 30  
(MOUNTED ON  
SIGNAL POLE)  
97+23

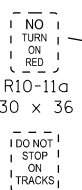

R10-11a  
30 x 36  
(MOUNTED ON  
MAST ARM POLE)  
(EXISTING  
TO REMAIN)

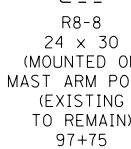

R8-8  
24 x 30  
(MOUNTED ON  
MAST ARM POLE)  
(EXISTING  
TO REMAIN)

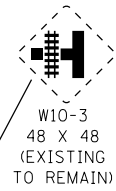

W10-3  
48 X 48  
(EXISTING  
TO REMAIN)

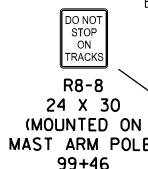

R8-8  
24 X 30  
(MOUNTED ON  
MAST ARM POLE)  
99+46

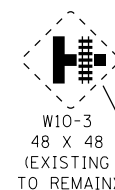

W10-3  
48 X 48  
(EXISTING  
TO REMAIN)

EXIST. CURVE C1  
PI STA. = 94+57.28 (N 759477.3846, E 2314475.1548)  
Δ = 19° 47' 00" (LT)  
D = 6° 19' 59"  
R = 904.72'  
T = 157.76'  
L = 312.39'  
E = 13.65'  
e = ----  
T.R. = ----  
S.E. RUN = ----  
P.C. STA. = 92+99.52 (N 759635.1426, E 2314476.4481)  
P.T. STA. = 96+11.91 (N 759328.4998, E 2314527.3333)

**BENCHMARK #1**

CHISELED "□" IN MIDDLE OF MEDIAN DIVIDING THE NORTHBOUND LANES OF IL RTE 203 AND TURN LANE FOR SOUTHBOUND TO MARYVILLE RD. EAST OF TURN ARROW AND APPROXIMATELY 30 FT NORTHWEST OF QEI #2.  
ELEVATION = 425.686, 11.26' RT STA 153+26.38  
N 759025.8, E 2314734.1

NOTE:  
SEE SHEET 2 OF 2 FOR SCHEDULES

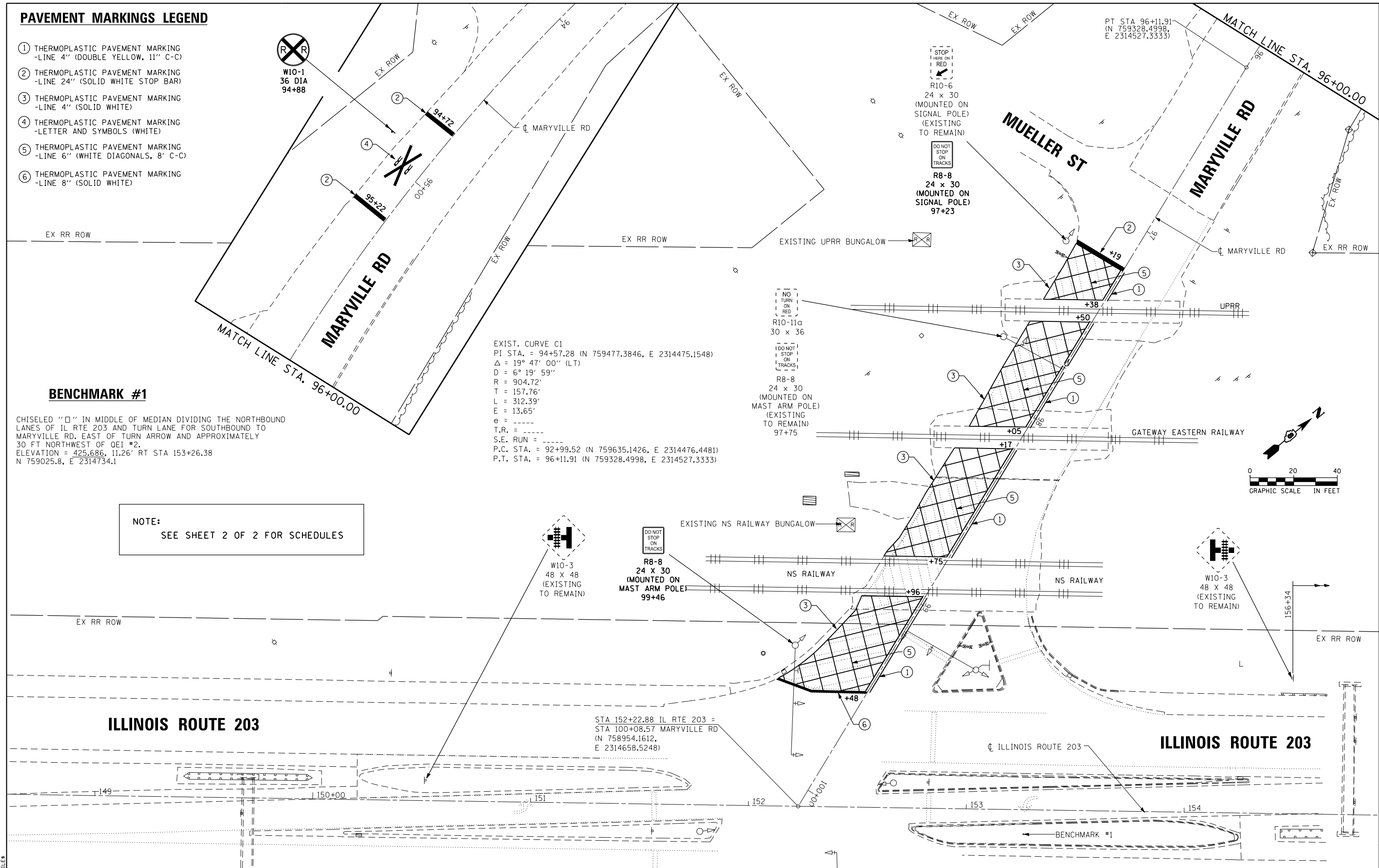
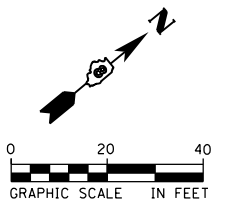

USER NAME = *USER*	DESIGNED - ACW	REVISED -
DRAWN - SRS	REVISED -	
CHECKED - MJL	REVISED -	
DATE - 05/31/16	REVISED -	

STATE OF ILLINOIS  
DEPARTMENT OF TRANSPORTATION

SIGNING AND PAVEMENT MARKING PLAN  
MARYVILLE ROAD AND ILLINOIS ROUTE 203  
SCALE: 1" = 20'  
SHEET 1 OF 2 SHEETS STA. TO STA.

F.A.P. RTE. 594/2	SECTION X-3-RR-HSR, 104-RR-HSR	COUNTY MADISON	TOTAL SHEETS 16	SHEET NO. 9
CONTRACT NO. 76J51				
ILLINOIS FED. AID PROJECT				

D876J51-shi009-pmk.dgn 5/25/2016 12:42:22 PM

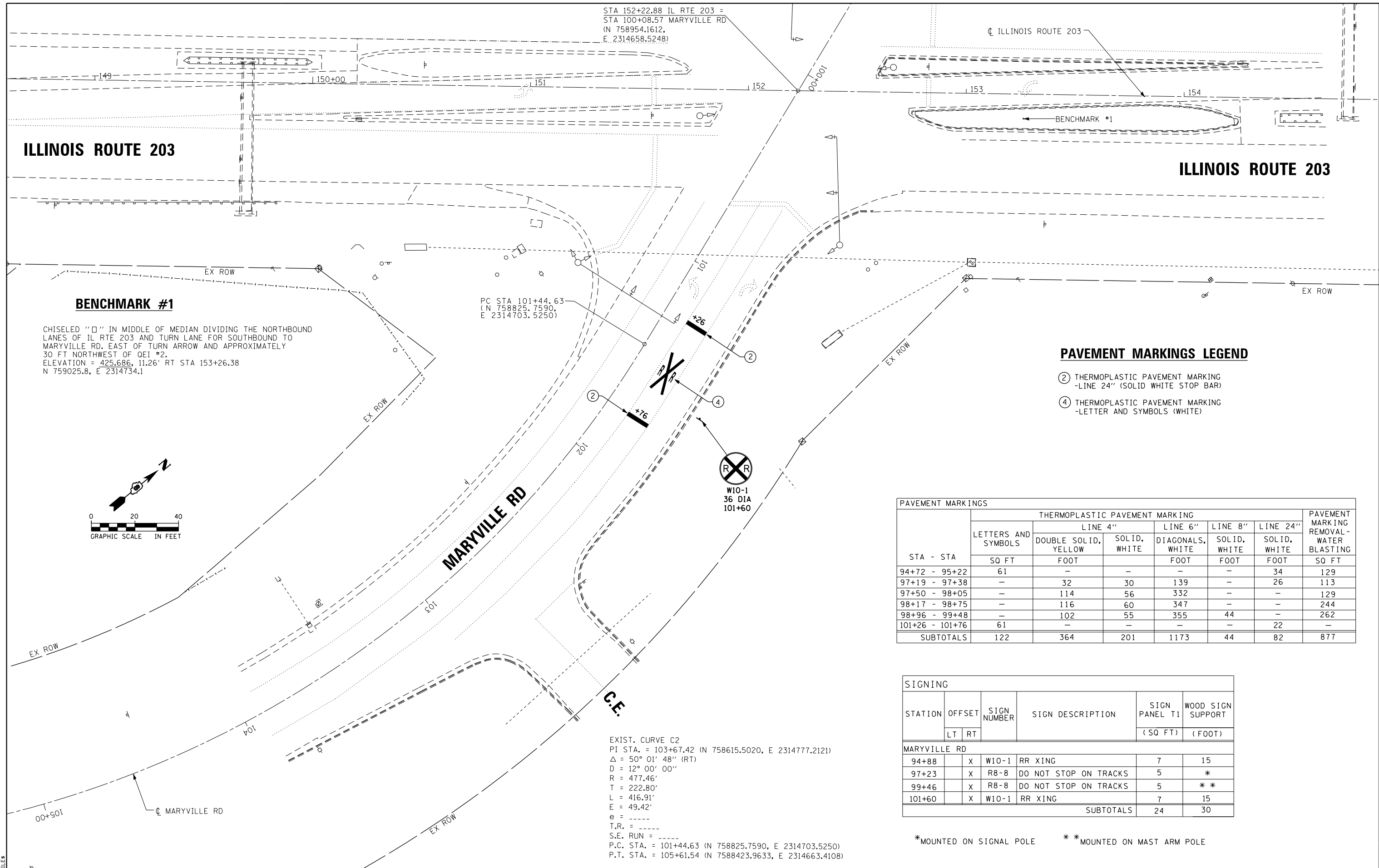

**ILLINOIS ROUTE 203**

**ILLINOIS ROUTE 203**

**BENCHMARK #1**

CHISELED "□" IN MIDDLE OF MEDIAN DIVIDING THE NORTHBOUND LANES OF IL RTE 203 AND TURN LANE FOR SOUTHBOUND TO MARYVILLE RD. EAST OF TURN ARROW AND APPROXIMATELY 30 FT NORTHWEST OF OEI #2.  
ELEVATION = 425.686, 11.26' RT STA 153+26.38  
N 759025.8, E 2314734.1

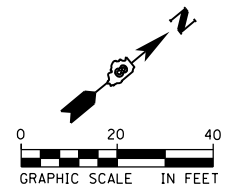

**PAVEMENT MARKINGS LEGEND**

- ② THERMOPLASTIC PAVEMENT MARKING  
-LINE 24" (SOLID WHITE STOP BAR)
- ④ THERMOPLASTIC PAVEMENT MARKING  
-LETTER AND SYMBOLS (WHITE)

STA - STA	LETTERS AND SYMBOLS SQ FT	THERMOPLASTIC PAVEMENT MARKING					PAVEMENT MARKING REMOVAL - WATER BLASTING SQ FT
		LINE 4"		LINE 6"	LINE 8"	LINE 24"	
		DOUBLE SOLID, YELLOW FOOT	SOLID, WHITE FOOT	DIAGONALS, WHITE FOOT	SOLID, WHITE FOOT	SOLID, WHITE FOOT	
94+72 - 95+22	61	-	-	-	-	34	129
97+19 - 97+38	-	32	30	139	-	26	113
97+50 - 98+05	-	114	56	332	-	-	129
98+17 - 98+75	-	116	60	347	-	-	244
98+96 - 99+48	-	102	55	355	44	-	262
101+26 - 101+76	61	-	-	-	-	22	-
<b>SUBTOTALS</b>	<b>122</b>	<b>364</b>	<b>201</b>	<b>1173</b>	<b>44</b>	<b>82</b>	<b>877</b>

SIGNING						
STATION	OFFSET		SIGN NUMBER	SIGN DESCRIPTION	SIGN PANEL T1 (SQ FT)	WOOD SIGN SUPPORT (FOOT)
	LT	RT				
<b>MARYVILLE RD</b>						
94+88	X		W10-1	RR XING	7	15
97+23	X		R8-8	DO NOT STOP ON TRACKS	5	*
99+46	X		R8-8	DO NOT STOP ON TRACKS	5	**
101+60	X		W10-1	RR XING	7	15
<b>SUBTOTALS</b>					<b>24</b>	<b>30</b>

\* MOUNTED ON SIGNAL POLE      \*\* MOUNTED ON MAST ARM POLE

STA 152+22.88 IL RTE 203 =  
STA 100+08.57 MARYVILLE RD  
(N 758954.1612, E 2314658.5248)

PC STA 101+44.63  
(N 758825.7590, E 2314703.5250)

W10-1  
36 DIA  
101+60

EXIST. CURVE C2  
PI STA. = 103+67.42 (N 758615.5020, E 2314777.2121)  
Δ = 50° 01' 48" (RT)  
D = 12° 00' 00"  
R = 477.46'  
T = 222.80'  
L = 416.91'  
E = 49.42'  
e = ----  
T.R. = ----  
S.E. RUN = ----  
P.C. STA. = 101+44.63 (N 758825.7590, E 2314703.5250)  
P.T. STA. = 105+61.54 (N 7588423.9633, E 2314663.4108)



USER NAME = \$USER*	DESIGNED - ACW	REVISED -
PLOT SCALE = \$SCALE*	DRAWN - SRS	REVISED -
PLOT DATE = \$DATE*	CHECKED - MJL	REVISED -
	DATE - 05/31/16	REVISED -

**STATE OF ILLINOIS  
DEPARTMENT OF TRANSPORTATION**

**SIGNING AND PAVEMENT MARKING PLAN  
MARYVILLE ROAD AND ILLINOIS ROUTE 203**

SCALE: 1" = 20'      SHEET 2 OF 2 SHEETS      STA. TO STA.

F.A.P. RTE.	SECTION	COUNTY	TOTAL SHEETS	SHEET NO.
594/2	X-3-RR-HSR, 104-RR-HSR	MADISON	16	10
CONTRACT NO. 76J51				
ILLINOIS FED. AID PROJECT				

# TRAFFIC SIGNAL GENERAL NOTES

- IT SHALL BE THE CONTRACTOR'S RESPONSIBILITY TO VERIFY ALL DIMENSIONS AND CONDITIONS EXISTING IN THE FIELD
- PRIOR TO ORDERING MATERIALS AND BEGINNING CONSTRUCTION, THE EXACT LOCATION OF ALL UTILITIES SHALL BE FIELD VERIFIED BY THE CONTRACTOR BEFORE ORDERING ANY MATERIALS AND STARTING ANY WORK. FOR LOCATIONS OF UTILITIES, LOCALLY OWNED EQUIPMENT, AND IDOT UNDERGROUND FACILITIES, CONTACT THE LOCAL COUNTIES, MUNICIPALITIES AND IDOT FOR LOCATES. THE CONTRACTOR SHALL CALL 'JULIE' AT (800) 892-0123. THE CONTRACTOR SHALL CALL THE UNION PACIFIC (UPRR) "CALL BEFORE YOU DIG" OPERATION AT 1-800-336-9193 FOR FIELD LOCATIONS OF UNION PACIFIC OWNED BURIED FIBER OPTIC CABLES IN UNION PACIFIC RIGHT OF WAY.
- CONTRACTOR SHALL COORDINATE WITH NORFOLK SOUTHERN (NS) RAILROAD BEFORE STARTING ANY WORK ON NS PROPERTY. CONTRACTOR SHALL BE RESPONSIBLE FOR OBTAINING AND FOLLOWING CURRENT SPECIFICATIONS FOR PIPELINE OCCUPANCY OF NORFOLK SOUTHERN CORPORATION PROPERTY.
- THE CONTRACTOR SHALL COORDINATE CONSTRUCTION ACTIVITIES WITH UTILITY COMPANIES, LOCAL GOVERNMENT AGENCIES, IDOT, THE UPRR, AND NS RAILWAY.
- COORDINATE ALL WORK WITH THE RAILROAD FORCES. SEE SPECIAL PROVISION "RAILROAD COORDINATION AND FLAGGERS."
- THE ILLINOIS DEPARTMENT OF TRANSPORTATION SHALL BE NOTIFIED AT LEAST 72 HOURS PRIOR TO THE REPLACING OF AND TURNING ON OF THE UPGRADED CONTROLLER UNIT.
- THE CONTRACTOR IS RESPONSIBLE FOR THE COST OF UNCOVERING OR HAND DIGGING AROUND UTILITIES, AS NECESSARY; COST TO BE INCLUDED WITH THE CONDUIT PAY ITEM.
- CONTRACTOR SHALL PROVIDE A SELF-ADHERED PHASE DIAGRAM ON THE INSIDE OF THE CONTROLLER CABINET DOOR.
- PROPOSED UNDERGROUND CONDUIT SHALL AVOID UNDERGROUND UTILITIES.
- RAILROAD, FULL-ACTUATED CONTROLLER AND TYPE IV CABINET, SPECIAL SHALL INCLUDE VEHICLE DETECTOR AMPS, REMOTE MONITORING, AND AN INTERSECTION MONITOR.
- IT SHALL BE THE CONTRACTOR'S RESPONSIBILITY TO MAINTAIN THE EXISTING TRAFFIC SIGNAL INSTALLATION DURING THE WORK.
- CONDUIT UNDER THE RAILROAD TRACKS SHALL BE INSTALLED IN ACCORDANCE WITH THE UNION PACIFIC RAILROAD WIRELINE INSTALLATION ENGINEERING SPECIFICATIONS FOR DIRECTIONAL DRILLING. IN ADDITION, ALL OTHER APPLICABLE UNION PACIFIC RAILROAD SPECIFICATIONS SHALL BE MET.

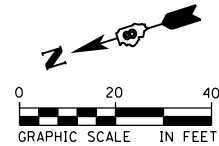

- UNINTERRUPTIBLE POWER SUPPLY IN CABINET
- REMOVE EXISTING TRAFFIC CONTROLLER AND CABINET
- MODIFY EXISTING CONTROLLER FOUNDATION
- RAILROAD, FULL-ACTUATED CONTROLLER AND TYPE IV CABINET, SPECIAL

THE FOLLOWING ITEMS SHALL BE REMOVED BY THE CONTRACTOR AND SHALL REMAIN THE PROPERTY OF THE AGENCY LISTED BELOW. THE CONTRACTOR SHALL SAFELY STORE AND ARRANGE FOR THE PICK UP OF ALL EQUIPMENT TO BE RETURNED TO THE LISTED AGENCY AS PER THE SPECIAL PROVISION.

AGENCY: ILLINOIS DEPARTMENT OF TRANSPORTATION DISTRICT 8  
1 EACH CONTROLLER AND CABINET (COMPLETE)

NOTE:  
ALL TRAFFIC SIGNAL CONTROLLER EQUIPMENT FOR THIS PROJECT SHALL BE "ECONOLITE".

RESTORATION OF WORK AREA. RESTORATION OF THE TRAFFIC SIGNAL WORK AREA SHALL BE INCLUDED WITH THE RELATED PAY ITEM SUCH AS MODIFY EXISTING CONTROLLER FOUNDATION, CONDUIT, ETC., AND NO EXTRA COMPENSATION SHALL BE ALLOWED. ALL ROADWAY SURFACES SUCH AS SHOULDERS, MEDIANS, SIDEWALKS, PAVEMENT, ETC. SHALL BE REPLACED IN KIND. ALL DAMAGE TO MOWED LAWNS SHALL BE REPLACED WITH AN APPROVED SOD, AND ALL DAMAGE TO UNMOWED FIELDS SHALL BE SEEDED IN ACCORDANCE WITH STANDARD SPECIFICATIONS 252 AND 250 RESPECTIVELY.

STAGING OF RAILROAD INTERCONNECT WORK. THE EXISTING RAILROAD INTERCONNECT WILL BE MAINTAINED THROUGHOUT THE WORK. ONCE THE NEW RAILROAD INTERCONNECT CONDUIT HAS BEEN INSTALLED TO THE BUNGALOW, A NEW RAILROAD INTERCONNECT CABLE WILL BE INSTALLED FROM THE NEW CONTROLLER TO THE RAILROAD BUNGALOW AS SHOWN.

ANY DAMAGE DONE TO THE EXISTING SIGNAL ITEMS OR APPURTENANCES SHALL BE REPAIRED OR REPLACED BY THE CONTRACTOR, PER SECTION 895.02 OF THE STANDARD SPECIFICATIONS.

## ILLINOIS ROUTE 3

## BISSELL AVE

STATE OF ILLINOIS  
DEPARTMENT OF TRANSPORTATION

TRAFFIC SIGNAL MODIFICATION PLAN  
BISSELL AVENUE AND ILLINOIS ROUTE 3

SCALE: 1" = 20' SHEET 1 OF 1 SHEETS STA. TO STA.

### TRAFFIC SIGNAL LEGEND

- PROPOSED CONTROLLER
- EXISTING SERVICE INSTALLATION (POLE MTD.)
- EXISTING SIGNAL HEAD
- PROPOSED HANDHOLE
- EXISTING SIGNAL HEAD WITH BACKPLATE
- EXISTING TRAFFIC SIGNAL POST, PAINTED STEEL
- EXISTING STEEL MAST ARM ASSEMBLY AND POLE
- EXISTING HANDHOLE
- EXISTING DOUBLE HANDHOLE
- EXISTING UNDERGROUND CONDUIT
- PROPOSED UNDERGROUND CONDUIT
- RAILROAD CONTROL CABINET (EXISTING)
- UNINTERRUPTIBLE POWER SUPPLY
- EXISTING ILLUMINATED SIGN
- PROPOSED L.E.D. BLANK OUT SIGN

FILE NAME: \$FILES

**AECOM**

USER NAME: \$USER*	DESIGNED: KMO	REVISED: -
PLOT SCALE: \$SCALE*	DRAWN: SRS	REVISED: -
PLOT DATE: \$DATE*	CHECKED: MJL	REVISED: -
	DATE: 05/31/16	REVISED: -

F.A.P. RTE.	SECTION	COUNTY	TOTAL SHEETS	SHEET NO.
594/2	X-3-RR-HSR, 104-RR-HSR	MADISON	16	11
CONTRACT NO. 76J51				
ILLINOIS FED. AID PROJECT				

D876J51-shi011-signal plan.dgn 5/31/2016 12:37:24 PM

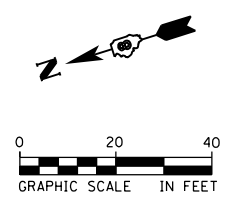

NEW CABLE (NO. 14, 3C)  
RAILROAD INTERCONNECT

2/C #6AWG  
DIAL-UP TELEPHONE

CONTROLLER

REPLACE EXISTING ILLUMINATED "NO RIGHT TURN" SIGN  
WITH L.E.D. R3-1 NO RIGHT TURN SYMBOL BLANK OUT SIGN

ILLINOIS ROUTE 3

ILLINOIS ROUTE 3

BISSELL AVE

BISSELL AVE

NS RAILWAY

UPRR

**TRAFFIC SIGNAL LEGEND**

- P EXISTING SERVICE INSTALLATION (POLE MTD.)
- 2/C INDICATES NUMBER OF CONDUCTORS IN CABLE
- LD-IN ELECTRIC CABLE LEAD-IN 1 PAIR
- #6 INDICATES AMERICAN WIRE GAUGE (AWG) SIZE 6 CONDUCTORS
- ELECTRIC CABLE IN CONDUIT
- - - EXISTING ELECTRIC CABLE IN CONDUIT

FILE NAME: #FILES



USER NAME = #USER*	DESIGNED - KMO	REVISED -
DRAWN - SRS	REVISED -	
CHECKED - MJL	REVISED -	
DATE - 05/31/16	REVISED -	

STATE OF ILLINOIS  
DEPARTMENT OF TRANSPORTATION

TRAFFIC SIGNAL CABLE PLAN  
BISSELL AVENUE AND ILLINOIS ROUTE 3

SCALE: 1" = 20' SHEET 1 OF 1 SHEETS STA. TO STA.

F.A.P. RTE.	SECTION	COUNTY	TOTAL SHEETS	SHEET NO.
594/2	X-3-RR-HSR, 104-RR-HSR	MADISON	16	12
CONTRACT NO. 76J51				
ILLINOIS FED. AID PROJECT				

D876J51-shit012-cable plan.dgn 5/26/2016 2:30:53 PM

# SEQUENCE OF OPERATION

MOVEMENT	5		2 5			1 6			2 6								3				4					FLASH										
	1 + 5		2 + 5			1 + 6			2 + 6								3				4															
PHASE	1 + 5		2 + 5			1 + 6			2 + 6								3				4															
INTERVAL	1	2A	2B	3A	3B	4A	4B	5	6A	6B	7	8A	8B	9	10A	10B	11A	11B	12A	12B	13A	13B	14A	14B	15	16A	16B	16C	16D	17	18A	18B	19A	19B		
CHANGE TO	2 + 5		1 + 6			2 + 6			2 + 6			2 + 6			1 + 5			2 + 5		1 + 6			3		4		1 + 5, 1 + 6 2 + 5, 2 + 6, 4				1 + 5 1 + 6		2 + 5 2 + 6			
ILLINOIS ROUTE 3 FAR LEFT AND LEFT POST MOUNTED SIGNALS S/B	G	G	G	Y	R	Y	R	G	Y	R	R	R	R	R	R	R	R	R	R	R	R	R	R	R	R	R	R	R	R	R	R	R	R	R	R	
ILLINOIS ROUTE 3 LEFT AND RIGHT MAST ARM SIGNALS S/B	R	R	R	R	R	R	R	G	G	G	R	R	R	G	Y	R	G	G	Y	R	Y	R	Y	R	R	R	R	R	R	R	R	R	R	R	R	
ILLINOIS ROUTE 3 FAR RIGHT AND NEAR RIGHT SIGNALS S/B	R	R	R	R	R	R	R	G	G	G	R	R	R	G	Y	R	G	G	Y	R	Y	R	Y	R	Y	R	R	R	R	R	R	R	R	R	R	
ILLINOIS ROUTE 3 FAR LEFT AND LEFT POST MOUNTED SIGNALS N/B	G	Y	R	G	G	Y	R	R	R	R	G	Y	R	R	R	R	R	R	R	R	R	R	R	R	R	R	R	R	R	R	R	R	R	R	R	
ILLINOIS ROUTE 3 LEFT AND RIGHT MAST ARM AND NEAR RIGHT SIGNALS N/B	R	R	R	R	R	R	R	R	R	R	G	G	G	G	Y	R	Y	R	G	G	Y	R	Y	R	R	R	R	R	R	R	R	R	R	R	R	
BISSELL AVENUE FAR LEFT SIGNAL E/B	R	R	R	R	R	R	R	R	R	R	R	R	R	R	R	R	R	R	R	R	R	R	R	R	R	R	R	R	R	R	R	R	R	R	R	
BISSELL AVENUE FAR RIGHT AND NEAR RIGHT SIGNALS E/B	R	Y	R	R	R	Y	R	R	R	R	R	Y	R	R	R	R	R	R	R	R	R	R	R	R	R	R	R	R	R	R	R	R	R	R	R	
BISSELL AVENUE (PRE-SIGNAL) ALL SIGNALS W/B	R	R	R	R	R	R	R	R	R	R	R	R	R	R	R	R	R	R	R	R	R	R	R	R	R	R	R	R	R	R	R	R	R	R	R	
BISSELL AVENUE (WEST OF TRACKS) FAR LEFT SIGNAL W/B	R	R	R	R	R	R	R	R	R	R	R	R	R	R	R	R	R	R	R	R	R	R	R	R	R	R	R	R	R	R	R	R	R	R	R	
BISSELL AVENUE (WEST OF TRACKS) FAR RIGHT AND NEAR RIGHT SIGNALS W/B	R	R	R	R	R	R	R	R	R	R	R	R	R	R	R	R	R	R	R	R	R	R	R	R	R	R	R	R	R	R	R	R	R	R	R	

PHASES 2 AND 6 SHALL BE PLACED ON RECALL.

FILE NAME = \$FILES



USER NAME = \$USER*	DESIGNED - MJL	REVISED -
DRAWN - MJL	REVISIONS -	
PLOT SCALE = \$SCALE*	CHECKED - JAL	REVISED -
PLOT DATE = \$DATE*	DATE - 05/31/16	REVISED -

**STATE OF ILLINOIS  
DEPARTMENT OF TRANSPORTATION**

**TRAFFIC SIGNAL SEQUENCE OF OPERATION  
BISSELL AVENUE AND ILLINOIS ROUTE 3**

SCALE: NTS      SHEET 1 OF 1 SHEETS      STA.      TO STA.

F.A.P. RTE.	SECTION	COUNTY	TOTAL SHEETS	SHEET NO.
594/2	X-3-RR-HSR, 104-RR-HSR	MADISON	16	13
CONTRACT NO. 76J51				
ILLINOIS FED. AID PROJECT				

D876J51-shi013-seq.dgn 5/25/2016 12:53:03 PM

# RAILROAD PREEMPTION SEQUENCE OF OPERATION

	PREEMPTOR NUMBER 2																
CHANGE FROM NORMAL SEQUENCE OF OPERATION INTERVAL NUMBER	1		5		7		9		15		17		2	3	4	5	CLEAR TO NORMAL SEQUENCE
RAILROAD PREEMPTION SEQUENCE OF OPERATION INTERVAL NUMBER	1A	1B	1C	1D	1E	1F	1G	1H	1L	1M	1N	1P	2	3	4	5	
CHANGE TO RAILROAD PREEMPTION SEQUENCE OF OPERATION INTERVAL NUMBER	1B	2	1D	2	1F	2	1H	2	1M	2	1P	2	3	4	5	5	
ILLINOIS ROUTE 3 FAR LEFT AND LEFT POST MOUNTED SIGNALS S/B	Y ←	R	Y ←	R	R	R	R	R	R	R	R	R	R	R	R	R	△
ILLINOIS ROUTE 3 LEFT AND RIGHT MAST ARM SIGNALS S/B	R	R	Y	R	R	R	Y	R	R	R	R	R	R	R	R	G	△
ILLINOIS ROUTE 3 FAR RIGHT AND NEAR RIGHT SIGNALS S/B	R	R	Y →	R	R	R	Y →	R	R	R	R	R	R	R	R	G	△
ILLINOIS ROUTE 3 FAR LEFT AND LEFT POST MOUNTED SIGNALS N/B	Y ←	R	R	R	Y ←	R	R	R	R	R	R	R	R	R	R	R	△
ILLINOIS ROUTE 3 LEFT AND RIGHT MAST ARM AND NEAR RIGHT SIGNALS N/B	R	R	R	R	Y	R	Y	R	R	R	R	R	R	R	R	G	△
BISSELL AVENUE FAR LEFT SIGNAL E/B	R	R	R	R	R	R	R	R	R	R	Y	R	R	R	R	R	△
BISSELL AVENUE FAR RIGHT AND NEAR RIGHT SIGNALS E/B	R →	R	R	R	R →	R	R	R	R	R	Y →	R	R	R	R	R	△
BISSELL AVENUE (PRE-SIGNAL) ALL SIGNALS W/B	R	R	R	R	R	R	R	R	Y	R	R	R	R	R	R	R	△
BISSELL AVENUE (WEST OF TRACKS) FAR LEFT SIGNAL W/B	R	R	R	R	R	R	R	R	G ←	G ←	R	R	G ←	Y	R	R	△
BISSELL AVENUE (WEST OF TRACKS) FAR RIGHT AND NEAR RIGHT SIGNALS W/B	R	R	R	R	R	R	R	R	G	G	R	R	G	Y	R	R	△
INTERNALLY ILLUMINATED NO RIGHT TURN SIGNS	NRT	NRT	NRT	NRT	NRT	NRT	NRT	NRT	NRT	NRT	NRT	NRT	NRT	NRT	NRT	NRT	△

HOLD

PHASES 2 AND 6 SHALL BE PLACED ON RECALL.

\* THE RAILROAD PREEMPTION SEQUENCE SHALL BE CAPABLE OF CYCLING BETWEEN PHASES 4, 1+6, AND 2+6 UNTIL PREEMPTION IS TERMINATED.

△ RAILROAD PREEMPTION SEQUENCE SHALL PROVIDE THE PROPER CLEARANCE INTERVAL TO RESUME THE NORMAL SEQUENCE OF OPERATION AFTER RAILROAD INTERVAL 5 IS TERMINATED.

**NOTES:**

1. ONCE PREEMPTION HAS BEEN CALLED, THE TRACK CLEAR SIGNAL DISPLAY SHALL APPEAR IMMEDIATELY AFTER ALL NECESSARY VEHICULAR CLEARANCES HAVE BEEN PROVIDED.
2. THE RAILROAD PREEMPTION SEQUENCE OF OPERATION SHALL HAVE PRIORITY OVER ALL OTHER SEQUENCES OF OPERATION.

FILE NAME = \$FILES



USER NAME = \$USER*	DESIGNED - MJL	REVISED -
	DRAWN - MJL	REVISED -
PLOT SCALE = \$SCALE*	CHECKED - JAL	REVISED -
PLOT DATE = \$DATE*	DATE - 05/31/16	REVISED -

**STATE OF ILLINOIS  
DEPARTMENT OF TRANSPORTATION**

**RAILROAD PREEMPTION SEQUENCE OF OPERATION  
BISSELL AVENUE AND ILLINOIS ROUTE 3**

SCALE: NTS    SHEET 1 OF 1 SHEETS    STA.    TO STA.

F.A.P. RTE.	SECTION	COUNTY	TOTAL SHEETS	SHEET NO.
594/2	X-3-RR-HSR, 104-RR-HSR	MADISON	16	14
CONTRACT NO. 76J51				
ILLINOIS FED. AID PROJECT				

D876J51-shit014-mseq.dgn 5/25/2016 12:54:46 PM

**EXISTING ALIGNMENT**

P. O. T. STA 38+00.00 (N 732841.5788, E 2295804.3442)

**BENCHMARK #2**

CHISELED "□" SOUTHWEST CORNER OF METAL LIP FOR TRAFFIC SIGNAL FOUNDATION IN CENTER MEDIAN DIVIDING NORTHBOUND AND SOUTHBOUND IL RTE 3 NORTH OF BISSELL AVE AND SOUTH OF SIGNAL POST.  
ELEVATION = 422.591, STA 1727+00  
N 733262.4, E 2294653.6

**NOTE:**  
SEE SHEET 2 OF 2 FOR SCHEDULES

**PAVEMENT MARKINGS LEGEND**

- ① THERMOPLASTIC PAVEMENT MARKING  
-LINE 24" (SOLID WHITE STOP BAR)
- ② THERMOPLASTIC PAVEMENT MARKING  
-LINE 4" (SOLID WHITE)
- ③ THERMOPLASTIC PAVEMENT MARKING  
-LETTER AND SYMBOLS (WHITE)
- ④ THERMOPLASTIC PAVEMENT MARKING  
-LINE 6" (WHITE DIAGONALS, 8' C-C)
- ⑤ THERMOPLASTIC PAVEMENT MARKING  
-LINE 8" (SOLID WHITE)
- ⑥ THERMOPLASTIC PAVEMENT MARKING  
-LINE 6" (SOLID WHITE)

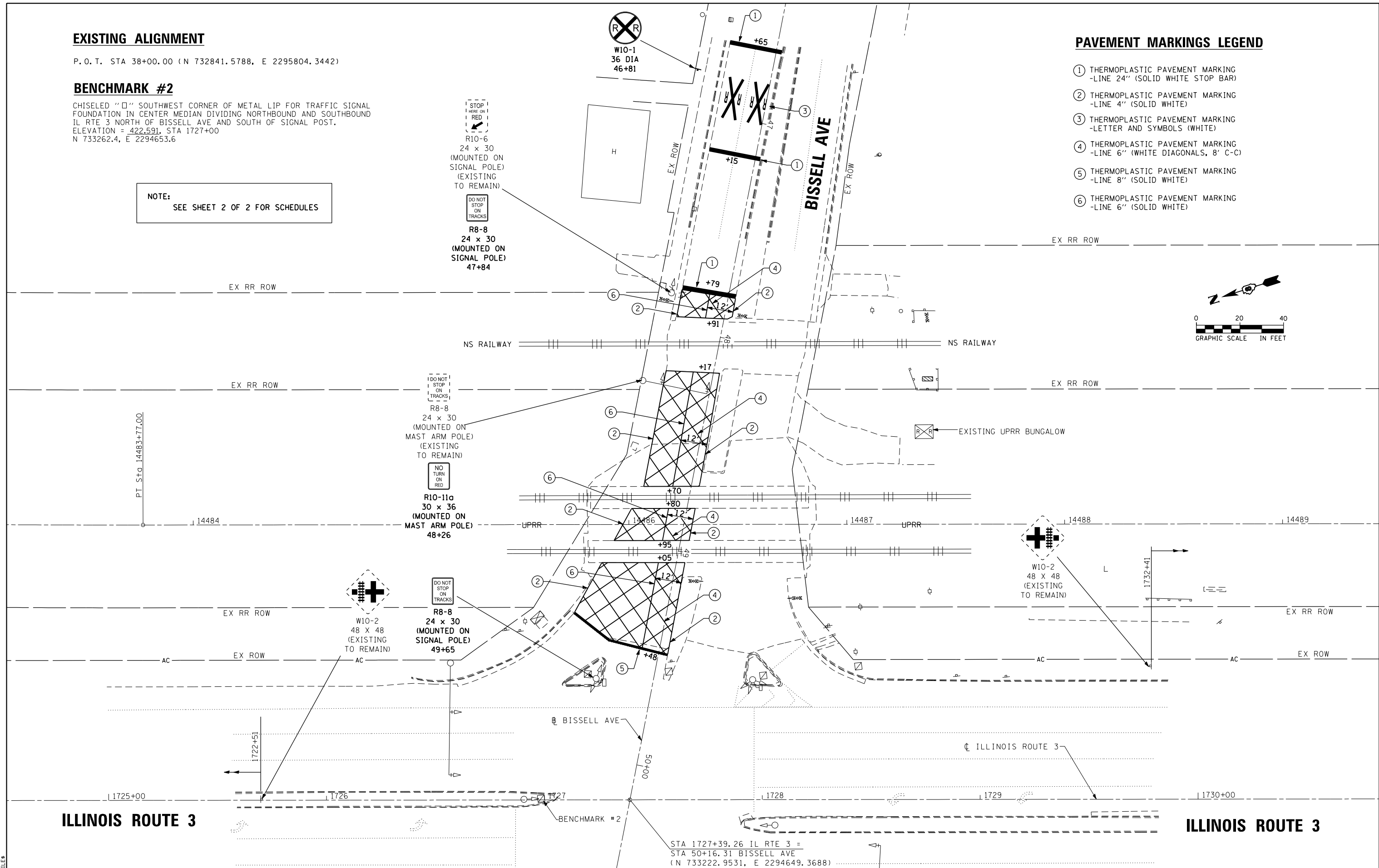
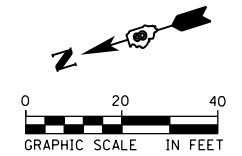

FILE NAME = \$FILES



USER NAME = \$USER*	DESIGNED - ACW	REVISED -
DRAWN - SRS	REVISOR -	
CHECKED - KMO	REVISOR -	
DATE - 05/31/16	REVISOR -	

**STATE OF ILLINOIS  
DEPARTMENT OF TRANSPORTATION**

**SIGNING AND PAVEMENT MARKING PLANS  
BISSELL AVENUE AND ILLINOIS ROUTE 3**

F.A.P. RTE. 594/2	SECTION X-3-RR-HSR, 104-RR-HSR	COUNTY MADISON	TOTAL SHEETS 16	SHEET NO. 15
CONTRACT NO. 76J51				
ILLINOIS FED. AID PROJECT				

SCALE: 1" = 20' SHEET 1 OF 2 SHEETS STA. TO STA.

D876J51-shit015-pmk.dgn 5/25/2016 1:36:46 PM

ILLINOIS ROUTE 3

ILLINOIS ROUTE 3

**PAVEMENT MARKINGS LEGEND**

- ① THERMOPLASTIC PAVEMENT MARKING  
-LINE 24" (SOLID WHITE STOP BAR)
- ③ THERMOPLASTIC PAVEMENT MARKING  
-LETTER AND SYMBOLS (WHITE)

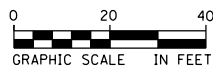

**EXISTING ALIGNMENT**

P. O. T. STA 56+00.00 (N 733405.9692, E 2294095.1124)

**BENCHMARK #2**

CHISELED "□" SOUTHWEST CORNER OF METAL LIP FOR TRAFFIC SIGNAL FOUNDATION IN CENTER MEDIAN DIVIDING NORTHBOUND AND SOUTHBOUND IL RTE 3 NORTH OF BISSELL AVE AND SOUTH OF SIGNAL POST.  
ELEVATION = 422.591, STA 1727+00  
N 733262.4, E 2294653.6

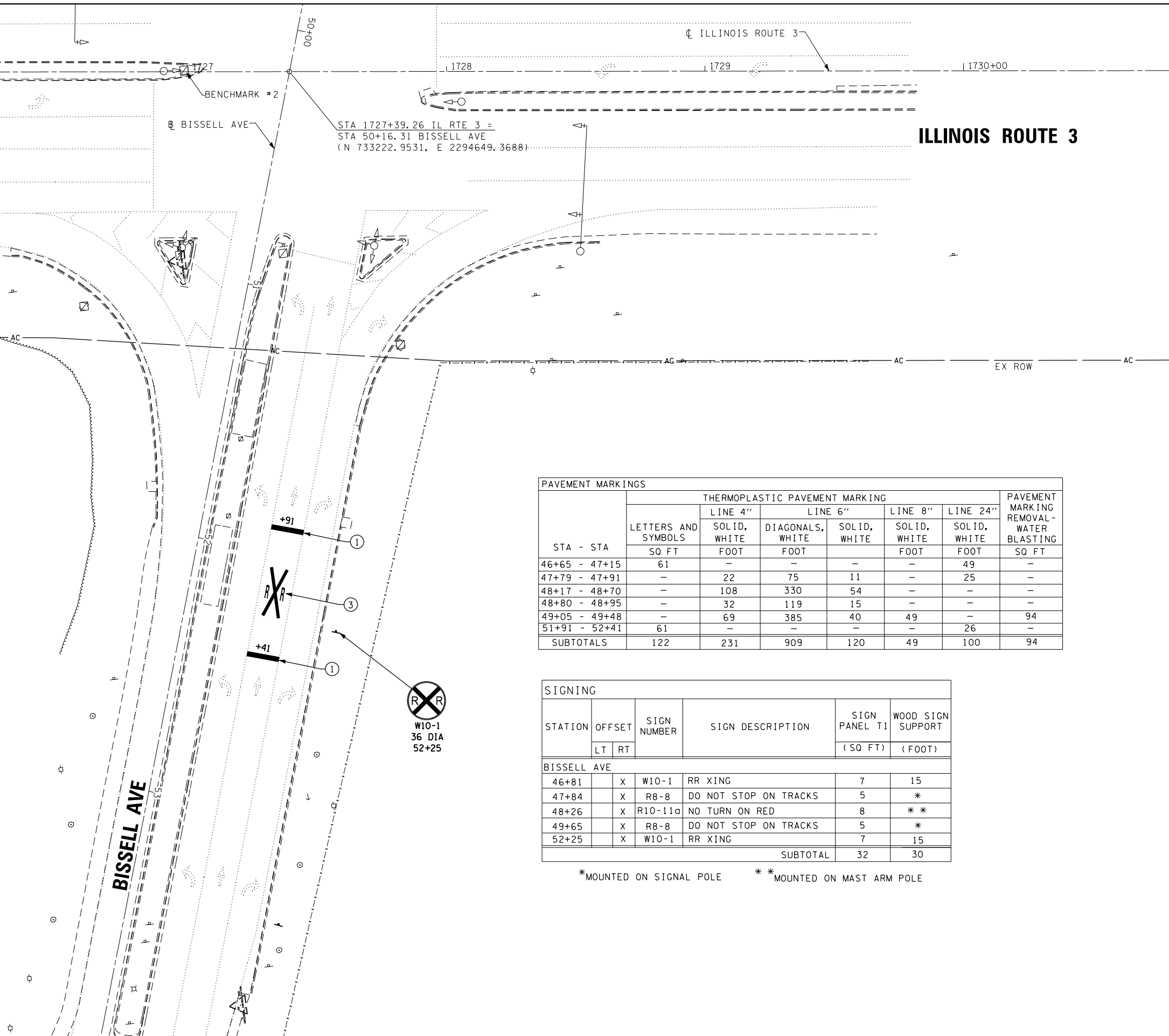

STA - STA	LETTERS AND SYMBOLS SQ FT	THERMOPLASTIC PAVEMENT MARKING					PAVEMENT MARKING REMOVAL - WATER BLASTING SQ FT
		LINE 4" SOLID, WHITE FOOT	DIAGONALS, WHITE FOOT	LINE 6" SOLID, WHITE FOOT	LINE 8" SOLID, WHITE FOOT	LINE 24" SOLID, WHITE FOOT	
46+65 - 47+15	61	-	-	-	-	49	-
47+79 - 47+91	-	22	75	11	-	25	-
48+17 - 48+70	-	108	330	54	-	-	-
48+80 - 48+95	-	32	119	15	-	-	-
49+05 - 49+48	-	69	385	40	49	-	94
51+91 - 52+41	61	-	-	-	-	26	-
<b>SUBTOTALS</b>	<b>122</b>	<b>231</b>	<b>909</b>	<b>120</b>	<b>49</b>	<b>100</b>	<b>94</b>

SIGNING						
STATION	OFFSET		SIGN NUMBER	SIGN DESCRIPTION	SIGN PANEL T1 (SO FT)	WOOD SIGN SUPPORT (FOOT)
	LT	RT				
<b>BISSELL AVE</b>						
46+81	X		W10-1	RR XING	7	15
47+84	X		R8-8	DO NOT STOP ON TRACKS	5	*
48+26	X		R10-11a	NO TURN ON RED	8	**
49+65	X		R8-8	DO NOT STOP ON TRACKS	5	*
52+25	X		W10-1	RR XING	7	15
<b>SUBTOTAL</b>					<b>32</b>	<b>30</b>

\* MOUNTED ON SIGNAL POLE      \*\* MOUNTED ON MAST ARM POLE



USER NAME = \$USER*	DESIGNED - ACW	REVISED -
PLOT SCALE = \$SCALE*	DRAWN - SRS	REVISED -
PLOT DATE = \$DATE*	CHECKED - KMO	REVISED -
	DATE - 05/31/16	REVISED -

STATE OF ILLINOIS  
DEPARTMENT OF TRANSPORTATION

SIGNING AND PAVEMENT MARKING PLANS  
BISSELL AVENUE AND ILLINOIS ROUTE 3  
SCALE: 1" = 20'    SHEET 2 OF 2 SHEETS    STA. TO STA.

F.A.P. RTE. 594/2	SECTION X-3-RR-HSR, 104-RR-HSR	COUNTY MADISON	TOTAL SHEETS 16	SHEET NO. 16
CONTRACT NO. 76J51				
ILLINOIS FED. AID PROJECT				

FILE NAME = \$FILES

D876J51-shi016-pmk.dgn 6/13/2016 12:19:46 PM