

EXISTING TYPICAL SECTION
 STA 274+91 TO STA 315+37
 STA 286+52 TO STA 289+37
 STA 302+37 TO STA 315+37

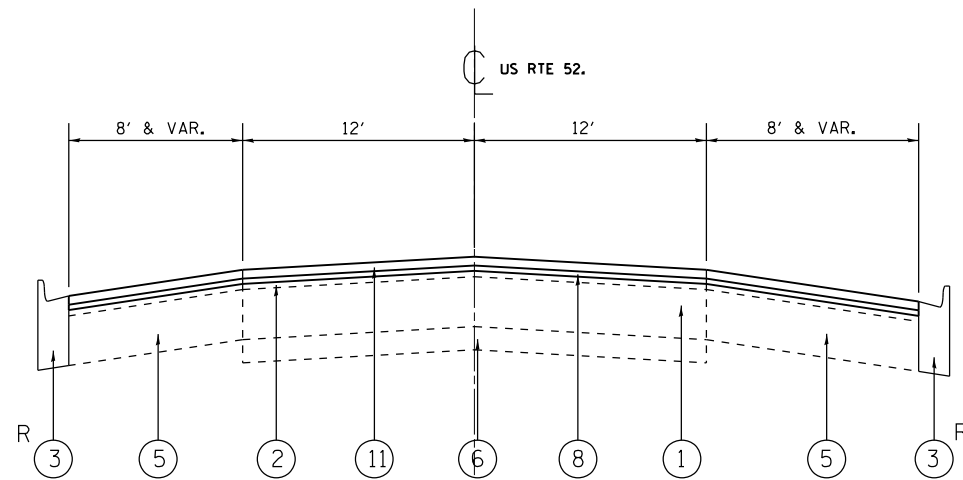

PROPOSED TYPICAL SECTION
 STA 274+91 TO STA 315+37
 STA 286+52 TO STA 289+37
 STA 302+37 TO STA 315+37

LEGEND

- ① EXISTING PCC PAVEMENT +/- 8"
- ② EXISTING HMA RESURFACING TO REMAIN +/- 9" (AFTER HEATING AND SCARIFICATION)
- ③ EXISTING COMBINATION CONCRETE CURB AND GUTTER, TYPE B-6.12
- ④ EXISTING AGGREGATE SHOULDER
- ⑤ EXISTING HMA SHOULDER
- ⑥ EXISTING STABILIZED SUB-BASE
- ⑦ PROPOSED HOT IN-PLACE RECYCLING, 1"
- ⑧ PROPOSED POLYMERIZED LEVELING BINDER (MACHINE METHOD), IL-4.75, N50, 1"
- ⑨ PROPOSED GRADING AND SHAPING SHOULDERS
- ⑩ PROPOSED AGGREGATE WEDGE SHOULDER, TYPE B
- ⑪ PROPOSED HOT-MIX ASPHALT SURFACE COURSE, MIX "D", N70, 1-1/2"

R CURB AND GUTTER REMOVAL AND REPLACEMENT (LOCATIONS TO BE DETERMINED BY THE ENGINEER)

FILE NAME =	USER NAME = Bakerom	DESIGNED -	REVISED -
ct:\pw\work\p\dot\bakerom\d0331242\0118313-shit-plan.dgn		DRAWN -	REVISED -
Default	PLOT SCALE = 100.0000' / in.	CHECKED -	REVISED -
	PLOT DATE = 6/2/2014	DATE -	REVISED -

STATE OF ILLINOIS
 DEPARTMENT OF TRANSPORTATION

US 52 (2ND STREET TO US 45)
 EXISTING AND PROPOSED TYPICAL SECTIONS

SCALE: SHEET OF SHEETS STA. TO STA.

F.A.P. RTE.	SECTION	COUNTY	TOTAL SHEETS	SHEET NO.
852	(17&18) RS-6	WILL	33	6
			CONTRACT NO. 60W12	
ILLINOIS FED. AID PROJECT				