

F.A.P. RTE. 852	SECTION (17&18) RS-6	COUNTY WILL	TOTAL SHEETS 33	SHEET NO. 1
FED. ROAD DIST. NO. 1 ILLINOIS		CONTRACT NO. 60W12		

STATE OF ILLINOIS  
DEPARTMENT OF TRANSPORTATION  
DIVISION OF HIGHWAYS

**PROPOSED  
HIGHWAY PLANS**

F.A.P. 852 U.S. ROUTE 52  
SECTION (17&18) RS-6  
2ND STREET TO U.S. ROUTE 45  
RESURFACING (3P)  
WILL COUNTY  
C-91-183-13

D-91-183-13

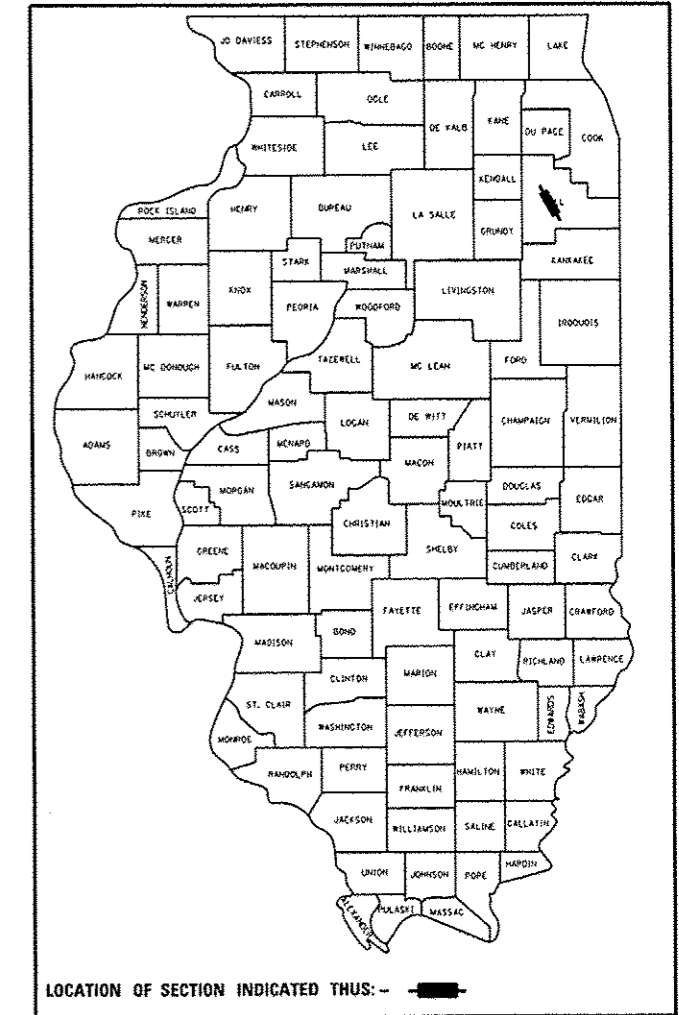

FOR INDEX OF SHEETS, SEE SHEET NO. 2

IMPROVEMENT LOCATED WITHIN  
THE VILLAGE OF MANHATTAN  
AND THE UNINCORPORATED AREA.

**TRAFFIC DATA**  
U.S. ROUTE 52  
2013 ADT = 3650  
SPEED LIMIT = 35 TO 55 MPH

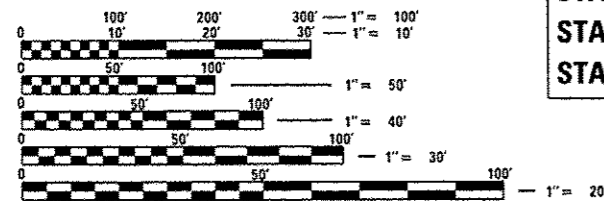

FULL SIZE PLANS HAVE BEEN PREPARED USING STANDARD  
ENGINEERING SCALES. REDUCED SIZED PLANS WILL NOT  
CONFORM TO STANDARD SCALES. IN MAKING MEASUREMENTS  
ON REDUCED PLANS, THE ABOVE SCALES MAY BE USED.

J.U.L.I.E.  
JOINT UTILITY LOCATION INFORMATION FOR EXCAVATION  
1-800-892-0123  
OR 811

IMPROVEMENT BEGINS  
STA. 12 + 73

OMISSION  
STA. 98 + 70 TO STA. 100 + 38  
STA. 270 + 24 TO STA. 272 + 12  
STA. 424 + 93 TO STA. 425 + 14

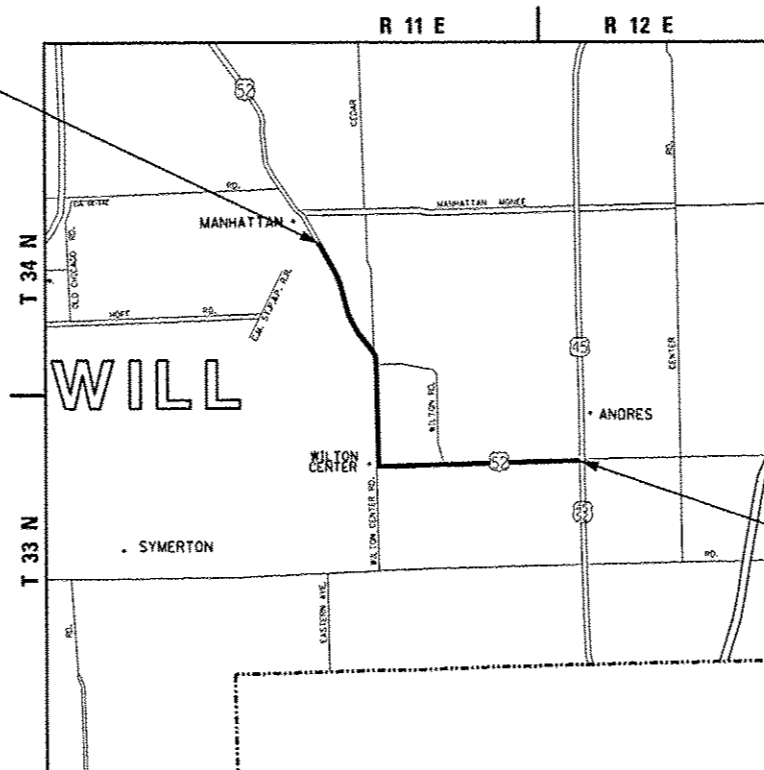

IMPROVEMENT ENDS  
STA. 494 + 45

MANHATTAN, WILTON, AND PEOTONE TOWNSHIPS  
GROSS LENGTH = 48,172 FT. = 9.12 MILES  
NET LENGTH = 47,795 FT. = 9.05 MILES

PROJECT ENGINEER: JENPAI CHANG (847) 705-4432  
PROJECT MANAGER: KEN ENG (847) 705-4247

CONTRACT NO. 60W12

STATE OF ILLINOIS  
DEPARTMENT OF TRANSPORTATION  
DIVISION OF HIGHWAYS

SUBMITTED May 29 2014

John Fortman, Jr.  
DEPUTY DIRECTOR OF HIGHWAYS, REGION ENGINEER

John D. Baranzelli, P.E.  
ENGINEER OF DESIGN AND ENVIRONMENT

Omur Osman, P.E.  
DIRECTOR OF HIGHWAYS, CHIEF ENGINEER

PRINTED BY THE AUTHORITY  
OF THE STATE OF ILLINOIS

Rev.