

STATE OF ILLINOIS  
DEPARTMENT OF TRANSPORTATION

| F.A.P. RTE. | SECTION     | COUNTY   | TOTAL SHEETS       | SHEET NO. |
|-------------|-------------|----------|--------------------|-----------|
| 360         | 2021-037-R5 | KANE     | 23                 | 1         |
|             |             | ILLINOIS | CONTRACT NO. 62N54 |           |

D-91-104-21



FOR INDEX OF SHEETS, SEE SHEET NO. 2

IMPROVEMENT IS LOCATED IN THE CITY OF  
ELGIN & VILLAGE OF EAST DUNDEE.

# PROPOSED HIGHWAY PLANS

F.A.P. ROUTE 360: IL-25 (DUNDEE AVE.)  
FROM SOUTH OF IL-72 (HIGGINS ROAD)  
TO I-90 (JANE ADAMS TOLLWAY)  
SECTION: 2021-037-RS  
PROJECT: NHPP - L3YE (009)  
SMART RESURFACING  
KANE COUNTY

C-91-127-21

R 8 E

IMPROVEMENT BEGINS  
STA 19+55

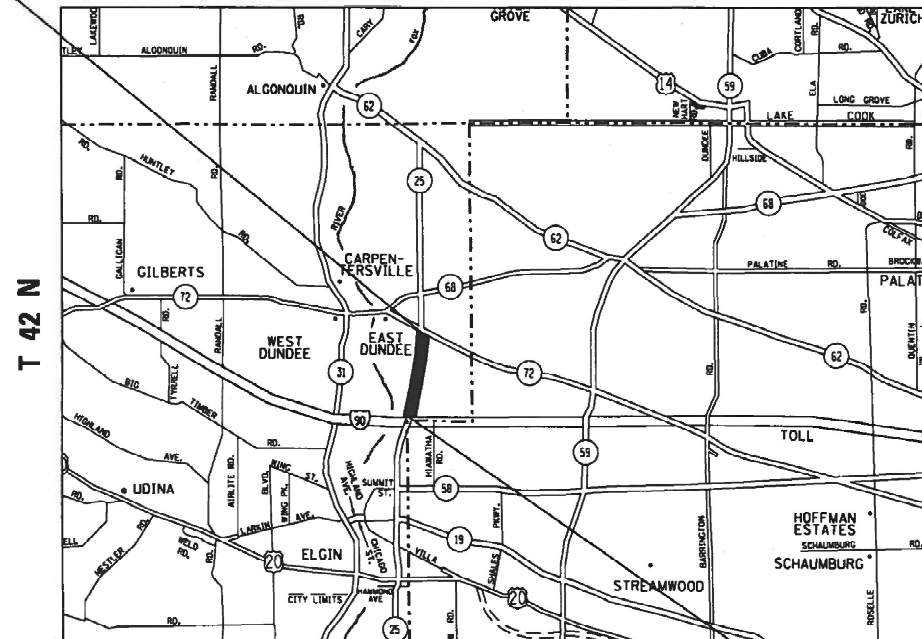

DUNDEE TOWNSHIP

IMPROVEMENT ENDS  
STA 109+88

GROSS & NET LENGTH = 9,033 FT. = 1.710 MILES

**TRAFFIC DATA**

2019 ADT  
IL-25 (DUNDEE AVE.) = 18,800

**POSTED SPEED LIMIT**  
IL-25 (DUNDEE AVE.) = 45 MPH

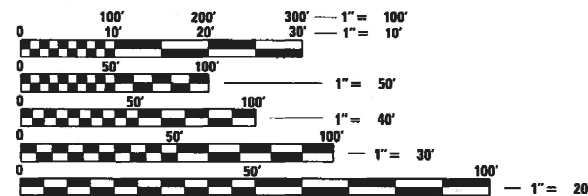

FULL SIZE PLANS HAVE BEEN PREPARED USING STANDARD  
ENGINEERING SCALES. REDUCED SIZED PLANS WILL NOT  
CONFORM TO STANDARD SCALES. IN MAKING MEASUREMENTS  
ON REDUCED PLANS, THE ABOVE SCALES MAY BE USED.

J.U.L.I.E.  
JOINT UTILITY LOCATION INFORMATION FOR EXCAVATORS  
1-800-892-0123  
OR 811

PROJECT ENGINEER: RODRIGO LEDEZMA (847)705-4580  
PROJECT MANAGER: JEAN ALAIN MIDY (847)221-3056

CONTRACT NO. 62N54

STATE OF ILLINOIS  
DEPARTMENT OF TRANSPORTATION

SUBMITTED June 1, 2022  
Rodrigo Ledezma  
REGIONAL ENGINEER

July 1, 2022 [Signature]  
ENGINEER OF DESIGN AND ENVIRONMENT

July 1, 2022 [Signature]  
DIRECTOR OF HIGHWAYS PROJECT IMPLEMENTATION

PRINTED BY THE AUTHORITY  
OF THE STATE OF ILLINOIS



| SUMMARY OF QUANTITIES |   |       | URBAN<br>TOTAL<br>QUANTITIES | CONSTRUCTION TYPE CODE       |                    |  |  |  |  |
|-----------------------|---|-------|------------------------------|------------------------------|--------------------|--|--|--|--|
| CODE NO               | ITEM  | UNIT  |                              | 0005<br>80% FED<br>20% STATE | 0005<br>100% STATE |  |  |  |  |
| 20100110              | TREE REMOVAL (6 TO 15 UNITS DIAMETER)           | UNIT  | 30                           | 30                           |                    |  |  |  |  |
| 20100210              | TREE REMOVAL (OVER 15 UNITS DIAMETER)           | UNIT  | 35                           | 35                           |                    |  |  |  |  |
| 21101615              | TOPSOIL FURNISH AND PLACE, 4"                   | SO YD | 475                          | 475                          |                    |  |  |  |  |
| 25000210              | SEEDING, CLASS 2A                               | ACRE  | 0.6                          | 0.6                          |                    |  |  |  |  |
| 25000400              | NITROGEN FERTILIZER NUTRIENT                    | POUND | 54                           | 54                           |                    |  |  |  |  |
| 25000500              | PHOSPHORUS FERTILIZER NUTRIENT                  | POUND | 54                           | 54                           |                    |  |  |  |  |
| 25000600              | POTASSIUM FERTILIZER NUTRIENT                   | POUND | 54                           | 54                           |                    |  |  |  |  |
| 25100127              | MULCH, METHOD 3A                                | ACRE  | 0.6                          | 0.6                          |                    |  |  |  |  |
| 25200110              | SODDING, SALT TOLERANT                          | SO YD | 475                          | 475                          |                    |  |  |  |  |
| 25200200              | SUPPLEMENTAL WATERING                           | UNIT  | 1                            | 1                            |                    |  |  |  |  |
| 35501316              | HOT-MIX ASPHALT BASE COURSE, 8"                 | SO YD | 14                           | 14                           |                    |  |  |  |  |
| 40600290              | BITUMINOUS MATERIALS (TACK COAT)                | POUND | 24750                        | 24750                        |                    |  |  |  |  |
| 40600370              | LONGITUDINAL JOINT SEALANT                      | FOOT  | 21000                        | 21000                        |                    |  |  |  |  |
| 40600400              | MIXTURE FOR CRACKS, JOINTS, AND<br>FLANGEWAYS   | TON   | 83                           | 83                           |                    |  |  |  |  |
| 40600982              | HOT-MIX ASPHALT SURFACE REMOVAL - BUTT<br>JOINT | SO YD | 190                          | 190                          |                    |  |  |  |  |

| SUMMARY OF QUANTITIES |   |       |                              | TOTAL<br>QUANTITIES | CONSTRUCTION TYPE CODE |  |  |  |  |  |
|-----------------------|---|-------|------------------------------|---------------------|------------------------|--|--|--|--|--|
| CODE NO               | ITEM  | UNIT  | 0005<br>80% FED<br>20% STATE |                     | 0005<br>100% STATE     |  |  |  |  |  |
| 40604060              | HOT-MIX ASPHALT SURFACE COURSE, IL-9.5,<br>MIX "D", N50 | TON   | 1.6                          | 1.6                 |                        |  |  |  |  |  |
| 40604062              | HOT-MIX ASPHALT SURFACE COURSE, IL-9.5,<br>MIX "D", N70 | TON   | 4620                         | 4620                |                        |  |  |  |  |  |
| 42001300              | PROTECTIVE COAT   | SO YD | 265                          | 265                 |                        |  |  |  |  |  |
| 42300400              | PORTLAND CEMENT CONCRETE DRIVEWAY<br>PAVEMENT, 8 INCH   | SO YD | 6                            | 6                   |                        |  |  |  |  |  |
| 44000155              | HOT-MIX ASPHALT SURFACE REMOVAL, 1<br>1/2"              | SO YD | 54960                        | 54960               |                        |  |  |  |  |  |
| 44000200              | DRIVEWAY PAVEMENT REMOVAL                               | SO YD | 20                           | 20                  |                        |  |  |  |  |  |
| 44003100              | MEDIAN REMOVAL  | SO FT | 550                          | 550                 |                        |  |  |  |  |  |
| 44201839              | CLASS D PATCHES, TYPE II, 16 INCH                       | SO YD | 225                          | 225                 |                        |  |  |  |  |  |
| 44201843              | CLASS D PATCHES, TYPE III, 16 INCH                      | SO YD | 140                          | 140                 |                        |  |  |  |  |  |
| 60250200              | CATCH BASINS TO BE ADJUSTED                             | EACH  | 3                            | 3                   |                        |  |  |  |  |  |
| 60252800              | CATCH BASINS TO BE RECONSTRUCTED                        | EACH  | 1                            | 1                   |                        |  |  |  |  |  |
| 60255500              | MANHOLES TO BE ADJUSTED                                 | EACH  | 4                            | 4                   |                        |  |  |  |  |  |
| 60257900              | MANHOLES TO BE RECONSTRUCTED                            | EACH  | 1                            | 1                   |                        |  |  |  |  |  |

|  |                   |            |                    |   |  |                     |                           |                       |                           |              |
|--|-------------------|------------|--------------------|---|--|---------------------|---------------------------|-----------------------|---------------------------|--------------|
| FILE NAME =  | USER NAME = hssom | DESIGNED - | REVISED -          | <b>STATE OF ILLINOIS<br/>DEPARTMENT OF TRANSPORTATION</b> | <b>IL. ROUTE 25 (IL. ROUTE 72 TO I-90)<br/>SUMMARY OF QUANTITIES</b> | F.A.P.<br>RTE.      | SECTION                   | COUNTY                | TOTAL<br>SHEETS           | SHEET<br>NO. |
| pw\N\dot-pw\benley.com\PW\DOT\Documents\DOT_Offices\District\Projects\DI042\CADData\Design\DI0421-st-500.dwg | DRAWN -           | REVISED -  | 360                |   |  | 2021-037-RS         | KANE                      | 23                    | 3                         |              |
| PLOT SCALE = 100,0000' / in.   | CHECKED -         | REVISED -  | CONTRACT NO. 62N54 |   |  |                     |                           |                       |                           |              |
| PLOT DATE = 6/7/2022   | DATE -            | REVISED -  | SCALE: 1"=50'      |   |  | SHEET NO. OF SHEETS | STA. 19+55 TO STA. 109+88 | FED. ROAD DIST. NO. 1 | ILLINOIS FED. AID PROJECT |              |

| SUMMARY OF QUANTITIES |   |       | URBAN<br>TOTAL<br>QUANTITIES | CONSTRUCTION TYPE CODE       |                    |  |  | SUMMARY OF QUANTITIES |  |                              | URBAN<br>TOTAL<br>QUANTITIES | CONSTRUCTION TYPE CODE |  |  |  |
|-----------------------|---|-------|------------------------------|------------------------------|--------------------|--|--|-----------------------|--|------------------------------|------------------------------|------------------------|--|--|--|
| CODE NO               | ITEM  | UNIT  |                              | 0005<br>80% FED<br>20% STATE | 0005<br>100% STATE |  |  |                       |  | 0005<br>80% FED<br>20% STATE |                              | 0005<br>100% STATE     |  |  |  |
| 60260100              | INLETS TO BE ADJUSTED                                     | EACH  | 10                           | 10                           |                    |  |  |                       |  |                              |                              |                        |  |  |  |
| 60300305              | FRAMES AND LIDS TO BE ADJUSTED                            | EACH  | 3                            | 3                            |                    |  |  |                       |  |                              |                              |                        |  |  |  |
| 60618300              | CONCRETE MEDIAN SURFACE, 4 INCH                           | SO FT | 550                          | 550                          |                    |  |  |                       |  |                              |                              |                        |  |  |  |
| 67100100              | MOBILIZATION  | L SUM | 1                            | 1                            |                    |  |  |                       |  |                              |                              |                        |  |  |  |
| 70102625              | TRAFFIC CONTROL AND PROTECTION,<br>STANDARD 701606        | L SUM | 1                            | 1                            |                    |  |  |                       |  |                              |                              |                        |  |  |  |
| 70102632              | TRAFFIC CONTROL AND PROTECTION,<br>STANDARD 701602        | L SUM | 1                            | 1                            |                    |  |  |                       |  |                              |                              |                        |  |  |  |
| 70102635              | TRAFFIC CONTROL AND PROTECTION,<br>STANDARD 701701        | L SUM | 1                            | 1                            |                    |  |  |                       |  |                              |                              |                        |  |  |  |
| 70300100              | SHORT TERM PAVEMENT MARKING                               | FOOT  | 42325                        | 42325                        |                    |  |  |                       |  |                              |                              |                        |  |  |  |
| 70300150              | SHORT TERM PAVEMENT MARKING REMOVAL                       | SO FT | 14108                        | 14108                        |                    |  |  |                       |  |                              |                              |                        |  |  |  |
| 70300211              | TEMPORARY PAVEMENT MARKING LETTERS AND<br>SYMBOLS - PAINT | SO FT | 402.6                        | 402.6                        |                    |  |  |                       |  |                              |                              |                        |  |  |  |
| 70300221              | TEMPORARY PAVEMENT MARKING - LINE 4"-<br>PAINT            | FOOT  | 23233                        | 23233                        |                    |  |  |                       |  |                              |                              |                        |  |  |  |
| 70300241              | TEMPORARY PAVEMENT MARKING - LINE 6"-<br>PAINT            | FOOT  | 2010                         | 2010                         |                    |  |  |                       |  |                              |                              |                        |  |  |  |
| 70300261              | TEMPORARY PAVEMENT MARKING - LINE 12"-<br>PAINT           | FOOT  | 390                          | 390                          |                    |  |  |                       |  |                              |                              |                        |  |  |  |
| 70300281              | TEMPORARY PAVEMENT MARKING - LINE 24"-<br>PAINT           | FOOT  | 230                          | 230                          |                    |  |  |                       |  |                              |                              |                        |  |  |  |
| 70306120              | TEMPORARY PAVEMENT MARKING - LINE 4" -<br>TYPE III TAPE   | FOOT  | 10582                        | 10582                        |                    |  |  |                       |  |                              |                              |                        |  |  |  |
| * 78000100            | THERMOPLASTIC PAVEMENT MARKING -<br>LETTERS AND SYMBOLS   | SO FT | 402.6                        | 402.6                        |                    |  |  |                       |  |                              |                              |                        |  |  |  |
| * 78000200            | THERMOPLASTIC PAVEMENT MARKING - LINE<br>4"               | FOOT  | 23233                        | 23233                        |                    |  |  |                       |  |                              |                              |                        |  |  |  |
| * 78000400            | THERMOPLASTIC PAVEMENT MARKING - LINE<br>6"               | FOOT  | 2010                         | 2010                         |                    |  |  |                       |  |                              |                              |                        |  |  |  |
| * 78000600            | THERMOPLASTIC PAVEMENT MARKING - LINE<br>12"              | FOOT  | 390                          | 390                          |                    |  |  |                       |  |                              |                              |                        |  |  |  |
| * 78000650            | THERMOPLASTIC PAVEMENT MARKING - LINE<br>24"              | FOOT  | 230                          | 230                          |                    |  |  |                       |  |                              |                              |                        |  |  |  |
| * 78100100            | RAISED REFLECTIVE PAVEMENT MARKER                         | EACH  | 715                          | 715                          |                    |  |  |                       |  |                              |                              |                        |  |  |  |
| 78300200              | RAISED REFLECTIVE PAVEMENT MARKER<br>REMOVAL              | EACH  | 700                          | 700                          |                    |  |  |                       |  |                              |                              |                        |  |  |  |
| 78300202              | PAVEMENT MARKING REMOVAL - WATER<br>BLASTING              | SO FT | 13430                        | 13430                        |                    |  |  |                       |  |                              |                              |                        |  |  |  |
| * 88600600            | DETECTOR LOOP REPLACEMENT                                 | FOOT  | 355                          | 355                          |                    |  |  |                       |  |                              |                              |                        |  |  |  |

| SUMMARY OF QUANTITIES |   |        | URBAN<br>TOTAL<br>QUANTITIES | CONSTRUCTION TYPE CODE       |                    |  |  |  |
|-----------------------|---|--------|------------------------------|------------------------------|--------------------|--|--|--|
| CODE NO               | ITEM  | UNIT   |                              | 0005<br>80% FED<br>20% STATE | 0005<br>100% STATE |  |  |  |
| X0100018              | TREE REMOVAL (UNDER 6 UNITS DIAMETER)   | UNIT   | 10                           | 10                           |                    |  |  |  |
| X0327120              | WEED CONTROL, NATIVE LANDSCAPE<br>ENHANCEMENT   | ACRE   | 0.6                          | 0.6                          |                    |  |  |  |
| X2010100              | TREE LIMB REMOVAL (4 TO 10 INCHES<br>DIAMETER)  | EACH   | 20                           | 20                           |                    |  |  |  |
| X2010200              | TREE LIMB REMOVAL (OVER 10 INCHES<br>DIAMETER)  | EACH   | 10                           | 10                           |                    |  |  |  |
| X2010350              | TREE REMOVAL, ACRES (SPECIAL)   | ACRE   | 0.5                          | 0.5                          |                    |  |  |  |
| X2100002              | PRUNING FOR SAFETY AND EQUIPMENT<br>CLEARANCE   | UNIT   | 25                           | 25                           |                    |  |  |  |
| X4400501              | COMBINATION CURB AND GUTTER REMOVAL AND<br>REPLACEMENT LESS THAN OR EQUAL TO 10<br>FEET | FOOT   | 50                           | 50                           |                    |  |  |  |
| X5537800              | STORM SEWERS TO BE CLEANED 12"  | FOOT   | 200                          | 200                          |                    |  |  |  |
| X5537900              | STORM SEWERS TO BE CLEANED 15"  | FOOT   | 200                          | 200                          |                    |  |  |  |
| X6030310              | FRAMES AND LIDS TO BE ADJUSTED<br>(SPECIAL)   | EACH   | 5                            | 5                            |                    |  |  |  |
| X6700407              | ENGINEER'S FIELD OFFICE, TYPE A (D1)  | CAL MO | 12                           | 12                           |                    |  |  |  |
| Z0004562              | COMBINATION CONCRETE CURB AND GUTTER<br>REMOVAL AND REPLACEMENT                         | FOOT   | 789                          | 789                          |                    |  |  |  |

| SUMMARY OF QUANTITIES |                                      |       | URBAN<br>TOTAL<br>QUANTITIES | CONSTRUCTION TYPE CODE       |                    |  |  |  |
|-----------------------|--------------------------------------|-------|------------------------------|------------------------------|--------------------|--|--|--|
| CODE NO               | ITEM                                 | UNIT  |                              | 0005<br>80% FED<br>20% STATE | 0005<br>100% STATE |  |  |  |
| Z0018500              | DRAINAGE STRUCTURES TO BE CLEANED    | EACH  | 40                           | 40                           |                    |  |  |  |
| Z0030850              | TEMPORARY INFORMATION SIGNING        | SO FT | 51.4                         | 51.4                         |                    |  |  |  |
| Z0064800              | SELECTIVE CLEARING                   | UNIT  | 8.5                          | 8.5                          |                    |  |  |  |
| Z0076600              | TRAINEES                             | HOURS | 500                          | 500                          |                    |  |  |  |
| Z0076604              | TRAINEES - TRAINING PROGRAM GRADUATE | HOURS | 500                          | 500                          |                    |  |  |  |

|   |                    |            |           |
|---|--------------------|------------|-----------|
| FILE NAME =   | USER NAME = hssomn | DESIGNED - | REVISED - |
| pw\N\dot-pw\benrey.com\PW\DOT\Documents\DOT - Office\Dist\1\Projects\DI1042\CAAD\dot\Design\DI1042-st-500.dwg |                    | DRAWN -    | REVISED - |
|   |                    | CHECKED -  | REVISED - |
|   |                    | DATE -     | REVISED - |

**STATE OF ILLINOIS  
DEPARTMENT OF TRANSPORTATION**

**IL. ROUTE 25 (IL. ROUTE 72 TO I-90)  
SUMMARY OF QUANTITIES**

SCALE: 1"=50'      SHEET NO.      OF      SHEETS      STA. 19+55 TO STA. 109+88

|   |             |        |                 |              |
|---|-------------|--------|-----------------|--------------|
| F.A.P.<br>RTE.                                    | SECTION     | COUNTY | TOTAL<br>SHEETS | SHEET<br>NO. |
| 360   | 2021-037-RS | KANE   | 23              | 5            |
| CONTRACT NO. 62N54                                |             |        |                 |              |
| FED. ROAD DIST. NO. 1 (ILLINOIS) FED. AID PROJECT |             |        |                 |              |



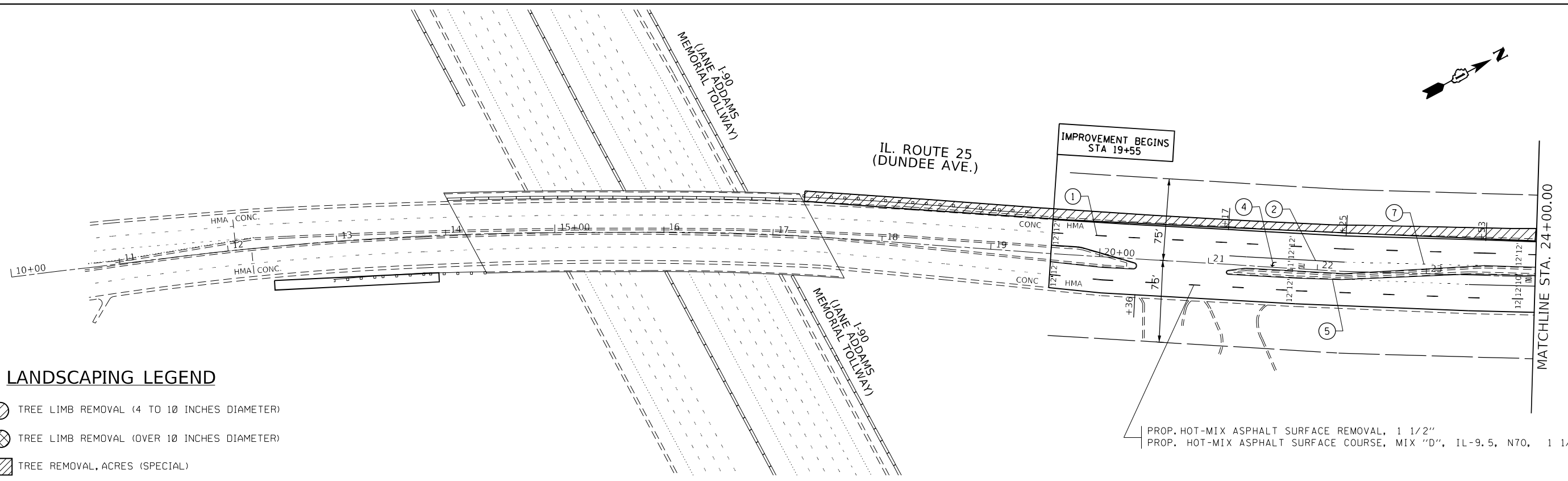
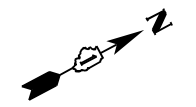

**LANDSCAPING LEGEND**

- TREE LIMB REMOVAL (4 TO 10 INCHES DIAMETER)
- TREE LIMB REMOVAL (OVER 10 INCHES DIAMETER)
- TREE REMOVAL, ACRES (SPECIAL)
- PRUNING FOR SAFETY AND EQUIPMENT CLEARING
- SELECTIVE CLEARING

- ① PROP. THERMOPLASTIC PVMT MARKING 4", 10' DASH 30' SKIP, WHITE (TYP.)
- ② PROP. THERMOPLASTIC PVMT MARKING 6", TURN LANE, WHITE (TYP.)
- ③ PROP. THERMOPLASTIC PVMT MARKING 4", DOUBLE YELLOW @ 11" C-C (TYP.)
- ④ PROP. THERMOPLASTIC PVMT, MARKING LETTERS AND SYMBOLS, WHITE (TYP.)
- ⑤ PROP. THERMOPLASTIC PVMT MARKING 4", MEDIAN LANE, YELLOW (TYP.)
- ⑥ PROP. THERMOPLASTIC PVMT MARKING LINE, 24" STOPBAR, WHITE (TYP.)
- ⑦ PROP. THERMOPLASTIC PVMT MARKING 6", 2' DASH 6' SKIP, WHITE (TYP.)
- ⑧ PROP. THERMOPLASTIC PVMT, MARKING 12" MEDIAN @ 45° 150' C-C, YELLOW (TYP.)

PROP. HOT-MIX ASPHALT SURFACE REMOVAL, 1 1/2"  
 PROP. HOT-MIX ASPHALT SURFACE COURSE, MIX "D", IL-9.5, N70, 1 1/2"

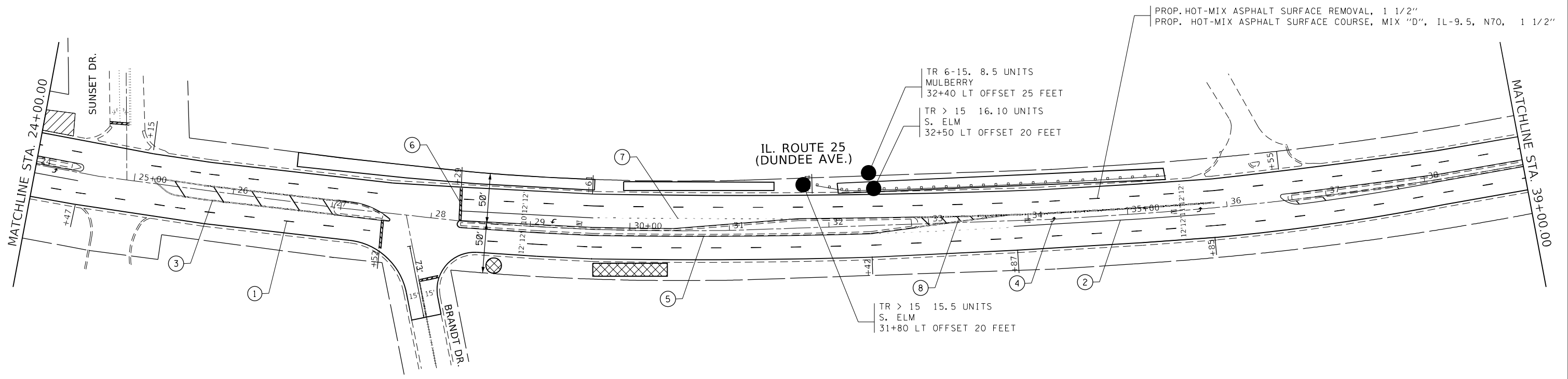

PROP. HOT-MIX ASPHALT SURFACE REMOVAL, 1 1/2"  
 PROP. HOT-MIX ASPHALT SURFACE COURSE, MIX "D", IL-9.5, N70, 1 1/2"

MODEL: Default  
 FILE: h:\m\p\p\110101\110101.dwg  
 PROJECT: 110101  
 USER: hassan  
 DATE: 6/7/2022

|                              |            |           |
|------------------------------|------------|-----------|
| USER NAME = hassan           | DESIGNED - | REVISED - |
|                              | DRAWN -    | REVISED - |
| PLOT SCALE = 100,0000' / in. | CHECKED -  | REVISED - |
| PLOT DATE = 6/7/2022         | DATE -     | REVISED - |

**STATE OF ILLINOIS  
 DEPARTMENT OF TRANSPORTATION**

|  |                              |
|--|------------------------------|
| <b>ROADWAY PLAN</b>                        |                              |
| <b>IL. ROUTE 25 (IL. ROUTE 72 TO I-90)</b> |                              |
| SCALE: 1"=50'                              | SHEET OF SHEETS STA. TO STA. |

|                           |             |        |              |           |
|---------------------------|-------------|--------|--------------|-----------|
| F.A.P. RTE.               | SECTION     | COUNTY | TOTAL SHEETS | SHEET NO. |
| 360                       | 2021-037-R5 | KANE   | 23           | 7         |
| CONTRACT NO. 62N54        |             |        |              |           |
| ILLINOIS FED. AID PROJECT |             |        |              |           |









**NOTES:**

1. WORK SHALL MEET THE REQUIREMENTS OF THE SPECIAL PROVISION, "DETECTOR LOOP REPLACEMENT AND/OR INSTALLATION (ROADWAY GRINDING, RESURFACING & PATCHING OPERATIONS).
2. THIS PLAN IS FOR THE SOLE PURPOSE OF DETECTOR LOOP REPLACEMENT.

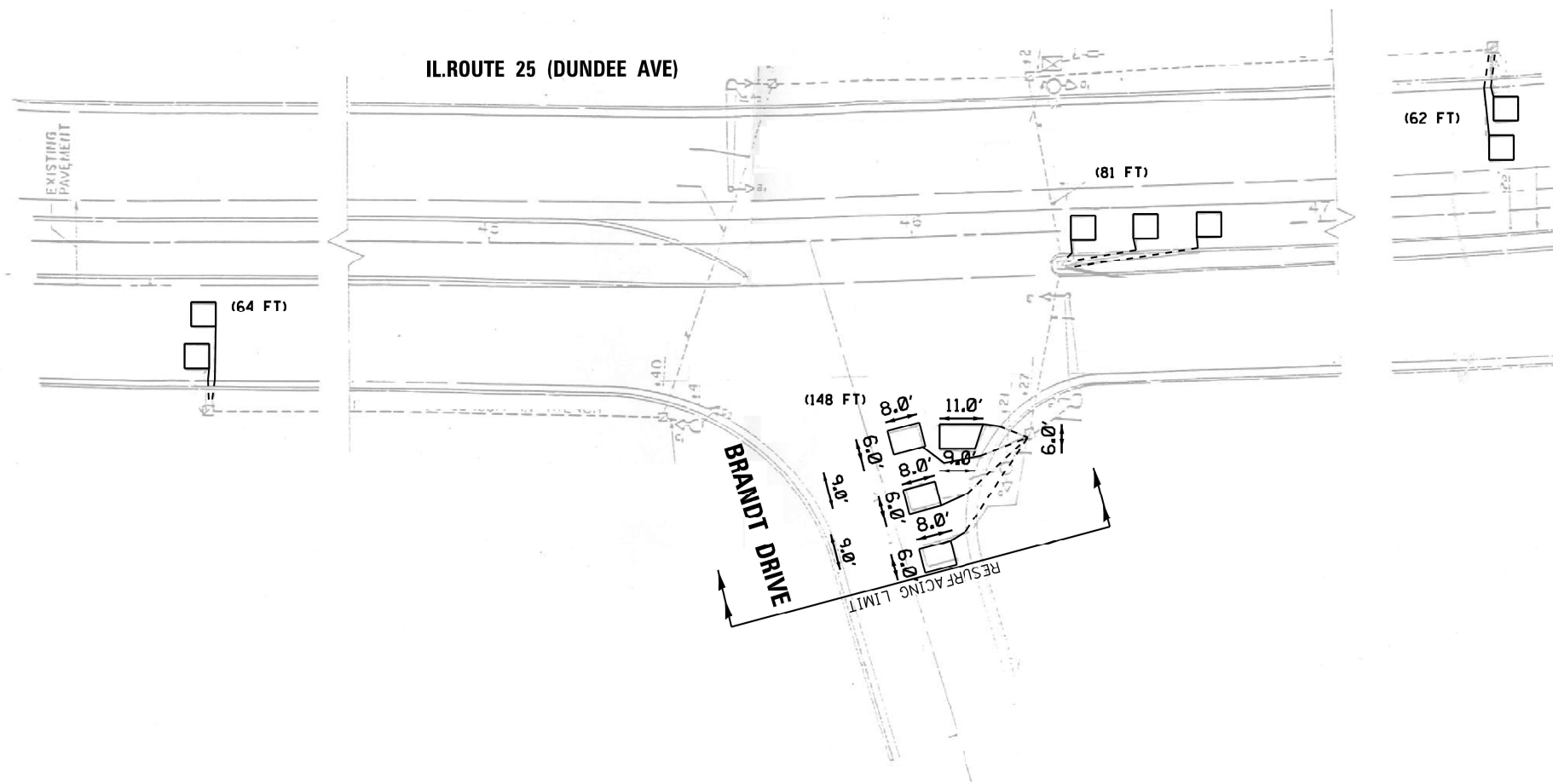
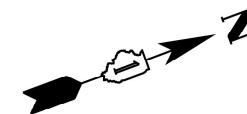

**REPLACE ALL DETECTOR LOOPS AS SHOWN  
(WITHIN THE RESURFACING LIMITS)**

| CODE     | ITEM                      | QUANTITY | UNIT |
|----------|---------------------------|----------|------|
| 88600600 | DETECTOR LOOP REPLACEMENT | 355      | FOOT |

**TS 775**

|  |                            |                   |           |   |   |                           |             |              |                 |              |
|--|----------------------------|-------------------|-----------|---|---|---------------------------|-------------|--------------|-----------------|--------------|
| FILE NAME =                            | USER NAME = meremh         | DESIGNED - MM     | REVISED - | <b>STATE OF ILLINOIS<br/>DEPARTMENT OF TRANSPORTATION</b> | <b>DETECTOR LOOP REPLACEMENT PLAN<br/>IL.ROUTE 25 (DUNDEE AVE) AT BRANDT DR</b> | F.A.P.<br>RTE:            | SECTION     | COUNTY       | TOTAL<br>SHEETS | SHEET<br>NO. |
| S:\WP\Design\Muntather-Mere\Detector L | ops IL 25\IL 25_62N54.dgn  | DRAWN - MM        | REVISED - |   |   | 360                       | 2021-037-RS | KANF         | 23              | 11           |
| Default                                | PLOT SCALE = 40,0000' / 1" | CHECKED - KK      | REVISED - |   |   | CONTRACT NO. 62N54        |             |              |                 |              |
|  | PLOT DATE = 2/23/2022      | DATE - 02/14/2022 | REVISED - |   |   | ILLINOIS FED. AID PROJECT |             |              |                 |              |
|  |                            |                   |           | SCALE:  |   | SHEET OF SHEETS           |             | STA. TO STA. |                 |              |

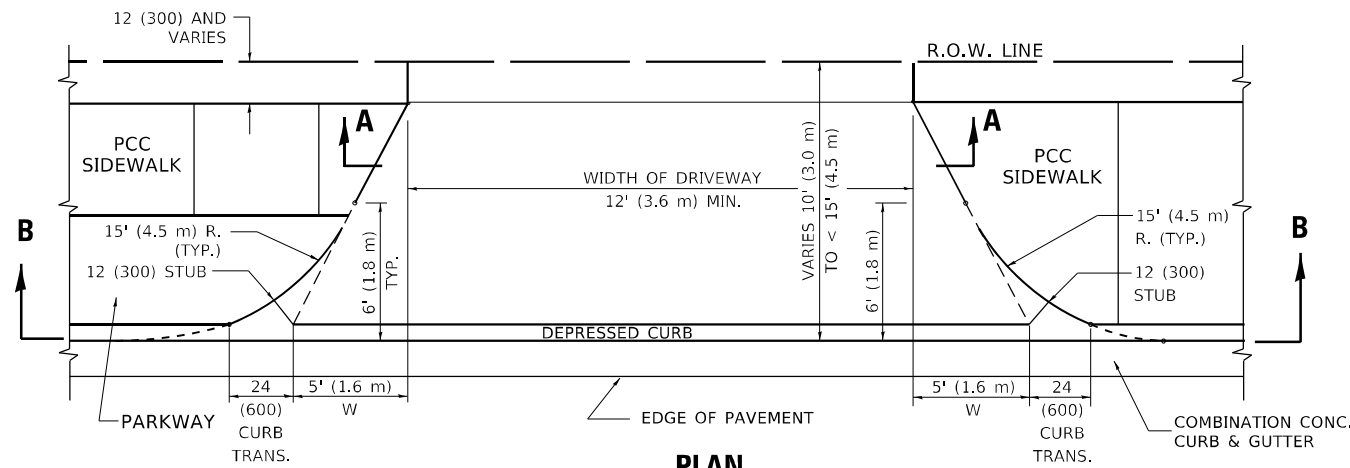

**PLAN**  
10' (3.0 m) TO < 15' (4.5 m)

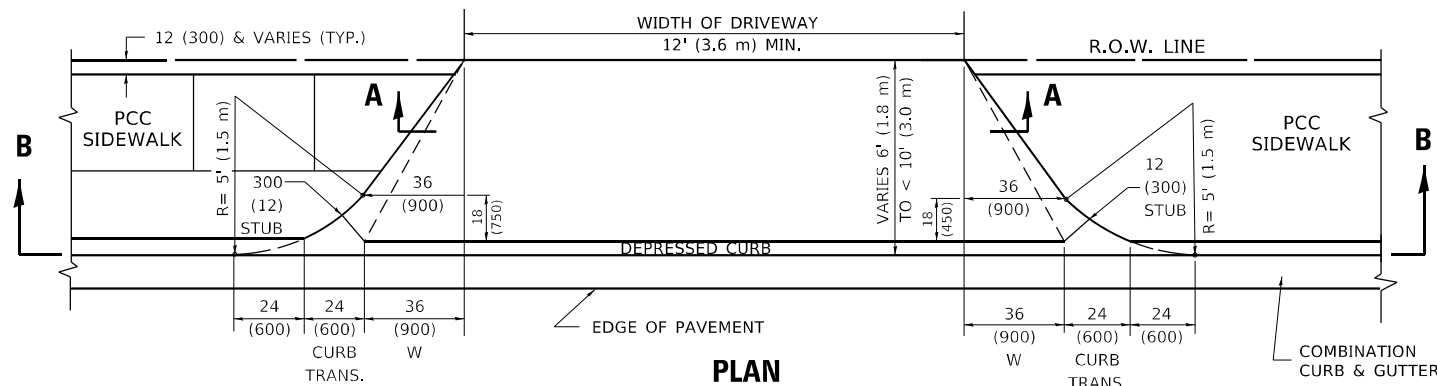

**PLAN**  
6' (1.8 m) TO < 10' (3.0 m)

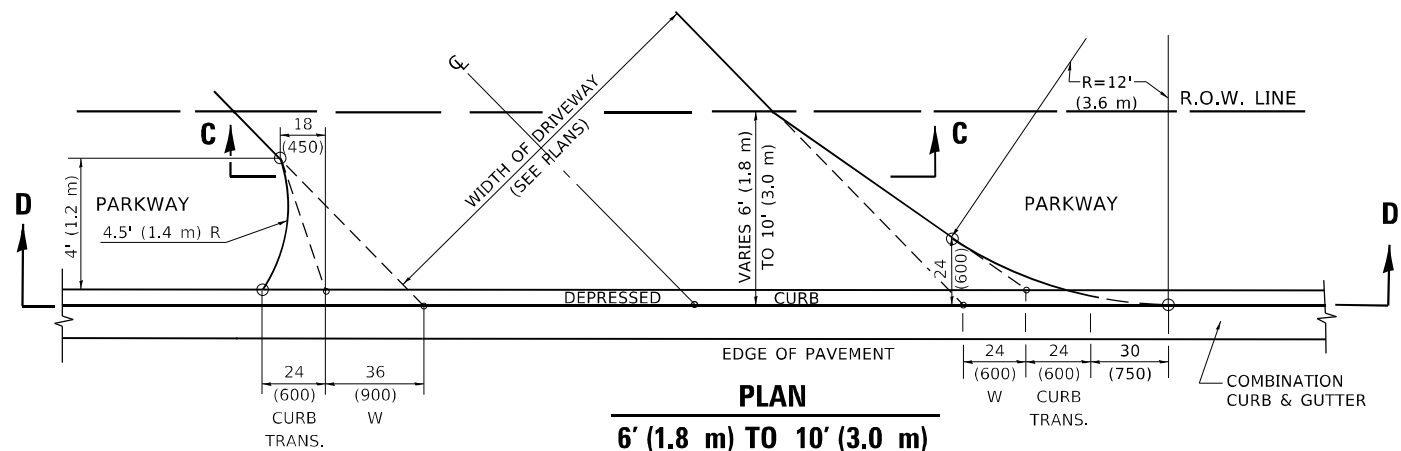

**PLAN**  
6' (1.8 m) TO 10' (3.0 m)

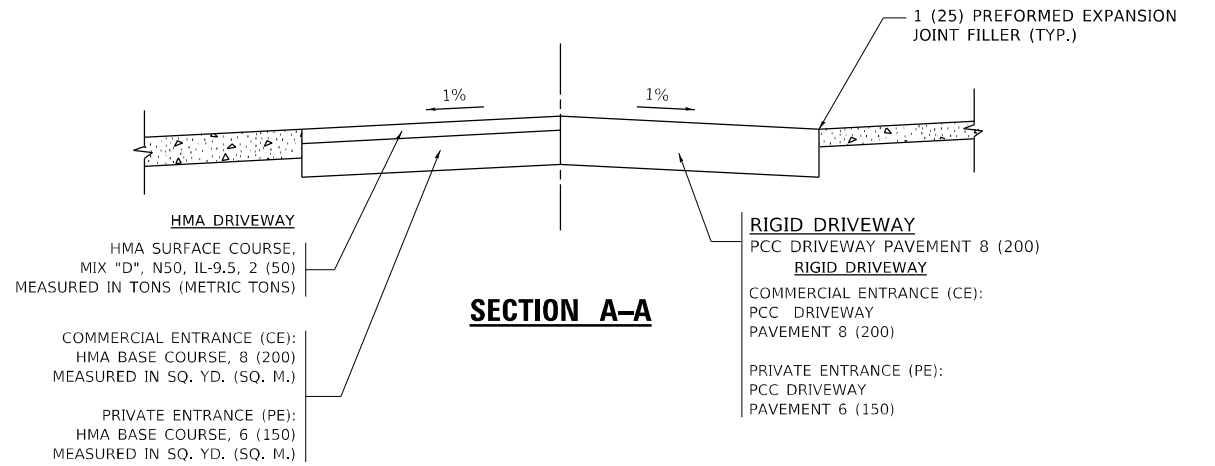

**SECTION A-A**

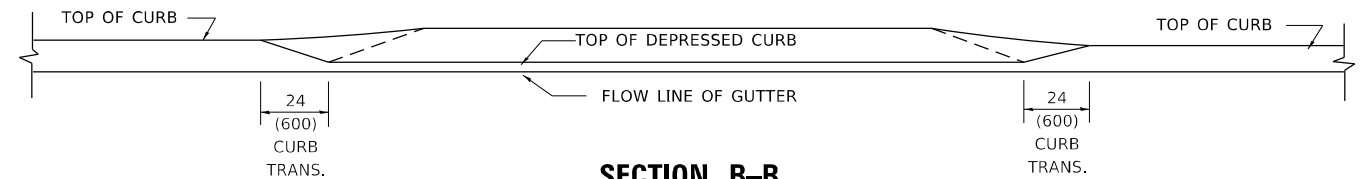

**SECTION B-B**

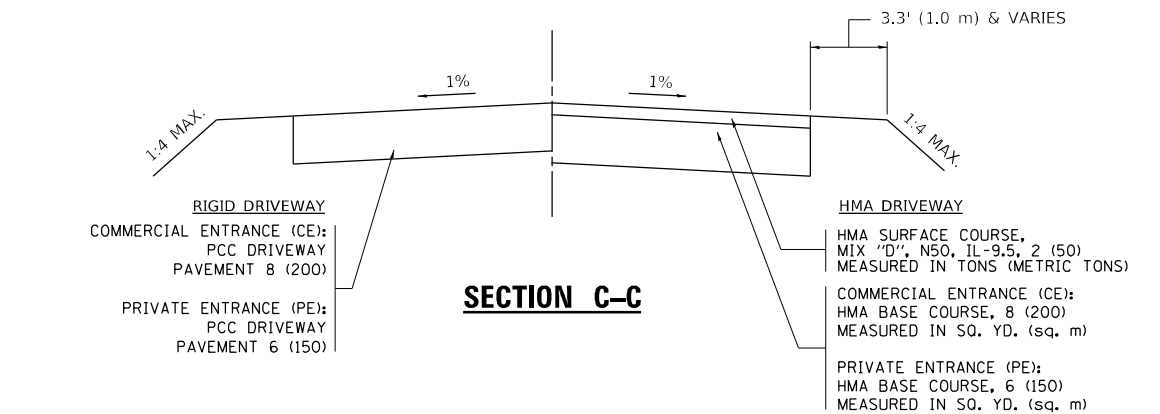

**SECTION C-C**

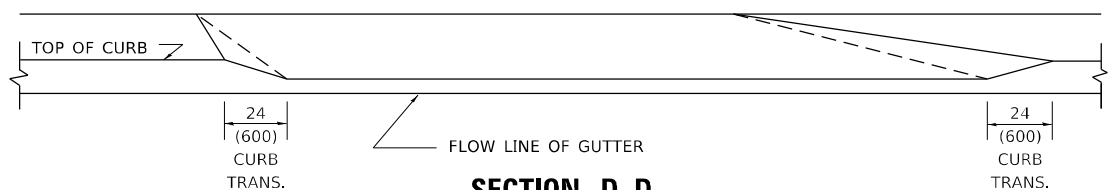

**SECTION D-D**

**GENERAL NOTES**

- DRIVEWAY SLOPES, LOCATIONS, & GEOMETRIC LAYOUT SHALL BE IN ACCORDANCE WITH THE LATEST EDITION OF THE "HANDBOOK FOR POLICY ON PERMITS FOR ACCESS DRIVEWAYS TO STATE HIGHWAYS". FOR FURTHER LAYOUT REQUIREMENTS, REFER TO ILLUSTRATION 10 IN THE PERMIT HANDBOOK. WHERE SIDEWALKS EXIST, DRIVEWAYS SHALL BE REPLACED WITH RIGID PAVEMENT. WHERE NO SIDEWALKS EXIST, DRIVEWAYS SHALL BE REPLACED IN KIND. SIDEWALK CROSS SLOPE THRU DRIVEWAY AREA TO BE A MAXIMUM OF 1:50.
- WHEN THE DISTANCE BETWEEN R.O.W. AND THE BACK OF CURB IS EQUAL TO OR LESS THAN 8' (2.4 m), THE PCC SIDEWALK SHALL EXTEND TO THE BACK OF CURB.
- "W" VARIES FROM 36 (900) TO 5' (1.5 m) PROPORTIONAL TO THE LENGTH (L), FROM 6' (1.8 m) TO 10' (3 m).

ALL DIMENSIONS ARE IN INCHES (MILLIMETERS) UNLESS OTHERWISE NOTED.

MODEL: Default  
FILE NAME: p:\project-paw-beach\paw.com\p\w\DOT\Documents\DOT Office\Drawings\11042\ICADD\Drawings\Drawings\BdFS.dgn

|                              |                    |                             |
|------------------------------|--------------------|-----------------------------|
| USER NAME = hassan           | DESIGNED - R. SHAH | REVISED - R. BORO 01-01-07  |
|                              | DRAWN -            | REVISED - R. BORO 09-06-11  |
| PLOT SCALE = 100,0000' / in. | CHECKED -          | REVISED - K. SMITH 08-27-19 |
| PLOT DATE = 6/7/2022         | DATE - 11-06-95    | REVISED - K. SMITH 02-01-22 |

**STATE OF ILLINOIS  
DEPARTMENT OF TRANSPORTATION**

**DRIVEWAY DETAILS  
DISTANCE BETWEEN ROW AND FACE OF CURB < 15' (4.5m)**

SCALE: NONE SHEET 1 OF 1 SHEETS STA. TO STA.

| F.A.P. RTE.               | SECTION     | COUNTY       | TOTAL SHEETS | SHEET NO. |
|---------------------------|-------------|--------------|--------------|-----------|
| 360                       | 2021-037-R5 | KANE         | 23           | 12        |
| <b>BD400-02 (BD-02)</b>   |             | CONTRACT NO. | 62N54        |           |
| ILLINOIS FED. AID PROJECT |             |              |              |           |



**METHOD OF MEASUREMENT**

REFER TO SECTION 442 OF THE STANDARD SPECIFICATIONS FOR ROAD AND BRIDGE CONSTRUCTION AND THE RECURRING SPECIAL PROVISION "PATCHING WITH HOT-MIX ASPHALT OVERLAY REMOVAL."

**BASIS OF PAYMENT**

1. REFER TO SECTION 442 OF THE STANDARD SPECIFICATIONS FOR ROAD AND BRIDGE CONSTRUCTION AND THE RECURRING SPECIAL PROVISION "PATCHING WITH HOT-MIX ASPHALT OVERLAY REMOVAL."
2. SAW CUT/SCORING OF EXISTING HMA OVERLAY IS INCLUDED IN THE COST OF PAVEMENT PATCHING.
3. SAW CUT/SCORING OF EXISTING PAVEMENT IS INCLUDED IN THE COST OF PAVEMENT PATCHING.

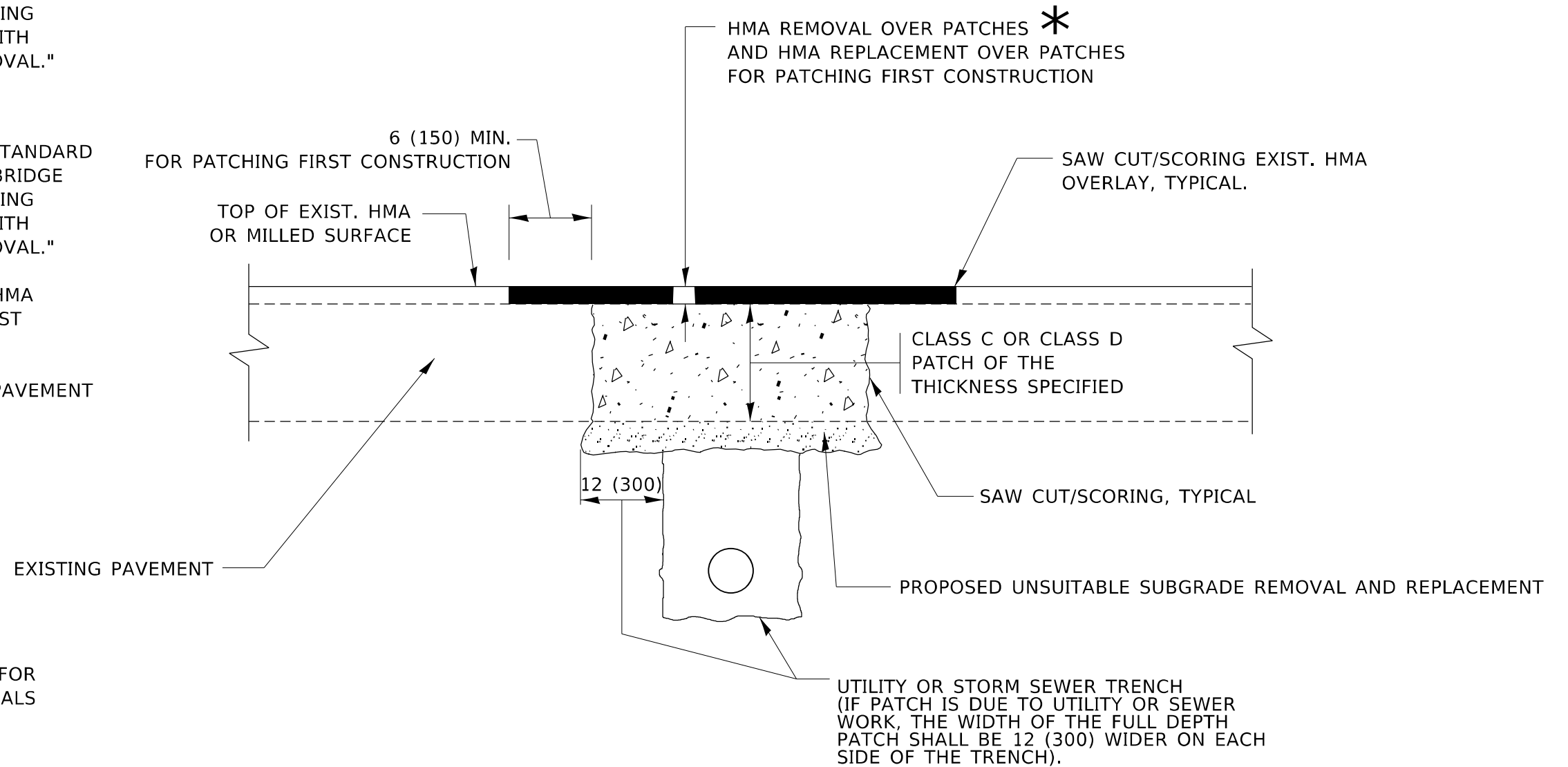

\* SEE TYPICAL SECTIONS FOR THICKNESS AND MATERIALS

**SEQUENCE OF CONSTRUCTION (PATCHING FIRST)**

1. REMOVE THE EXISTING HMA MATERIAL OVER THE AREA TO BE PATCHED.
2. REMOVE AND REPLACE WITH CLASS C OR D PATCH.
3. REPLACE HMA MATERIAL OVER THE AREA TO BE PATCHED.

**SEQUENCE OF CONSTRUCTION (MILLING FIRST)**

1. MILL HMA FIRST IF THERE IS AT LEAST 4½ INCHES OR MORE OF HMA MATERIAL ON TOP OF THE EXISTING PAVEMENT OR IF THE PAVEMENT IS FULL DEPTH HMA. A MINIMUM OF 2 INCHES OF HMA MATERIAL SHALL BE IN PLACE AFTER MILLING.
2. REMOVE AND REPLACE WITH FULL DEPTH CLASS D PATCHES TO TOP OF MILLED SURFACE.

ALL DIMENSIONS ARE IN INCHES (MILLIMETERS) UNLESS OTHERWISE SHOWN.

MODEL: Default  
FILE: hma14a.dwg  
PROJECT: 2021-037-R5  
DRAWING: BD400-04 (BD-22)  
DATE: 6/7/2022

|                               |                    |                             |
|-------------------------------|--------------------|-----------------------------|
| USER NAME = hassan            | DESIGNED - R. SHAH | REVISED - R. BORO 01-01-07  |
|                               | DRAWN -            | REVISED - R. BORO 09-04-07  |
| PLOT SCALE = 100,0000 ' / in. | CHECKED -          | REVISED - K. ENG 10-27-08   |
| PLOT DATE = 6/7/2022          | DATE - 10-25-94    | REVISED - K. SMITH 02-01-22 |

**STATE OF ILLINOIS  
DEPARTMENT OF TRANSPORTATION**

**PAVEMENT PATCHING FOR  
HMA SURFACED PAVEMENT**

SCALE: NONE SHEET 1 OF 1 SHEETS STA. TO STA.

|                           |                     |                    |                 |              |
|---------------------------|---------------------|--------------------|-----------------|--------------|
| F.A.P. RTE. 360           | SECTION 2021-037-R5 | COUNTY KANE        | TOTAL SHEETS 23 | SHEET NO. 14 |
| BD400-04 (BD-22)          |                     | CONTRACT NO. 62N54 |                 |              |
| ILLINOIS FED. AID PROJECT |                     |                    |                 |              |









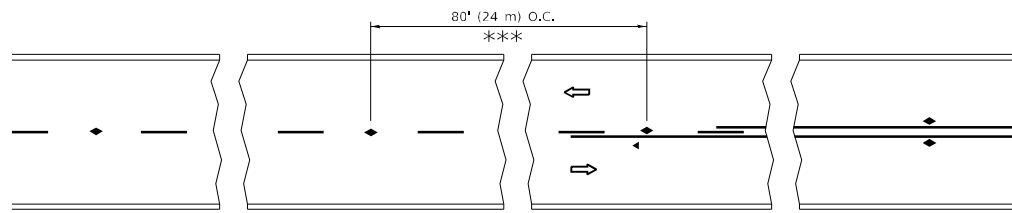

\*\*\* REDUCE TO 40' (12 m) O.C. ON CURVES WITH POSTED OR ADVISORY SPEED 45 M.P.H. (70 km/h) OR LESS.

**TWO-LANE/TWO-WAY**

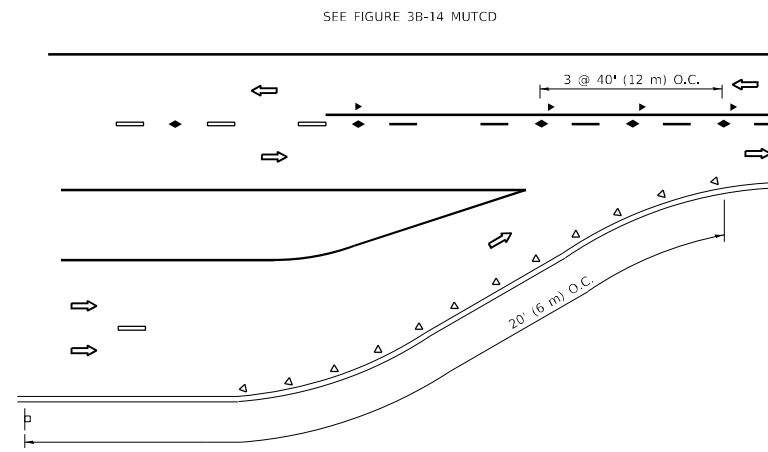

**LANE REDUCTION TRANSITION**

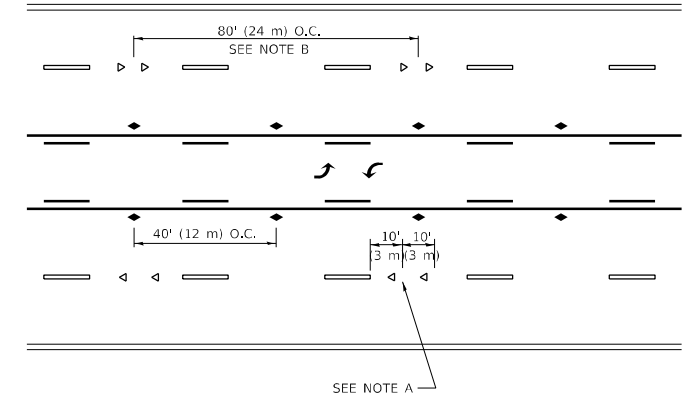

**TWO-WAY LEFT TURN**

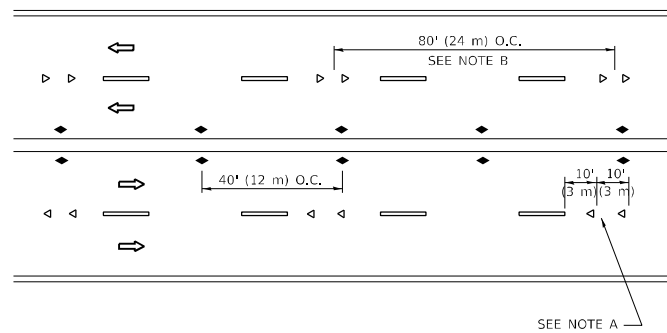

**MULTI-LANE/UNDIVIDED**

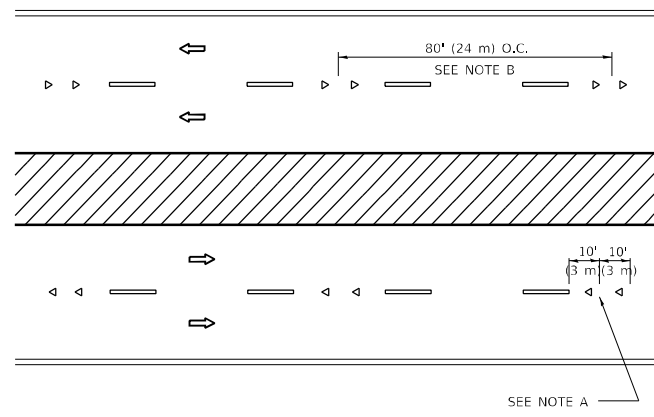

**MULTI-LANE/DIVIDED**

**GENERAL NOTES**

1. MARKERS USED WITH DASHED LINES SHALL BE CENTERED IN THE GAP BETWEEN SEGMENTS.
2. MARKERS USED ADJACENT TO SOLID LINES SHALL BE OFFSET 2 TO 3 (50 TO 75) TOWARD TRAFFIC AS SHOWN.
3. MARKERS THROUGH TANGENTS LESS THAN 500' (150 m) IN LENGTH BETWEEN CURVES SHALL BE INSTALLED AT THE LESSER OF THE TWO CURVE SPACINGS.
4. MARKERS ARE TO BE USED ADJACENT TO BOTH SOLID WHITE LINES IN DUAL LEFT TURN LANES

**SYMBOLS**

- YELLOW STRIPE
- WHITE STRIPE
- ◀ ONE-WAY AMBER MARKER
- ◀ ONE-WAY CRYSTAL MARKER (W/O)
- ◆ TWO-WAY AMBER MARKER

**LANE MARKER NOTES**

- A. USE DOUBLE LANE LINE MARKERS SPACED AS SHOWN.
- B. REDUCE TO 40' (12 m) O.C. ON CURVES WHERE ADVISORY SPEEDS ARE 10 M.P.H (20 km/h) LOWER THAN POSTED SPEEDS.

**DESIGN NOTES**

1. DOUBLE LANE LINE MARKERS SHALL BE USED UNLESS SPECIFIED OTHERWISE.
2. EXCEPT AS SHOWN ON THE LANE REDUCTION TRANSITION AND FREEWAY EXIT RAMP DETAIL, MARKERS ARE NOT TO BE SPECIFIED ON RIGHT EDGE LINES.
3. THE EXACT MARKER LIMITS, SPACING, AND COLOR SHALL BE INCLUDED IN THE PLANS WHEN STANDARD SPECIFICATIONS ARE NOT BEING USED.
4. MARKERS SHOULD NOT BE USED ALONGSIDE CURBS EXCEPT FOR EXTREMELY SHORT SECTIONS OF CURBS WHERE NOT MORE THAN TWO MARKERS WOULD BE INVOLVED.

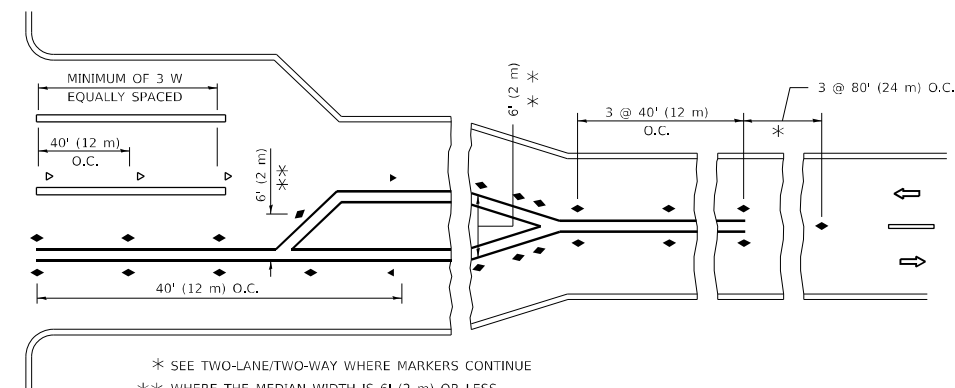
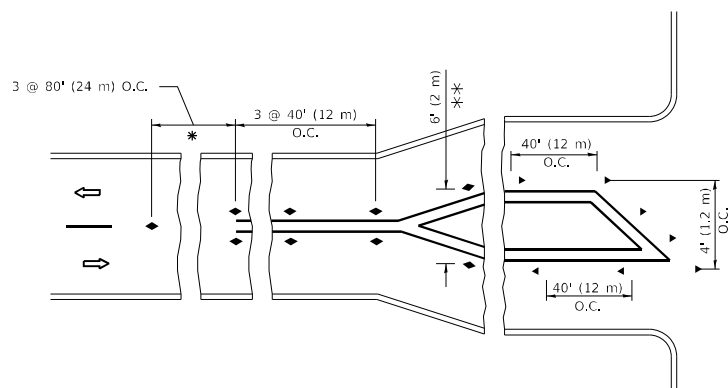

**TURN LANES**

\* SEE TWO-LANE/TWO-WAY WHERE MARKERS CONTINUE  
 \*\* WHERE THE MEDIAN WIDTH IS 6' (2 m) OR LESS USE TWO-WAY MARKERS.

All dimensions are in inches (millimeters) unless otherwise shown.

MODEL: Default  
 FILE NAME: p:\projects\paw\_bentley.com\p\w\dot\Documents\DOT Office\Dir\rdet\_1\Project\1042\ICAD\DrawData\Design\BdfStEd.dgn

|                               |            |                                 |
|-------------------------------|------------|---------------------------------|
| USER NAME = hassan            | DESIGNED - | REVISED - T. RAMMACHER 03-12-99 |
|                               | DRAWN -    | REVISED - T. RAMMACHER 01-06-00 |
| PLOT SCALE = 100,0000 ' / in. | CHECKED -  | REVISED - C. JUCIUS 09-09-09    |
| PLOT DATE = 6/7/2022          | DATE -     | REVISED - C. JUCIUS 07-01-13    |

**STATE OF ILLINOIS  
 DEPARTMENT OF TRANSPORTATION**

**TYPICAL APPLICATIONS  
 RAISED REFLECTIVE PAVEMENT MARKERS (SNOW-PLOW RESISTANT)**

SCALE: NONE SHEET 1 OF 1 SHEETS STA. TO STA.

|                           |                     |                    |                 |              |
|---------------------------|---------------------|--------------------|-----------------|--------------|
| F.A.P. RTE. 360           | SECTION 2021-037-R5 | COUNTY KANE        | TOTAL SHEETS 23 | SHEET NO. 18 |
| TC-11                     |                     | CONTRACT NO. 62N54 |                 |              |
| ILLINOIS FED. AID PROJECT |                     |                    |                 |              |









