

GUARDRAIL & SHOULDER DETAIL

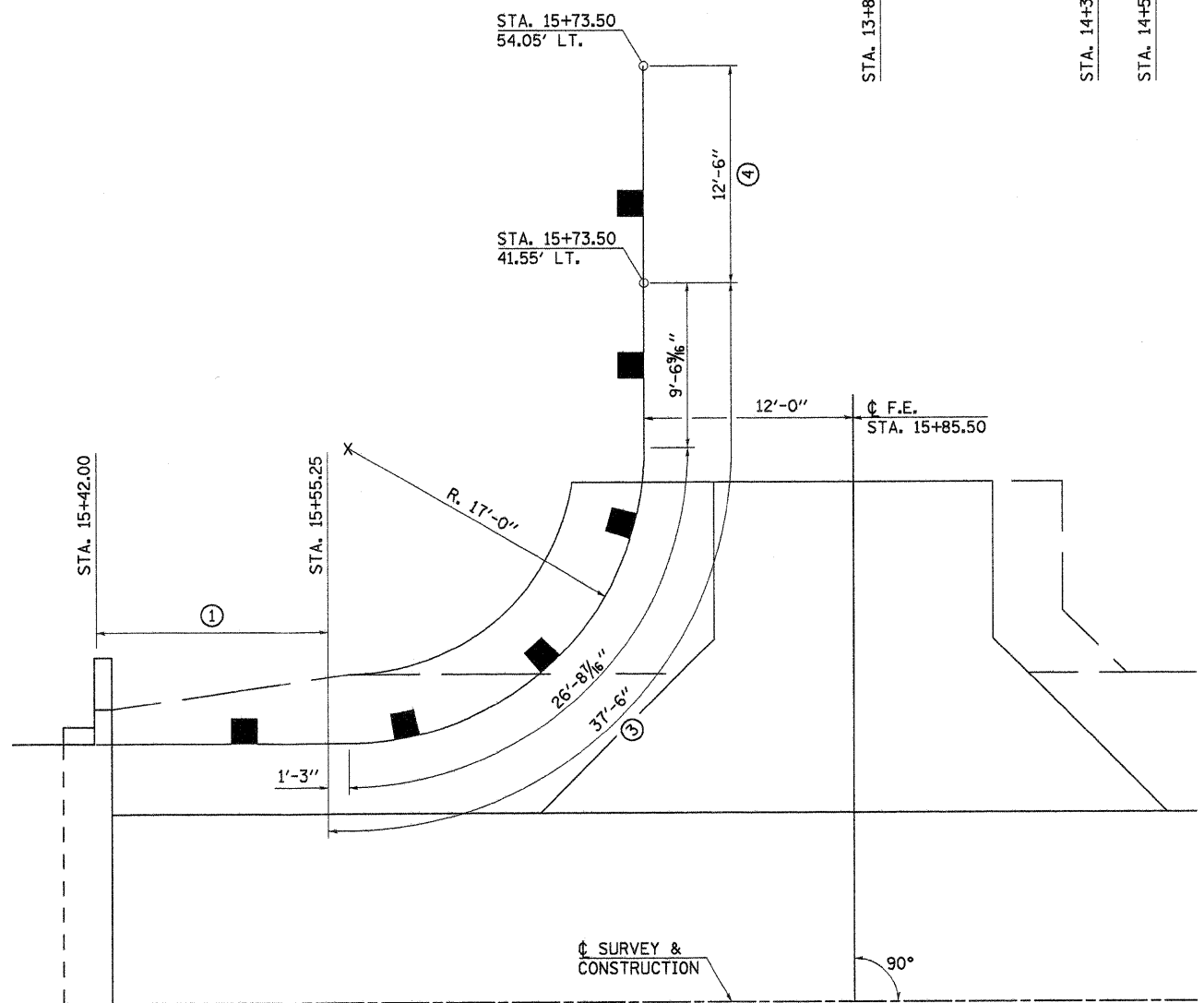

DETAIL "A"

TRAFFIC BARRIER TERMINAL, TYPE 5A

15' RT. STA. 14+38.75 TO 15' RT. STA. 14+52.00 = 1 EACH
 15' LT. STA. 15+42.00 TO 15' LT. STA. 15+55.25 = 1 EACH
 TOTAL = 2 EACH

TRAFFIC BARRIER TERMINAL, TYPE 1 (SPECIAL) TANGENT

16' RT. STA. 13+88.75 TO 15' RT. STA. 14+38.75 = 1 EACH
 15' LT. STA. 16+19.50 TO 16' LT. STA. 16+69.50 = 1 EACH
 TOTAL = 2 EACH

STEEL PLATE BEAM GUARDRAIL (SHORT RADIUS)

15' LT. STA. 15+55.25 TO 41.55' LT. STA. 15+73.50 = 37.5 FOOT
 TOTAL = 37.5 FOOT

TRAFFIC BARRIER TERMINAL, TYPE 2

41.55' LT. STA. 15+73.50 TO 54.05' LT. STA. 15+73.50 = 1 EACH
 15' LT. STA. 16+05.23 TO 15' LT. STA. 16+19.50 = 1 EACH
 TOTAL = 2 EACH

LEGEND

- ① TRAFFIC BARRIER TERMINAL, TYPE 5A
- ② TRAFFIC BARRIER TERMINAL, TYPE 1 (SPECIAL) TANGENT
- ③ STEEL PLATE BEAM GUARDRAIL (SHORT RADIUS)
- ④ TRAFFIC BARRIER TERMINAL, TYPE 2

FILE NAME = 10-273_SHLDR.DGN	DESIGNED - G.J.C.	REVISED -	4440 ASH GROVE SPRINGFIELD, IL. 62711 (217) 793-8600 www.fehr-graham.com	FEHR-GRAHAM & ASSOCIATES, LLC ENGINEERING AND SCIENCE CONSULTANTS FREEPORT, IL ROCKFORD, IL ROCHELLE, IL MONROE, WI SPRINGFIELD, IL	SHOULDER AND GUARDRAIL DETAIL			C.H.	SECTION	COUNTY	TOTAL SHEETS	SHEET NO.
	DRAWN - S.A.P.	REVISED -						48	08-00095-00-BR	SANGAMON	18	4
	CHECKED - G.J.C.	REVISED -			SCALE: 1"=20'	SHEET NO.	OF	SHEETS	PROPOSED STRUCTURE @ STA. 14+97.00	CONTRACT NO. 03553		
	DATE - 04/19/11	REVISED -								[ILLINOIS]		