

ROUTE NO.	SECTION	COUNTY	TOTAL SHEETS	SHEET NO.
C.H. 48	08-00095-00-BR	SANGAMON	18	1
ILLINOIS				

CONTRACT NO. **93553**

STATE OF ILLINOIS DEPARTMENT OF TRANSPORTATION DIVISION OF HIGHWAYS PLANS FOR PROPOSED HIGHWAY BRIDGE PROGRAM

**SECTION 08-00095-00-BR
SANGAMON COUNTY
C.H. 48
BROS-0167-(065)
JOB NO. C-96-217-11**

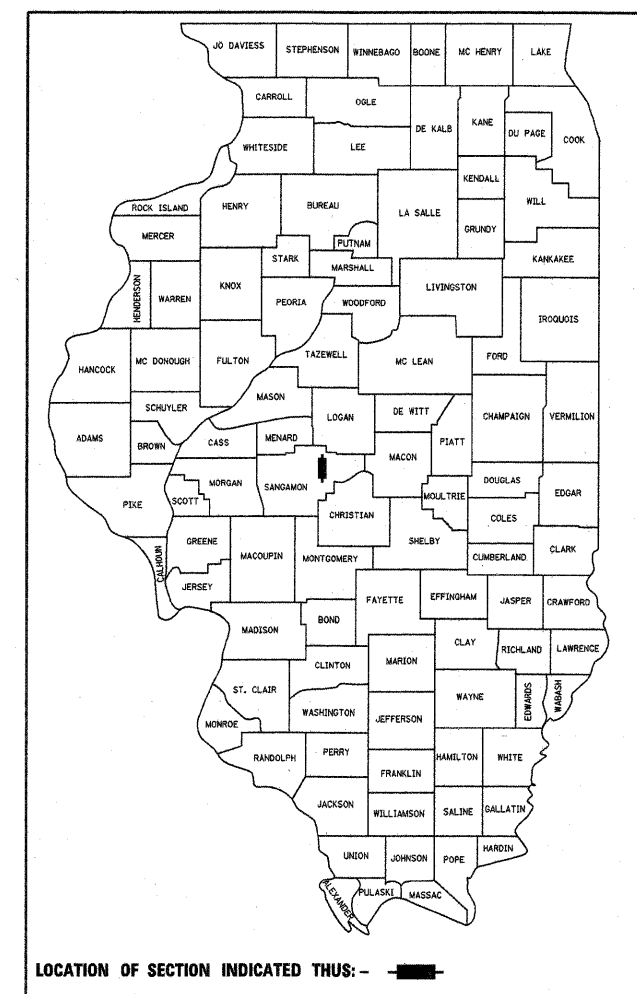

CLASSIFICATION: MINOR COLLECTOR (NON-URBAN)
DESIGN VOLUME: 400 ADT
CURRENT ADT: 185 (2012)
DESIGN SPEED: 40 M.P.H.

TOLL FREE JOINT UTILITY LOCATING
 INFORMATION FOR EXCAVATORS (J.U.L.I.E.)
 TELEPHONE NUMBER 1-800-892-0123

INDEX OF SHEETS	
SHEET NO.	TITLE
1.	COVER SHEET
2.	SUMMARY OF QUANTITIES, GENERAL NOTES & TYPICAL SECTIONS
3.	PLAN AND PROFILE SHEET
4.	SHOULDER & GUARDRAIL DETAILS
5.-13.	BRIDGE PLANS
14.-18.	STATION CROSS SECTIONS

STANDARDS	
280001-05	TEMPORARY EROSION CONTROL SYSTEMS
515001-03	NAME PLATE FOR BRIDGES
631011-07	TRAFFIC BARRIER TERMINAL TYPE 2
635006-03	REFLECTOR AND TERMINAL MARKER PLACEMENT
701901-01	TRAFFIC CONTROL DEVICES
BLR 21-8	TYPICAL APPLICATION OF TRAFFIC CONTROL DEVICES FOR CONSTRUCTION ON RURAL LOCAL HIGHWAYS
BLR 26-2	STEEL PLATE BEAM GUARDRAIL 700mm (27 1/2") HEIGHT
BLR 27-1	TRAFFIC BARRIER TERMINAL TYPE 5A
780001-02	TYPICAL PAYEMENT MARKINGS

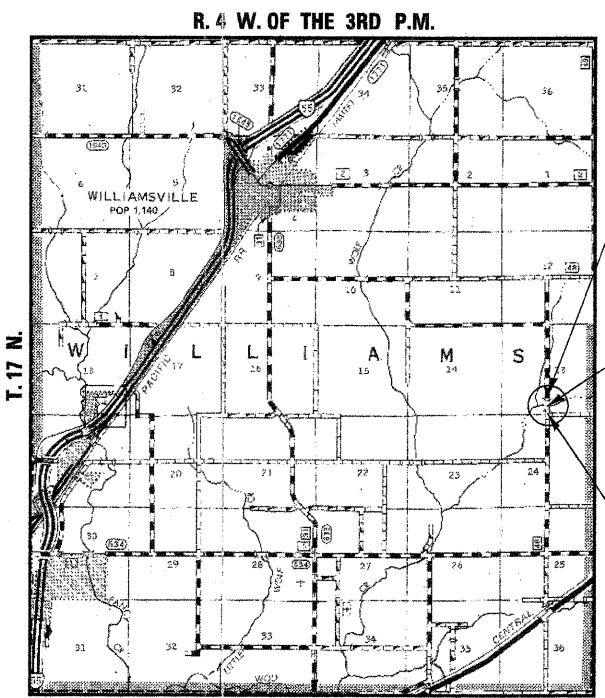

**IMPROVEMENT ENDS
STA. 17 + 50.00**

**STA. 14 + 97.00 - SPECIAL BRIDGE DESIGN
THREE SPAN P.P.C. DECK BEAM
(17" DEPTH) BRIDGE, THREE SPANS @
30'-0", 30'-0", 30'-0"; 91'-9" BK.-BK. ABUTS.;
30'-0" ROADWAY, 0° SKEW
PROPOSED S.N. 084-3443
EXISTING S.N. 084-3043**

**IMPROVEMENT BEGINS
STA. 12 + 00.00**

LOCATION PLAN

GROSS LENGTH OF SECTION = 550.00 FEET = 0.104 MILES
 NET LENGTH OF SECTION = 550.00 FEET = 0.104 MILES

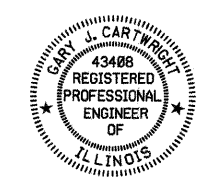
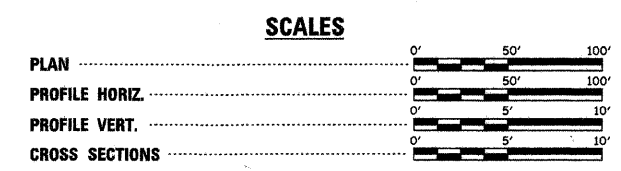
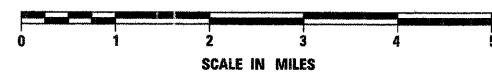

Gary J. Cartwright 4-27-11
 ILLINOIS PROFESSIONAL NO. 43408
 EXPIRES 11-30-11

APPROVED	<i>April 28, 2011</i>	20
	COUNTY ENGINEER	
PASSED	<i>May 23</i>	2011
	DISTRICT SIX CONSTRUCTION ENGINEER	
PASSED	<i>May 23</i>	2011
	DISTRICT SIX ENGINEER OF LOCAL ROADS & STREETS	
RELEASED FOR BID BASED ON LIMITED REVIEW	<i>May 23</i>	2011
	DEPUTY DIRECTOR OF HIGHWAYS, REGION FOUR ENGINEER	
STATE OF ILLINOIS DEPARTMENT OF TRANSPORTATION		

4440 ASH GROVE
 SPRINGFIELD, IL 62711
 (217) 793-8600
 www.fehr-graham.com

FEHR-GRAHAM & ASSOCIATES, LLC
 ENGINEERING AND SCIENCE CONSULTANTS
 PEORIA, IL ROCKFORD, IL ROCKFORD, IL SPRINGFIELD, IL