

NOTES: SEE I.D.O.T. STANDARD 780001 FOR TYPICAL PAVEMENT MARKINGS.  
 SEE SHEET 155 FOR DISTRICT ONE TYPICAL PAVEMENT MARKINGS DETAIL.  
 SEE SHEET 119 FOR RECESSED REFLECTIVE PAVEMENT MARKER SPACING.  
 SEE SHEET 142 FOR "RECESSED REFLECTIVE PAVEMENT MARKER DETAIL".

- RECESSED REFLECTIVE PAVEMENT MARKER LEGEND**
- ◄ ONE-WAY AMBER MARKER
  - ◄ ONE-WAY CRYSTAL MARKER
  - ◆ TWO-WAY AMBER MARKER

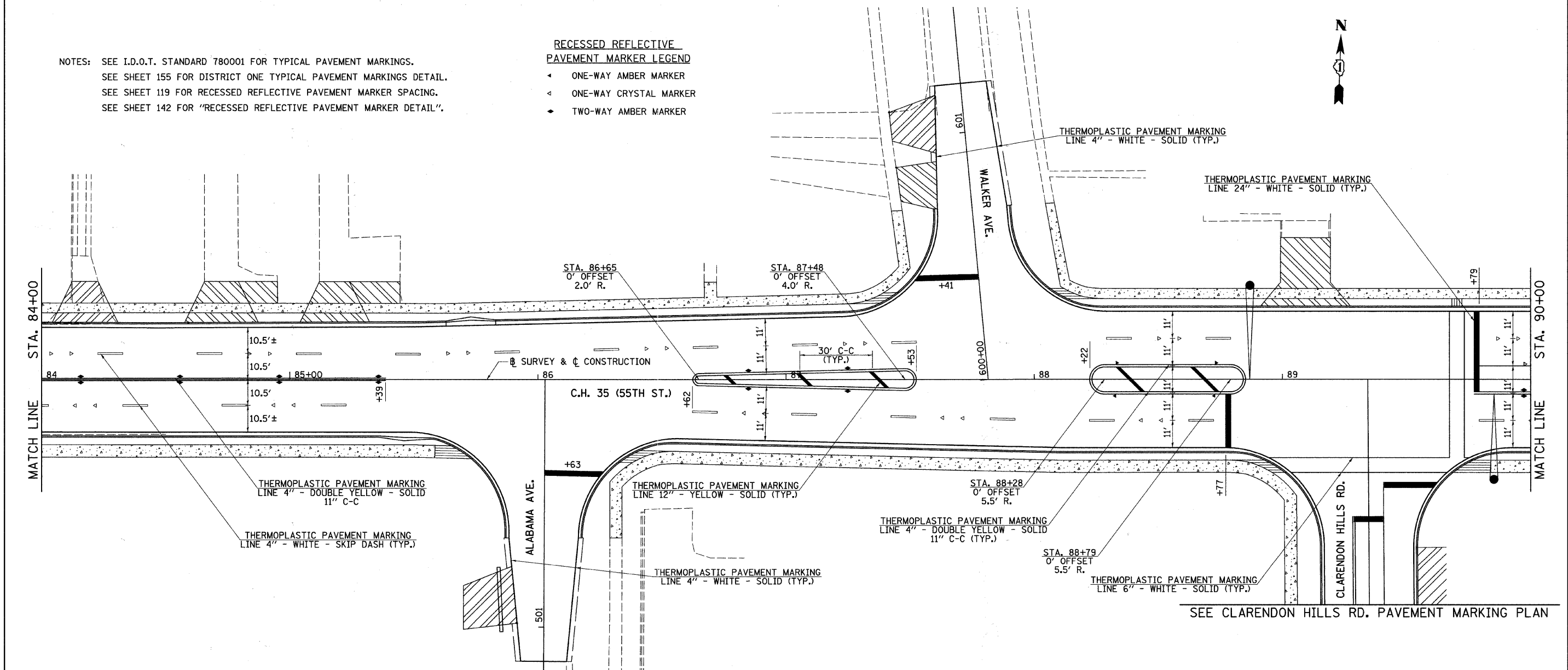

SEE CLARENDON HILLS RD. PAVEMENT MARKING PLAN

FILE NAME = v:\2791\2791e\007.dgn	USER NAME = shughes	DESIGNED -	REVISED -	<b>STATE OF ILLINOIS DEPARTMENT OF TRANSPORTATION</b>	<b>C.H. 35 (55TH ST.) PAVEMENT MARKING PLAN</b>			F.A.U. RTE.	SECTION	COUNTY	TOTAL SHEETS	SHEET NO.		
	PLOT SCALE = 20.0000' / IN.	CHECKED -	REVISED -					1504	94-00302-00-FP	DU PAGE	240	125		
	PLOT DATE = 5/19/2011	DATE -	REVISED -					SCALE: 1"=20'			SHEET NO. 7 OF 8 SHEETS	STA. 78+00 TO STA. 90+00	CONTRACT NO. 63609	
	[ILLINOIS] FED. AID PROJECT													