

DRAINAGE TAGS

- 40 INLET TA T11 F&G
STA 553+87, 22' LT
RIM = 806.00
INV = 803.62 W
- 41 30 LIN FT SS CL A 1 12" @ 0.50%
(TBF = 4 CY)
- 42 CB TA 4' DIA T11 F&G
STA 553+55, 22' LT
RIM = 805.60
INV = 803.46 N (EXIST)
INV = 803.46 E (PROP)
- 43 EX 12" RCP TO REMAIN
- 50 INLET TA T11 F&G
STA 557+91, 22' LT
RIM = 806.90
INV = 803.90 E
- 51 7 LIN FT SS CL A 1 12" @ 0.50%
(TBF = 1 CY)
- 52 CB TA 4' DIA T11 F&G
STA 558+01, 22' LT
RIM = 806.85
INV = 803.85 W
INV = 803.85 NE
- 53 31 LIN FT SS CL A 2 12" @ 1.68%
(TBF = 8 CY)
- 54 CB TA 4' DIA T11 F&G
STA 558+24, 46' LT
RIM = 806.83
INV = 803.33 E (EXIST)
INV = 803.33 SW (PROP)
- 55 EX 12" RCP TO REMAIN
- 60 INLET TA T11 F&G
STA 559+27, 23' RT
RIM = 806.90
INV = 803.90 E
- 61 23 LIN FT SS CL A 1 12" @ 1.00%
(TBF = 3 CY)
- 62 CB TA 4' DIA T11 F&G
STA 559+54, 23' LT
RIM = 806.66
INV = 803.91 W
INV = 803.91 N
- 63 40 LIN FT SS CL A 2 12" @ 2.00%
(TBF = 8 CY)
- 64 INLET TA T11 F&G
STA 559+65, 22' LT
RIM = 806.00
INV = 803.02 W
- 65 7 LIN FT SS CL A 1 12" @ 0.50%
(TBF = 1 CY)
- 66 CB TA 4' DIA T11 F&G
STA 559+55, 22' LT
RIM = 805.75
INV = 802.98 S
INV = 802.98 E
INV = 802.98 W
- 67 75 LIN FT SS CL A 2 12" @ 0.44%
(TBF = 16 CY)

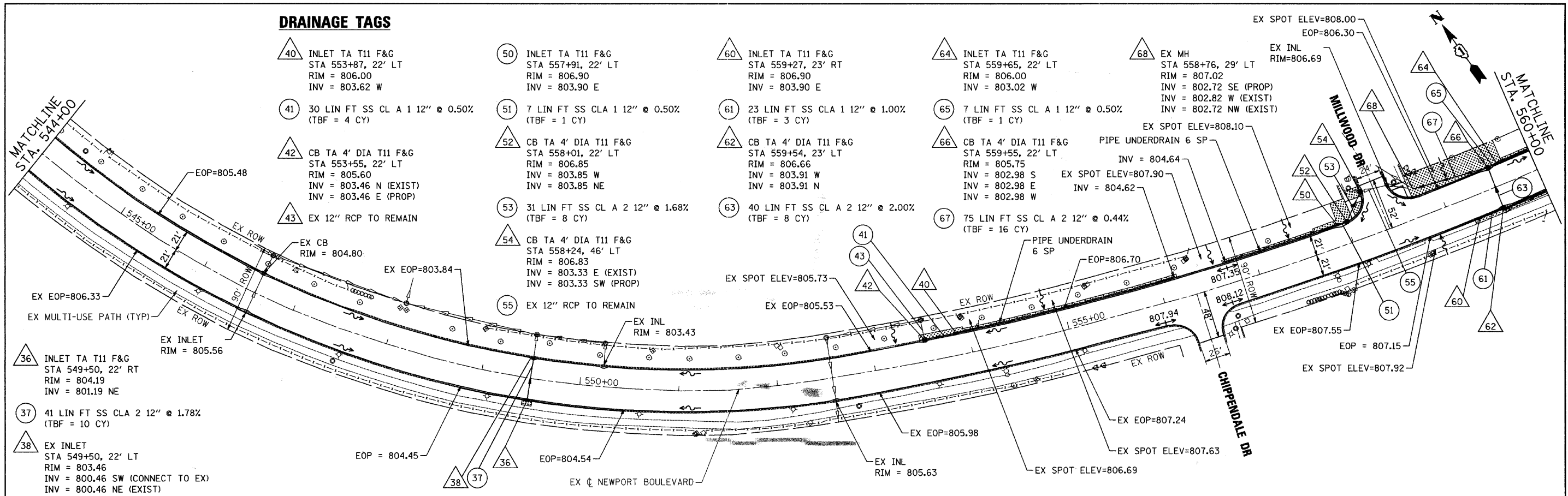

DRAINAGE TAGS

- 70 INLET TA T11 F&G
STA 564+15, 23' RT
RIM = 803.60
INV = 801.01 W
- 71 7 LIN FT SS CL A 1 12" @ 0.50%
(TBF = 1 CY)
- 72 EX INLET TO BE ADJ
STA 564+05, 23' RT
RIM = 803.47
INV = 800.97 E (CONNECT TO EX)
INV = 800.97 N (EXIST)
- 73 EX 12" RCP TO REMAIN

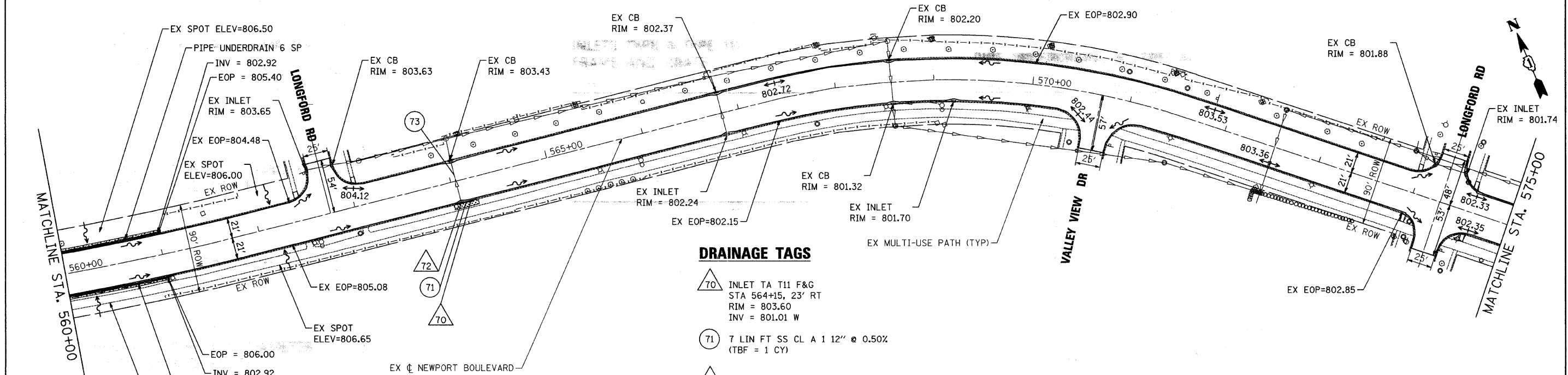

NOTE:
PIPE UNDERDRAIN CONNECTIONS
TO STORM STRUCTURES WILL NOT
BE PAID FOR SEPERATELY, BUT
INCLUDED IN THE COST OF PIPE
UNDERDRAINS 6" (SPECIAL).

NOTE:
RIM ELEVATIONS ARE AT EOP.
STATION OFFSET LOCATIONS ARE
AT BACK OF CURB.



COMPANY NAME: HRGreen.com
PROJECT CONTACT: Jstrzal
DATE PLOTTED: 5/10/2011 9:16:14 AM
FILE NAME: 86090304-draw-02.dwg
PLOT DRIVER: McHenry-1050-dotter-AS.LSP
PEN TABLE: STANDARD-TRANS.TBL

USER NAME = Jstrzal PLOT SCALE = 1" = 50' PLOT DATE = 5/10/2011	DESIGNED - JJS DRAWN - JPA CHECKED - AC DATE -	REVISED - REVISED - REVISED - REVISED -	VILLAGE OF BARTLETT	DRAINAGE PLAN NEWPORT BOULEVARD		F.A.U. RTE. 3805	SECTION 11-00088-00-RS	COUNTY DUPAGE	TOTAL SHEETS 21	SHEET NO. 9
	SCALE: 1" = 50' SHEET NO. 2 OF 3 SHEETS STA. 544+00 TO STA. 575+00			ILLINOIS FED. AID PROJECT		CONTRACT NO. 63604				