

EXISTING

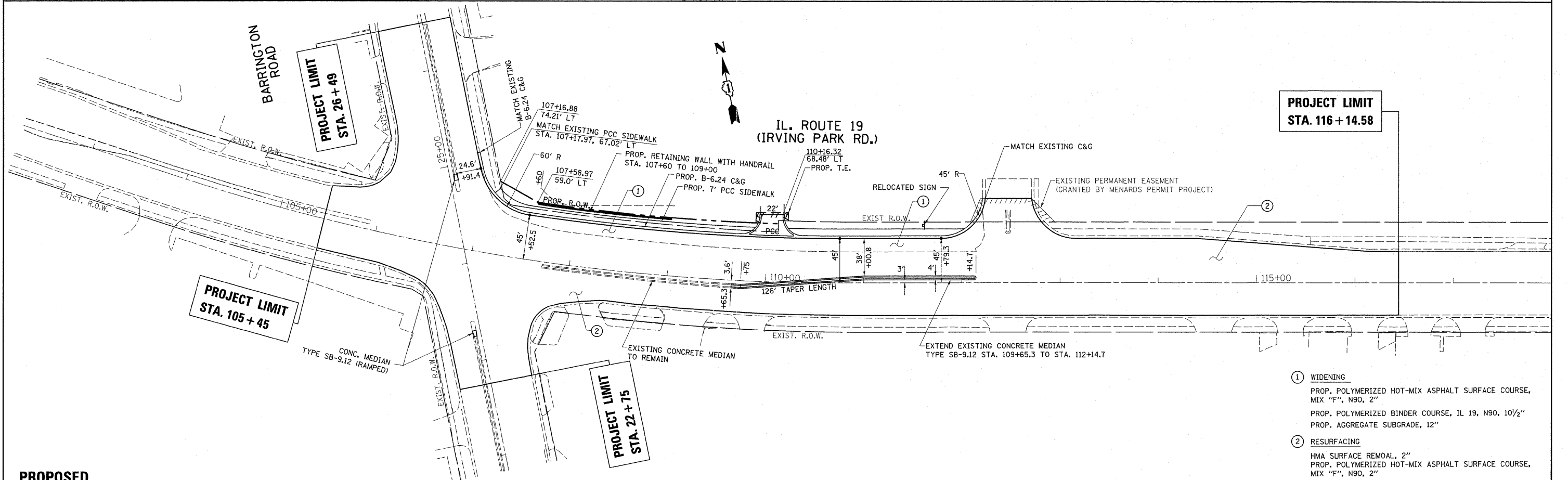

PROPOSED

- ① **WIDENING**
 PROP. POLYMERIZED HOT-MIX ASPHALT SURFACE COURSE, MIX "F", N90, 2"
 PROP. POLYMERIZED BINDER COURSE, IL 19, N90, 10 1/2"
 PROP. AGGREGATE SUBGRADE, 12"
- ② **RESURFACING**
 HMA SURFACE REMOVAL, 2"
 PROP. POLYMERIZED HOT-MIX ASPHALT SURFACE COURSE, MIX "F", N90, 2"

FILE NAME =	USER NAME = midyja	DESIGNED -	REVISED -	STATE OF ILLINOIS DEPARTMENT OF TRANSPORTATION	IL. RTE. 19 (IRVING PARK RD.) AT BARRINGTON RD. EXISTING AND PROPOSED ROADWAY PLAN				F.A.I. RTE.	SECTION	COUNTY	TOTAL SHEETS	SHEET NO.
ct:\pw\work\pwsdot\mddyja\d0156246\VP141809-shr-plan.dgn		DRAWN -	REVISED -		1321	2010-048-N	COOK	53	11				
PLOT SCALE = 5/8"=1'-0"		CHECKED -	REVISED -						CONTRACT NO. 60L23				
PLOT DATE = 5/12/2011		DATE -	REVISED -		SCALE:	SHEET NO.	OF SHEETS	STA.	TO STA.	ILLINOIS FED. AID PROJECT			