

- NOTES:
1. GRADE CHANNEL TO MAINTAIN UNIFORM SLOPE FROM BEGINNING POINT TO END POINT.
 2. CHANNEL CROSS SECTION WITHIN AREA OF WORK TO MATCH EXISTING CHANNEL CROSS SECTION UPSTREAM OF WORK AREA.
 3. INSTALL SILT FENCE AT LIMITS OF SOIL DISTURBANCE.

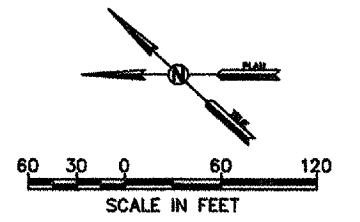

STATE OF ILLINOIS
 JOSEPH M. WEISSERT
 LICENSED PROFESSIONAL ENGINEER
 No. 062-053095
 EXP. 11/30/05

DESIGNED BY: TAC
 DRAWN BY: DEM
 CHECKED BY: DJT
 DATE: 6/10/05

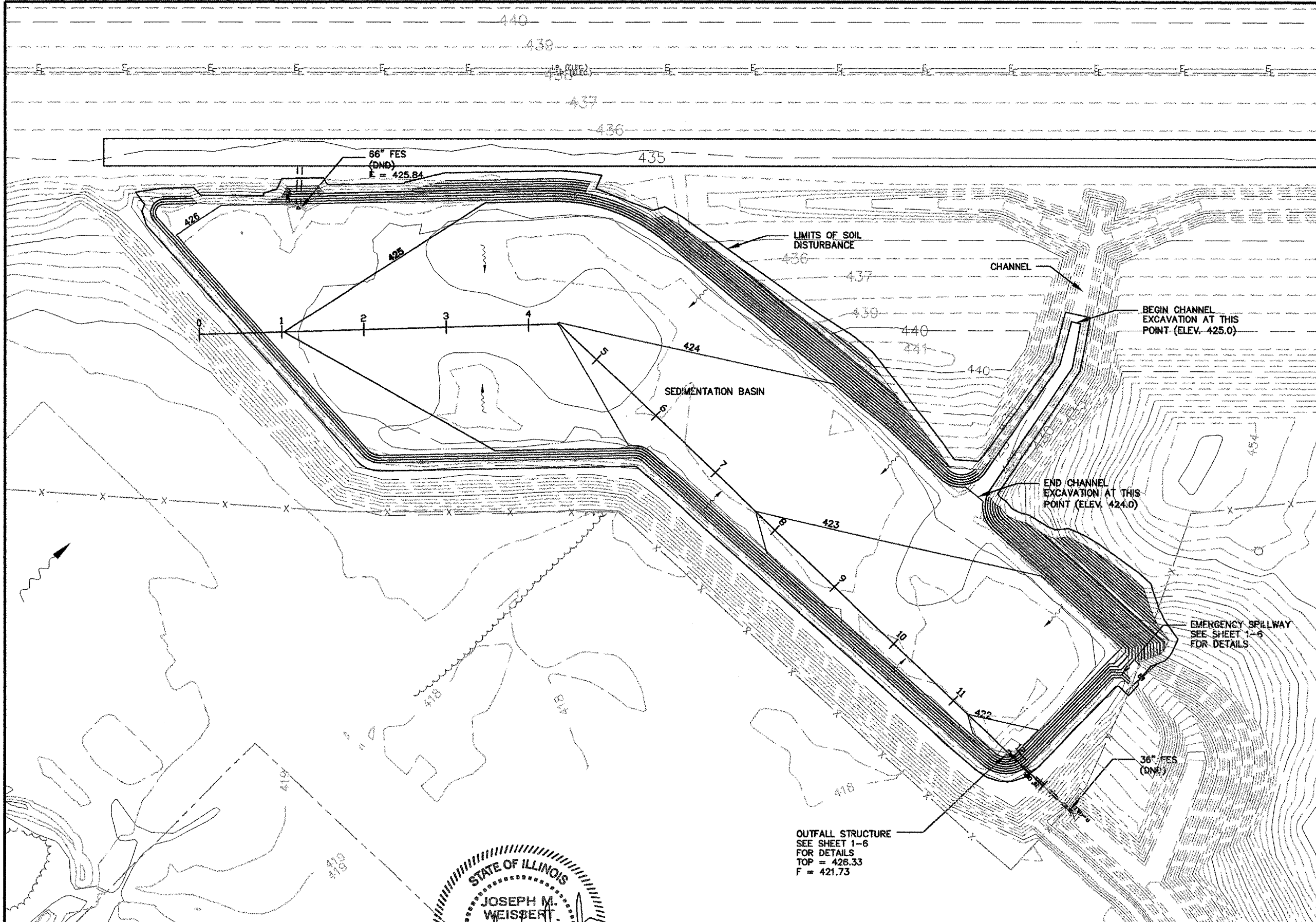

SEDIMENTATION BASIN
CONVERSION

1075 Eastgate Drive
 O'Fallon, Illinois 62269
 PH 618-624-2628
 FAX 618-624-2730



GRADING AND
DRAINAGE PLAN
(SB 145)

DWG. FILE NAME
84725c09
 SHEET NO.
1-2

REV.	DATE	BY	APPR.	DESCRIPTION	PLOT FILE

L:\WORK\05\062-053095\05062-053095.DWG, DWG, 05/23/05 11:41:11 AM