

JOINT TYPE-B (THICKENED EDGE)

NOT TO SCALE

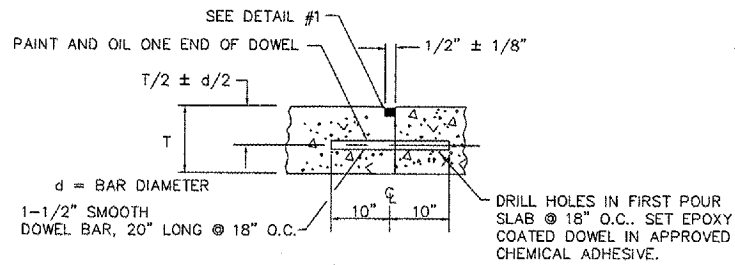

JOINT TYPE-D (DOWELED)

NOT TO SCALE

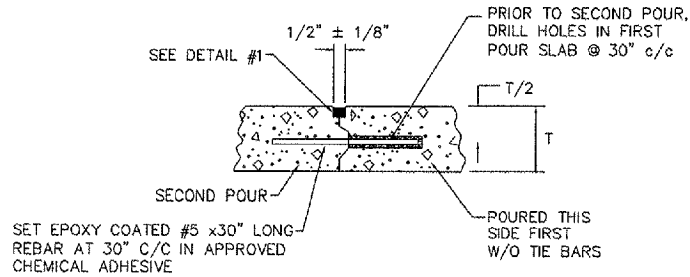

JOINT TYPE-E HINGED WITH KEY

NOT TO SCALE

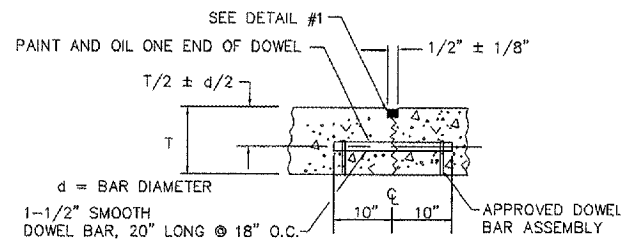

JOINT TYPE-F (DOWELED)

NOT TO SCALE

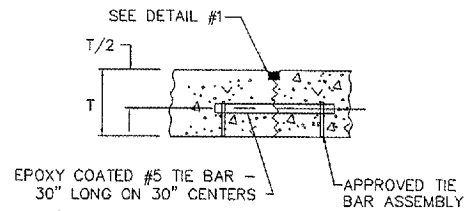

JOINT TYPE-G (HINGED)

NOT TO SCALE

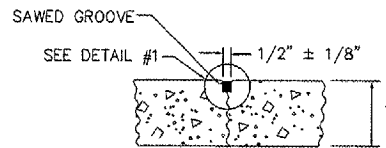

JOINT TYPE-H (DUMMY)

NOT TO SCALE

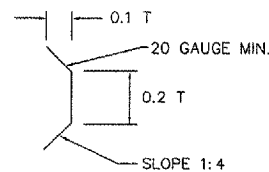

KEYWAY DETAIL

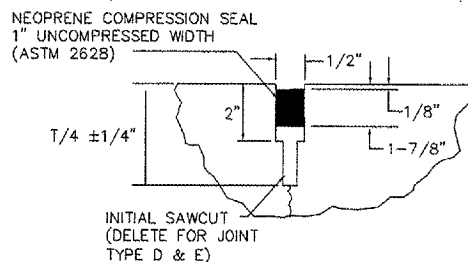

**DETAIL NO. 1
JOINT TYPE-D,E,F & H**

NOTES - JOINT DETAILS

- 1.) ALL TRANSVERSE JOINTS MUST BE CONTINUOUS ACROSS PAVEMENT EXCEPT TIED TRANSVERSE CONSTRUCTION JOINTS.
- 2.) JOINTS SHALL BE SAWS TO A DEPTH OF T/4 FOR TRANSVERSE JOINTS & T/3 FOR LONGITUDINAL JOINTS. UNLESS OTHERWISE NOTED, SAW JOINTS SHALL BE SEALED WITH PREFORMED POLYCHLOROPRENE ELASTOMERIC JOINT SEAL.
- 3.) TYPE-D JOINTS WITHOUT BAR ASSEMBLY SHALL BE INSTALLED AT THE END OF EACH DAYS POUR EXCEPT AS NOTED IN SEC. 501-3.12(d)(3) OF THE STANDARD SPECIFICATIONS.

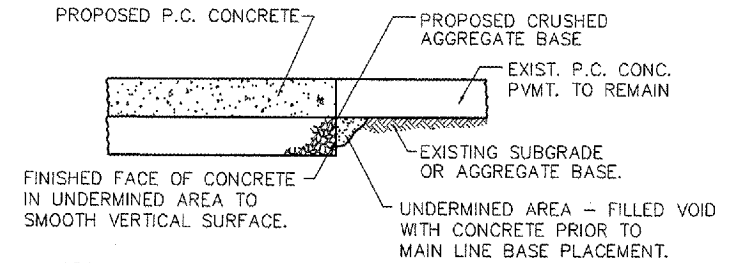

NOTES:

- 1.) REMAINING VOIDS SHALL BE PRESSURE GROUTED.
- 2.) REQUIRED UNDERMINING REPAIRS, AS DETERMINED BY THE ENGINEER, SHALL BE THE RESPONSIBILITY OF THE CONTRACTOR AND SHALL BE CONSIDERED INCIDENTAL TO 17\"/>

UNDERMINING REPAIR DETAIL

NOT TO SCALE

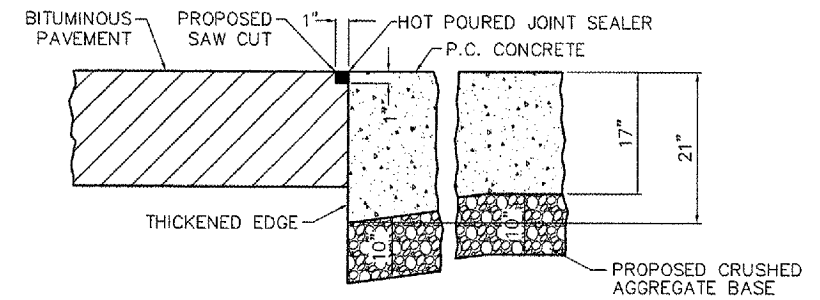

JOINT BETWEEN FLEXIBLE AND RIGID PAVEMENTS

NOT TO SCALE

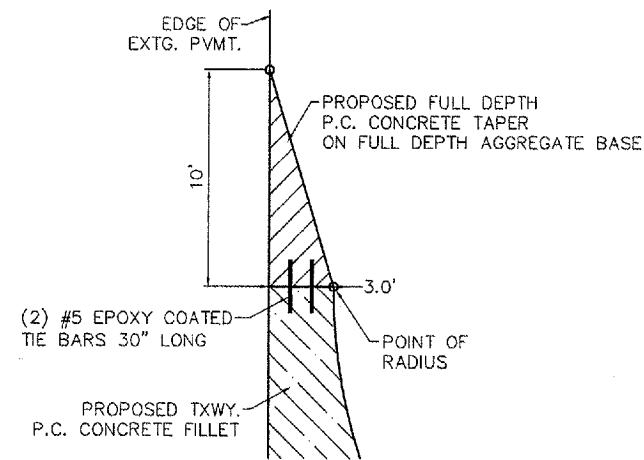

P.C. CONCRETE TAPER DETAIL

NOT TO SCALE

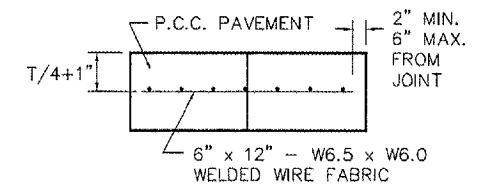

ODD SHAPED PANEL REINFORCEMENT (SYMBOL R)

REVISIONS		
NO.	ITEM	DATE

PLOTTING SCALE:	1:1
DRAWN BY:	MLK
CHECKED BY:	
DATE:	MAY 2005