

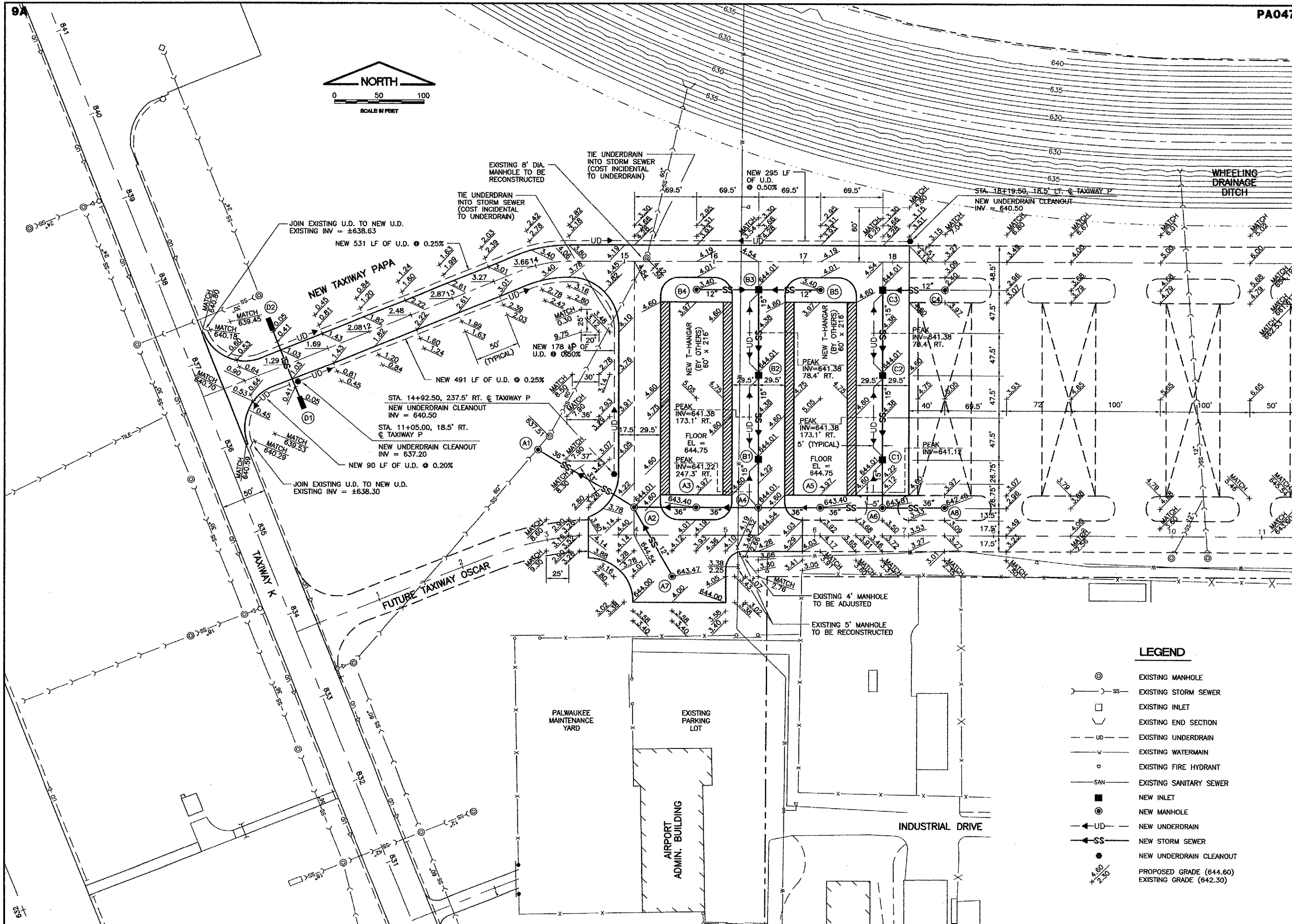

REVISIONS		
NUMBER	BY	DATE

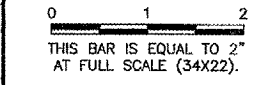

**PALWAUKEE MUNICIPAL AIRPORT
 WHEELING / PROSPECT HEIGHTS ILLINOIS**

NORTHEAST QUADRANT SITEWORK

**DRAINAGE AND GRADING PLAN -
 NORTHEAST QUADRANT**

- LEGEND**
- ⊙ EXISTING MANHOLE
 - SS — EXISTING STORM SEWER
 - EXISTING INLET
 - UD — EXISTING UNDERDRAIN
 - W — EXISTING WATERMAIN
 - SAN — EXISTING FIRE HYDRANT
 - SAN — EXISTING SANITARY SEWER
 - NEW INLET
 - ⊙ NEW MANHOLE
 - UD — NEW UNDERDRAIN
 - SS — NEW STORM SEWER
 - NEW UNDERDRAIN CLEANOUT
 - ▲ PROPOSED GRADE (644.60)
 - EXISTING GRADE (642.30)

© Copyright CMT, Inc.

CMT
 CRAWFORD, MURPHY & TILLY, INC.
 CONSULTING ENGINEERS
 License No. 184-000613

Palwaukee
 Municipal Airport

DESIGN BY: MLK
 DRAWN BY: JRO
 CHECKED BY:
 APPROVED BY:
 DATE: 06/28/05
 JOB No: 03290-02
 ILLINOIS PROJECT: PWK-3471