

PATH: K:\PaiwaukeeAp\0329002\draw
 FILE: Siteplan.dwg
 UPDATE BY: johse
 SURVEY BOOK #
 XREF DWG:
 XREF DWG:
 DATE: Wed 6/8/05 2:49pm



LEGEND

- NEW BITUMINOUS PAVEMENT
- EXISTING FENCE LINE
- EXISTING BUILDING
- NEW T-HANGAR (BY OTHERS)
- FUTURE T-HANGAR
- AIRPORT PROPERTY LINE
- FUTURE PAVEMENT
- VERTICAL CONTROL BENCHMARK
- HORIZONTAL CONTROL POINT
- PROJECT LIMITS

REVISIONS

NUMBER	BY	DATE

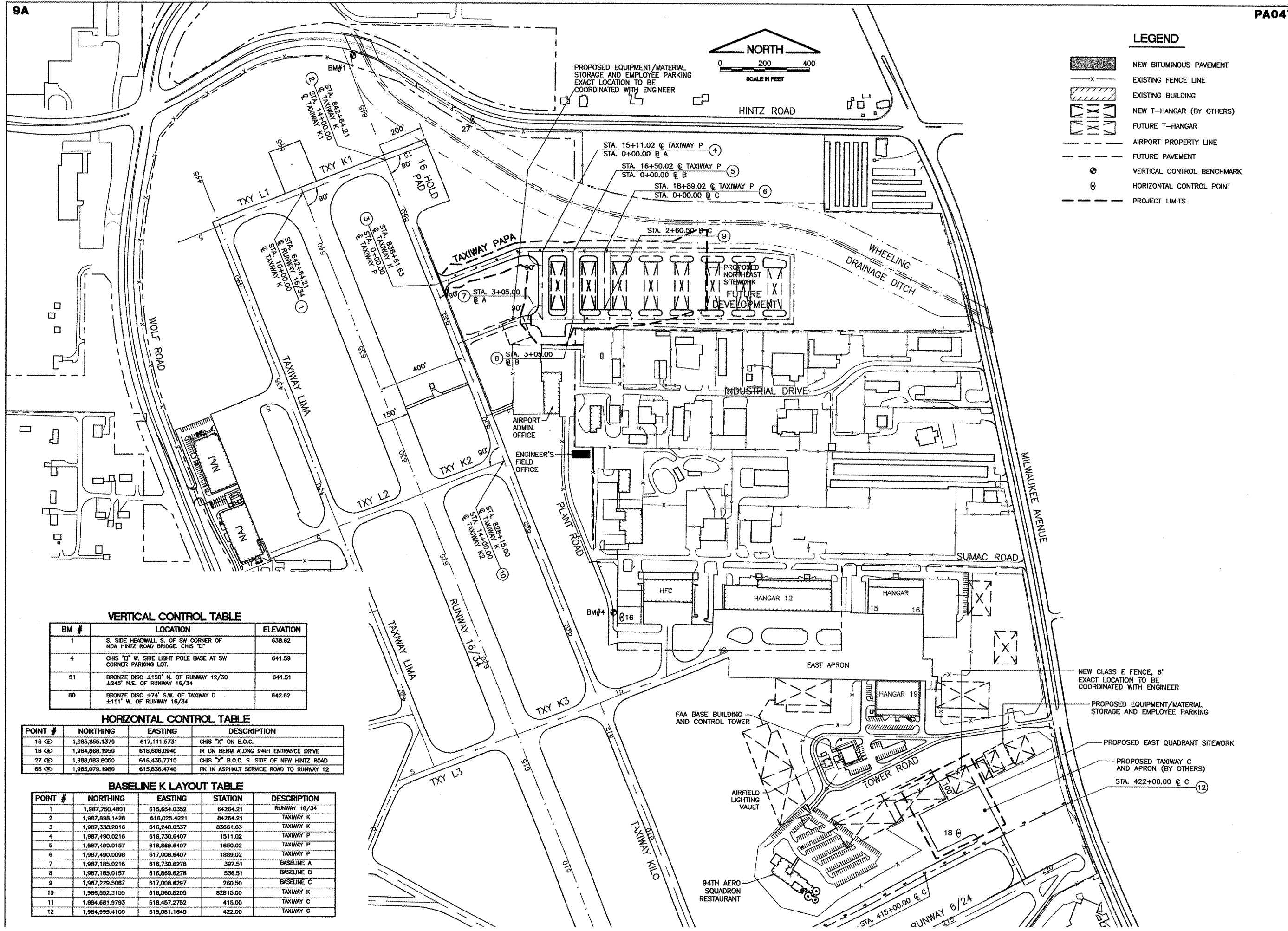
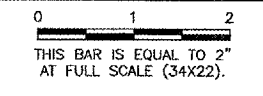

VERTICAL CONTROL TABLE

BM #	LOCATION	ELEVATION
1	S. SIDE HEADWALL S. OF SW CORNER OF NEW HINTZ ROAD BRIDGE. CHIS "I"	638.62
4	CHIS "I" W. SIDE LIGHT POLE BASE AT SW CORNER PARKING LOT.	641.59
51	BRONZE DISC ±150' N. OF RUNWAY 12/30 ±245' N.E. OF RUNWAY 16/34	641.51
80	BRONZE DISC ±74' S.W. OF TAXIWAY D ±111' W. OF RUNWAY 16/34	642.62

HORIZONTAL CONTROL TABLE

POINT #	NORTHING	EASTING	DESCRIPTION
16	1,985,855.1379	617,111.6731	CHIS "X" ON B.O.C.
18	1,984,868.1950	618,608.0940	IR ON BERM ALONG 94TH ENTRANCE DRIVE
27	1,988,083.8050	616,435.7710	CHIS "X" B.O.C. S. SIDE OF NEW HINTZ ROAD
66	1,985,079.1980	615,836.4740	PK IN ASPHALT SERVICE ROAD TO RUNWAY 12

BASELINE K LAYOUT TABLE

POINT #	NORTHING	EASTING	STATION	DESCRIPTION
1	1,987,750.4801	615,654.0352	64284.21	RUNWAY 16/34
2	1,987,898.1428	616,025.4221	84284.21	TAXIWAY K
3	1,987,338.2016	616,248.0537	83681.63	TAXIWAY K
4	1,987,490.0216	616,730.6407	1511.02	TAXIWAY P
5	1,987,490.0157	616,869.6407	1650.02	TAXIWAY P
6	1,987,490.0098	617,008.6407	1889.02	TAXIWAY P
7	1,987,185.0216	616,730.6278	397.51	BASELINE A
8	1,987,185.0157	616,869.6278	536.51	BASELINE B
9	1,987,229.8067	617,008.6297	260.50	BASELINE C
10	1,986,552.3155	616,560.5205	82815.00	TAXIWAY K
11	1,984,681.9793	618,457.2752	415.00	TAXIWAY C
12	1,984,999.4100	619,081.1645	422.00	TAXIWAY C

**PALWAUKEE MUNICIPAL AIRPORT
 WHEELING / PROSPECT HEIGHTS ILLINOIS
 NORTHEAST QUADRANT SITEWORK
 SITE PLAN/
 PROJECT CONTROL PLAN**

Copyright: CMT, Inc.
CMT
 CRAWFORD, MURPHY & TILLY, INC.
 CONSULTING ENGINEERS
 License No. 184-000613

DESIGN BY:	ARM
DRAWN BY:	JRO
CHECKED BY:	
APPROVED BY:	
DATE:	06/28/05
JOB No:	03290-02
ILLINOIS PROJECT: PWK-3471	