

JUN 10, 2005 12:43 PM CCC
 I:\AIRPORTS\DECATUR\802-04TYXD\AIRPORT\SHEETS\CONTRACT-1\8-308-XS.DWG - STA. 379+00 TO 380+00

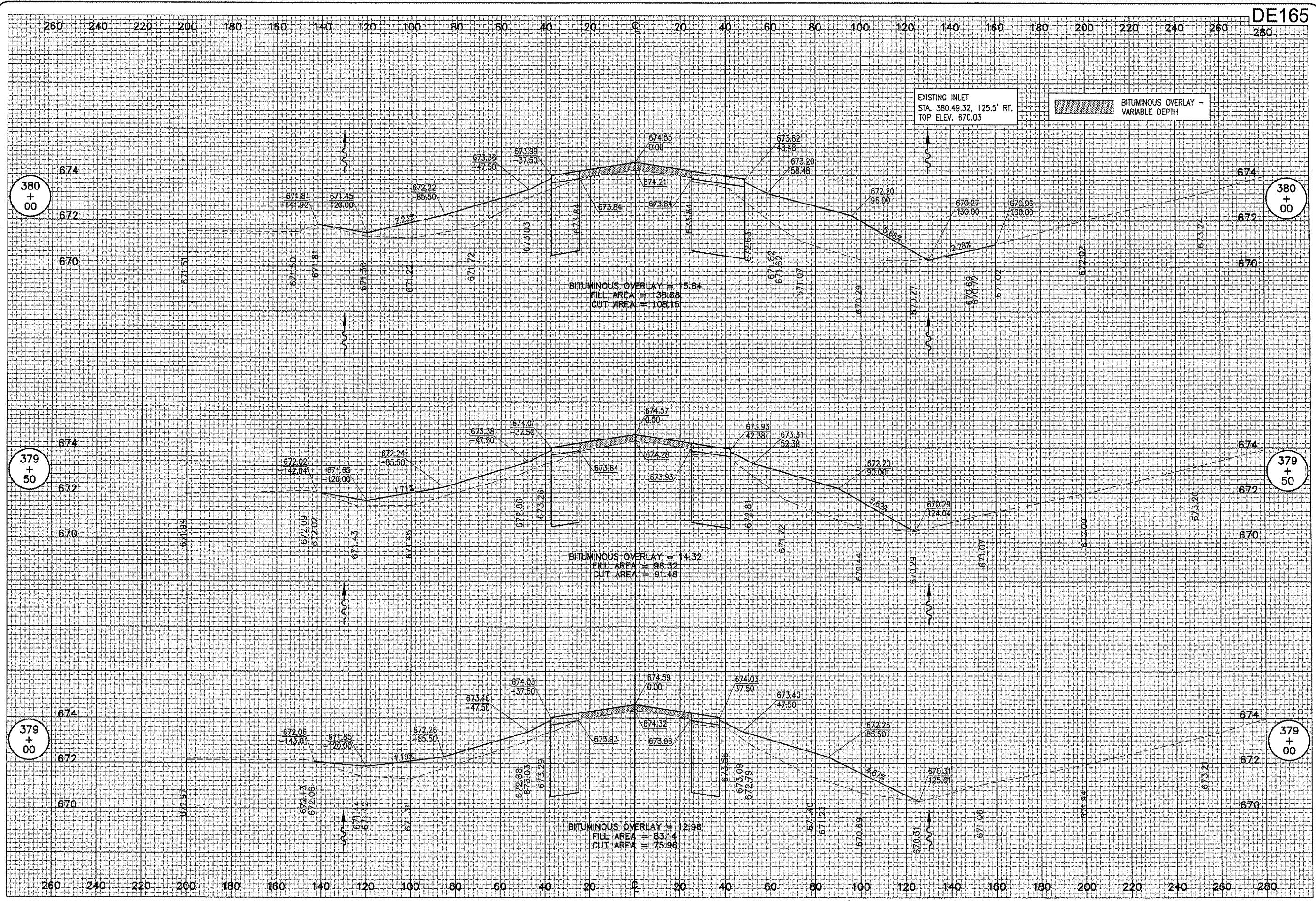

REVISION	DATE

DECATUR, ILLINOIS

IL PROJ.: DEC-3414 A.I.P. PROJ.: 3-17-0033-28

REV. Project No. 802-04TYXD	
Drawn: 308-XS.DWG	
Scale: 1" = 50'	
Date: 11/11/04	
LAYOUT	CCC 11/11/04
DRAWN	CCC 11/11/04
REVIEWED	CAH 06/07/05

HANSON

Engineers, Architects, Scientists
 1525 South Sixth Street
 Springfield, Illinois 62703-2886
 Offices Nationwide

**TAXIWAY G WIDENING
 PHASE II**

PROPOSED CROSS-SECTIONS
 TAXIWAY "G"
 STA. 379+00 TO STA. 380+00