

F.A.S. RTE.	SECTION	COUNTY	TOTAL SHEETS	SHEET NO.
69 ^c	03 00088-00-WR	CRAWFORD	56	38
STA. 64+00	TO STA. 68+14.20			
FED. ROAD DIST. NO.		ILLINOIS	FED. AID PROJECT	
CONTRACT NO. 95433				

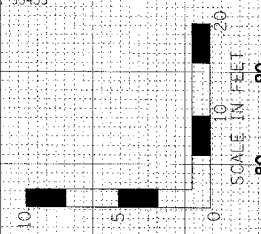

FINAL SURVEYED BY: DATE:
 SURVEY:
 NOTE BOOK:
 NO. AREAS CHECKED:

REGION SURVEYED BY: DATE:
 SURVEY:
 NOTE BOOK:
 NO. AREAS CHECKED:

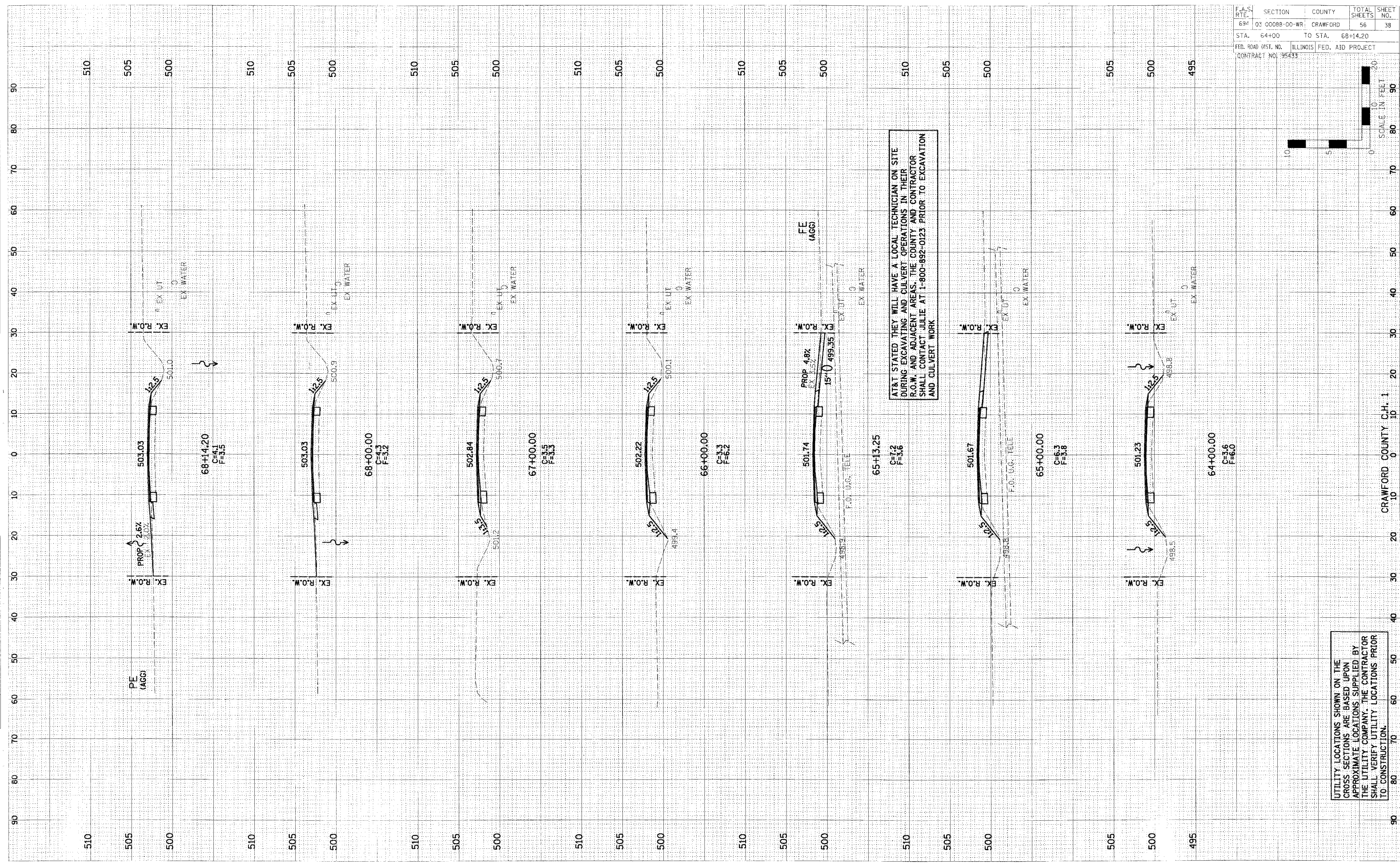

AT&T STATED THEY WILL HAVE A LOCAL TECHNICIAN ON SITE DURING EXCAVATING AND CULTURE OPERATIONS IN THEIR R.O.W. AND ADJACENT AREAS. THE COUNTY AND CONTRACTOR SHALL CONTACT JULIE AT 1-800-892-0123 PRIOR TO EXCAVATION AND CULTURE WORK

UTILITY LOCATIONS SHOWN ON THE CROSS SECTIONS ARE BASED UPON APPROXIMATE LOCATIONS SUPPLIED BY THE UTILITY COMPANY. THE CONTRACTOR SHALL VERIFY UTILITY LOCATIONS PRIOR TO CONSTRUCTION.