

F.A.S. RTE.	SECTION	COUNTY	TOTAL SHEETS	SHEET NO.
694	03-00088-00-WR	CRAWFORD	56	34
STA. 43+00	TO STA. 46+61.10			
FED. ROAD DIST. NO. ILLINOIS		FED. AID PROJECT		
CONTRACT NO. 95433				

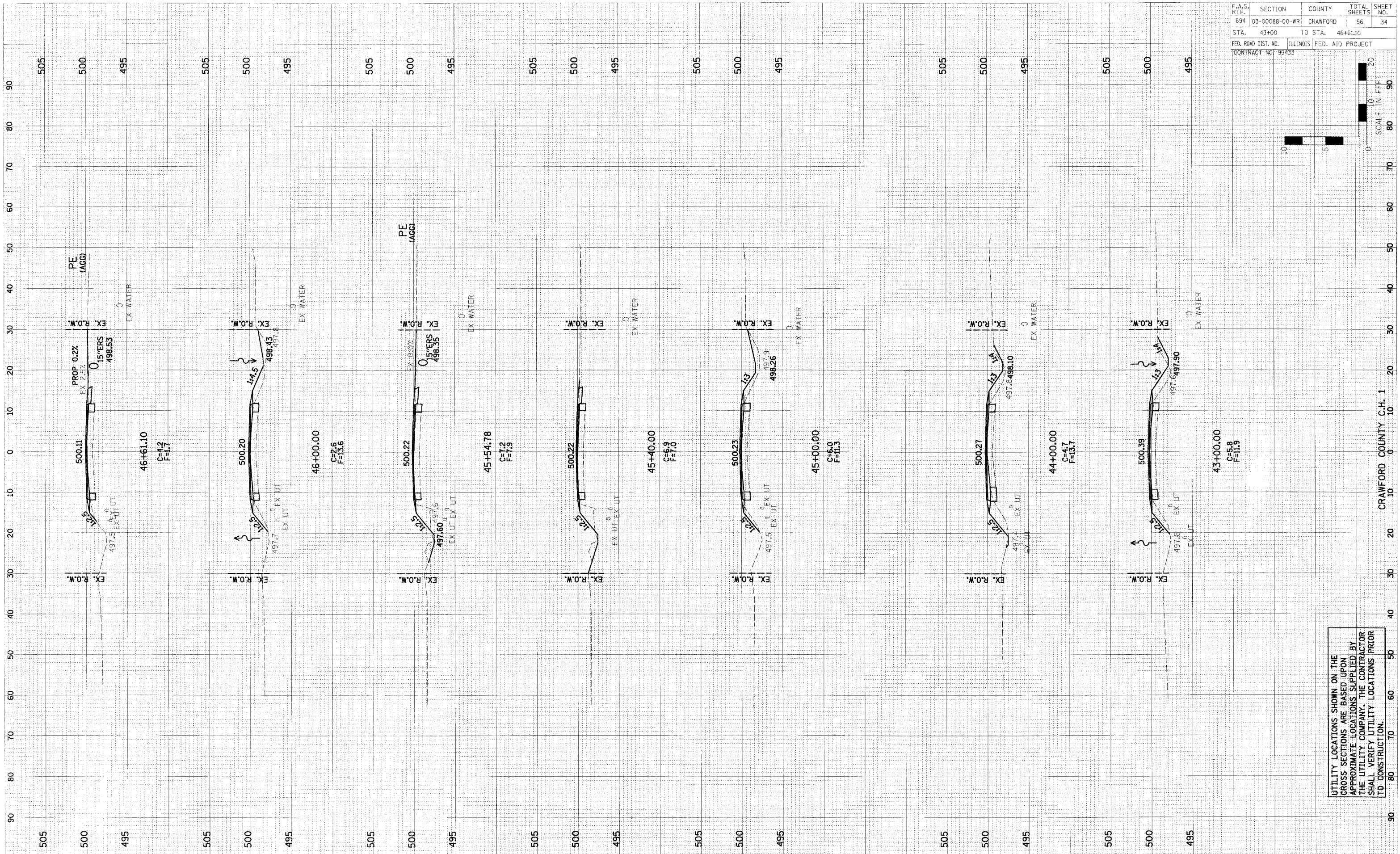
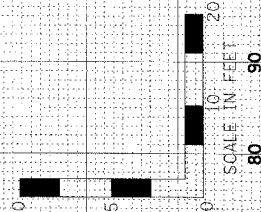

DATE	BY	REVISION
		1. SURVEYED
		2. PLOTTED
		3. CHECKED
		4. APPROVED

DATE	BY	REVISION
		1. ORIGINAL
		2. SURVEY
		3. PLOTTED
		4. CHECKED
		5. APPROVED

UTILITY LOCATIONS SHOWN ON THE CROSS SECTIONS ARE BASED UPON APPROXIMATE LOCATIONS SUPPLIED BY THE UTILITY COMPANY. THE CONTRACTOR SHALL VERIFY UTILITY LOCATIONS PRIOR TO CONSTRUCTION.