

F.A.S. RTE.	SECTION	COUNTY	TOTAL SHEETS	SHEET NO.
694	03-00088-00-WR	CRAWFORD	56	18
STA. 155+50		TO STA. 159+86.21		
FED. ROAD DIST. NO.		ILLINOIS	FED. AID PROJECT	
CONTRACT NO. 95433				

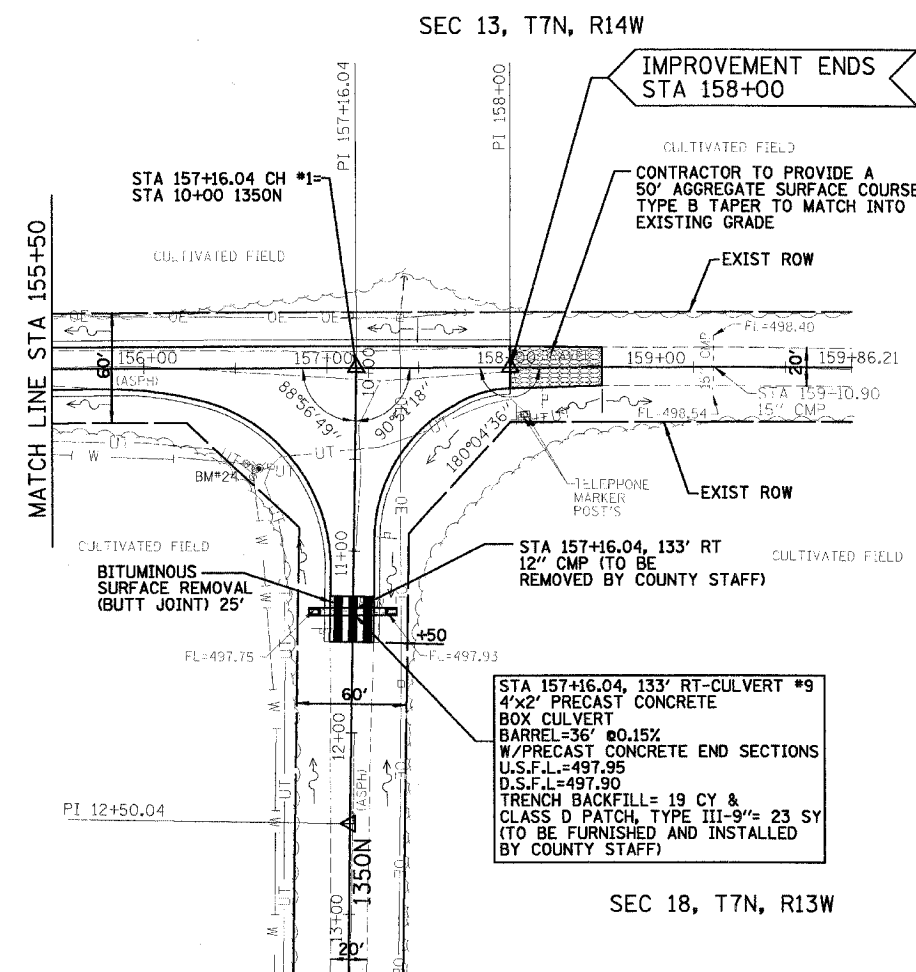

COUNTY HIGHWAY #1 (200E)

- NOTES:
1. ELLIP=ELLIPTICAL  
ERS=EQUIVALENT ROUND SIZE  
PRC=PRECAST REINFORCED CONCRETE  
FES=FLARED END SECTIONS
  2. SEE CROSS SECTIONS FOR LOCATIONS WHERE THE CONTRACTOR SHALL GRADE DITCHES.

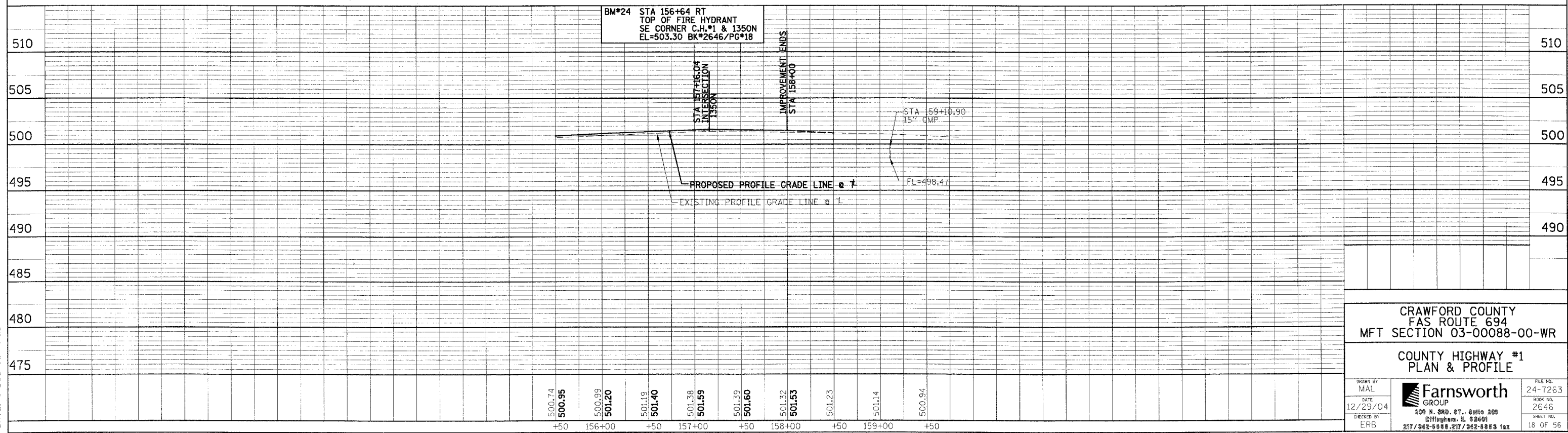

CRAWFORD COUNTY  
FAS ROUTE 694  
MFT SECTION 03-00088-00-WR

COUNTY HIGHWAY #1  
PLAN & PROFILE

DRAWN BY MAL	DATE 12/29/04	CHECKED BY ERB	FILE NO. 24-7263	BOOK NO. 2646	SHEET NO. 18 OF 56
-----------------	------------------	-------------------	---------------------	------------------	-----------------------

Farnsworth GROUP  
200 N. 9th St., Suite 205  
Effingham, IL 62401  
217/342-8888, 217/342-8883 fax

FILE: c:\userp\dgm\pdpeng.dgn  
DATE: 8-Dec-06 12:10