

F.A.P. RTE.	SECTION	COUNTY	TOTAL SHEETS	SHEET NO.
301	22BR-1	STEPHENSON	32	1

STATE OF ILLINOIS
DEPARTMENT OF TRANSPORTATION
DIVISION OF HIGHWAYS

**PROPOSED
HIGHWAY PLANS**

FAP ROUTE 301 (US 20)
SECTION 22BR-1
PROJECT BHF-0301(033)
STEPHENSON COUNTY
C-92-131-05

FOR INDEX OF SHEETS, SEE SHEET NO. 2
FOR STATE STANDARDS, SEE SHEET NO. 2

PROJECT ENGINEER: BOB WAGNER

SQUAD LEADER: SAMEER ABDULLAH
(815) 284-5935

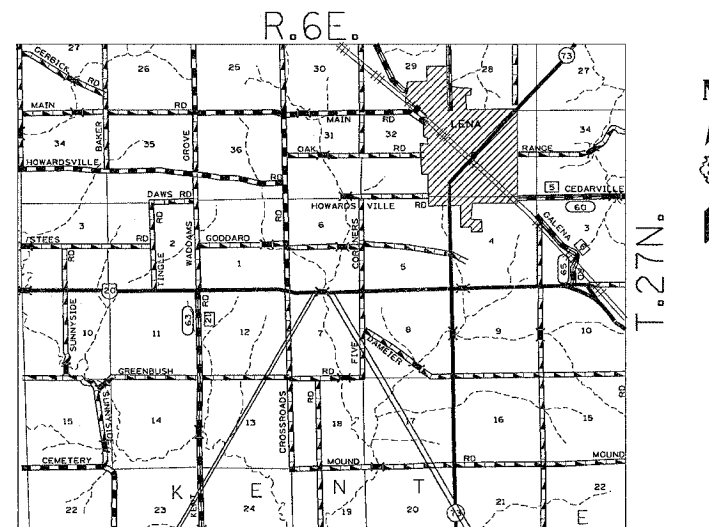
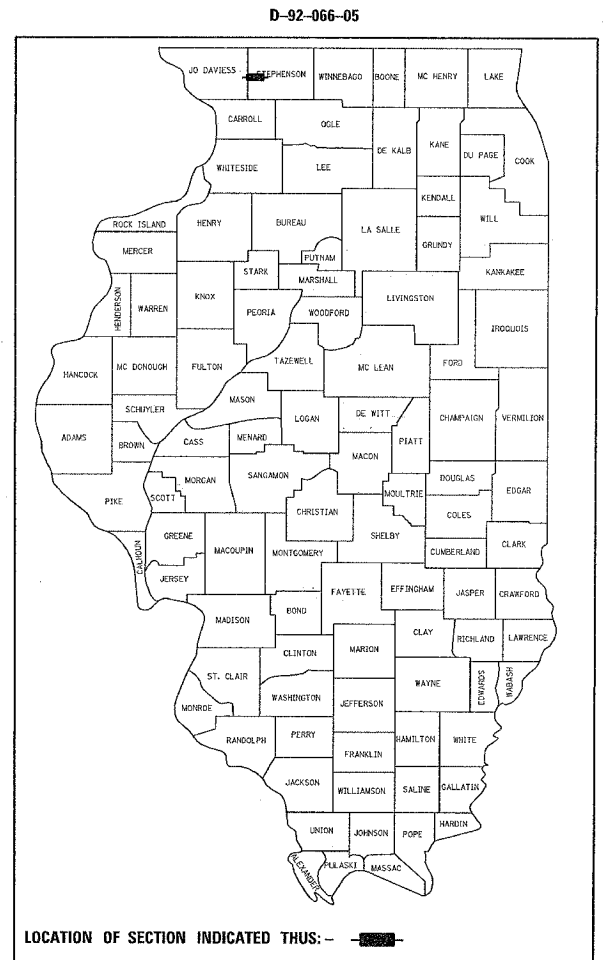

IMPROVEMENT BEGINS STA. 7+73
SECTION BEGINS STA. 10+36
IMPROVEMENT ENDS STA. 14+12
SECTION ENDS STA. 10+68

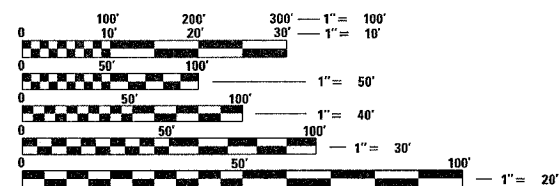

FULL SIZE PLANS HAVE BEEN PREPARED USING STANDARD ENGINEERING SCALES. REDUCED SIZED PLANS WILL NOT CONFORM TO STANDARD SCALES. IN MAKING MEASUREMENTS ON REDUCED PLANS, THE ABOVE SCALES MAY BE USED.

J.U.L.I.E.
JOINT UTILITY LOCATION INFORMATION FOR EXCAVATION
1-800-892-0123

KENT TOWNSHIP,
SECTION 6,7

NET LENGTH OF PROJECT = 32 FEET = 0.006 MILES
GROSS LENGTH OF PROJECT = 32 FEET = 0.006 MILES

STATE OF ILLINOIS
DEPARTMENT OF TRANSPORTATION
DIVISION OF HIGHWAYS

SUBMITTED: June 23, 2005
 Gregory R. Mountain
DEPUTY DIRECTOR OF HIGHWAYS, REGION ENGINEER
 July 1, 2005
 Mike Hine
ENGINEER OF DESIGN AND ENVIRONMENT
 July 1, 2005
 Victor Maden
DIRECTOR OF HIGHWAYS, CHIEF ENGINEER

PRINTED BY THE AUTHORITY
OF THE STATE OF ILLINOIS

CONTRACT NO. 64B04

FAP ROUTE 301 (US 20) SECTION 22BR-1 STEPHENSON COUNTY