

ROUTE	SECTION	COUNTY	TOTAL SHEETS	SHEET NUMBER
FAP 343	531-4HBK-I-2	COOK	10	1

FOR INDEX OF SHEETS SEE SHEET 2

**STATE OF ILLINOIS
DEPARTMENT OF TRANSPORTATION
DIVISION OF HIGHWAYS
DISTRICT ONE
PROPOSED HIGHWAY PLANS**

CONTRACT NO. 62865

D-91-042-05

**IMPROVEMENT IS
LOCATED IN THE VILLAGE
OF PALATINE**

FAP 343: ILLINOIS ROUTE 68
OVER ILLINOIS ROUTE 53
SECTION: 531-4HBK-I-2
BEAM REPLACEMENT
COOK COUNTY
C-91-042-05

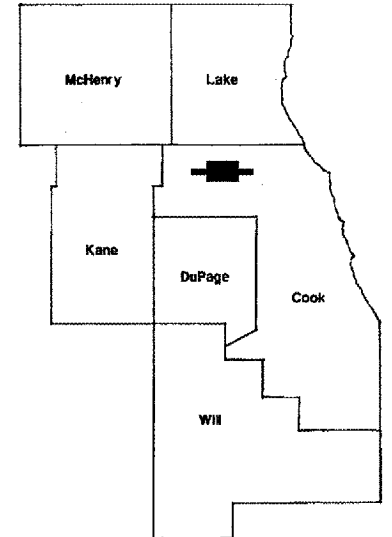

LOCATION OF IMPROVEMENT INDICATED THUS:

**LOCATION OF
IMPROVEMENT AT
S.N.: 016-0961**

TRAFFIC DATA:

IL RTE. 53:
SPEED LIMIT = 55 MPH
2003 ADT = 93,400

IL RTE. 68:
SPEED LIMIT = 45 MPH
2003 ADT = 38,800

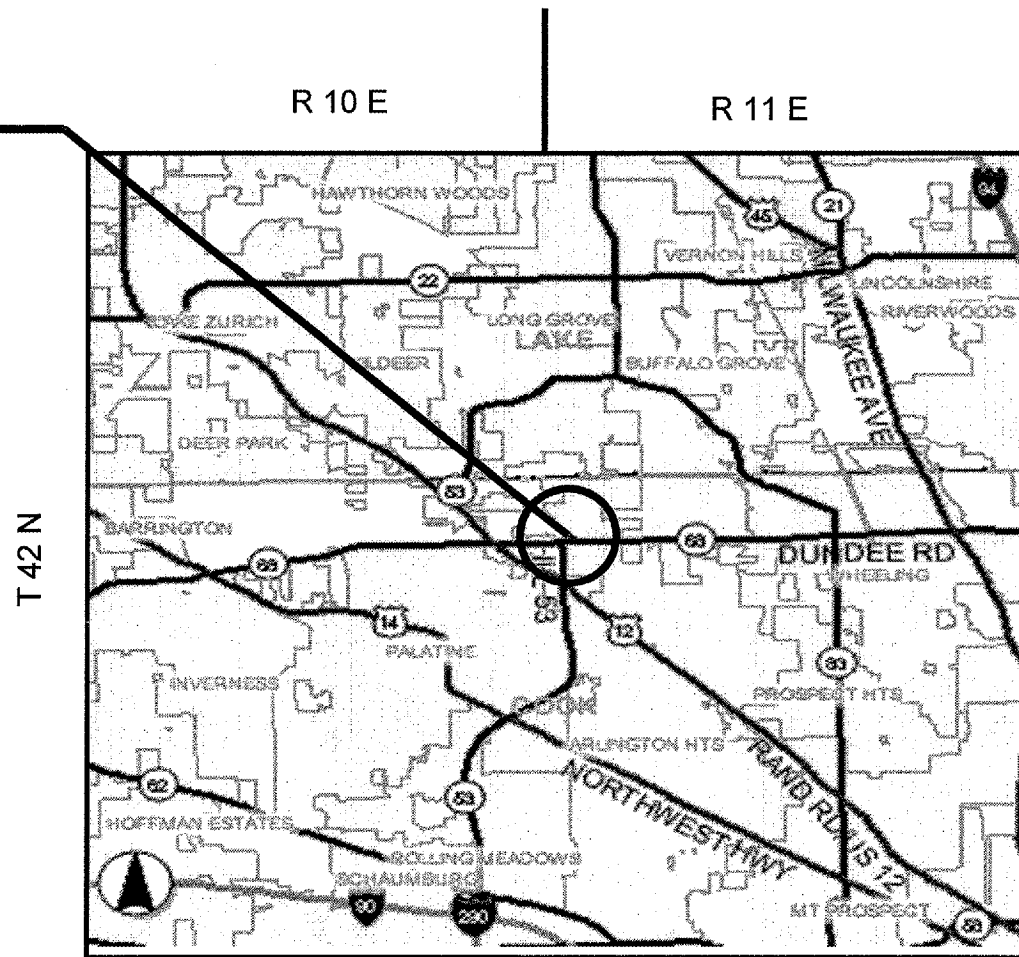

**STATE OF ILLINOIS
DEPARTMENT OF TRANSPORTATION
DIVISION OF HIGHWAYS**

SUBMITTED: March 23, 20 05
Dina O'Keefe
DEPUTY DIRECTOR OF HIGHWAYS, REGION ENGINEER

May 13, 2005
Mike Hine
ENGINEER OF DESIGN AND ENVIRONMENT

May 13, 2005
Victor Moders
DIRECTOR, DIVISION OF HIGHWAYS

**PRINTED BY THE AUTHORITY
OF THE STATE OF ILLINOIS**

**J.U.L.I.E.: JOINT UTILITY LOCATION
INFORMATION FOR EXCAVATION
(312) 744-7000**

CONTRACT NO. 62865

DISTRICT ONE - DESIGN - PLAN PREPARATION ENGINEER:
KEN ENG / ROBERT BORO (847) 705-4178