

NOTES:  
1. FOR CURVE DATA AND BENCHMARKS  
SEE ALIGNMENT, TIES & BENCHMARKS SHEETS.

MUNICIPALITY: JOLIET

F.A. RTE.	SECTION	COUNTY	TOTAL SHEETS	SHEET NO.
575	(B&I4) R-3	WILL	390	385
STA.	834+00	TO STA.	840+00	
FED. ROAD DIST. NO.	ILLINOIS	FED. AID PROJECT		
CONTRACT NO. 60961				

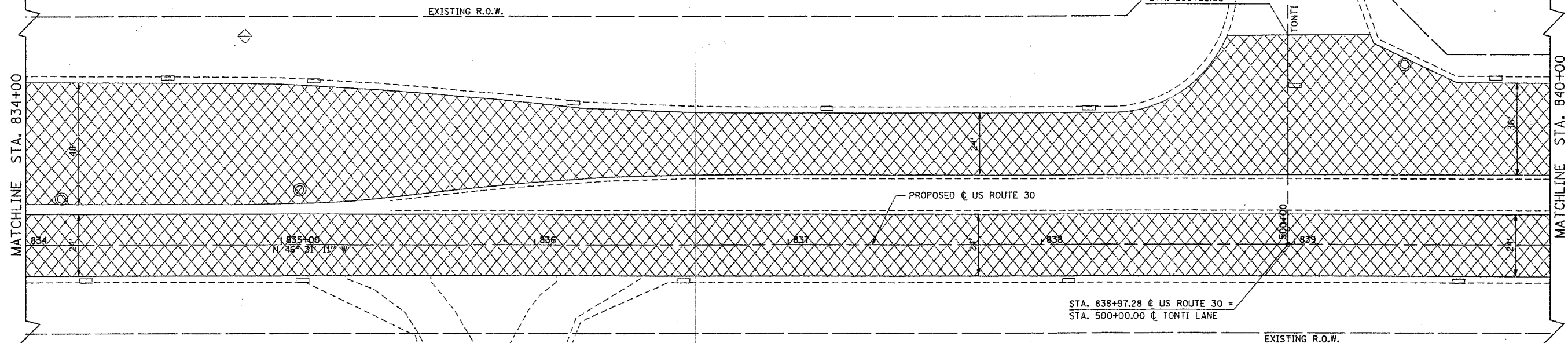

LEGEND  
 3/4" LEVELING BINDER (MACHINE METHOD), SUPERPAVE, N70  
 1 1/2" BITUMINOUS CONCRETE SURFACE COURSE, SUPERPAVE, MIX "D", N70

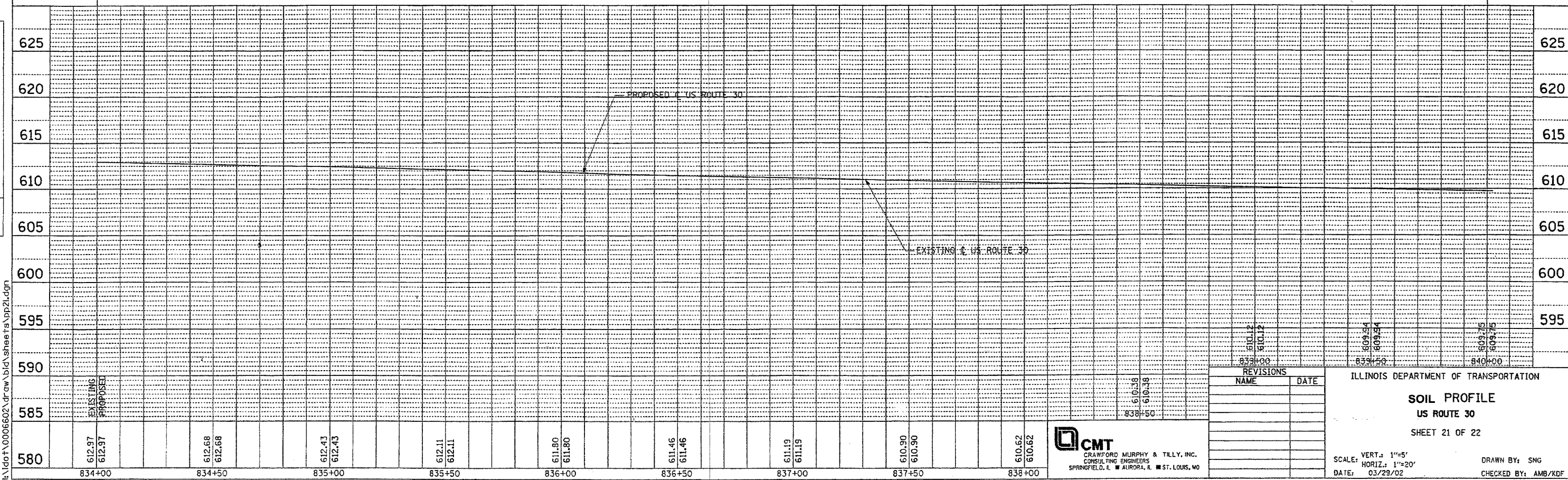

REVISIONS	
NAME	DATE

ILLINOIS DEPARTMENT OF TRANSPORTATION  
**SOIL PROFILE**  
**US ROUTE 30**  
 SHEET 21 OF 22  
 SCALE: VERT.: 1"=5'  
 HORIZ.: 1"=20'  
 DATE: 03/23/02  
 DRAWN BY: SNG  
 CHECKED BY: AMB/KDF

**CMT**  
 CRAWFORD MURPHY & TILLY, INC.  
 CONSULTING ENGINEERS  
 SPRINGFIELD, IL ■ AURORA, IL ■ ST. LOUIS, MO

PLOTTED AT: 11:00 AM  
 FILE NAME: C:\PROJECTS\60961\DRAWING\SOIL\SOIL21.DWG  
 DATE: 03/23/02  
 TIME: 11:00 AM  
 USER: SNG

PLOTTED AT: 11:00 AM  
 FILE NAME: C:\PROJECTS\60961\DRAWING\SOIL\SOIL21.DWG  
 DATE: 03/23/02  
 TIME: 11:00 AM  
 USER: SNG

I:\dot\0006602\draw\bid\sheet's\pp21.dgn