

| F.A.P. RTE. | SECTION | COUNTY | TOTAL SHEETS | SHEET NO. |
|---|------------|--------|--------------|-----------|
| 575 | (B&I4) R-3 | WILL | 390 | 40 |
| STA. TO STA. | | | | |
| FED. ROAD DIST. NO. ILLINOIS FED. AID PROJECT | | | | |
| CONTRACT NO. 60961 | | | | |

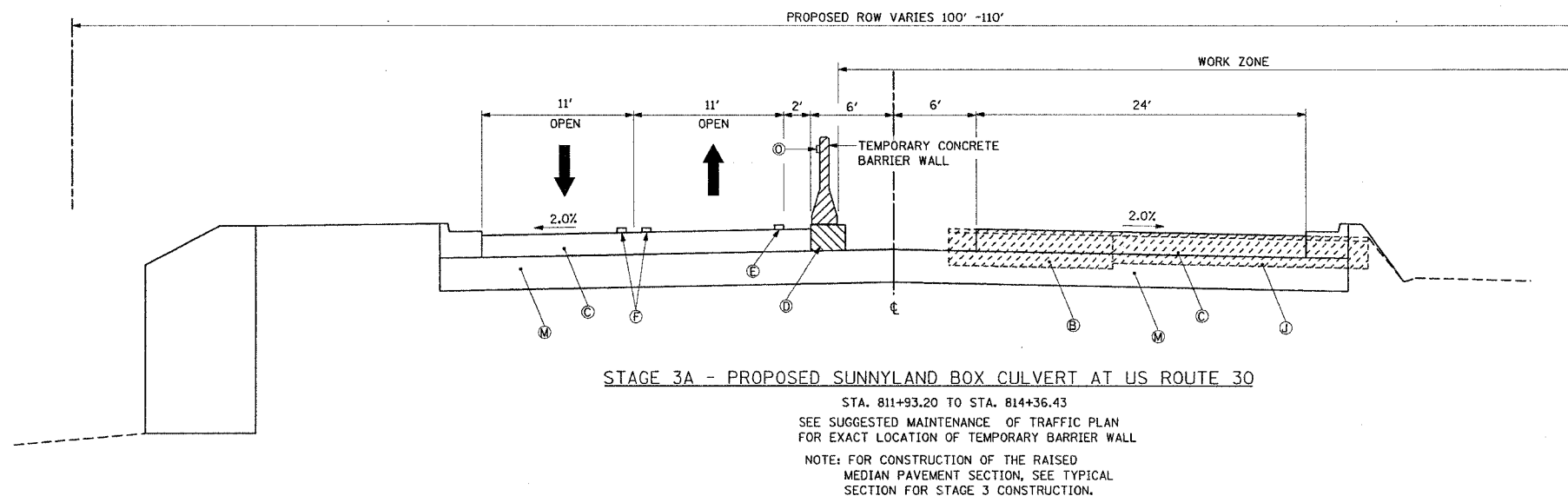
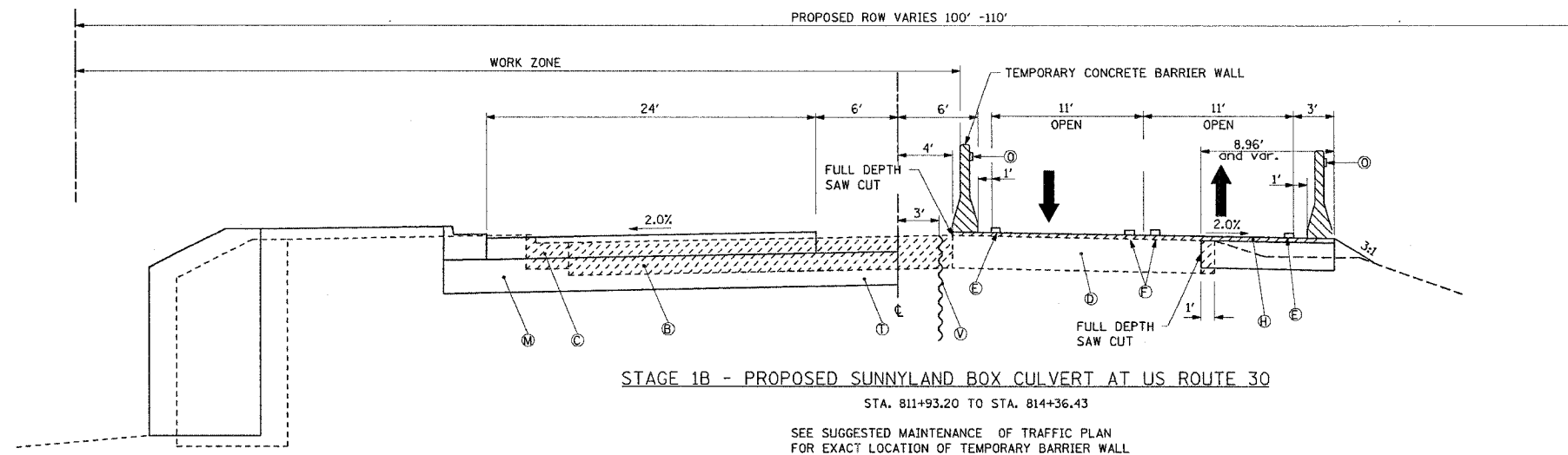

LEGEND:

- (A) EXISTING BITUMINOUS CONCRETE PAVEMENT
- (B) PAVEMENT, MEDIAN AND/OR CURB REMOVAL
- (C) PROPOSED BITUMINOUS CONCRETE BINDER COURSE, SUPERPAVE, IL 19.0 N90 - 11"
- (D) PROPOSED TEMPORARY PAVEMENT
- (E) TEMPORARY EDGE LINE - 4" WHITE SOLID LINE
- (F) TEMPORARY CENTERLINE - 2-4" YELLOW SOLID LINE ON 11" CENTERS
- (G) TEMPORARY SHORT TERM PAVEMENT MARKINGS - 4" WHITE
- (H) POLYMERIZED LEVELING BINDER (MACHINE METHOD), SUPERPAVE IL 4.75, NS0 - 1"
- (I) PROPOSED TEMPORARY EMBANKMENT
- (J) TEMPORARY PAVEMENT AND/OR CURB REMOVAL
- (K) PROPOSED 2 1/2" PAVEMENT MILLING W/ PROPOSED 2 1/2" BITUMINOUS OVERLAY
- (L) PROPOSED TEMPORARY PAVEMENT CROSS-OVER (TO BE PAID AS TEMPORARY PAVEMENT)
- (M) PROPOSED AGGREGATE SUBGRADE, 12" (CONSTRUCT PERMANENT SUBGRADE TO CENTERLINE)
- (N) REMOVE TEMPORARY EMBANKMENT (EARTH EXCAVATION)
- (O) PROPOSED BARRIER WALL REFLECTORS
- (P) PROPOSED TEMPORARY AGGREGATE SHOULDER (TO BE PAID AS AGGREGATE SHOULDER, SPECIAL)
- (Q) TEMPORARY AGGREGATE SHOULDER REMOVAL (INCIDENTAL TO AGGREGATE SHOULDER, SPECIAL)
- (R) DRUMS WITH MONODIRECTIONAL STEADY BURN LIGHTS
- (S) PROPOSED TEMPORARY CONCRETE CURB AND GUTTER, B-6.18
- (T) TEMPORARY SOIL RETENTION SYSTEM (SEE SHEET 226-229)
- (U) TEMPORARY EDGE LINE - 4" YELLOW SOLID LINE
- (V) TEMPORARY SHEET PILING
- (W) PROPOSED RETAINING WALL

| REVISIONS | |
|-----------|------|
| NAME | DATE |
| | |
| | |
| | |
| | |
| | |
| | |
| | |
| | |
| | |

ILLINOIS DEPARTMENT OF TRANSPORTATION
SUGGESTED MAINTENANCE
OF TRAFFIC PLAN
STAGE 1B & STAGE 3A
AT SUNNYLAND BOX CULVERT
US ROUTE 30
SHEET 6 OF 26

SCALE: VERT. NONE HORIZ. NONE
DATE: 3/1/05
DRAWN BY: SNH
CHECKED BY: SBP

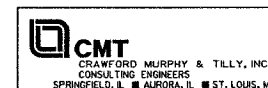

Rev. 7-26-05