

F.A.U. RTE.	SECTION	COUNTY	TOTAL SHEETS	SHEET NO.
8009	05-00445-00-BR	SANGAMON	17	9
STA.		TO STA.		
FED. ROAD DIST. NO.		ILLINOIS	FED. AID PROJECT	
SHEET 3 OF 9 SHEETS				

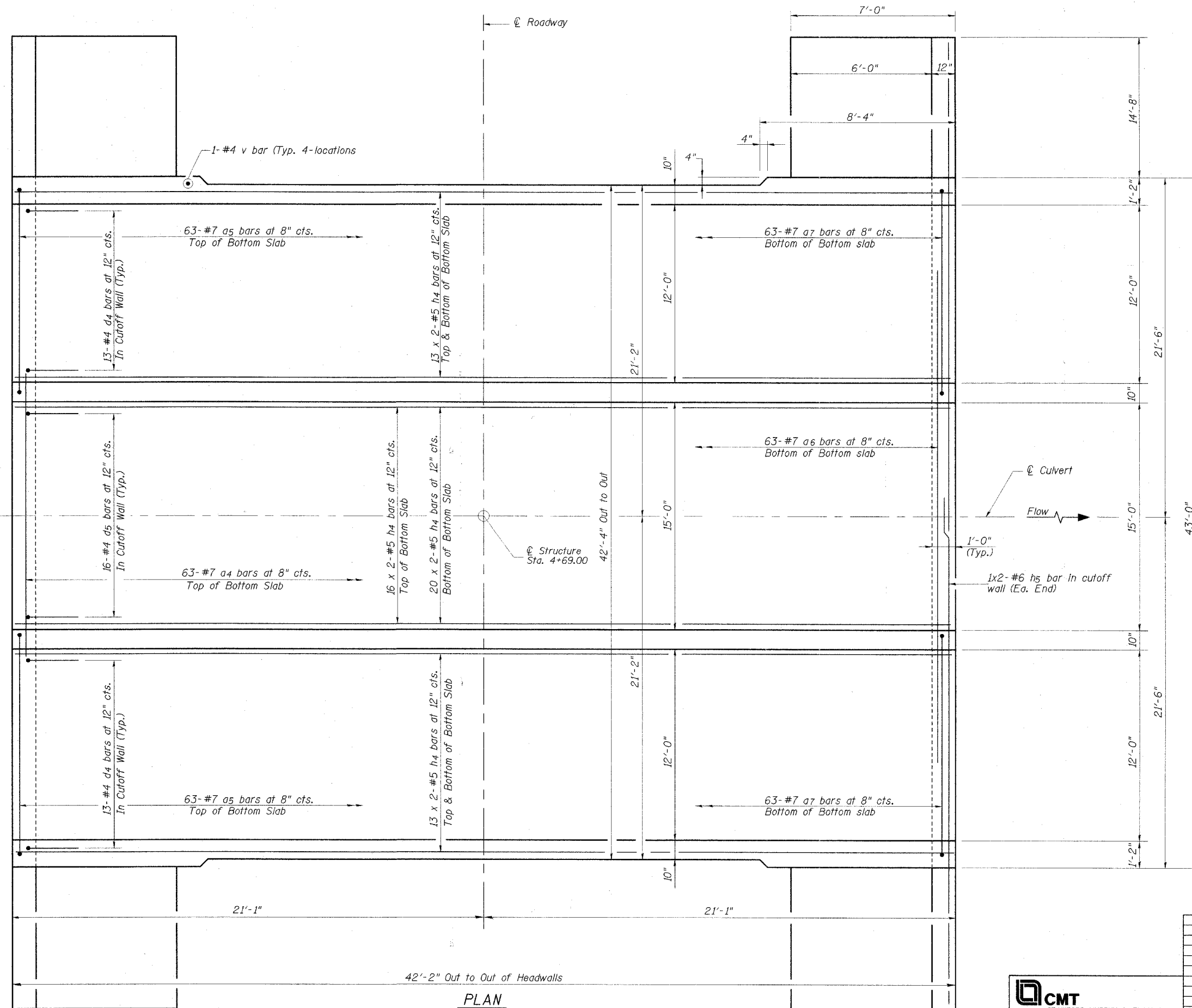

**MIN. BAR LAP**  
 #5 = 1'-8"  
 #6 = 2'-0"

**NOTES:**

- See Sheet 6 of 9 for wingwall details.
- Bars indicated 13x2-#5 etc. indicates 13 lines of bars with 2 lengths per line.

REVISIONS	
NAME	DATE

CITY OF SPRINGFIELD, ILLINOIS  
**BOTTOM SLAB REINFORCEMENT PLAN**  
 FAU 8009-AMOS AVE. OVER DRAINAGE DITCH  
 SECTION 05-00445-00-BR  
 SANGAMON COUNTY  
 STATION 4+69.00 S.N. 084-8009  
 SCALE: NONE DRAWN BY: GLD  
 DATE: 5/26/06 CHECKED BY: GBR

**CMT**  
 CRAWFORD MURPHY & TILLY, INC.  
 CONSULTING ENGINEERS  
 SPRINGFIELD, IL ■ AURORA, IL ■ ST. LOUIS, MO  
 ROCKFORD, IL ■ PEORIA, IL ■ CHICAGO, IL

**PLAN**  
**BOTTOM SLAB**

I:\Springfield\050250\Draw\Sheets\CULV DE TLS BOTT SLAB.dgn  
 5/24/2006