

F.A. RTE.	SECTION	COUNTY	TOTAL SHEETS	SHEET NO.
	05-00194-00-RP	COOK	58	19
STA.		TO STA.		
FED. ROAD DIST. NO.		ILLINOIS FED. AID PROJECT		

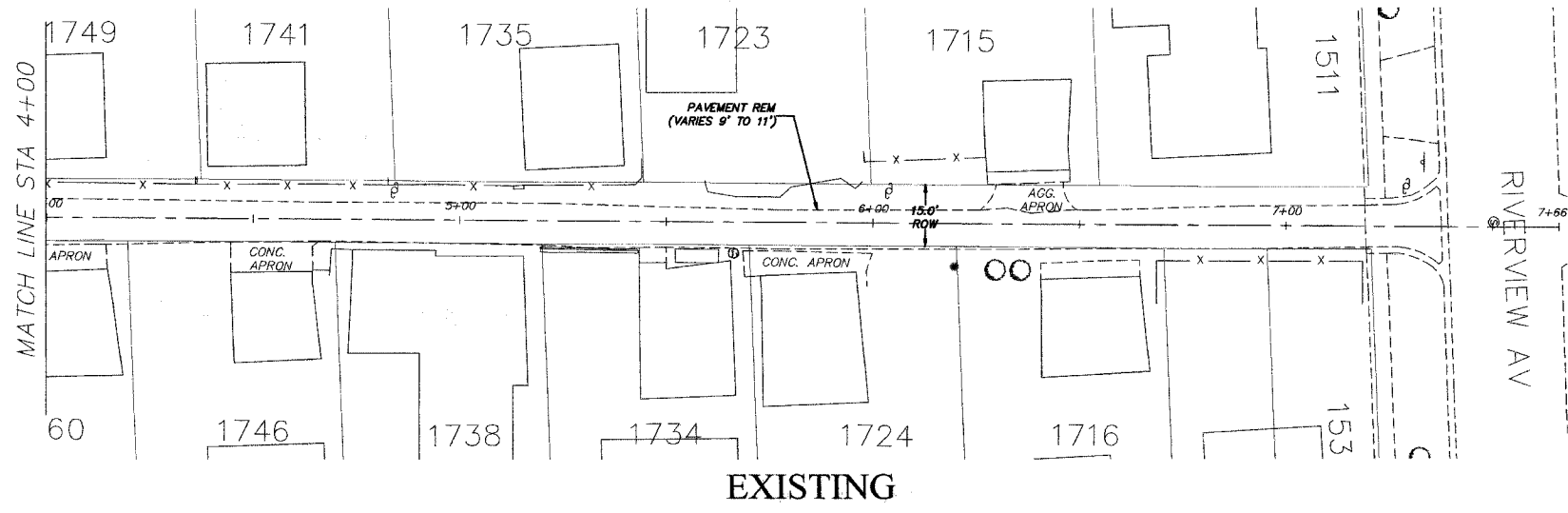

EXISTING

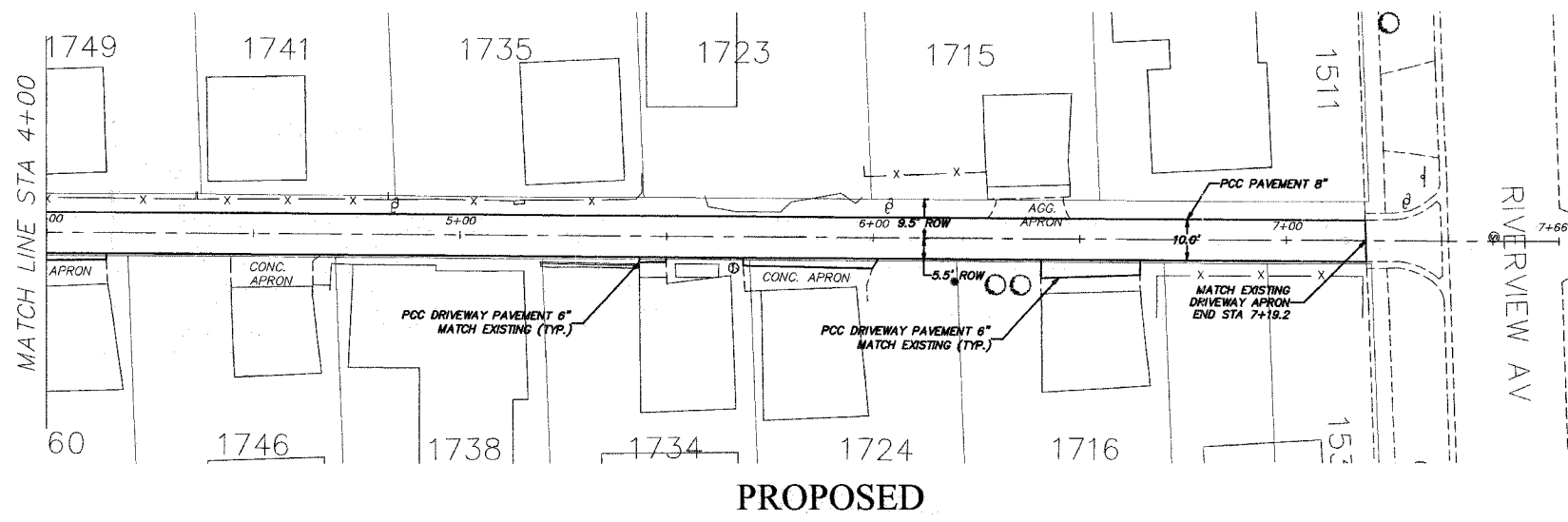

PROPOSED

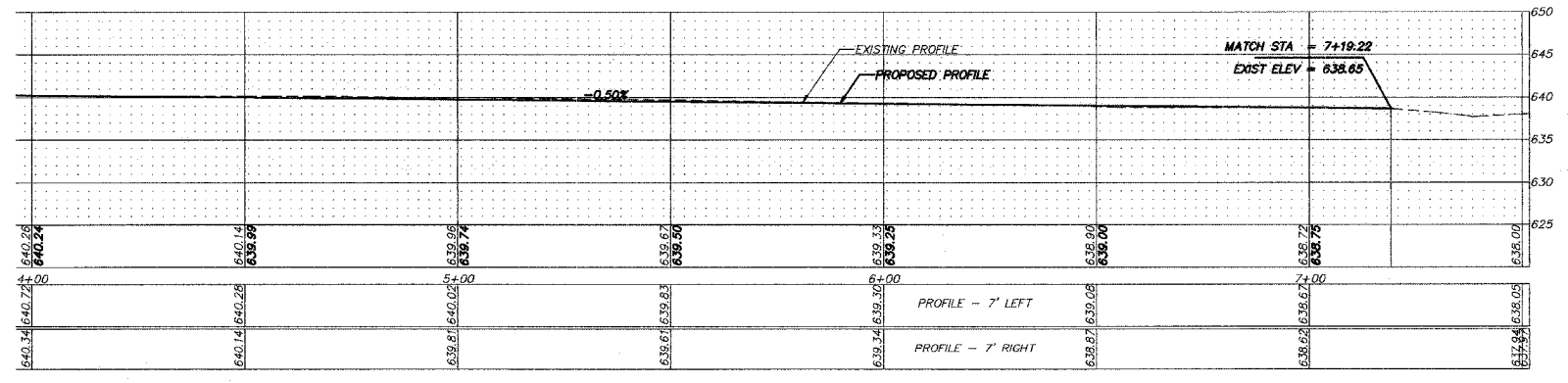

REVISIONS		ILLINOIS DEPARTMENT OF TRANSPORTATION CITY OF DES PLAINES - ALLEY IMPROVEMENTS ILLINOIS - CORA ALLEY EVERETT TO RIVERVIEW PLAN AND PROFILE STA 4+00 TO 7+19.2 SCALE: VERT. 1" = 5' HORIZ. 1" = 20' DATE: 2-17-06	DRAWN BY BLS	CHECKED BY AJD
NAME	DATE			

PLOT DATE = 2/13/2006 3:18:57 PM
 PLOT SCALE = 1" = 20'
 USER NAME = JUDILES