

CONTRACT NO. 60B32

F.A.U. RTE.	SECTION	COUNTY	TOTAL SHEETS	SHEET NO.
2710	(1213&3219)RS-7	COOK	22	7
STA.		TO STA.		
FED. ROAD DIST. NO.		ILLINOIS FED. AID PROJECT		

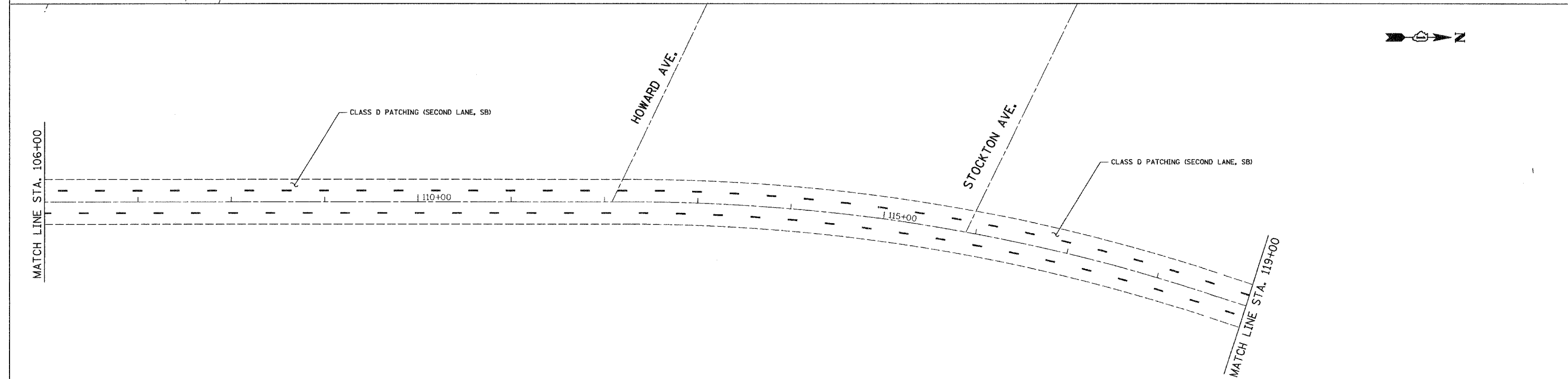
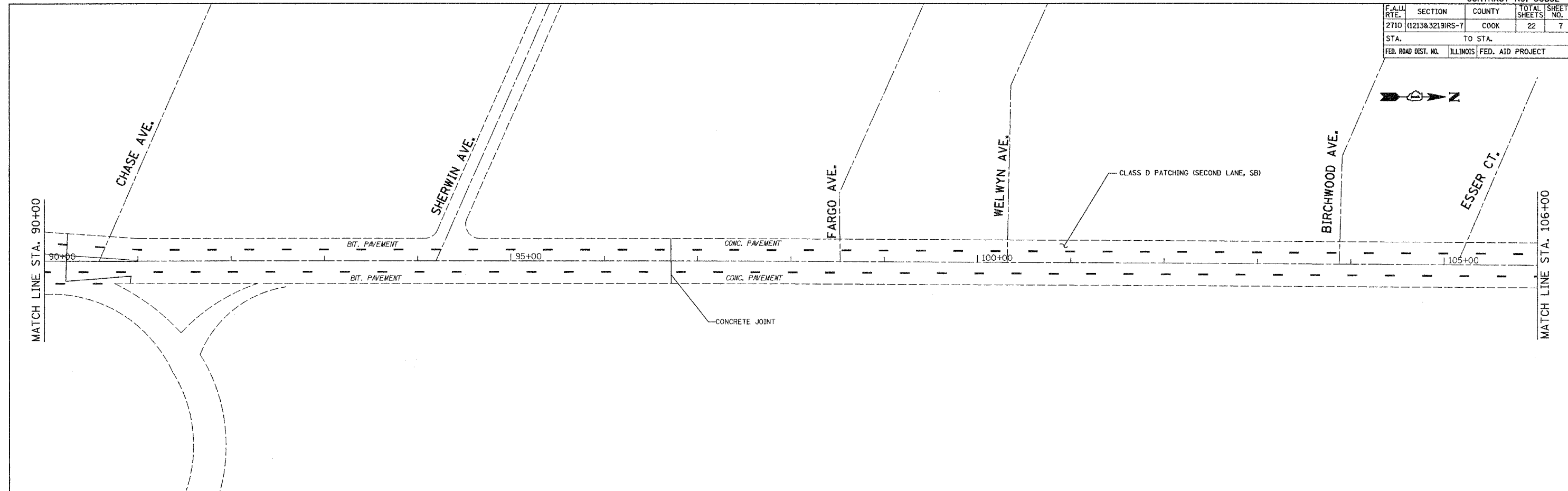
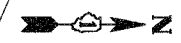

REVISIONS	
NAME	DATE

ILLINOIS DEPARTMENT OF TRANSPORTATION

DES PLAINES RIVER ROAD  
FROM US 12 ( RAND ROAD) TO DEVON AVE.

ROADWAY AND PAVEMENT MARKING PLAN

SCALE: VERT. \_\_\_\_\_  
HORIZ. \_\_\_\_\_

DATE \_\_\_\_\_

DRAWN BY \_\_\_\_\_  
CHECKED BY \_\_\_\_\_

PLOT DATE = 6/23/2006  
FILE NAME = c:\projects\1132286\design\adgn  
PLOT SCALE = 5/8"=1' IN.  
USER NAME = handanah