

- NOTES:
1. TREE SHALL BE SET 2" HIGHER THAN DEPTH GROWN AT NURSERY.
 2. STAKE TREES UNDER 8' TALL. GUY TREES 8' TALL AND OVER.

MULTISTEM TREE PLANTING DETAIL

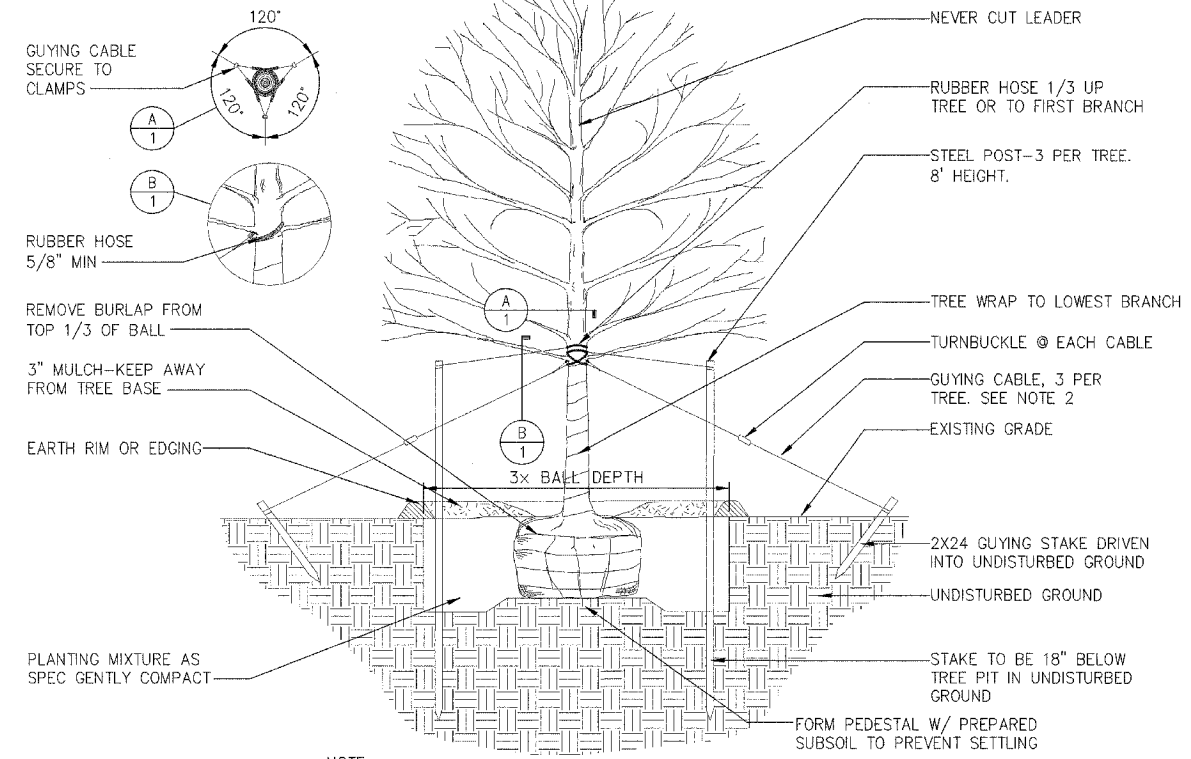

- NOTE:
1. TREE SHALL BE SET 2" HIGHER THAN DEPTH GROWN AT NURSERY.
 2. STAKE TREES UNDER 2" CALIPER OR LESS. GUY TREES OVER 2" CALIPER.

TREE PLANTING DETAIL

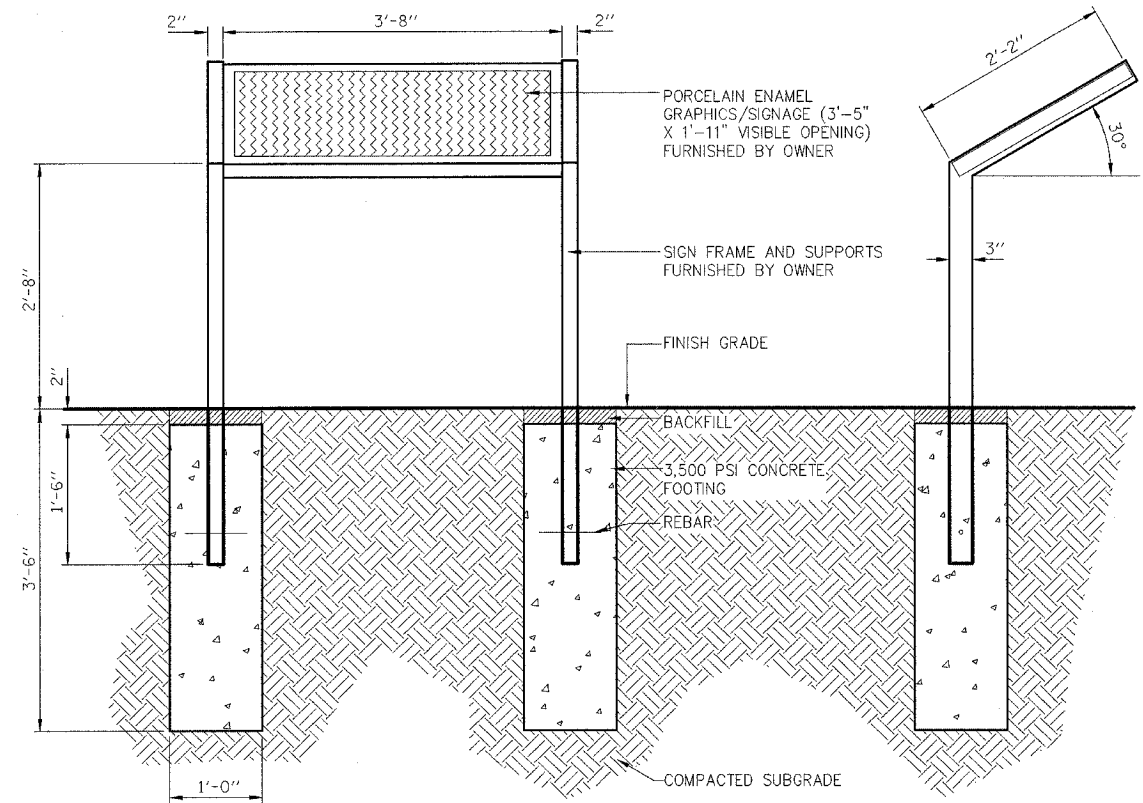

- NOTES:
1. SIGN FRAME AND SUPPORT MATERIAL IS TO BE ALUMINUM WITH MANUFACTURER'S STANDARD POWDER COAT FINISH.
 2. SIGN GRAPHICS AND FINISH COLOR ARE TO BE COORDINATED WITH THE OWNER.

INTERPRETIVE SIGN INSTALLATION DETAIL

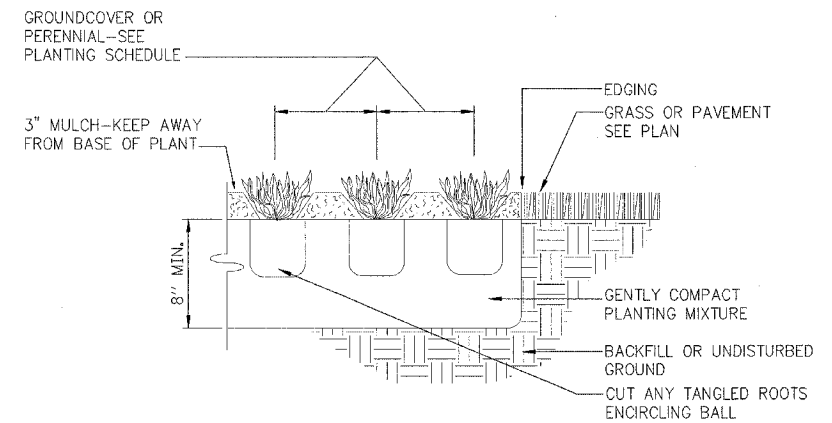

PERENNIAL PLANTING DETAIL

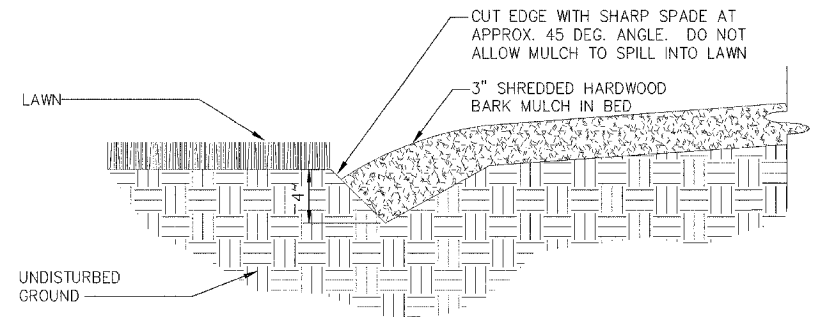

SPADE EDGING DETAIL

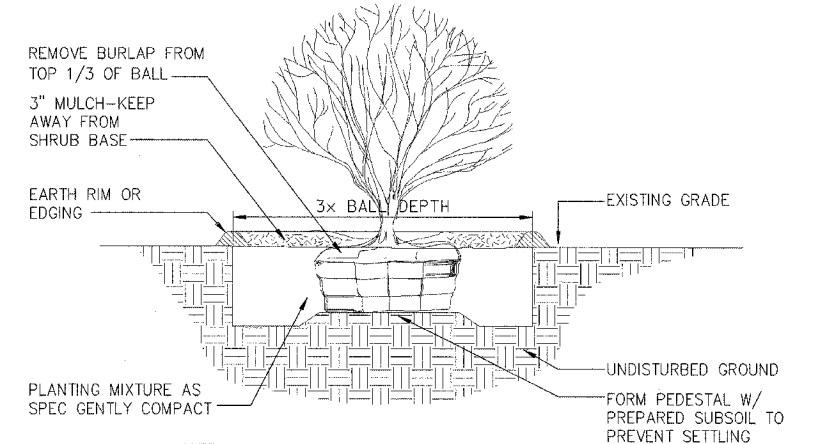

- NOTE:
1. SHRUB SHALL BE SET 2" HIGHER THAN THE DEPTH GROWN AT NURSERY.

SHRUB PLANTING DETAIL

REVISIONS	
NAME	DATE

ILLINOIS DEPARTMENT OF TRANSPORTATION
LANDSCAPING DETAILS
 IDOT / IHPA
 PULLMAN STATE HISTORIC SITE

SCALE: VERT. _____
 HORIZ. _____
 DATE: 11/08/05

DRAWN BY: DJM
 CHECKED BY: PJM