

INDEX OF SHEETS

1. COVER SHEET
2. SUMMARY OF QUANTITIES, GENERAL NOTES, AND TYPICAL SECTIONS
3. PLAN AND PROFILE OF ROADWAY
4. GENERAL PLAN AND ELEVATION
5. SUPERSTRUCTURE DETAILS
6. 21" X 48" PPC DECK BEAM DETAILS
7. 21" X 48" PPC DECK BEAM DETAILS
8. STEEL RAILING, TYPE SM WITH CONCRETE WEARING SURFACE
9. ABUTMENT AND WINGWALL CONCRETE REMOVAL AND CONCRETE REPAIR
10. ABUTMENT CONCRETE REPLACEMENT
11. WINGWALL CONCRETE REPLACEMENT
12. CROSS SECTIONS OF ROADWAY

HIGHWAY STANDARDS

- | | |
|-------------|---|
| 000001-06 | STANDARD SYMBOLS, ABBREVIATIONS AND PATTERNS |
| 515001-03 | NAME PLATE FOR BRIDGES |
| 630001-10 | STEEL PLATE BEAM GUARDRAIL |
| 631032-07 | TRAFFIC BARRIER TERMINAL, TYPE 6A |
| 635006-03 | REFLECTOR AND TERMINAL MARKER PLACEMENT |
| 701901-02 | TRAFFIC CONTROL DEVICES |
| B.L.R. 21-9 | TYPICAL APPLICATION OF TRAFFIC CONTROL DEVICES FOR CONSTRUCTION ON RURAL LOCAL HIGHWAYS |

DESIGN CLASSIFICATION: MAJOR COLLECTOR (NON-URBAN)

ADT₂₀₁₂ : 550
 ADT₂₀₃₂ : 567
 DESIGN SPEED - 50 MPH

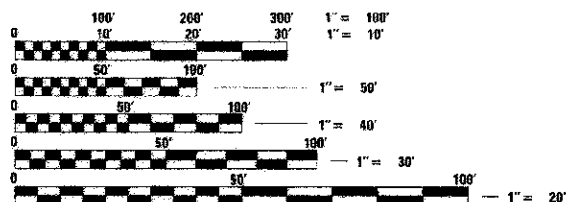

FULL SIZE PLANS HAVE BEEN PREPARED USING STANDARD ENGINEERING SCALES. REDUCED SIZED PLANS WILL NOT CONFORM TO STANDARD SCALES. IN MAKING MEASUREMENTS ON REDUCED PLANS, THE ABOVE SCALES MAY BE USED.

J.U.L.I.E.
 JOINT UTILITY LOCATING INFORMATION FOR EXCAVATORS
 1-800-892-0123 Website: <http://www.illinois1call.com>



Gary L. Hahn 5-29-12
 GARY L. HAHN
 CENTRALIA, ILLINOIS
 ILLINOIS LICENSED PROFESSIONAL
 ENGINEER NO. 62-42606
 EXPIRES NOV. 30, 2013

STATE OF ILLINOIS
 DEPARTMENT OF TRANSPORTATION

**PLANS FOR PROPOSED
 HIGHWAY BRIDGE PROGRAM**

**CH 28 (FAS 711)
 DISMAL CREEK
 SECTION 12-00124-00-BR
 PROJECT NO. BRS-0711(109)
 FAYETTE COUNTY
 JOB NO. C-97-122-12**

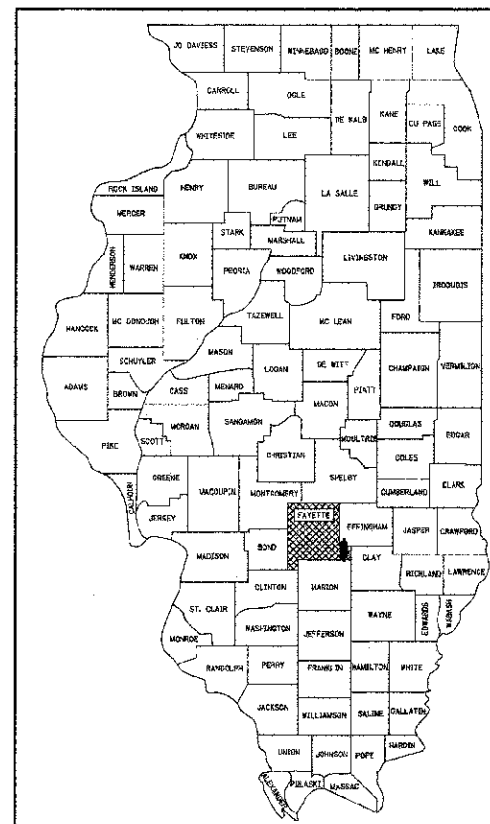

LOCATION OF SECTION INDICATED THUS: [Symbol]

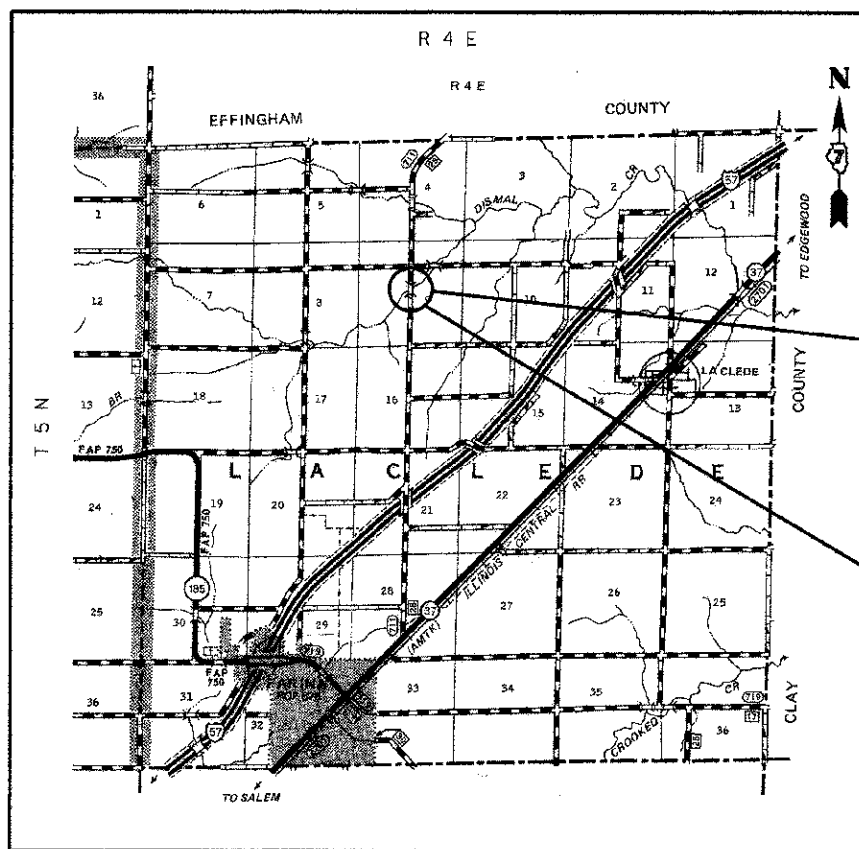

SECTION BEGINS
 STA. 604+02.02

SECTION 12-00124-00-BR INCLUDES THE REMOVAL OF THE EXISTING T-BEAM AND SLAB SUPERSTRUCTURE, RECONSTRUCTION AND REPAIRS TO THE EXISTING ABUTMENTS AND WINGWALLS, AND REPLACEMENT WITH A PROPOSED PRECAST PRESTRESSED CONCRETE DECK BEAM SUPERSTRUCTURE FOR A BRIDGE CARRYING CH 28 (FAS 711) OVER DISMAL CREEK, 37'-3 3/4" BK. TO BK. ABUTMENTS X 28' WIDE, 30° AH. RT. SKEW. EXISTING STRUCTURE NO. 026-3001

SECTION ENDS
 STA. 604+73.98

LOCATION: NEAR THE SW CORNER OF THE NE 1/4, SECTION 9, T 5 N, R 4 E, 3rd P.M.
 NET LENGTH OF PROJECT: 71.96 FT = 0.014 MI

STATE OF ILLINOIS
 DEPARTMENT OF TRANSPORTATION

APPROVED: *Michael A. ...* 5-31, 2012
 FAYETTE COUNTY, COUNTY ENGINEER

PASSED: *6/5, 2012*
Maurice ...
 DISTRICT SEVEN ENGINEER OF LOCAL ROADS & STREETS

RELEASING FOR BID
 BASED ON LIMITED
 REVIEW: *6/5, 2012*
Roger ...
 DEPUTY DIRECTOR OF HIGHWAYS, REGION FOUR ENGINEER

**PRINTED BY THE AUTHORITY
 OF THE STATE OF ILLINOIS**

CONTRACT NO. 95691

ROUTE	SECTION	COUNTY	TOTAL SHEETS	SHEET NO.
CH 28	12-00124-00-BR	FAYETTE	12	1
			CONTRACT NO. 95691	

05/29/2012 RAAI #51312