

STATE OF ILLINOIS
DEPARTMENT OF TRANSPORTATION

**PLANS FOR PROPOSED
BRIDGE REPLACEMENT**

**CHAMPAIGN COUNTY
SECTION 07-00944-00-BR
PROJECT NO. BRS-0527(103)
JOB NO. C-95-301-12
COUNTY HIGHWAY 16
BRIDGE REPLACEMENT PROGRAM**

INDEX OF SHEETS

SHEET NO.	DESCRIPTION
1	TITLE SHEET
2	GENERAL NOTES
3	SUMMARY OF QUANTITIES
4	SCHEDULE OF QUANTITIES
5	TYPICAL SECTIONS
6	TIE POINTS
7	PLAN & PROFILE
8	EROSION CONTROL PLAN
9	GUARDRAIL DETAILS
10-29	STRUCTURAL DETAILS
30	BORING LOGS
31-45	CROSS SECTIONS

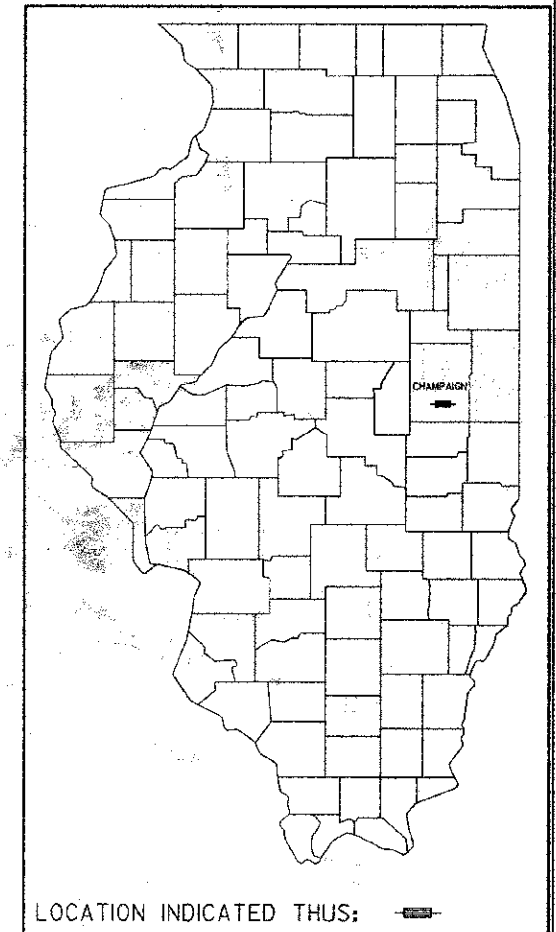
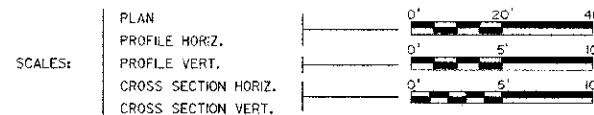

ILLINOIS DEPT. OF TRANSPORTATION STANDARD DRAWINGS

STANDARD NO.	DESCRIPTION
000001-06	STANDARD SYMBOLS, ABBREVIATIONS, AND PATTERNS
001001-02	AREAS OF REINFORCEMENT BARS
001006	DECIMAL OF AN INCH AND A FOOT
280001-06	TEMPORARY EROSION CONTROL SYSTEMS
515001-03	NAME PLATE FOR BRIDGES
542401-C1	METAL END SECTIONS FOR PIPE CULVERTS
609006-05	BRIDGE APPROACH PAVEMENT (DRAIN DETAIL)
630001-10	STEEL PLATE BEAM GUARDRAIL
631011-08	TRAFFIC BARRIER TERMINAL, TYPE 2
631026-05	TRAFFIC BARRIER TERMINAL, TYPE 5
631031-10	TRAFFIC BARRIER TERMINAL, TYPE 6
635006-03	REFLECTOR AND TERMINAL MARKER PLACEMENT
635011-02	REFLECTOR MARKER AND MOUNTING DETAILS
701001-02	OFF-ROAD OPERATIONS, 2L, 2W, MORE THAN 15' AWAY
701006-03	OFF-ROAD OPERATIONS, 2L, 2W, 15' TO 24' FROM PAVEMENT EDGE
701201-04	LANE CLOSURE, 2L, 2W, DAY ONLY FOR SPEED > 45 MPH
701301-04	LANE CLOSURE, 2L, 2W, SHORT TIME OPERATIONS
701311-03	LANE CLOSURE, 2L, 2W, MOVING OPERATIONS, DAY ONLY
701901-02	TRAFFIC CONTROL DEVICES
780001-03	TYPICAL PAVEMENT MARKINGS
BLR 21-9	TYPICAL APPLICATION OF TRAFFIC CONTROL DEVICES FOR CONSTRUCTION ON RURAL LOCAL HIGHWAYS

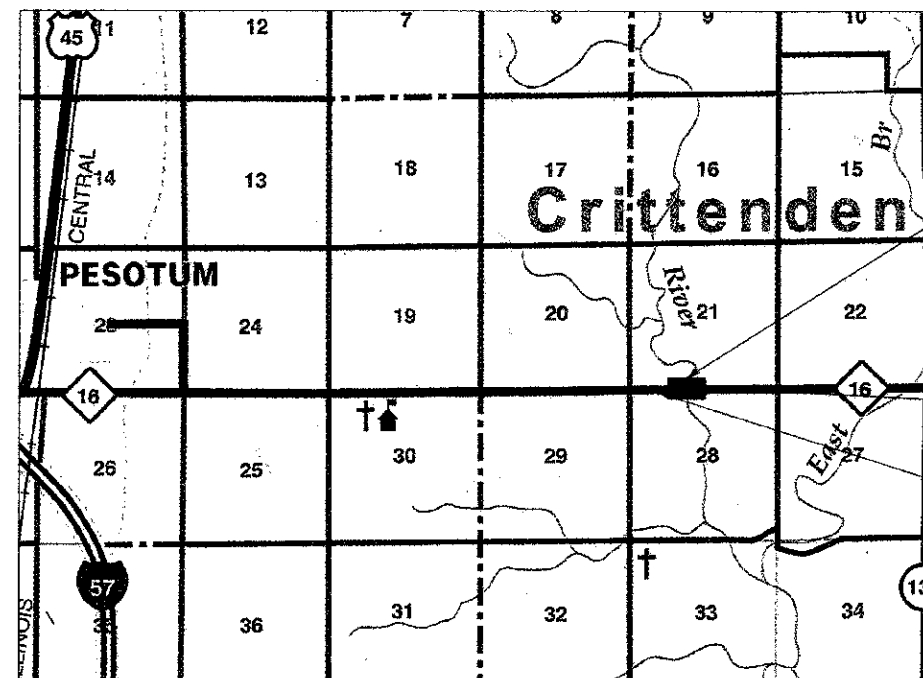

LOCATION MAP
NOT TO SCALE

NET LENGTH OF SECTION = 475 FEET = 0.09 MILES
FUNCTIONAL CLASSIFICATION - RURAL TWO-WAY COLLECTOR
CURRENT ADT = 1000
FUTURE ADT = 1200

EXISTING STRUCTURE *010-017
PROPOSED STRUCTURE *010-4548

END PROJECT
STATION 12+50

BEGIN PROJECT
STATION 7+75

APPROVED 4/11/12 J. J. Baker CHAMPAIGN COUNTY ENGINEER

PASSED 4/24/12 D. M. S. DISTRICT FIVE ENGINEER OF LOCAL ROADS & STREETS

Released For Bid Based on Limited Review April 25, 2012 [Signature] DEPUTY DIRECTOR OF HIGHWAYS, REGION THREE ENGINEER

STATE OF ILLINOIS
DEPARTMENT OF TRANSPORTATION



Ryan T. Mumm 4/11/2012
RYAN T. MUMM
ILLINOIS REGISTERED PROFESSIONAL ENGINEER NO. 062-059507
LICENSE EXPIRES 11-30-13

Sodemann and Associates, Inc.
340 NORTH NEIL STREET
POST OFFICE BOX 557
CHAMPAIGN, ILLINOIS 61824-0557
TEL 217 352-7688 FAX 217 352-7922
ENGINEERING / ANALYSIS / MANAGEMENT

