

LEGEND

- SAN SANITARY MANHOLE TO BE ADJUSTED
- ADJ INLET TO BE ADJUSTED
- SP FRAME AND LID TO BE ADJUSTED (SPECIAL)

STORM STRUCTURES

- EX MH-1
STA 89+45, 33' RT
INV 590.02 NE (PROPOSED)
- EX IN-1
STA 8+45, 34' LT
INV 592.85 NE (PROPOSED)
- ST MH-1
STA 90+00, 31' RT
MANHOLE, TY A, TY 1 FR, CL 4' DIA
RIM = 596.00
INV 590.16 SW 18"
INV 591.34 NE 15"
INV 593.68 SE 12"
- ST MH-2
STA 92+00, 29' RT
MANHOLE, TY A, TY 1 FR, CL 4' DIA
RIM = 597.60
INV 593.00 SW & NE 15"
- CB-1
STA 90+00, 38' RT
CATCH BASIN, TY C, TY 1 FR, OL
RIM = 596.00
INV 593.75 NW 12"
- CB-3
STA 90+00, 32' LT
CATCH BASIN, TY C, TY 1 FR, OL
RIM = 598.19
INV 594.11 SW & NE 12"
- CB-4
STA 91+50, 27' LT
CATCH BASIN, TY C, TY 1 FR, OL
RIM = 598.11
INV 595.61 SW 12"

STORM SEWER PIPES

- P-1
200 LF OF 15" STRG, TY 1 @ 1.33%
TBF = 145.6 CY
- P-2
7 LF OF 12" STRG, TY 1 @ 1.00%
TBF = 1.1 CY
- P-3
65 LF OF 15" STRG, TY 1 @ 0.97%
TBF = 24.4 CY
- P-7
55 LF OF 18" STRG, TY 1 @ 0.25%
TBF = 45.6 CY
- P-8
55 LF OF 12" STRG, TY 1 @ 2.29%
TBF = 18.8 CY
- P-9
150 LF OF 12" STRG, TY 1 @ 1.00%
TBF = 38.6 CY

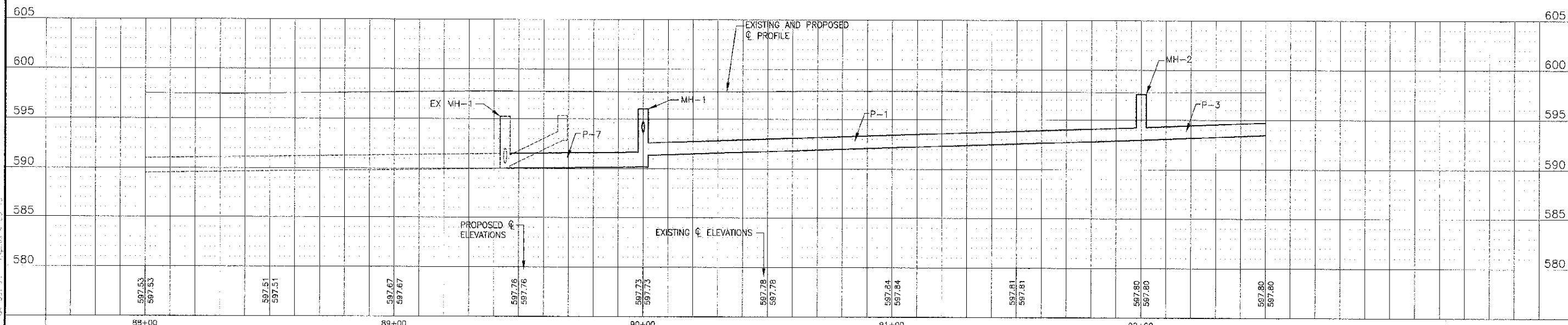

DESIGNED - REW	REVISED -
DRAWN - LUKE	REVISED -
CHECKED - LDH	REVISED -
DATE - 04-20-12	REVISED -

STATE OF ILLINOIS
DEPARTMENT OF TRANSPORTATION

PLAN AND PROFILE
CLAIRE BOULEVARD

F.A.U. RITE	SECTION	COUNTY	TOTAL SHEETS	SHEET NO.
1:500	10-0026-00-RS	COOK	21	9
CONTRACT NO.: 63692				

SCALE: HORIZ. 1"=20' / VERT. 1"=5'
PROJECT NO: 100493 STA. 88+00 TO STA. 92+50
FED. ROAD DIST. NO. 1 ILLINOIS

R:\CVS\741 - ANGLEBORNS\100493-CLAU...
 04/20/12 2:32 PM B. Woodman, Inc.
 Copyright © 2012, by Woodman, Inc.
 State of Illinois - Professional Design Firm
 License No. 04-031791 - Expires 4-30-13