

STORM STRUCTURES

IN-5
 STA 83+36, 56' LT
 INLET, TY A, TYPE 24 F&G
 RIM = 596.37
 INV 593.22 SW 12"

STORM SEWER PIPES

P-10
 10 LF OF 12" STRG @ 1.00%
 TBF = 2.6 CY

LEGEND

- SAN SANITARY MANHOLE TO BE ADJUSTED
- ADJ INLET TO BE ADJUSTED
- SP FRAME AND LID TO BE ADJUSTED (SPECIAL)

SIDEWALK SCHEDULE				
Station	O/S	Sidewalk Removal (SQ FT)	PCC Sidewalk 5" (SQ FT)	Detectable Warnings (SQ FT)
83+32	LT	204.0	204.0	10.0
84+15	RT	244.0	244.0	20.0
84+50	LT	393.0	393.0	10.0
85+35	RT	47.0	47.0	10.0
83+65	LT			20.0
84+92	RT			30.0
TOTALS:		888.0	888.0	100.0

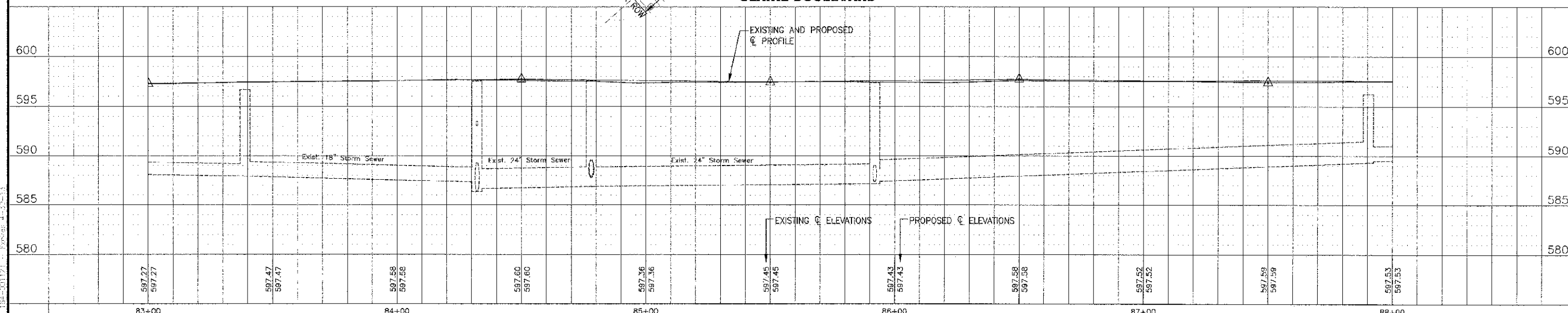
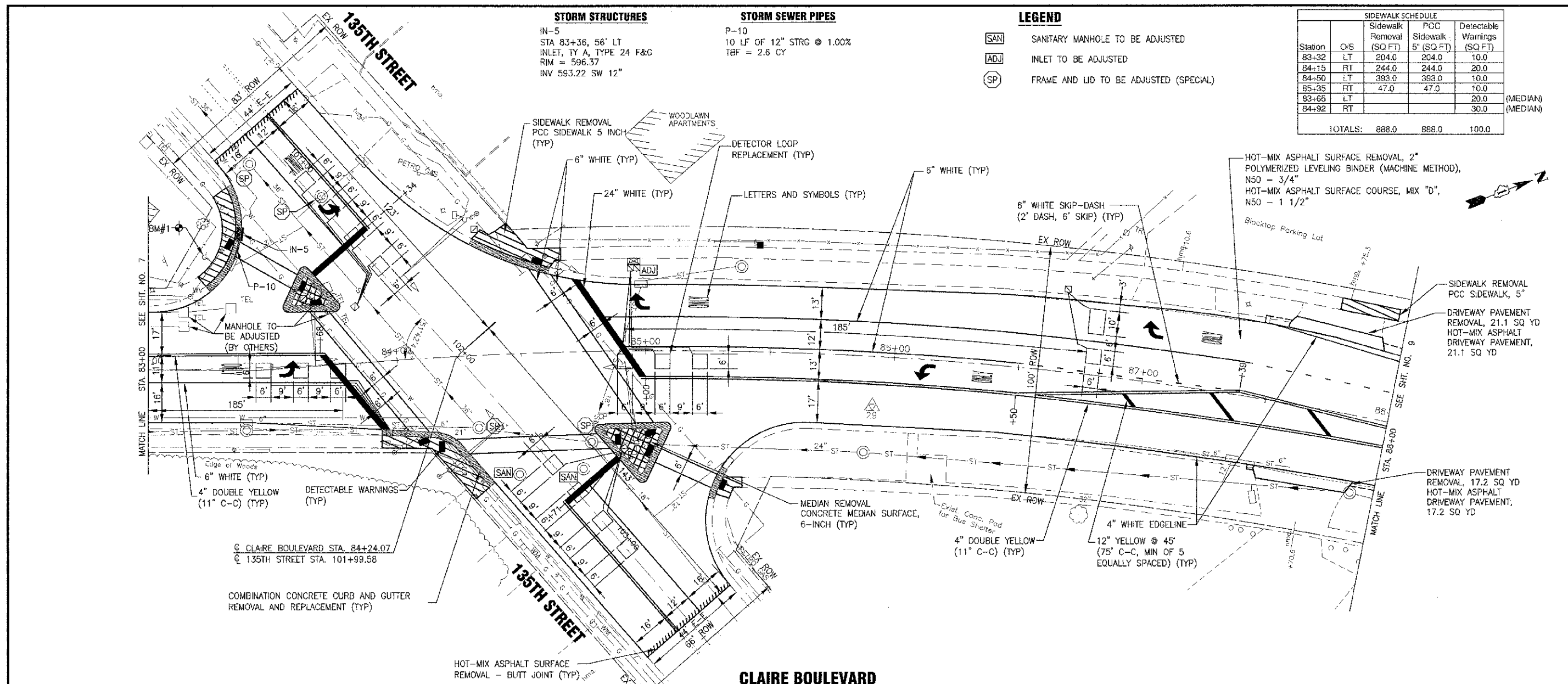

DESIGNED - REW	REVISED -
DRAWN - LKB	REVISED -
CHECKED - LDH	REVISED -
DATE - 04-20-12	REVISED -

**STATE OF ILLINOIS
 DEPARTMENT OF TRANSPORTATION**

**PLAN AND PROFILE
 CLAIRE BOULEVARD**

SCALE: HORIZ. 1"=20' / VERT. 1"=5'
 PROJECT NO: 100493 | STA. 83+00 TO STA. 88+00

F.A.U. RTE.	SECTION	COUNTY	TOTAL SHEETS	SHEET NO.
1596	10-00026-00-RS	COOK	21	8
CONTRACT NO.: 63692				

PROJECT: LAKE FOREST, ILLINOIS - CLAREMONT - CADD SURVEY DRAWINGS (JMS) 100493 - PLAN AND PROFILE
 DATE: 07/2012 3:42 PM BY: 5006/AR
 Copyright © 2012, by Baxter & Woodman, Inc.
 State of Illinois - Professional Design Firm
 License No.: 134-001121 - Expires: 4-30-15