

NO.	DATE	BY	REVISIONS

NO.	DATE	BY	REVISIONS

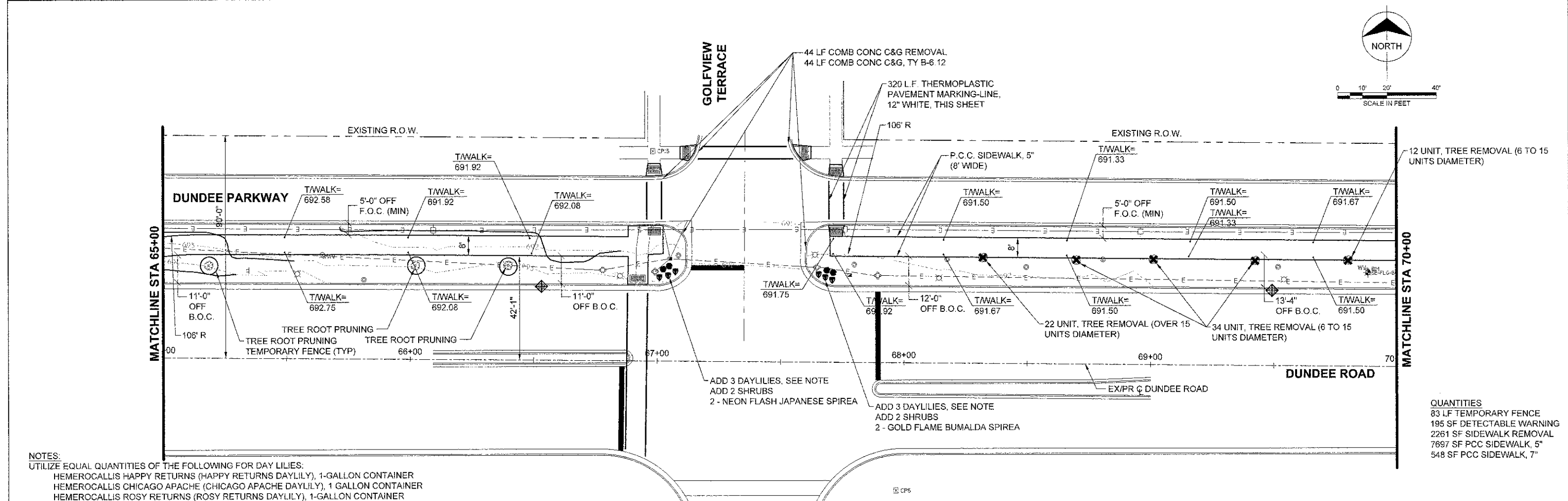
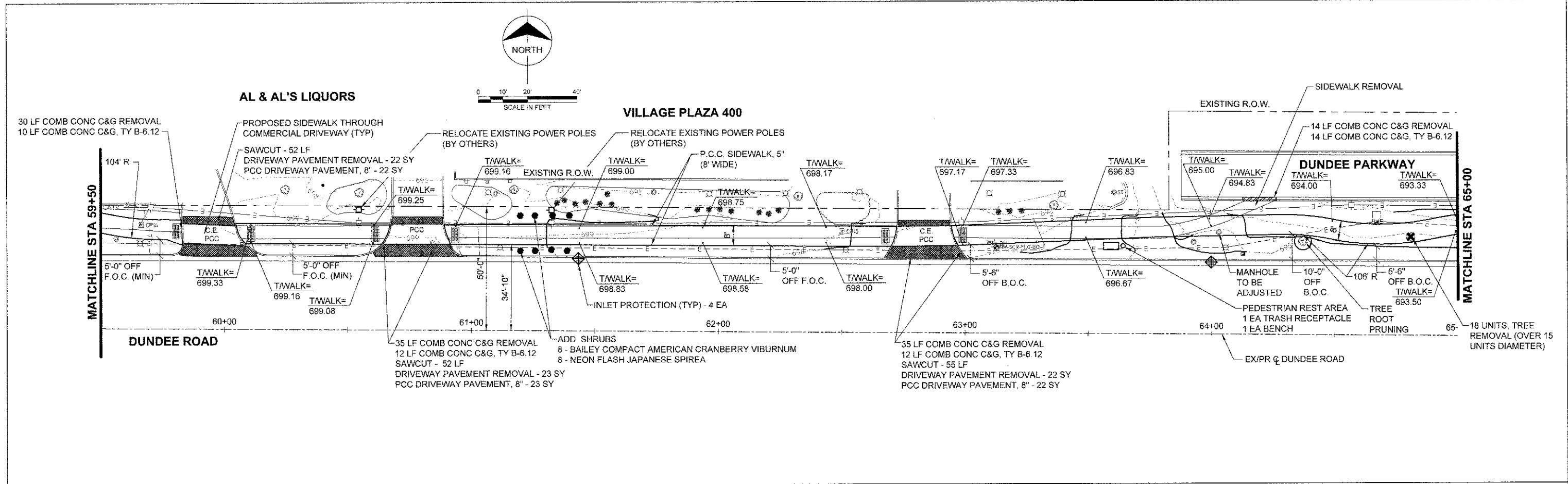

NOTES:
 UTILIZE EQUAL QUANTITIES OF THE FOLLOWING FOR DAY LILIES:
 HEMEROCALLIS HAPPY RETURNS (HAPPY RETURNS DAYLILY), 1-GALLON CONTAINER
 HEMEROCALLIS CHICAGO APACHE (CHICAGO APACHE DAYLILY), 1 GALLON CONTAINER
 HEMEROCALLIS ROSY RETURNS (ROSY RETURNS DAYLILY), 1-GALLON CONTAINER

**STATE OF ILLINOIS
 DEPARTMENT OF TRANSPORTATION**

**PLAN SHEET C003
 STA 59+50 TO 70+00**

FILE NAME	USER NAME	DESIGNED	REVISOR	F.A.U. R.T.E.	SECTION	COUNTY	TOTAL SHEETS	SHEET NO.
D:\Buff\Info Drive\04303 - Dundee Road	D. P-RVEZ	IMC	IMC	343	08-00095-00-SW	COOK	17	7
Drawn by: [Blank]		IMC						
Checked by: [Blank]		AJB						
Date: 8-16-2010								

SCALE: 1"=20' | SHEET NO. 3 OF 6 SHEETS | STA. 59+50 TO STA. 70+00 | FED. ROAD DIST. NO. 1 ILLINOIS FED. AID PROJECT | CONTRACT NO. 63614