

DATE	
BY	
FINAL SURVEY	SURVEYED
NOTE BOOK	PLOTTED
NO.	TEMPLATE
	AREAS CHECKED

DATE	
BY	
ORIGINAL SURVEY	SURVEYED
NOTE BOOK	PLOTTED
NO.	TEMPLATE
	AREAS CHECKED

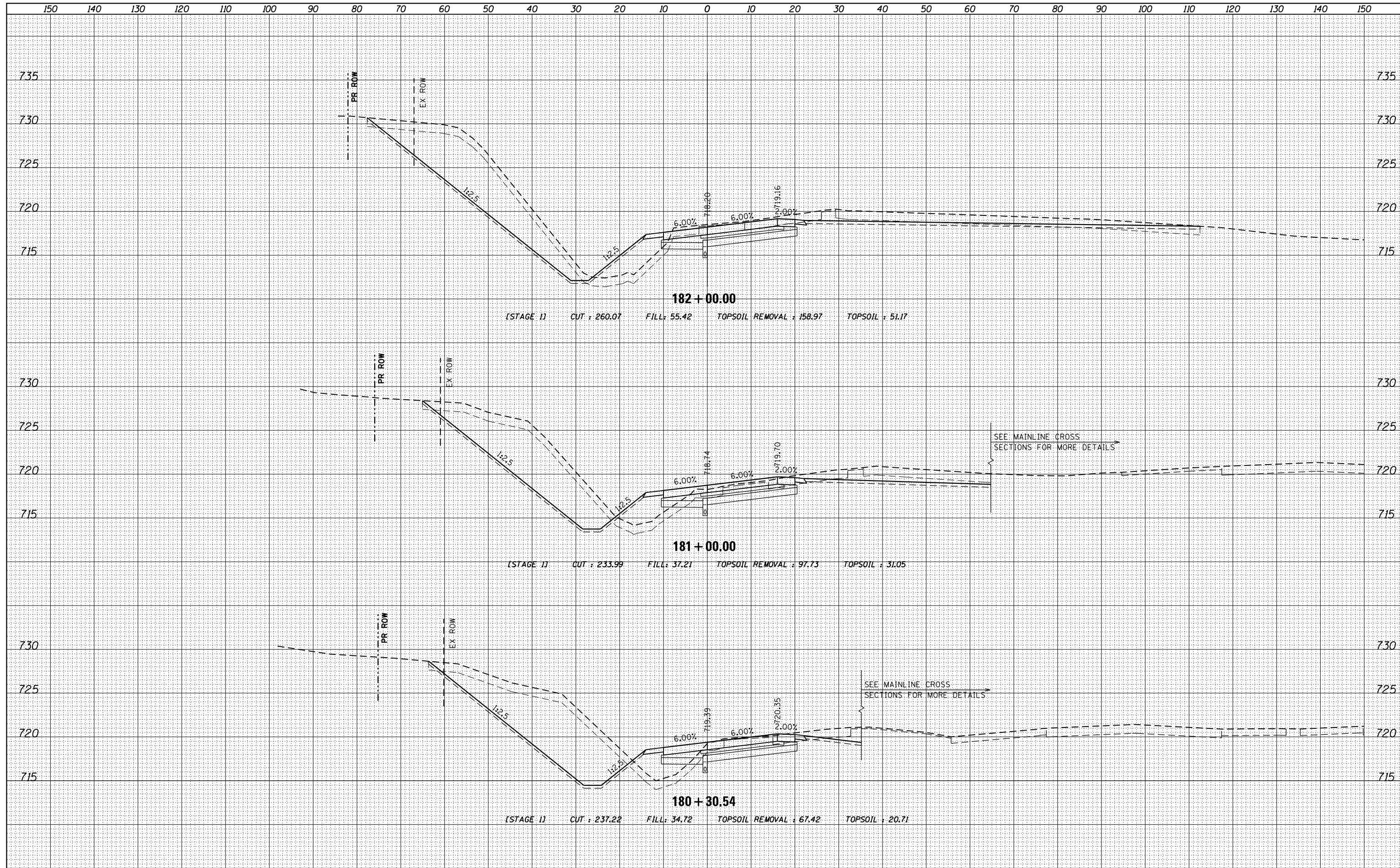

FILE NAME = D:\60L77-SHT-XSC_P94SEN.dgn

USER NAME = default	DESIGNED -	REVISED -
PLOT SCALE = H=1"=10' V=1"=5'	DRAWN -	REVISED -
PLOT DATE = 6/20/2012	CHECKED -	REVISED -
	DATE -	REVISED -

**STATE OF ILLINOIS
DEPARTMENT OF TRANSPORTATION**

**CROSS SECTIONS
SB OLD US-41 TO SB I-94**

SCALE: $\frac{1}{4}$ " = 1' = $\frac{10}{16}$ ' SHEET 104 OF 110 SHEETS STA. 180+30.54 TO STA. 182+00.00

F.A. RTE.	SECTION	COUNTY	TOTAL SHEETS	SHEET NO.
94	49-1-R-1	LAKE	677	603F
CONTRACT NO. 60L77				

ILLINOIS FED. AID PROJECT