

NOTES

1. SEE IDOT STD 781001-03 FOR RAISED RELECTIVE PAVEMENT MARKERS
2. SEE IDOT STD 782001 FOR PRISMATIC CURB REFLECTORS
3. SEE IDOT DISTRICT ONE STD TC12 FOR MULTI-LANE FREEWAY PAVEMENT MARKING DETAILS
4. STATIONARY LOCATION REFERENCE FOR GROUND MOUNTED SIGNS APPLIES TO THE CENTER OF THE SIGN OR AS DIRECTED BY THE ENGINEER.

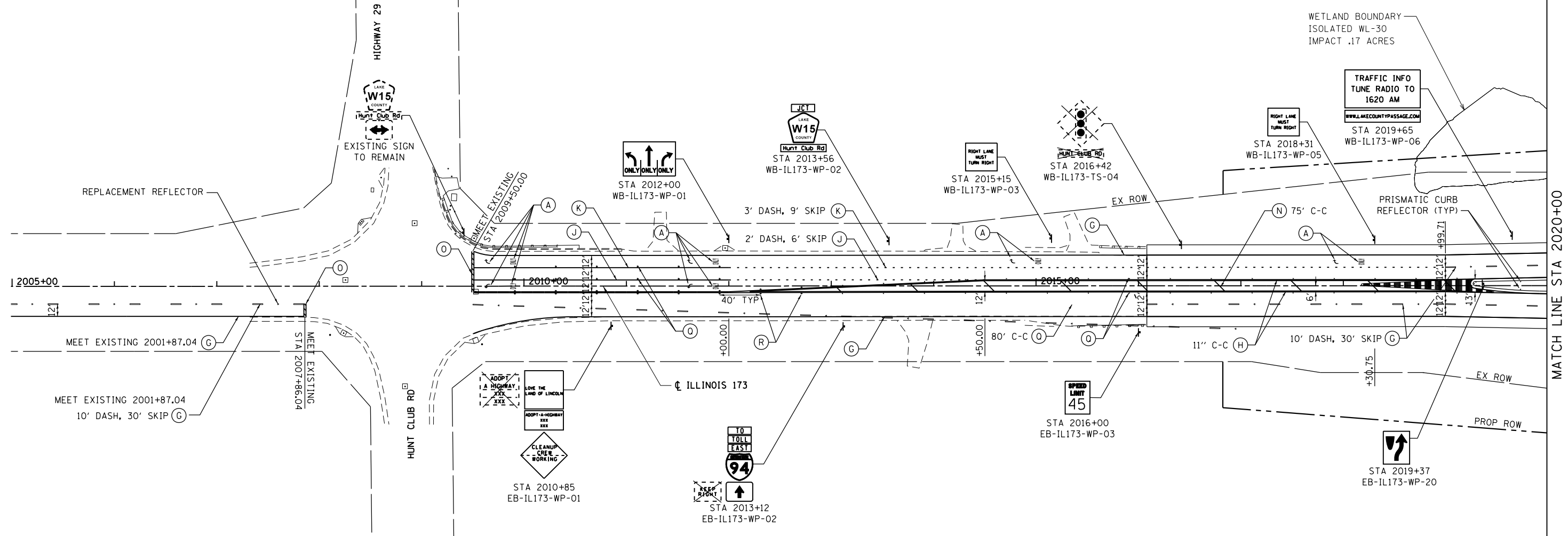

LEGEND

- | | |
|---|---|
| (A) POLYUREA PAVEMENT MARKING TYPE I-LETTERS & SYMBOLS (WHITE) | (I) POLYUREA PAVEMENT MARKING TYPE I-5" LINE (WHITE) |
| (B) POLYUREA PAVEMENT MARKING TYPE I-4" LINE (WHITE)
GROOVING FOR RECESSED PAVEMENT MARKING LINES, 5" GROOVE | (J) POLYUREA PAVEMENT MARKING TYPE I-6" LINE (WHITE) |
| (C) POLYUREA PAVEMENT MARKING TYPE I-4" LINE (YELLOW)
GROOVING FOR RECESSED PAVEMENT MARKING LINES, 5" GROOVE | (K) POLYUREA PAVEMENT MARKING TYPE I-8" LINE (WHITE) |
| (D) POLYUREA PAVEMENT MARKING TYPE I-6" LINE (WHITE)
GROOVING FOR RECESSED PAVEMENT MARKING LINES, 7" GROOVE | (L) POLYUREA PAVEMENT MARKING TYPE I-8" LINE (YELLOW) |
| (E) POLYUREA PAVEMENT MARKING TYPE I-10" LINE (WHITE)
GROOVING FOR RECESSED PAVEMENT MARKING LINES, 11" GROOVE | (M) POLYUREA PAVEMENT MARKING TYPE I-12" LINE (WHITE) |
| (F) POLYUREA PAVEMENT MARKING TYPE I-24" LINE (WHITE)
GROOVING FOR RECESSED PAVEMENT MARKING LINES, 25" GROOVE | (N) POLYUREA PAVEMENT MARKING TYPE I-12" LINE (YELLOW) |
| (G) POLYUREA PAVEMENT MARKING TYPE I-4" LINE (WHITE) | (O) POLYUREA PAVEMENT MARKING TYPE I-24" LINE (WHITE) |
| (H) POLYUREA PAVEMENT MARKING TYPE I-4" LINE (YELLOW) | (P) THERMOPLASTIC PAVEMENT MARKING-12" LINE (WHITE) |
| | (Q) ONE-WAY RAISED REFLECTIVE PAVEMENT MARKERS |
| | (R) TWO-WAY AMBER RAISED REFLECTIVE PAVEMENT MARKERS |
| | (S) POLYUREA PAVEMENT MARKING TYPE I-LETTERS & SYMBOLS (WHITE)
GROOVING FOR RECESSED PAVEMENT MARKINGS, LETTERS, NUMBERS AND SYMBOLS |

BOWMAN, BARRETT & ASSOCIATES INC.
CONSULTING ENGINEERS
Chicago, Illinois
312.228.0100
www.bbandainc.com

FILE NAME = \$FILES\$	USER NAME = default	DESIGNED - MAB	REVISED -
		DRAWN - MAB	REVISED -
	PLOT SCALE = H=1"=10' V=1"=5'	CHECKED - RGR	REVISED -
	PLOT DATE = 6/20/2012	DATE - 6/19/2012	REVISED -

**STATE OF ILLINOIS
DEPARTMENT OF TRANSPORTATION**

PAVEMENT MARKING & SIGNING PLAN IL RTE 173
SCALE: 1"=50' SHEET NO. 12 OF 15 SHEETS STA. 2005+00 TO STA. 2020+00

F.A. RTE.	SECTION	COUNTY	TOTAL SHEETS	SHEET NO.
94	49-1-R-1	LAKE	677	279
CONTRACT NO. 60L77				
ILLINOIS FED. AID PROJECT				

S:\1101\95\CADD\60L77_IL_173\60L77_Sheets\0160L77-INT-pmk12.dgn