

MAINTENANCE OF TRAFFIC SIGNING LEGEND

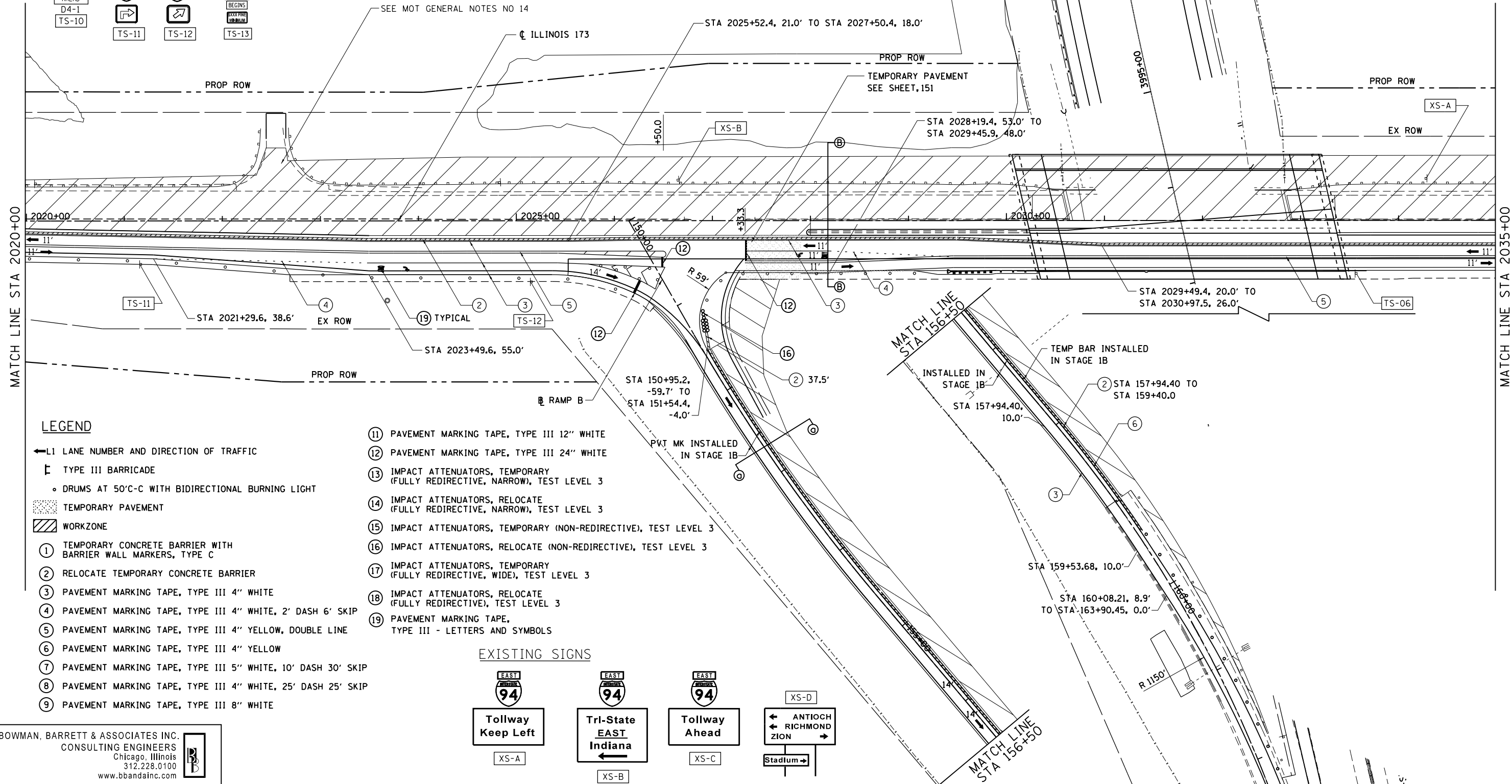
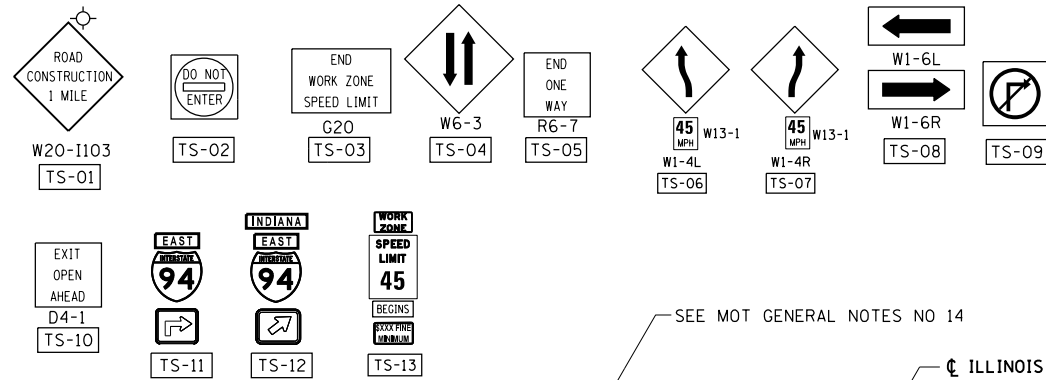

LEGEND

- ← L1 LANE NUMBER AND DIRECTION OF TRAFFIC
- ▤ TYPE III BARRICADE
- DRUMS AT 50'C-C WITH BIDIRECTIONAL BURNING LIGHT
- ▨ TEMPORARY PAVEMENT
- ▨ WORKZONE
- ① TEMPORARY CONCRETE BARRIER WITH BARRIER WALL MARKERS, TYPE C
- ② RELOCATE TEMPORARY CONCRETE BARRIER
- ③ PAVEMENT MARKING TAPE, TYPE III 4" WHITE
- ④ PAVEMENT MARKING TAPE, TYPE III 4" WHITE, 2' DASH 6' SKIP
- ⑤ PAVEMENT MARKING TAPE, TYPE III 4" YELLOW, DOUBLE LINE
- ⑥ PAVEMENT MARKING TAPE, TYPE III 4" YELLOW
- ⑦ PAVEMENT MARKING TAPE, TYPE III 5" WHITE, 10' DASH 30' SKIP
- ⑧ PAVEMENT MARKING TAPE, TYPE III 4" WHITE, 25' DASH 25' SKIP
- ⑨ PAVEMENT MARKING TAPE, TYPE III 8" WHITE

- ⑪ PAVEMENT MARKING TAPE, TYPE III 12" WHITE
- ⑫ PAVEMENT MARKING TAPE, TYPE III 24" WHITE
- ⑬ IMPACT ATTENUATORS, TEMPORARY (FULLY REDIRECTIVE, NARROW), TEST LEVEL 3
- ⑭ IMPACT ATTENUATORS, RELOCATE (FULLY REDIRECTIVE, NARROW), TEST LEVEL 3
- ⑮ IMPACT ATTENUATORS, TEMPORARY (NON-REDIRECTIVE), TEST LEVEL 3
- ⑯ IMPACT ATTENUATORS, RELOCATE (NON-REDIRECTIVE), TEST LEVEL 3
- ⑰ IMPACT ATTENUATORS, TEMPORARY (FULLY REDIRECTIVE, WIDE), TEST LEVEL 3
- ⑱ IMPACT ATTENUATORS, RELOCATE (FULLY REDIRECTIVE), TEST LEVEL 3
- ⑲ PAVEMENT MARKING TAPE, TYPE III - LETTERS AND SYMBOLS

EXISTING SIGNS

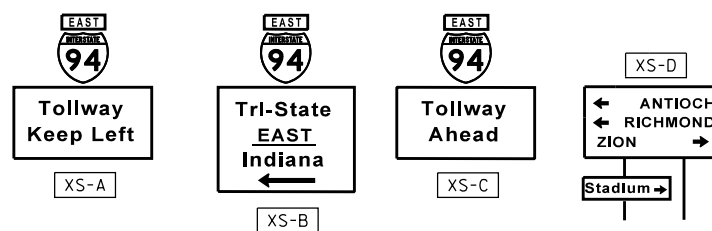

BOWMAN, BARRETT & ASSOCIATES INC.
CONSULTING ENGINEERS
Chicago, Illinois
312.228.0100
www.bbainc.com

| | | | |
|-----------------------|---------------------|------------------|-----------|
| FILE NAME = \$FILES\$ | USER NAME = default | DESIGNED - | REVISED - |
| | | DRAWN - RA | REVISED - |
| | | CHECKED - RGR | REVISED - |
| | | DATE - 6/19/2012 | REVISED - |

STATE OF ILLINOIS
DEPARTMENT OF TRANSPORTATION

MOT PLAN IL RTE 173 - STAGE 2A

SCALE: 1"=50' SHEET NO. 11 OF 14 SHEETS STA. 2020+00 TO STA. 2035+00

| F.A. RTE. | SECTION | COUNTY | TOTAL SHEETS | SHEET NO. |
|--------------------|----------|--------|--------------|-----------|
| 94 | 49-1-R-1 | LAKE | 677 | 152 |
| CONTRACT NO. 60L77 | | | | |

ILLINOIS FED. AID PROJECT