

PLAN	SURVEYED	BY	DATE
	PLOTTED		
	NOTE BOOK		
	NO.		
	CHECKED		
	FILE NAME		

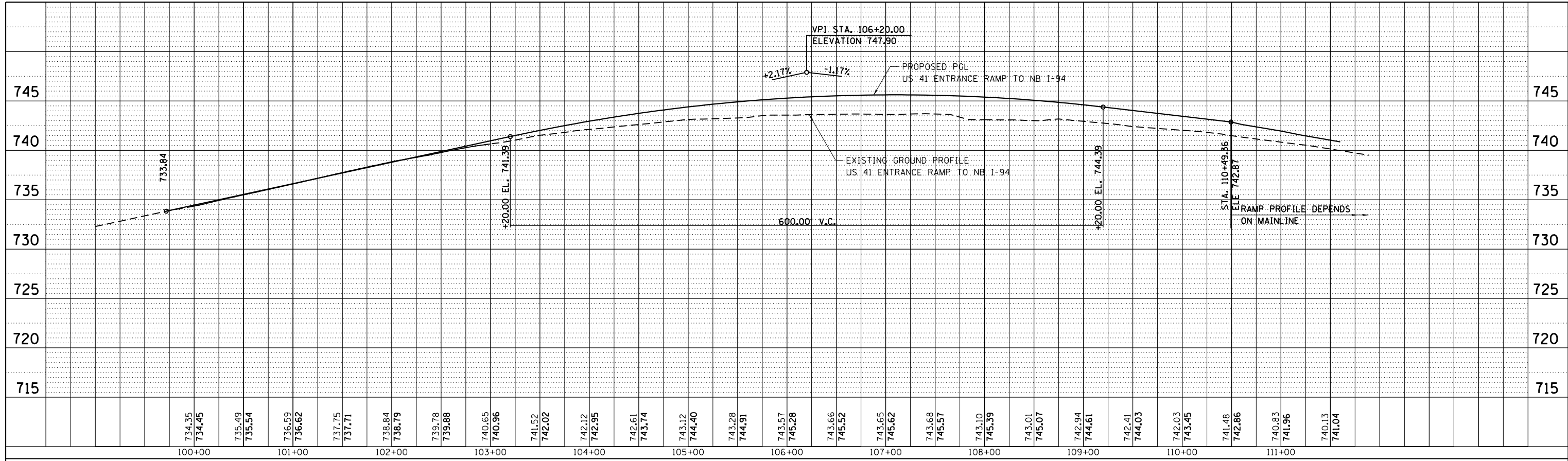

PROFILE	SURVEYED	BY	DATE
	PLOTTED		
	GRADES CHECKED		
	NO.		
	STRUCTURE		
	NOTATION		
	CPAD		

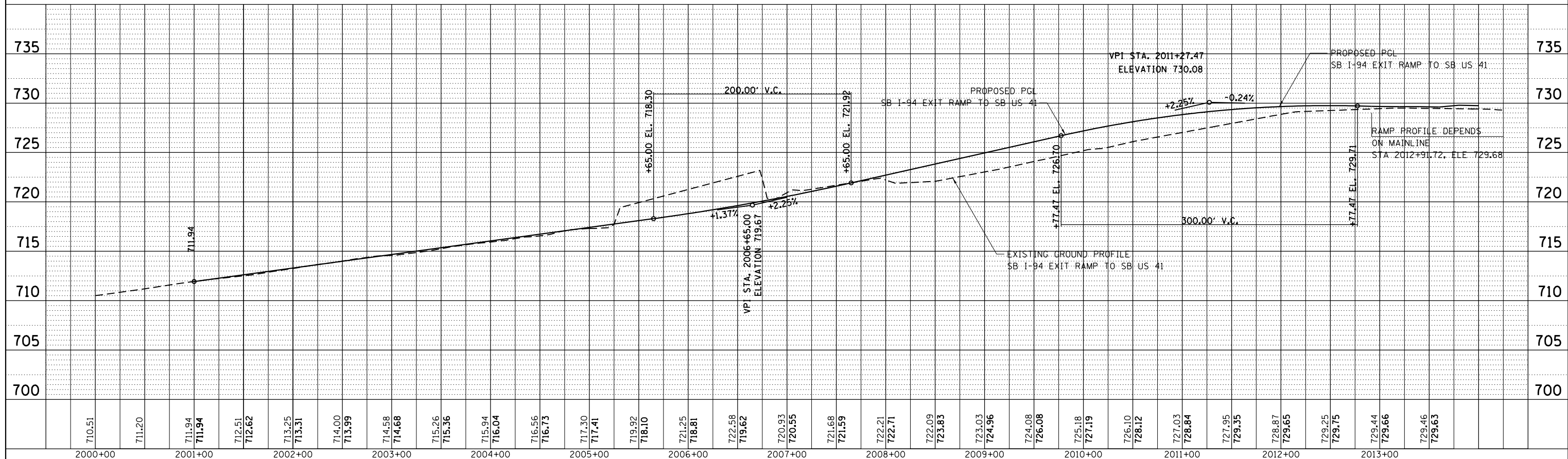

FILE NAME = D:\60L77-sht-profile.dgn

USER NAME = default
 PLOT SCALE = H=1"=10' V=1"=5'
 PLOT DATE = 6/20/2012

DESIGNED	-	REVISED	-
DRAWN	-	REVISED	-
CHECKED	-	REVISED	-
DATE	- 6/19/2012	REVISED	-

**STATE OF ILLINOIS
 DEPARTMENT OF TRANSPORTATION**

PROPOSED PROFILE
US 41 ENTRANCE RAMP TO NB I-94 US 41 EXIT RAMP FROM SB I-94
 SCALE: 1"=50' SHEET NO. 7 OF 10 SHEETS STA. TO STA.

F.A. RTE.	SECTION	COUNTY	TOTAL SHEETS	SHEET NO.
94	49-1-R-1	LAKE	677	93
CONTRACT NO. 60L77				
ILLINOIS FED. AID PROJECT				