

STATE OF ILLINOIS
DEPARTMENT OF TRANSPORTATION
DIVISION OF HIGHWAYS

PLANS FOR
PROPOSED FEDERAL AID HIGHWAY
HESSING STREET
FULLERTON AVENUE TO GRAND AVENUE
ROADWAY RESURFACING (LAPP)
SECTION 07-00088-00-FP
PROJECT HPP-4065(005)
JOB C-91-186-07
VILLAGE OF RIVER GROVE
COOK COUNTY

FOR INDEX OF SHEETS SEE SHEET NO. 2

PROJECT LOCATED IN
THE VILLAGE OF RIVER GROVE

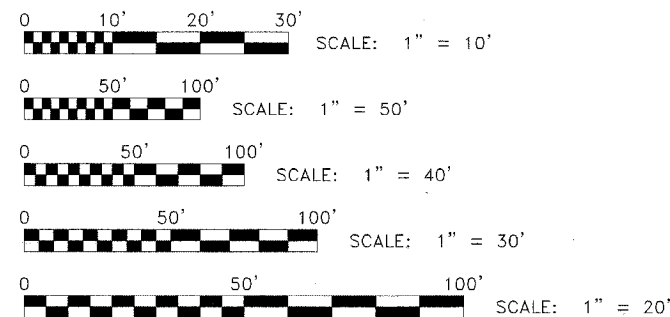

FULL SIZE PLANS HAVE BEEN PREPARED USING STANDARD
ENGINEERING SCALES. REDUCED SIZED PLANS WILL NOT
CONFORM TO STANDARD SCALES. IN MAKING MEASUREMENTS
ON REDUCED PLANS, THE ABOVE SCALES MAY BE USED.

CONTRACT NO. 83939

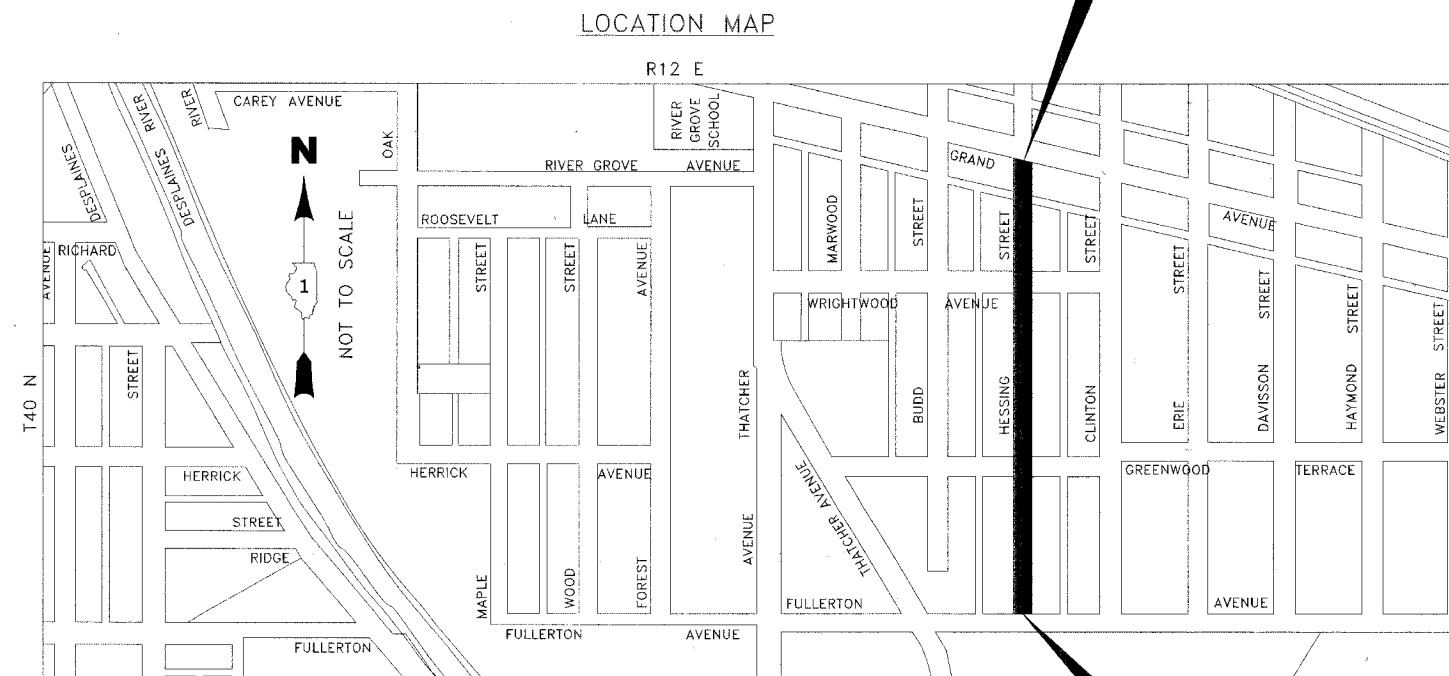

LEYDEN TOWNSHIP

— AREA OF IMPROVEMENT

GROSS AND NET LENGTH OF PROJECT = 1770 FT. = 0.34 MI.

PROJECT ENDS
STATION 18+62
HESSING STREET

PROJECT BEGINS
STATION 0+92
HESSING STREET

ROUTE NO.	SECTION	COUNTY	TOTAL SHEETS	SHEET NO.
FAU	**	COOK	11	1
ILLINOIS PROJECT HPP-4065(005)				
VILLAGE SECTION 07-00088-00-FP				
CONTRACT NO. 83939				



LOCATION OF SECTION
INDICATED THUS:

Derek S. Treichel



TRAFFIC DATA

DESIGN DESIGNATION: LOCAL ROAD
DESIGN SPEED LIMIT: 25 MPH
POSTED SPEED LIMIT: 25 MPH
ADT: 400

DATE SIGNED: 04-13-07
LICENSE EXPIRES: 11-30-07

ILLINOIS DEPARTMENT OF TRANSPORTATION
DEPARTMENT OF HIGHWAYS

APPROVED April 13 20 07

Marjorie May
VILLAGE OF RIVER GROVE, PRESIDENT

PASSED May 31 20 07

Christopher Holt
DISTRICT ENGINEER OF LOCAL ROADS & STREETS

RELEASING FOR BID
BASED ON LIMITED
REVIEW June 1, 2007 20 07

Diane O'Keefe
DEPUTY DIRECTOR OF HIGHWAYS, REGION 1 ENGINEER

(PRINTED BY AUTHORITY OF THE STATE OF ILLINOIS)

BEFORE YOU DIG, CALL J.U.L.I.E. (800) 892-0123

E.H.E. NO. 760-07-00420

Drawing file: W:\Projects\76007064 - 2007 St. Resurf. HPP\INDEX.dwg Apr 11, 2007 - 3:32pm

ROUTE NO.	SECTION	COUNTY	TOTAL SHEETS	SHEET NO.
FAU	**	COOK	11	2
ILLINOIS PROJECT		HPP-4065(003)		
VILLAGE SECTION		07-00088-00-FP		
CONTRACT NO.		83939		

GENERAL NOTES

STANDARDS

ANY REFERENCE TO STANDARDS THROUGHOUT THE PLANS OR SPECIAL PROVISIONS SHALL BE INTERPRETED TO BE THE LATEST STANDARD OF THE ILLINOIS DEPARTMENT OF TRANSPORTATION AS SHOWN ON THE INDEX OF SHEETS IN THE PLANS.

UNDERGROUND UTILITIES

BEFORE STARTING ANY EXCAVATION, THE CONTRACTOR SHALL CALL "JULIE" AT 800-892-0123 FOR FIELD LOCATIONS OF BURIED ELECTRICAL, TELEPHONE AND GAS FACILITIES. (48 HOURS NOTIFICATION IS REQUIRED).

THE LOCATIONS OF THE UNDERGROUND UTILITIES IF SHOWN ON THE PLANS HAVE BEEN OBTAINED BY FIELD SURVEYS AND SEARCHES OF AVAILABLE RECORDS. IT IS BELIEVED THAT THE DATA IS ESSENTIALLY CORRECT, BUT THE VILLAGE OF RIVER GROVE, THE ILLINOIS DEPARTMENT OF TRANSPORTATION AND/OR OTHER OFFICES AND AGENCIES ASSOCIATED WITH THE DEVELOPMENT OF THESE PLANS DO NOT GUARANTEE THEIR ACCURACY OR COMPLETENESS OF THIS INFORMATION. THE CONTRACTOR WILL BE REQUIRED TO VERIFY THE EXACT LOCATION OF EACH FACILITY WITH THE RESPECTIVE UTILITY COMPANY, AND SHALL TAKE DUE CARE IN ALL PHASES OF THE CONSTRUCTION TO PROTECT ANY SUCH FACILITIES WHICH MAY BE AFFECTED BY THE WORK. ANY DAMAGE TO EXISTING UTILITIES SHALL BE REPAIRED AT THE CONTRACTOR'S EXPENSE.

THE CONTRACTOR SHALL COORDINATE CONSTRUCTION ACTIVITIES WITH UTILITY COMPANIES AND THE VILLAGE OF RIVER GROVE.

MAINTENANCE OF SEWER FLOWS

THE CONTRACTOR SHALL CONDUCT HIS OPERATIONS AS TO MAINTAIN FLOW THROUGH EXISTING STORM AND SANITARY SEWER SYSTEMS AT ALL TIMES. HE SHALL ALSO PROVIDE AND MAINTAIN AN EFFICIENT PUMPING PLANT IF NECESSARY AND A TEMPORARY OUTLET AND BE PREPARED AT ALL TIMES TO DISPOSE OF THE WATER COLLECTED IN A SAFE MANNER WITHOUT DAMAGE OF ANY KIND TO ADJACENT PROPERTIES. THE ENDS OF EXISTING DRAINAGE LINES WHICH ARE NOT TO BE INCORPORATED INTO THE PROJECT ARE TO BE SEALED AS SPECIFIED IN THE SPECIAL PROVISIONS. EXISTING STRUCTURES ARE TO BE INSPECTED BEFORE CONSTRUCTION STARTS - ANY ACCUMULATION OF MATERIAL IN THE STRUCTURE DUE TO CONSTRUCTION OPERATIONS SHALL BE REMOVED BY THE CONTRACTOR AT HIS EXPENSE.

MAINTENANCE OF EXISTING DRAINAGE STRUCTURES

WHEN DURING THE CONSTRUCTION OPERATIONS, ANY LOOSE MATERIAL IS DEPOSITED IN THE FLOW LINE OF ANY GUTTERS AND DRAINAGE STRUCTURE SO THAT THE NATURAL FLOW OF WATER IS OBSTRUCTED, IT SHALL BE REMOVED AT THE CLOSE OF EACH WORKING DAY. AT THE CONCLUSION OF THE CONSTRUCTION OPERATIONS, ALL DRAINAGE FACILITIES SHALL BE CLEAN AND FREE OF ALL OBSTRUCTIONS DUE TO CONSTRUCTION OPERATIONS. THE COST OF THIS WORK SHALL BE INCIDENTAL TO THE CONTRACT.

SAW CUTTING

THE CONTRACTOR SHALL SAW CUT ASPHALT PAVEMENT AND DRIVEWAY PAVEMENT AS INDICATED ON THE PLANS TO SEPARATE THE EXISTING PAVEMENT TO BE REMOVED BY APPROVED MEANS OR AN APPROVED CONCRETE SAW TO A DEPTH AS DIRECTED BY THE ENGINEER. SUITABLE GUIDELINES OR DEVICES SHALL BE USED TO ASSURE CUTTING A NEAT, STRAIGHT LINE AS SHOWN ON THE PLANS. CARE SHALL BE TAKEN BY THE CONTRACTOR AS NOT TO DAMAGE THE REMAINING PAVEMENT DIRECTLY ADJACENT TO THE PAVEMENT TO BE REMOVED. ANY DAMAGE TO THE EXISTING PAVEMENT RESULTING FROM PAVEMENT REMOVAL OPERATIONS SHALL BE REPAIRED AT THE CONTRACTOR'S EXPENSE. THE COST OF SAW CUTTING SHALL BE INCLUDED IN THE ITEM BEING REMOVED.

PRIME COAT

PRIME COAT MUST BE INSTALLED NO EARLIER THAN TWENTY-FOUR (24) HOURS PRIOR TO PLACEMENT OF HOT-MIX ASPHALT BINDER.

BARRICADES

THE CONTRACTOR SHALL PROVIDE AND INSTALL TWO (2) WEIGHTED SANDBAGS ON EACH TYPE I OR TYPE II BARRICADE USED, ONE (1) WEIGHTED SANDBAG ACROSS EACH BOTTOM RAIL

BUTT JOINTS

BUTT JOINT WILL BE INSTALLED AT THE ENDS OF ALL RESURFACING (WHERE RESURFACING MEETS EXISTING PAVEMENT). IN ACCORDANCE WITH THE "BUTT JOINT AND HOT-MIX ASPHALT TAPER DETAILS" SHEET INCLUDED IN THE PLANS, UNLESS OTHERWISE SPECIFIED.

MILLED PAVEMENT OPEN TO TRAFFIC

WHEN MILLED PAVEMENT IS OPEN TO TRAFFIC THE MAXIMUM GRADE DIFFERENTIAL BETWEEN PASSES OF THE MILLING MACHINE SHALL NOT EXCEED 1-1/2 INCHES (40MM) WHERE THE SPEED LIMIT IS 45 MPH (80 KM/H) OR LESS AND 1 INCH (25 MM) WHERE THE SPEED LIMIT IS GREATER THAN 45 MPH (80 KM/H). WITH WRITTEN APPROVAL FROM THE ENGINEER, A MAXIMUM GRADE DIFFERENTIAL OF 3 INCHES (75 MM) MAY BE ALLOWED IF THE EDGE OF THE MILLING IS SLOPED A MINIMUM 1:3 (V:H)

LEGEND OF SYMBOLS

(TO BE USED IN CONJUNCTION WITH I.D.O.T. STANDARD 000001-04)

EXISTING	PROPOSED	DESCRIPTION	EXISTING	PROPOSED	DESCRIPTION
		GAS LINE			
		TELEPHONE LINE			PROPOSED CONCRETE PAVEMENT, SIDEWALK, OR DRIVEWAY
		SANITARY SEWER			PROPOSED HOT-MIX ASPHALT SURFACE COURSE, HOT-MIX ASPHALT DRIVEWAYS, OR INCIDENTAL HOT-MIX ASPHALT SURFACING
		WATER MAIN			
		STORM SEWER			
		COMBINATION SEWER			PAVEMENT, SIDEWALK OR DRIVEWAY TO BE REMOVED
		FIRE HYDRANT			HOT-MIX ASPHALT DRIVEWAYS OR SURFACE TO BE REMOVED (PARKWAY) OR HOT-MIX ASPHALT BUTT JOINT (PAVEMENT)
		POWER POLE			CONCRETE CURB & GUTTER
		WATER MAIN VALVE VAULT			CONCRETE CURB & GUTTER TO BE REMOVED
		WATER MAIN VALVE BOX			
		MANHOLE			
		INLET			
		BUFFALO BOX			
		CATCH BASIN		A	FRAMES AND LIDS TO BE ADJUSTED
		RIM ELEVATION (SANITARY)		A-1C	STRUCTURE TO BE ADJUSTED WITH A NEW TYPE 1 FRAME & LID (C = CLOSED, P = OPEN LID)
		INVERT ELEVATION			
		RIM ELEVATION (STORM)		RC	STRUCTURE TO BE RECONSTRUCTED
		INVERT ELEVATION		R-1C	STRUCTURE TO BE RECONSTRUCTED WITH A NEW TYPE 1 FRAME & LID (C = CLOSED, P = OPEN LID)
		RIM ELEVATION (WATER MAIN)			
		TOP OF WATER MAIN		RM	STRUCTURE REMOVAL

INDEX OF SHEETS

SHEET NO.	DESCRIPTION
1	COVER SHEET, LOCATION MAP
2	INDEX OF SHEETS, LEGEND, GENERAL NOTES, & I.D.O.T. STANDARD DRAWINGS
3	DETAILS
4	SUMMARY OF QUANTITIES
5	EXISTING AND PROPOSED TYPICAL CROSS SECTIONS
6-8	PAVING AND PAVEMENT MARKING PLANS
9	BUTT JOINT AND HOT-MIX ASPHALT TAPER DETAILS
10	TRAFFIC CONTROL AND PROTECTION FOR SIDE ROADS, INTERSECTIONS AND DRIVEWAYS
11	DISTRICT ONE TYPICAL PAVEMENT MARKINGS

I.D.O.T. STANDARD DRAWINGS

STANDARD NO.	TITLE OR DESCRIPTION
000001-04	STANDARD SYMBOLS, ABBREVIATIONS AND PATTERNS
424001-04	CURB RAMPS FOR SIDEWALKS
442201-02	CLASS C AND D PATCHES
602601-01	PRECAST REINFORCED CONCRETE FLAT SLAB TOP
604001-02	FRAMES AND LIDS, TYPE 1
701501-03	URBAN LANE CLOSURE, 2-LANE, 2-WAY, UNDIVIDED
701801-03	LANE CLOSURE MULTILANE 1W OR 2W CROSSWALK OR SIDEWALK CLOSURE
702001-06	TRAFFIC CONTROL DEVICES



◆ Civil Engineers
◆ Municipal Consultants
◆ Established 1911

9933 Roosevelt Road
Westchester, Illinois 60154-2780
Phone: 708/865-0300
Fax: 708/865-1212

2007 STREET RESURFACING PROJECT
VILLAGE OF RIVER GROVE, ILLINOIS

INDEX OF SHEETS, LEGEND
OF SYMBOLS, GENERAL NOTES,
& I.D.O.T. STANDARD DRAWINGS

REVISION:

SCALE:	NONE
DRAWN BY:	MK
BOOK NO.:	1505
DATE:	04/09/07
E.H.E. NO.:	760-07-00401

SHEET
2
OF
11

ROUTE NO.	SECTION	COUNTY	TOTAL SHEETS	SHEET NO.
FAU	**	COOK	11	3
ILLINOIS PROJECT HPP-4065(003)				
VILLAGE SECTION 07-00088-00-FP				
CONTRACT NO. 83939				

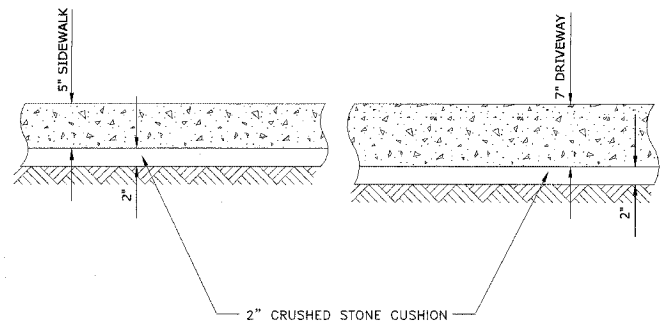

TYPICAL P.C.C. SIDEWALK & DRIVEWAY DETAIL

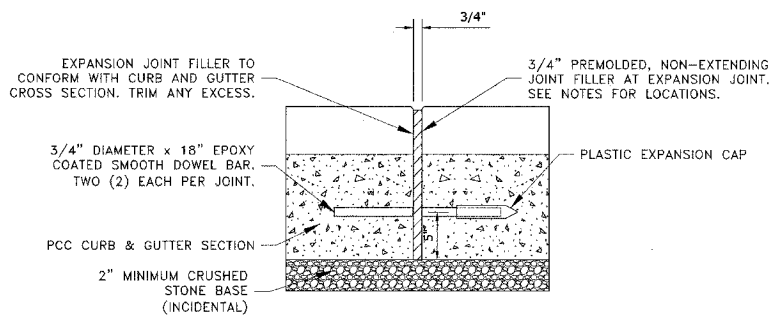

NOTE:
1. EXPANSION JOINTS ARE TO BE CONSTRUCTED AT ALL PC'S & PT'S OF INTERSECTION RETURNS AND ALL OTHER SHORT RADIUS SECTIONS, CONSTRUCTION JOINTS, EVERY 50' ON TANGENT SECTIONS, AND AS DIRECTED BY THE ENGINEER.

TYPICAL CURB AND GUTTER EXPANSION JOINT

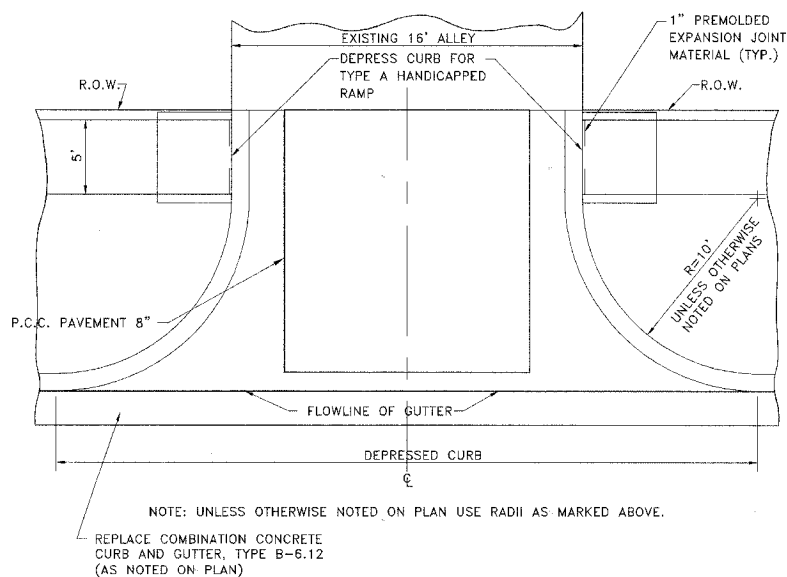

ALLEY RETURN DETAIL

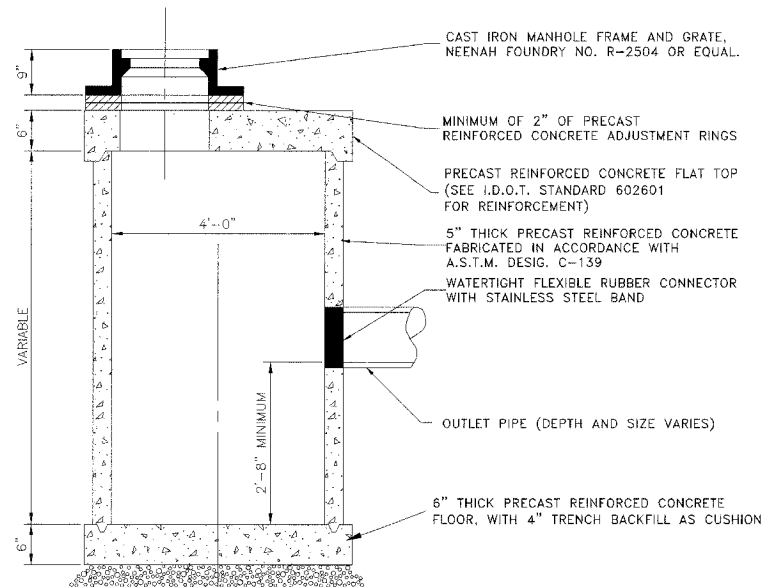

RESTRICTED DEPTH CATCH BASIN

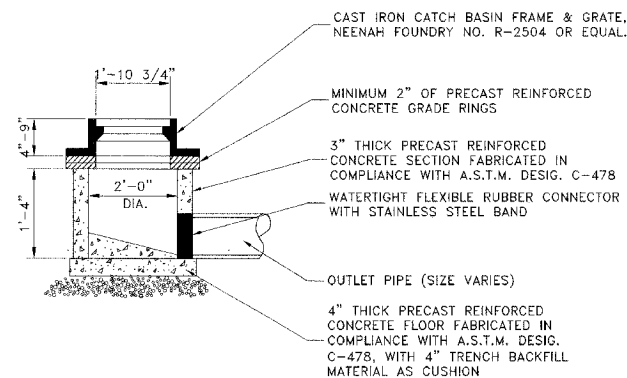

INLET, TYPE "A"

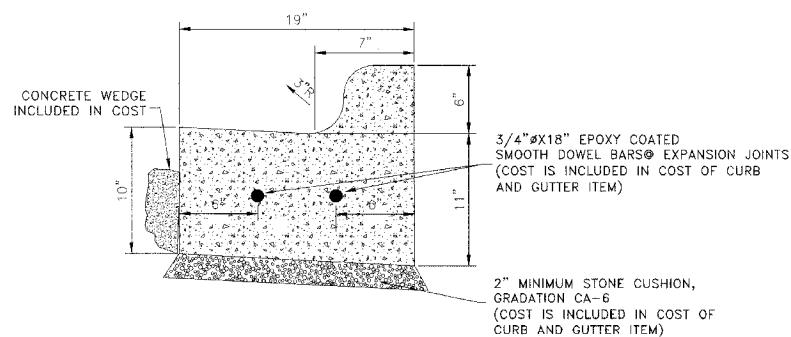

1. PROVIDE 2 3/4" Ø EPOXY COATED SMOOTH BARS WITH PLASTIC EXPANSION CAPS AT EACH EXPANSION JOINT.
2. CONTRACTION JOINTS SHALL BE PLACED AT EQUAL SPACES BETWEEN NORMAL EXPANSION JOINTS. CONTRACTION JOINTS SHALL BE SAW CUT IN THE UPPER 1/3 OF CURB AND GUTTERS WITHIN 24 HOURS OF PLACEMENT.

COMBINATION CONCRETE CURB & GUTTER TYPE B-6.12 (MODIFIED)

- M.W.R.D.G.C. GENERAL NOTES**
1. THE MWRD SEWER SYSTEMS SECTION FIELD OFFICE MUST BE NOTIFIED AT LEAST TWO (2) WORKING DAYS PRIOR TO THE COMMENCEMENT OF WORK AT (708) 588-4055.
 2. ELEVATION DATUM IS U.S.G.S.
 3. ALL FLOOR DRAINS SHALL DISCHARGE TO THE SANITARY SEWER SYSTEM.
 4. ALL DOWNSPOUTS AND FOOTING DRAINS SHALL DISCHARGE INTO THE STORM SEWER SYSTEM.
 5. ALL PVC STORM SEWER PIPE JOINTS SHALL CONFORM TO ASTM D-3139. ALL PVC SEWER PIPE 12" IN DIAMETER OR LESS SHALL CONFORM TO ASTM D-2241 (WATER QUALITY PIPE). ALL PVC SEWER PIPE SHALL BE SDR 26.
 6. ALL SANITARY SEWER CONSTRUCTION, AND ALSO STORM SEWER CONSTRUCTION IN COMBINED SEWER AREAS, REQUIRES STONE BEDDING 1/4" TO 1" IN SIZE, WITH A MINIMUM THICKNESS EQUAL TO 1/4 THE OUTSIDE DIAMETER OF THE SEWER PIPE, BUT NOT LESS THAN FOUR INCHES (4") NOR MORE THAN EIGHT INCHES (8"). MATERIAL SHALL BE CA-11 OR CA-13 AND SHALL BE EXTENDED AT LEAST 12" ABOVE THE TOP OF THE PIPE WHEN USING PVC PIPE.
 7. "BAND SEAL" OR SIMILAR FLEXIBLE-TYPE COUPLINGS SHALL BE USED IN THE CONNECTION OF SEWER PIPE OF DISSIMILAR MATERIALS.
 8. WHEN CONNECTING TO AN EXISTING SEWER MAIN BY MEANS OTHER THAN AN EXISTING WYE, TEE, OR AN EXISTING MANHOLE, ONE OF THE FOLLOWING METHODS SHALL BE USED:
 - 1) CIRCULAR SAW-CUT OF SEWER MAIN BY MECHANICAL CORING MACHINE, AND PROPER INSTALLATION OF HUB-WYE SADDLE OR HUB-TEE SADDLE, IN ACCORDANCE WITH THE MANUFACTURER'S RECOMMENDATIONS.
 - 2) REMOVE AN ENTIRE SECTION OF PIPE (BREAKING ONLY THE TOP OF ONE BELL) AND REPLACE WITH A WYE OR TEE BRANCH SECTION. AFTER THE WYE OR TEE BRANCH IS INSERTED, CONCRETE SHALL BE PLACED OVER THE BROKEN AREA TO A MINIMUM THICKNESS OF 4" AND TO A DIMENSION OF 8" IN ALL DIRECTIONS.
 - 3) USING PIPE CUTTER, NEATLY AND ACCURATELY CUT OUT DESIRED LENGTH OF PIPE FOR INSERTION OF PROPER FITTING. USE "BAND SEAL" OR SIMILAR COUPLINGS TO HOLD FIRMLY IN PLACE. FOLLOW MANUFACTURER'S RECOMMENDATIONS FOR THE INSTALLATION.
 9. WHEREVER A SANITARY/COMBINED SEWER CROSSES UNDER A WATER MAIN, THE MINIMUM VERTICAL DISTANCE FROM THE TOP OF THE SEWER TO THE BOTTOM OF THE WATER MAIN SHALL BE 18 INCHES. FURTHERMORE, A MINIMUM HORIZONTAL DISTANCE OF 10 FEET BETWEEN SANITARY/COMBINED SEWERS AND WATER MAINS SHALL BE MAINTAINED UNLESS THE SEWER IS LAID IN A SEPARATE TRENCH, KEEPING A MINIMUM 18" VERTICAL SEPARATION; OR THE SEWER IS LAID IN THE SAME TRENCH WITH THE WATER MAIN LOCATED AT THE OPPOSITE SIDE ON A BENCH OF UNDISTURBED EARTH, KEEPING A MINIMUM 18" VERTICAL SEPARATION. IF EITHER THE VERTICAL OR HORIZONTAL DISTANCES DESCRIBED ABOVE CANNOT BE MAINTAINED, OR THE SEWER CROSSES ABOVE THE WATER MAIN, THE SEWER SHALL BE CONSTRUCTED TO WATER MAIN STANDARDS.
 10. ALL SANITARY MANHOLES, (AND STORM MANHOLES IN COMBINED SEWER AREAS), SHALL HAVE A MINIMUM INSIDE DIAMETER OF 48 INCHES, AND SHALL BE CAST IN PLACE OR PRE-CAST REINFORCED CONCRETE.
 11. ALL ABANDONED SEWERS SHALL BE PLUGGED AT BOTH ENDS WITH A MINIMUM OF TWO (2) FEET LONG NON-SHRINK CONCRETE/MORTAR PLUG.
 12. ALL INLET AND OUTLET PIPES OF SANITARY SEWER MANHOLES AND OTHER UNDERGROUND STRUCTURES (AND IN COMBINED SEWER AREAS, ALSO ALL COMBINED/STORM SEWER MANHOLES, CATCH BASINS, INLETS, AND UNDERGROUND DETENTION STORAGE STRUCTURES) SHALL BE JOINED WITH WATERTIGHT FLEXIBLE RUBBER CONNECTORS CONFORMING TO A.S.T.M. C-443 & C-923 WITH STAINLESS STEEL BANDS.
 13. THE MAXIMUM ALLOWABLE INFILTRATION OR EX-FILTRATION IS 100 GAL/DAY/MILE/INCH DIA OF THE SEWER PIPE.

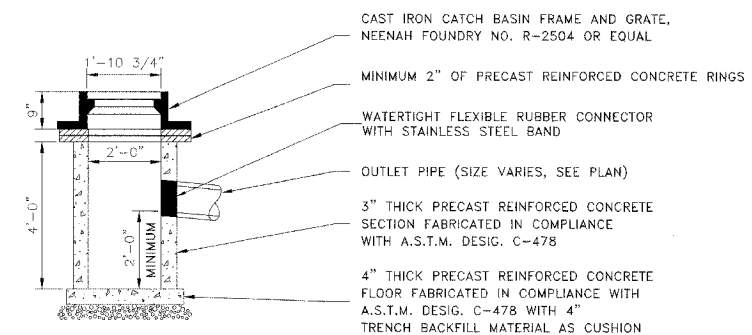

CATCH BASIN, TYPE C

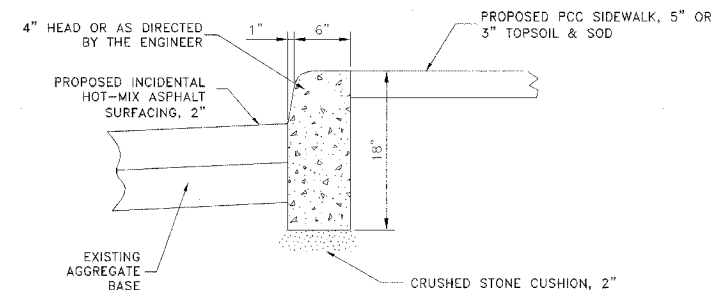

BARRIER CURB DETAIL

SUMMARY OF QUANTITIES				
CODE	PAY ITEM	UNIT	TOTAL QUANTITY	1000 - 2A 80% FEDERAL 20% LOCAL
20200100	Earth Excavation	CuYd	18	18
* 21101610	Topsoil Furnish and Place, 3"	SqYd	310	310
* 25000400	Nitrogen Fertilizer Nutrient	Pound	10	10
* 25000500	Phosphorus Fertilizer Nutrient	Pound	10	10
* 25000600	Potassium Fertilizer Nutrient	Pound	10	10
* 25200100	Sodding	SqYd	310	310
40300100	Bituminous Materials (Prime Coat)	Gal	600	600
40600300	Aggregate (Prime Coat)	Ton	12	12
40600625	Leveling Binder (Machine Method), N50, 3/4"	Ton	225	225
40600982	Hot-Mix Asphalt Surface Removal - Butt Joint	SqYd	100	100
40603335	Hot-Mix Asphalt Surface Course, Mix D, N50	Ton	480	480
40800050	Incidental Hot-Mix Asphalt Surfacing	Ton	32	32
42000300	Portland Cement Concrete Pavement, 8"	SqYd	55	55
42400200	Portland Cement Concrete Sidewalk, 5"	SqFt	1700	1700
42400800	Detectable Warnings	SqFt	220	220
44000100	Pavement Removal	SqYd	250	250
44000158	Hot-Mix Asphalt Surface Removal, 2 1/4"	SqYd	5600	5600
44000600	Sidewalk Removal	SqFt	1700	1700
44001900	Combination Curb & Gutter Removal (Special)	Foot	365	365
44002000	Concrete Curb Removal	Foot	50	50
44201329	Class C Patches, Type II, 8"	SqYd	60	60
48301000	Protective Coat	SqYd	335	335
56500600	Domestic Water Service Boxes to be Adjusted	Each	2	2
60213800	Restricted Depth Catch Basins, 4' Diameter, Type 1 Frame, Open Lid	Each	2	2
60234200	Inlets, Type A, Type 1 Frame, Open Lid	Each	1	1
60252800	Catch Basins to be Reconstructed	Each	5	5
60300305	Frames and Lids to be Adjusted	Each	20	20
60406000	Frames and Lids, Type 1, Open Lid	Each	1	1
60406100	Frames and Lids, Type 1, Closed Lid	Each	1	1
60600605	Concrete Curb, Type B	Foot	50	50
60604100	Combination Concrete Curb & Gutter, Type B-6.12(Modified)	Foot	365	365
67100100	Mobilization	LumpSum	1	1
70101800	Traffic Control & Protection (Special)	LumpSum	1	1
* 78000100	Thermoplastic Pavement Marking - Letters & Symbols	SqFt	10	10
* 78000200	Thermoplastic Pavement Marking - Line, 4"	Foot	275	275
* 78000400	Thermoplastic Pavement Marking - Line, 6"	Foot	270	270
* 78000650	Thermoplastic Pavement Marking - Line, 24"	Foot	110	110

* DENOTES SPECIALITY ITEM

LEGEND OF SYMBOLS

SYMBOL	DESCRIPTION
	COMBINATION CONCRETE CURB & GUTTER, TYPE B-6.12
	PORTLAND CEMENT CONCRETE SIDEWALK, 5"
	EXISTING AGGREGATE SUB-BASE
	EXISTING LEVELING BINDER COURSE
	EXISTING CONCRETE BASE, 8"
	PROPOSED HOT-MIX ASPHALT SURFACE REMOVAL, 2-1/4"
	PROPOSED LEVELING BINDER (MACHINE METHOD), N50, 3/4" MINIMUM AND 1" MAXIMUM
	PROPOSED HOT-MIX ASPHALT SURFACE COURSE, MIX D, N50, 1-1/2"
	EXISTING HOT-MIX ASPHALT SURFACE COURSE, MIXTURE D, 1-1/2"
	EXISTING BARRIER CURB
	PROPOSED INCIDENTAL HOT-MIX ASPHALT SURFACING, 2"
	EXISTING AGGREGATE BASE

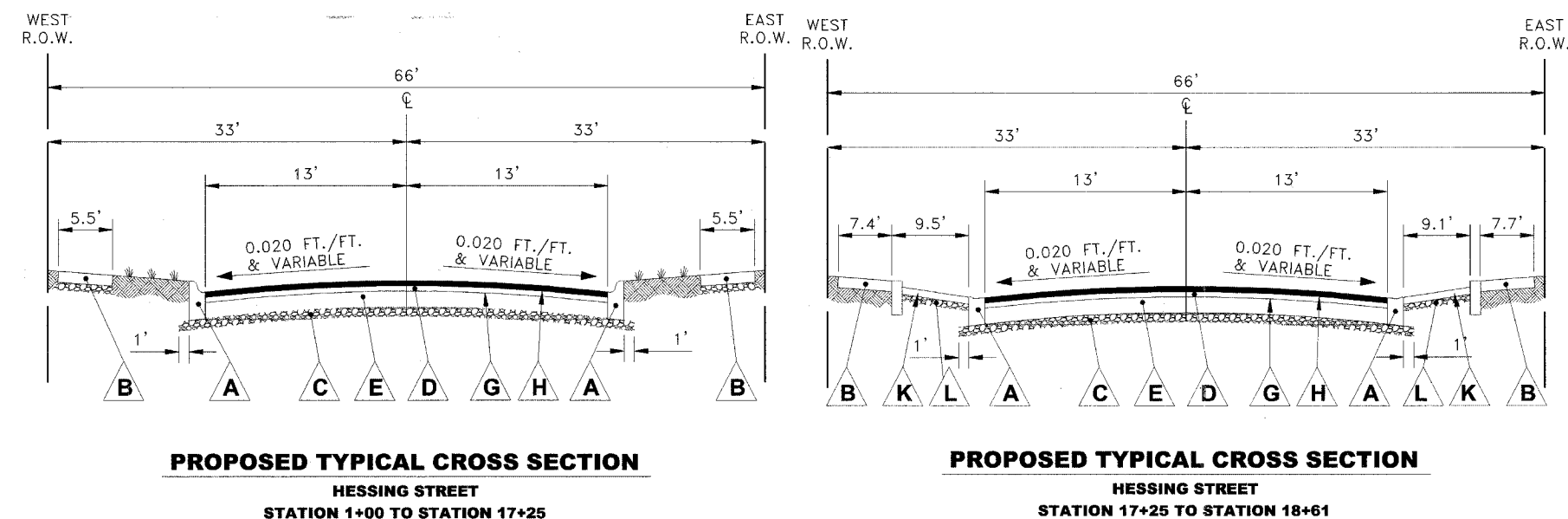
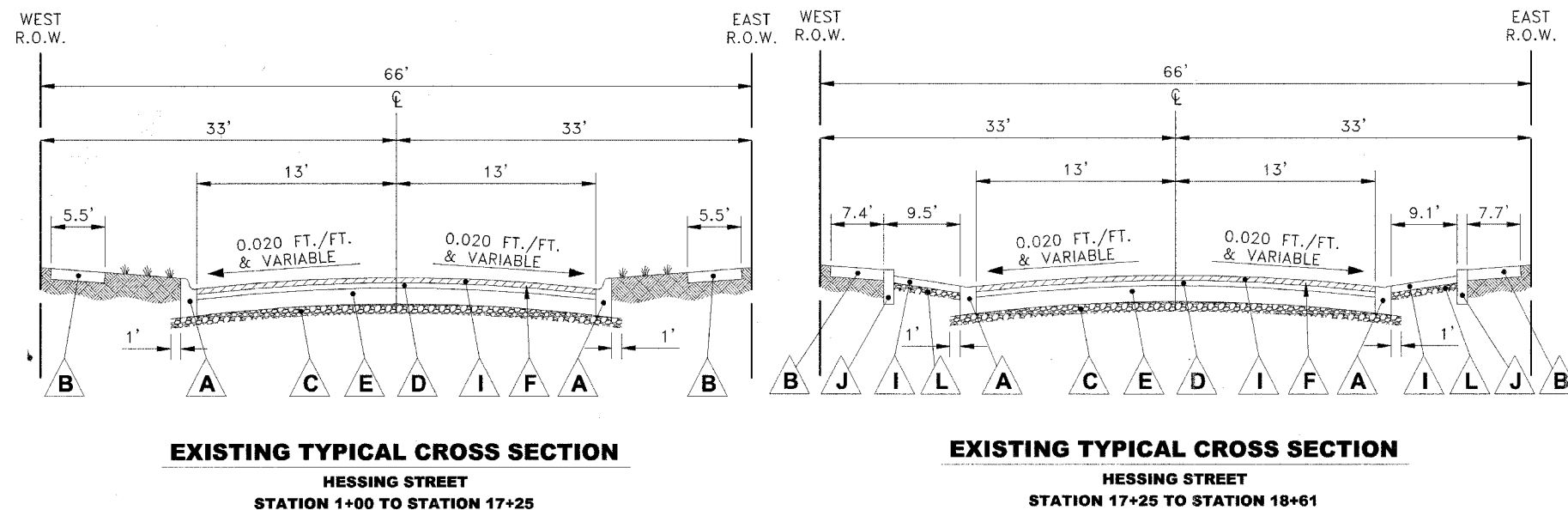

HOT-MIX ASPHALT MIXTURE REQUIREMENTS

ITEM	A C TYPE	VOIDS
HOT-MIX ASPHALT SURFACE COURSE, MIX D, N50, IL-9.5mm*	PG 64-22	4% @ 50 GYR.
LEVELING BINDER (MACHINE METHOD) N50, IL-9.5mm*	PG 64-22/58-22	4% @ 50 GYR.
INCIDENTAL HOT-MIX ASPHALT SURFACING, HOT-MIX ASPHALT SURFACE COURSE, MIX D N50, IL-9.5mm*	PG 64-22	4% @ 50 GYR.

* THE UNIT WEIGHT USED TO CALCULATE ALL HOT-MIX ASPHALT SURFACE MIXTURES IS 112 LBS/SQYD/IN.
* WHEN RAP EXCEEDS 20%, THE NEW ASPHALT BINDER IN THE MIX SHALL BE PG 58-22

Drawing file: w:\Projects\7600\004 - 2007 St. Resurf. HPP\typicals.dwg Apr 12, 2007 - 3:55pm

ROUTE NO.	SECTION	COUNTY	TOTAL SHEETS	SHEET NO.
FAU	**	COOK	11	6
ILLINOIS PROJECT		HPP-4065(003)		
VILLAGE SECTION		07-00088-00-FP		
CONTRACT NO.		83939		

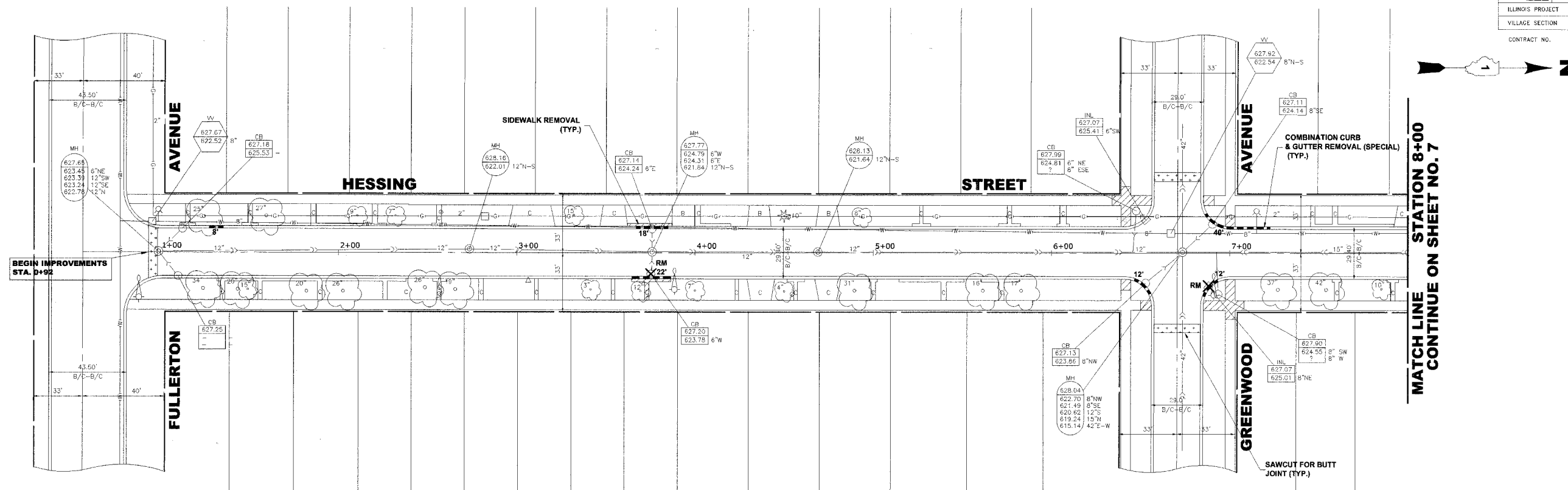

**EXISTING
TOPOGRAPHY**

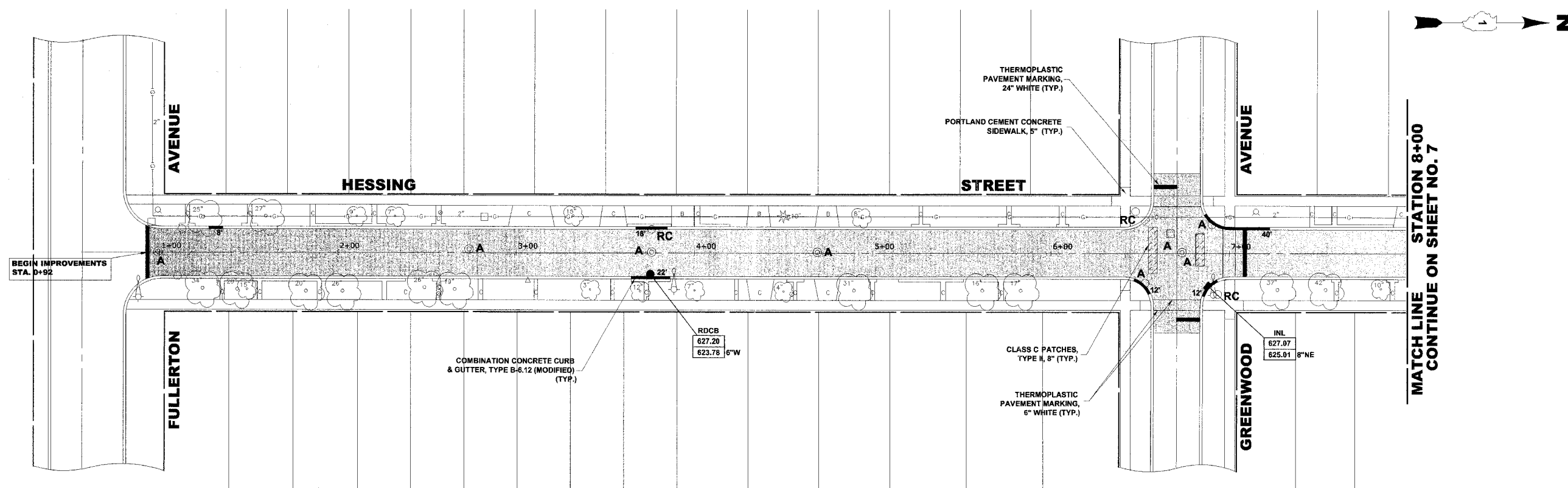

**PROPOSED
IMPROVEMENTS**



◆ Civil Engineers
◆ Municipal Consultants
◆ Established 1911

9933 Roosevelt Road
Westchester, Illinois 60154-2780
Phone: 708/865-0300
Fax: 708/865-1212

**2007 STREET RESURFACING PROJECT
VILLAGE OF RIVER GROVE, ILLINOIS**

**HESSING STREET
PAVING PLAN**

REVISION:

SCALE: 1"=30'H.
DRAWN BY: MK
BOOK NO.: 1505
DATE: 04/09/07
E.H.E. NO.: 760-07-00401

SHEET
6
11
CF

ROUTE NO.	SECTION	COUNTY	TOTAL SHEETS	SHEET NO.
FAU	**	COOK	11	7
ILLINOIS PROJECT HPP-4065(003)				
VILLAGE SECTION 07-00088-00-FP				
CONTRACT NO.			83939	

CONTINUED FROM SHEET NO. 6
MATCH LINE STATION 8+00

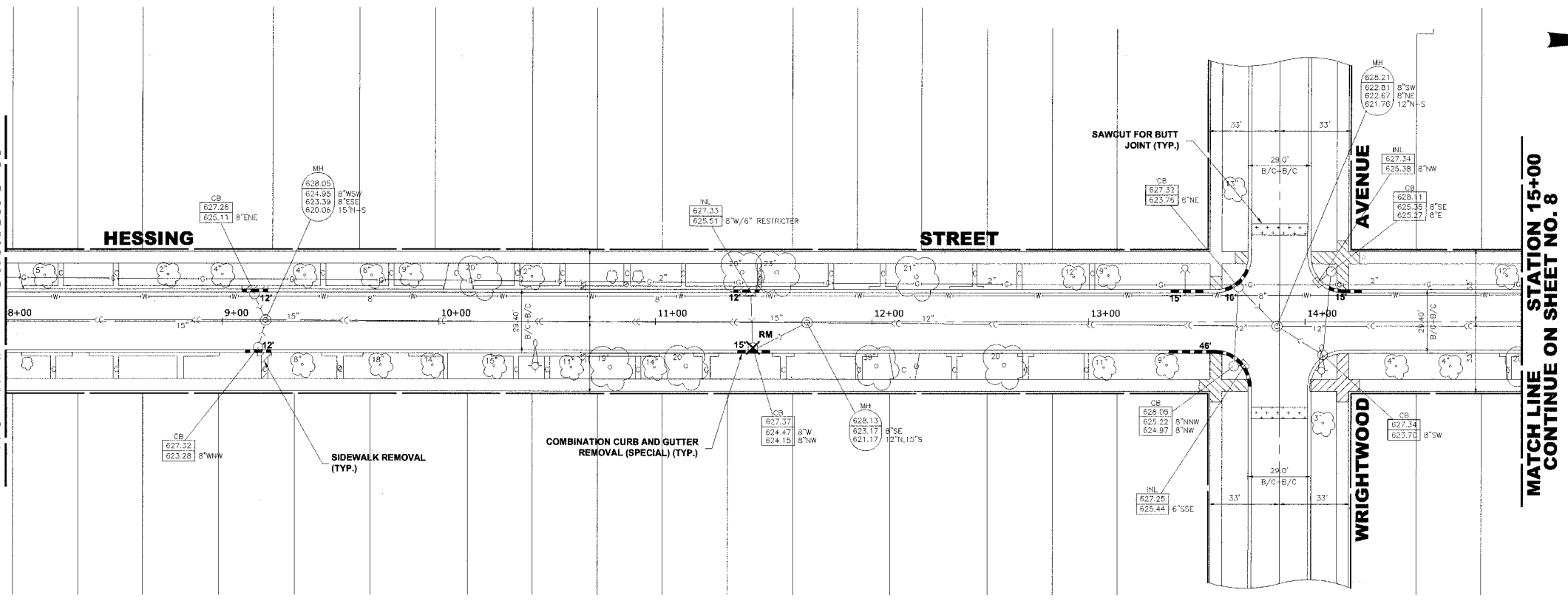

EXISTING
TOPOGRAPHY

CONTINUED FROM SHEET NO. 6
MATCH LINE STATION 8+00

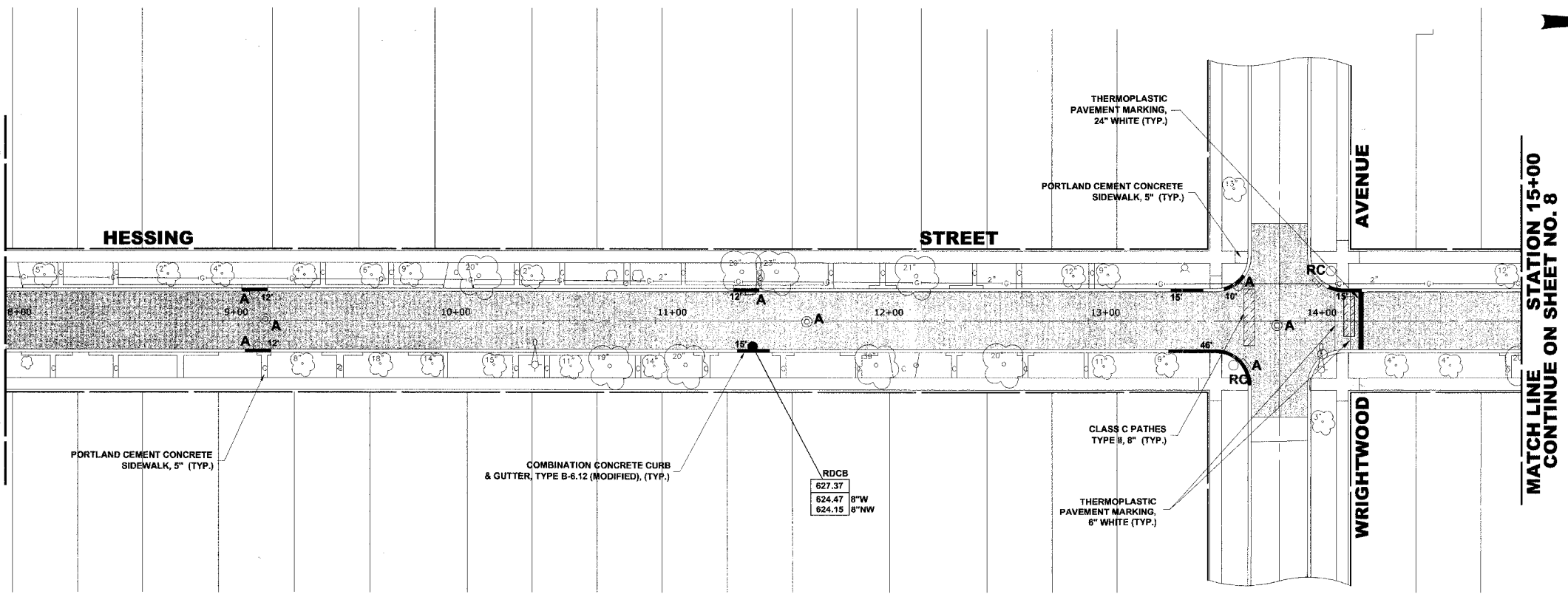

PROPOSED
IMPROVEMENTS



◆ Civil Engineers
◆ Municipal Consultants
◆ Established 1911

9933 Roosevelt Road
Westchester, Illinois 60154-2780
Phone: 708/865-0300
Fax: 708/865-1212

2007 STREET RESURFACING PROJECT
VILLAGE OF RIVER GROVE, ILLINOIS

HESSING STREET
PAVING PLAN

REVISION:	SCALE: 1"=30'H.	SHEET 7 / 11
	DRAWN BY: MK	
	BOOK NO.: 1505	
	DATE: 04/09/07	
E.H.E. NO.: 760-07-00401		OF

Drawing file: W:\Projects\76007004 - 2007 St. Repair\HP\Hessing\Hessing.dwg Apr 11, 2007 - 3:57pm

ROUTE NO.	SECTION	COUNTY	TOTAL SHEETS	SHEET NO.
FAU	**	COOK	11	8
ILLINOIS PROJECT HPP-4065(003)				
VILLAGE SECTION 07-00088-00-FP				
CONTRACT NO. 83939				

CONTINUED FROM SHEET NO. 6
MATCH LINE STATION 15+00

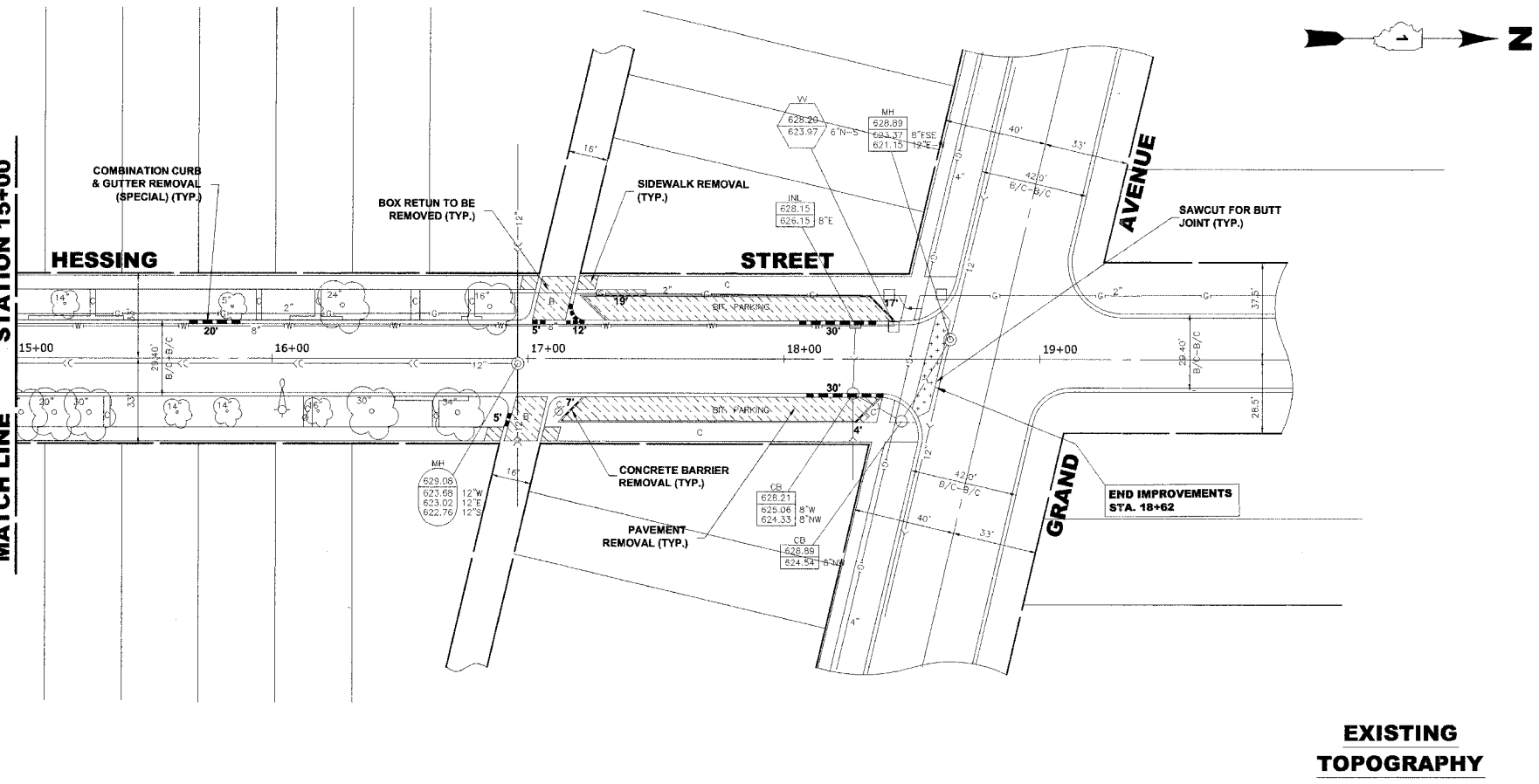

CONTINUED FROM SHEET NO. 7
MATCH LINE STATION 15+00

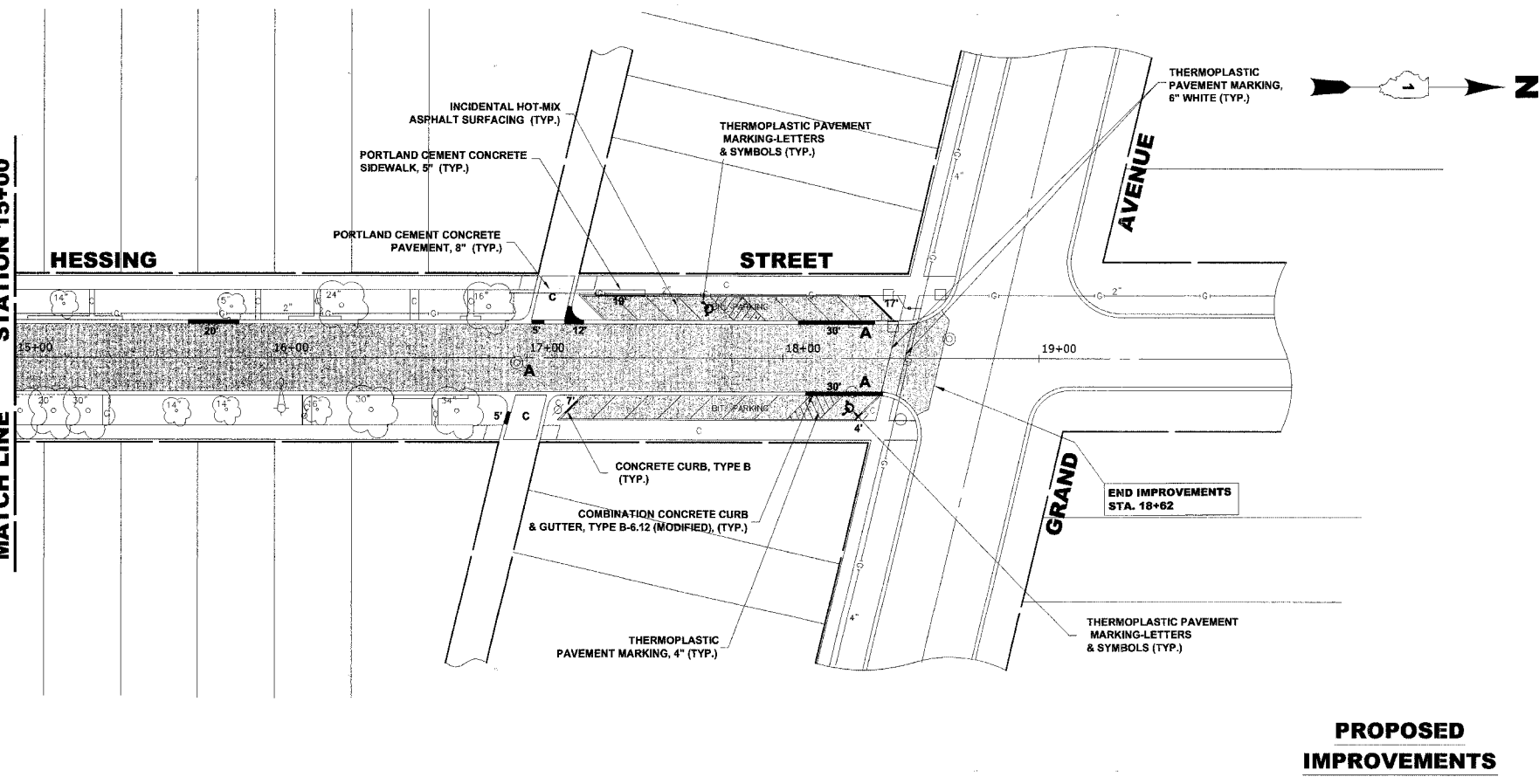

Drawing File: W:\Projects\76007004 - 2007 St. Resurf H\Hessing.dwg Apr 11, 2007 - 3:37pm



◆ Civil Engineers
◆ Municipal Consultants
◆ Established 1911

9933 Roosevelt Road
Westchester, Illinois 60154-2780
Phone: 708/865-0300
Fax: 708/865-1212

**2007 STREET RESURFACING PROJECT
VILLAGE OF RIVER GROVE, ILLINOIS**

**HESSING STREET
PAVING PLAN**

REVISION:

SCALE:	1"=30'H.
DRAWN BY:	MK
BOOK NO.:	1505
DATE:	04/09/07
E.H.E. NO.:	760-07-00401

SHEET
8
OF
11

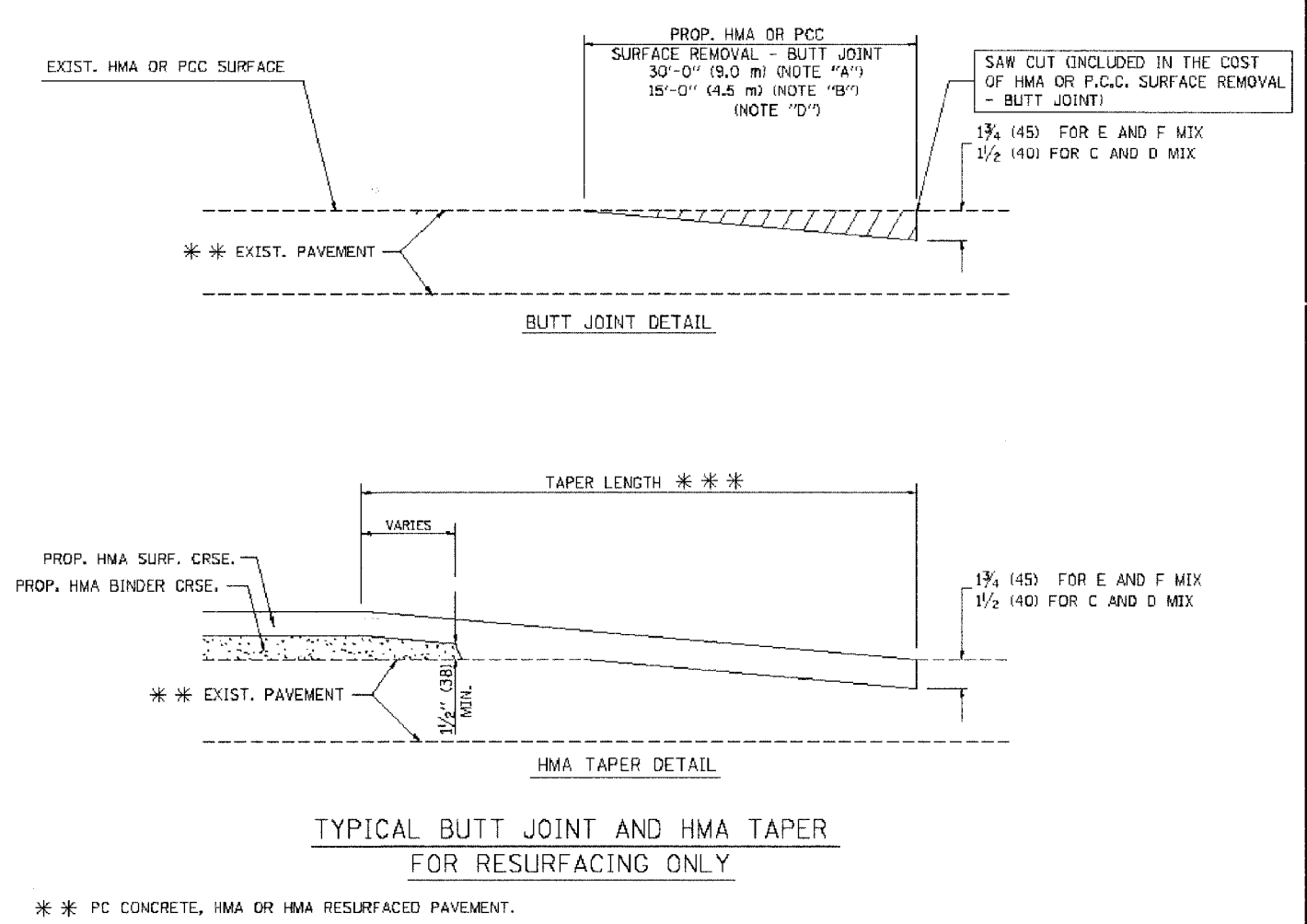
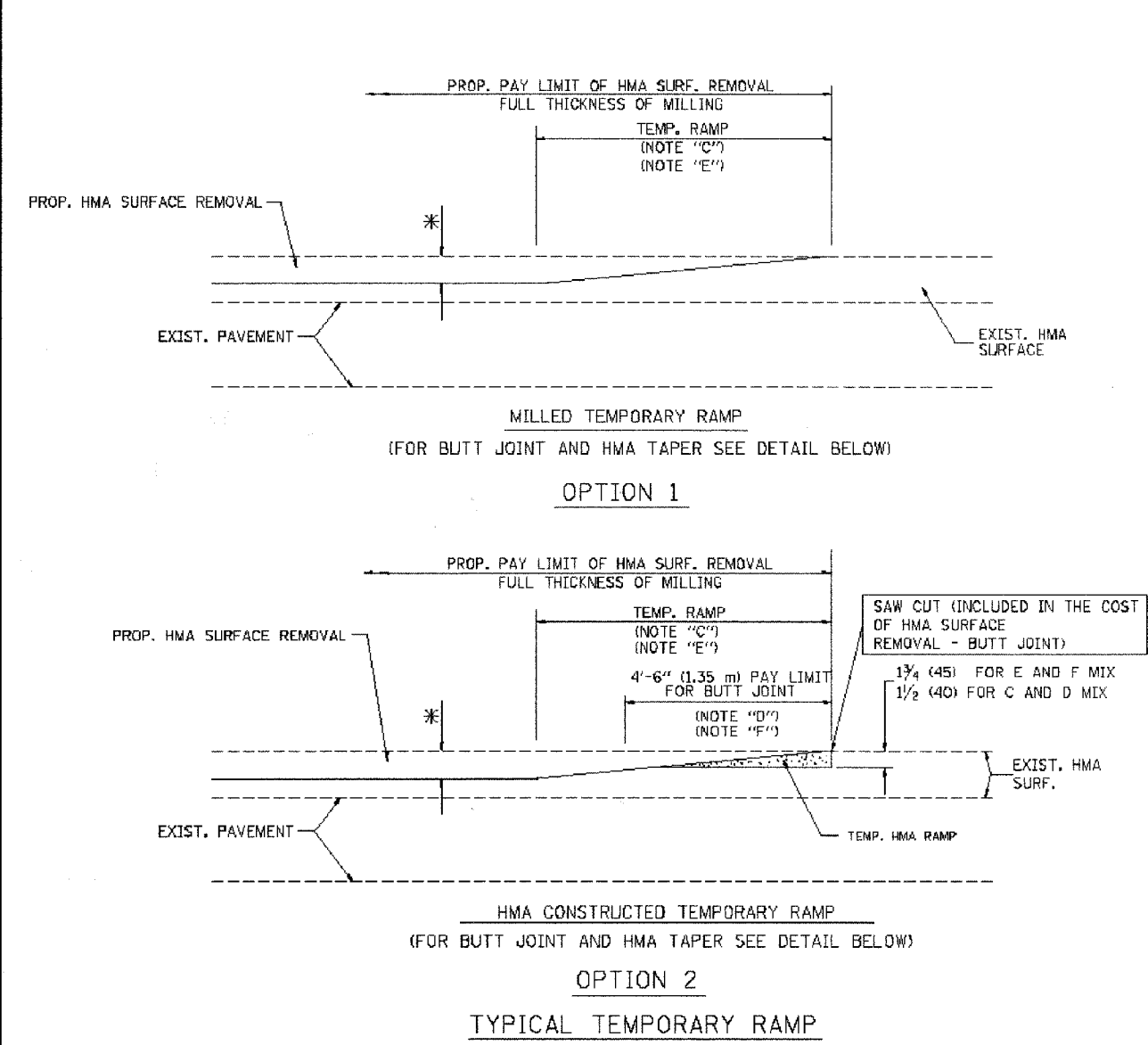

TYPICAL BUTT JOINT AND HMA TAPER
FOR RESURFACING ONLY

*** PC CONCRETE, HMA OR HMA RESURFACED PAVEMENT.

NOTES

- A: MAINLINE ROADWAYS AND MAJOR SIDE ROADS.
- B: MINOR SIDE ROADS.
- C: THE TEMP. RAMP SHALL BE CONSTRUCTED IMMEDIATELY UPON REMOVAL OF THE EXISTING HMA SURFACE.
- D: THE BUTT JOINT SHALL BE CONSTRUCTED IMMEDIATELY PRIOR TO PLACING THE PROPOSED HMA COURSES.
- E: TAPER THE TEMP. RAMP AT A RATE OF 3'-0" (900 mm) PER 1 INCH (25 mm) OF MILLING THICKNESS.
- F: INSTALLATION AND REMOVAL OF THE 4'-6" (1.35 m) TEMP. RAMP IS INCLUDED IN COST OF HMA SURFACE REMOVAL - BUTT JOINT
- G: SEE ARTICLE 406.08 AND 406.14 OF THE STANDARD SPECIFICATIONS FOR "HMA AND/OR PCC SURFACE REMOVAL, BUTT JOINT".
- * SEE TYPICAL SECTIONS FOR MILLING THICKNESS.
- *** 20'-0" (6.1 m) PER 1 (25) RESURFACING (NOTE "A")
10'-0" (3.0 m) PER 1 (25) RESURFACING (NOTE "B")

ALL DIMENSIONS ARE IN INCHES (MILLIMETERS) UNLESS OTHERWISE SHOWN.

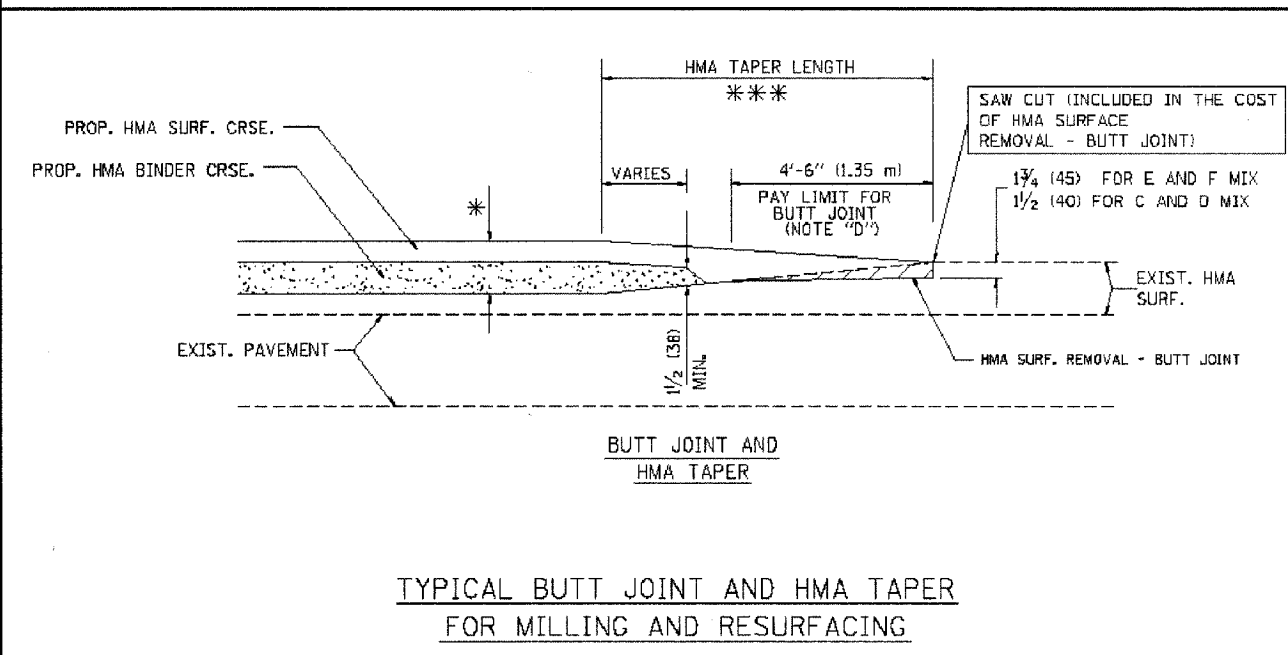

TYPICAL BUTT JOINT AND HMA TAPER
FOR MILLING AND RESURFACING

BASIS OF PAYMENT:

THE BUTT JOINT WILL BE PAID FOR AT THE CONTRACT UNIT PRICE PER SQUARE YARD (SQUARE METER) FOR "HOT-MIX ASPHALT SURFACE REMOVAL - BUTT JOINT" OR FOR "PORTLAND CEMENT CONCRETE SURFACE REMOVAL - BUTT JOINT".

REVISIONS	
NAME	DATE
M. DE YONG	6-13-90
M. DE YONG	7-3-90
M. DE YONG	3-27-92
R. SHAH	09/09/94
R. SHAH	10/25/94
A. ABBAS	03/21/97
M. GOMEZ	04/06/01
R. BORD	01/01/07

ILLINOIS DEPARTMENT OF TRANSPORTATION

BUTT JOINT AND
HMA TAPER
DETAILS

SCALE: VERT. NONE
HORIZ.

DRAWN BY
CHECKED BY

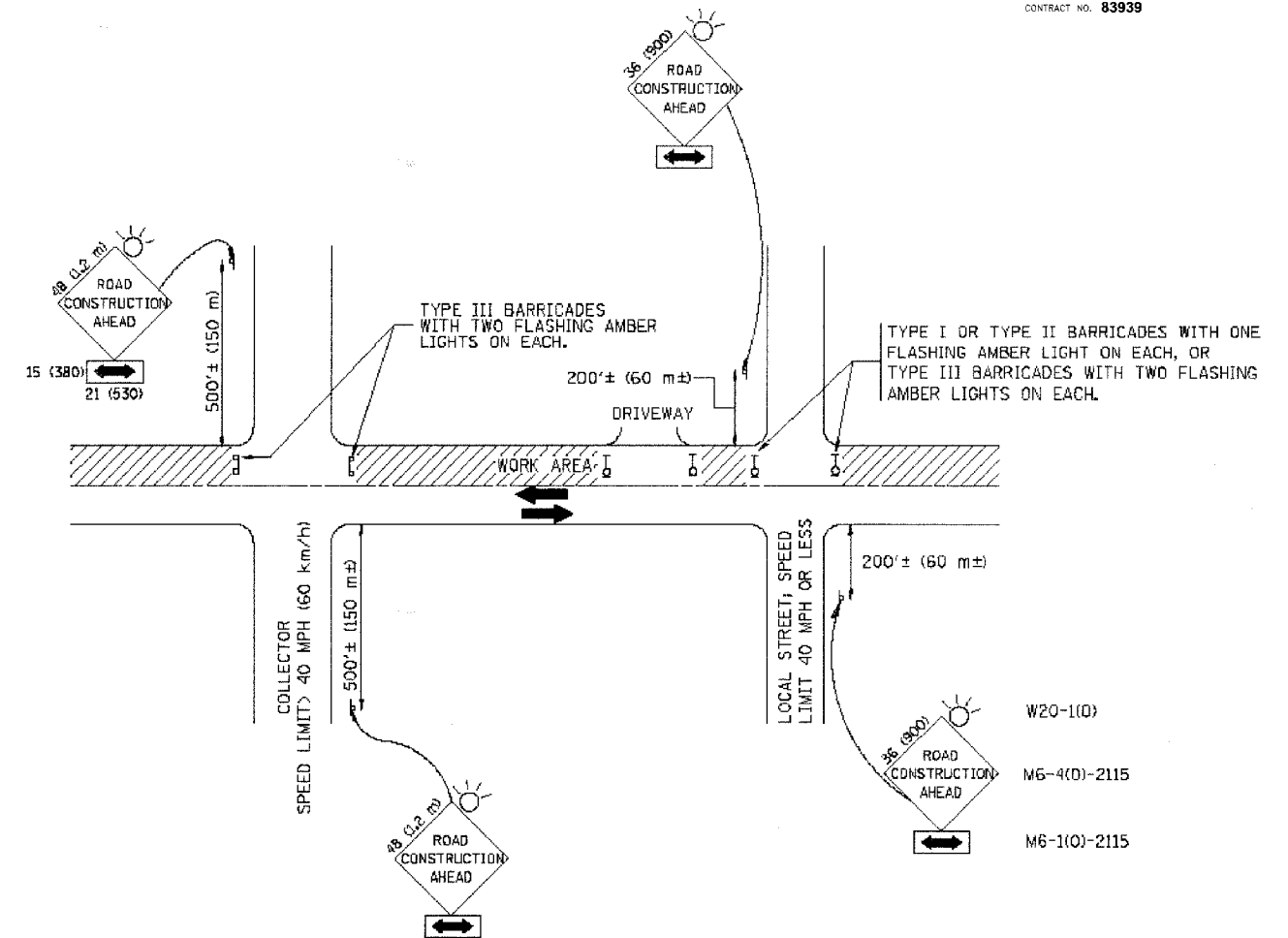

TRAFFIC CONTROL AND PROTECTION FOR SIDE ROADS, INTERSECTIONS, AND DRIVEWAYS

NOTES:

A. FOR NO LANE RESTRICTION ON THE SIDE ROAD OR DRIVEWAYS

1. SIDE ROAD WITH A SPEED LIMIT OF 40 MPH (60 km/h) OR LESS AS SHOWN ON THE DRAWING AND AS DIRECTED BY THE ENGINEER:

a) ONE **ROAD CONSTRUCTION AHEAD** SIGN 36 x 36 (900x900) WITH A FLASHER AND FLAG MOUNTED ON IT APPROXIMATELY 200' (60 m) IN ADVANCE OF THE MAIN ROUTE.

b) THE CLOSED PORTION OF THE MAIN ROUTE SHALL BE PROTECTED BY BLOCKING WITH TYPE I, TYPE II OR TYPE III BARRICADES, 1/3 OF THE CROSS SECTION OF THE CLOSED PORTION.

2. SIDE ROAD WITH A SPEED LIMIT GREATER THAN 40 MPH (60 km/h) AS SHOWN ON THE DRAWING AND AS DIRECTED BY THE ENGINEER:

a) ONE **ROAD CONSTRUCTION AHEAD** SIGN 48 x 48 (1.2 m x 1.2 m) WITH A FLASHER MOUNTED ON IT APPROXIMATELY 500' (150 m) IN ADVANCE OF THE MAIN ROUTE.

b) THE CLOSED PORTION OF THE MAIN ROUTE SHALL BE PROTECTED BY BLOCKING WITH TYPE III BARRICADES, 1/2 OF THE CROSS SECTION OF THE CLOSED PORTION.

3. WHEN THE SIDE ROAD LIES BETWEEN THE BEGINNING OF THE MAINLINE SIGNING AND THE WORK ZONE, A SINGLE HEADED ARROW (M6-1) SHALL BE USED IN LIEU OF THE DOUBLE HEADED ARROW (M6-4).

B. FOR A LANE CLOSURE ON A SIDE ROAD OR DRIVEWAY:

USE APPLICABLE PORTIONS OF THE TYPICAL APPLICATION OF TRAFFIC CONTROL DEVICES (STD. 701501, STD. 701606 OR THE APPROPRIATE STANDARD). THE SPACING OF SIGNS AND BARRICADES SHALL BE ADJUSTED FOR FIELD CONDITIONS AS DIRECTED BY THE ENGINEER. THE DIRECTIONAL ARROW SHALL BE COVERED OR REMOVED WHEN NO LONGER CONSISTENT WITH THE SIDE ROAD LANE CLOSURE.

C. ADVANCE WARNING SIGNS ARE TO BE OMITTED ON DRIVEWAY UNLESS OTHERWISE NOTED.

D. THE TRAFFIC CONTROL AND PROTECTION FOR SIDE ROADS, INTERSECTIONS, AND DRIVEWAYS SHALL BE INCIDENTAL TO THE COST OF SPECIFIED TRAFFIC CONTROL STANDARDS OR ITEMS.

All dimensions are in millimeters (inches) unless otherwise shown.

REVISIONS	
NAME	DATE
LHA	5/89
T. RAMMACHER	09/08/94
J. OBERLE	10/18/95
A. HOUSEH	03/06/96
A. HOUSEH	10/15/96
T. RAMMACHER	01/06/00

ILLINOIS DEPARTMENT OF TRANSPORTATION
TRAFFIC CONTROL AND PROTECTION
FOR
SIDE ROADS, INTERSECTIONS, AND
DRIVEWAYS

SCALE: NONE

DRAWN BY

CHECKED BY

TC10

E.H.E. PROJECT NO. 760-07-00420

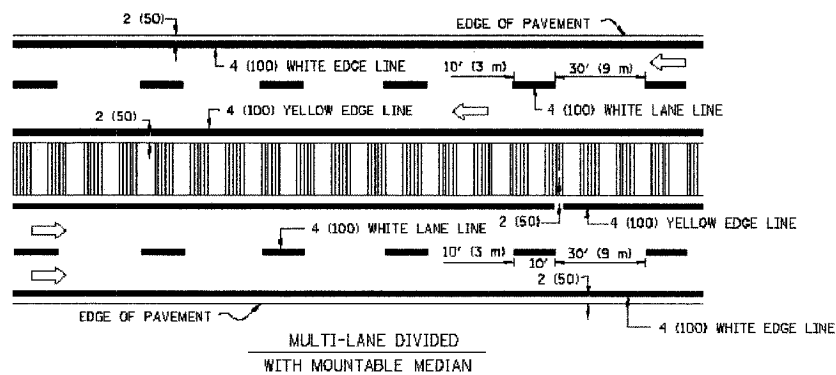
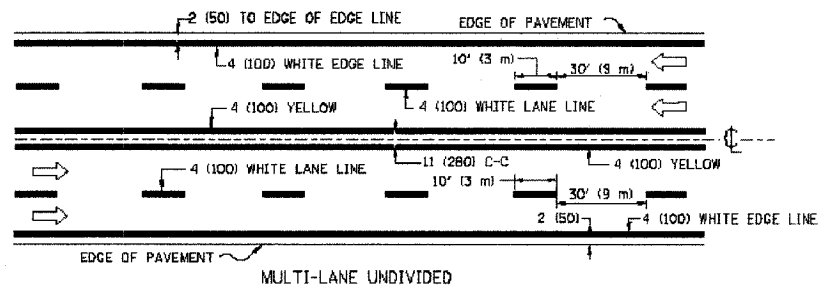
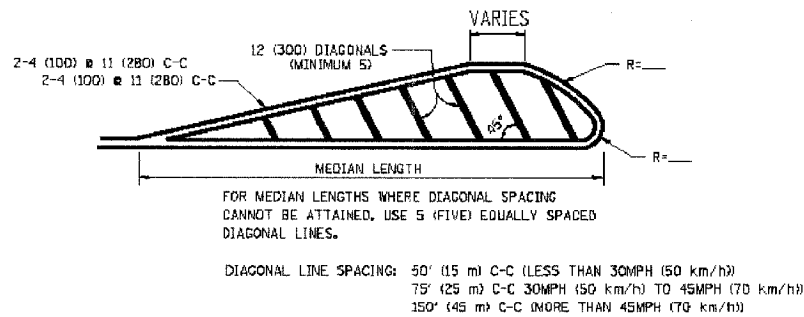
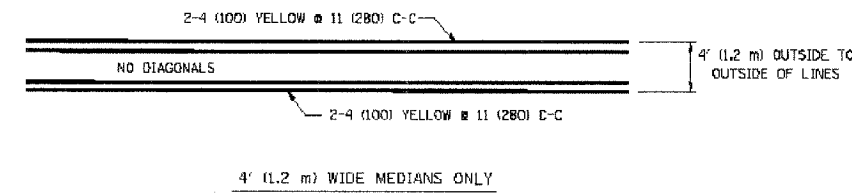
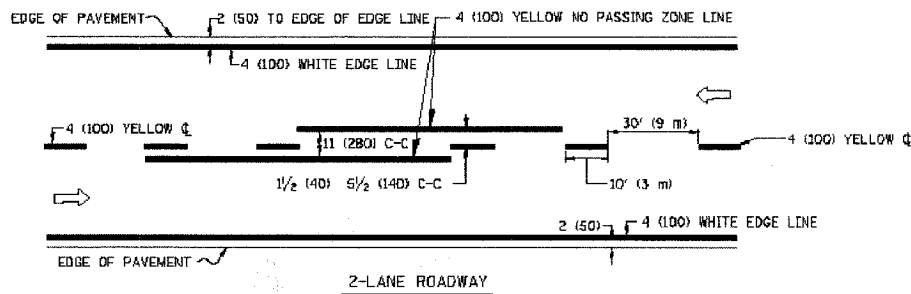

TYPICAL LANE AND EDGE LINE MARKING

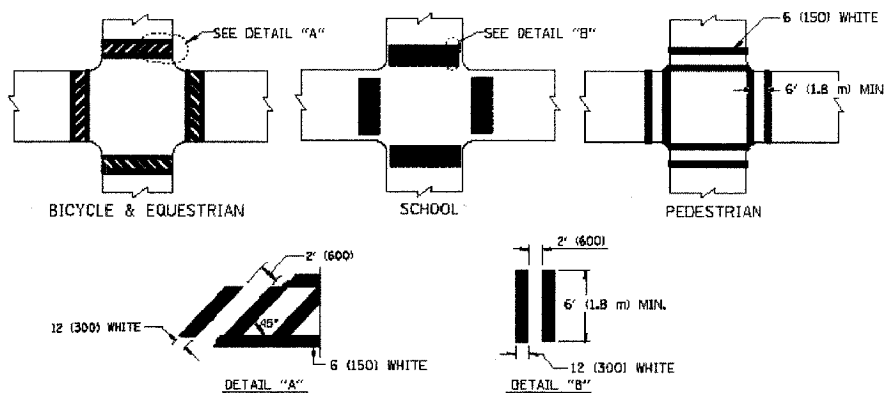

TYPICAL CROSSWALK MARKING

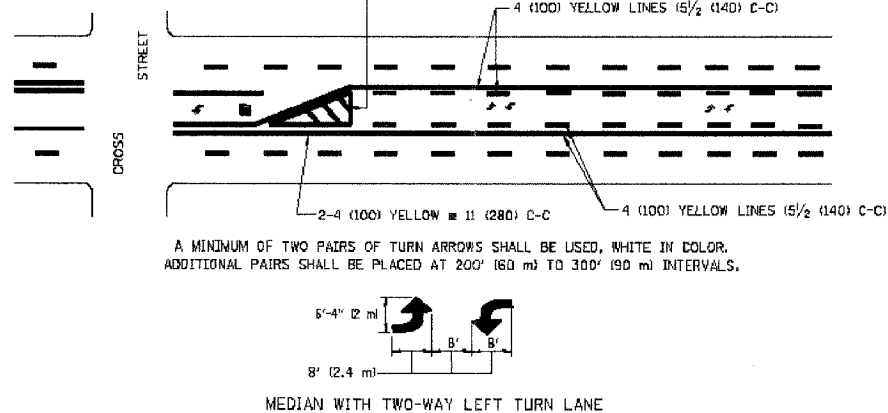

TYPICAL PAINTED MEDIAN MARKING

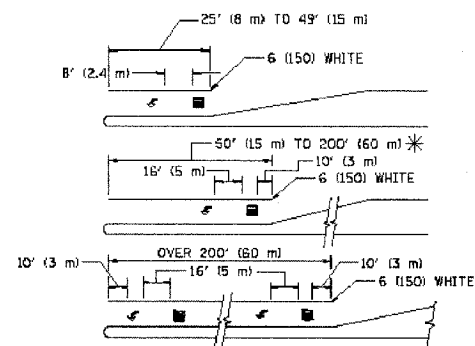

FULL SIZE LETTERS 8' (2.4 m) AND ARROWS SHALL BE USED.
AREA = 15.6 SQ. FT. (1.5 m²) AREA = 20.8 SQ. FT. (1.9 m²)

* TURN LANES IN EXCESS OF 400' (120 m) IN LENGTH MAY HAVE AN ADDITIONAL SET OF ARROW - "ONLY" INSTALLED MIDWAY BETWEEN THE OTHER TWO SETS OF ARROW - "ONLY".

TYPICAL LEFT (OR RIGHT) TURN LANE

TYPICAL TURN LANE MARKING

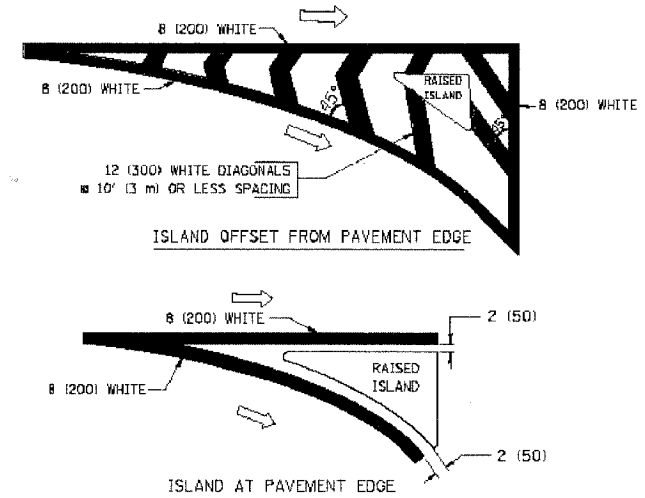

TYPICAL ISLAND MARKING

TYPE OF MARKING	WIDTH OF LINE	PATTERN	COLOR	SPACING / REMARKS
CENTERLINE ON 2 LANE PAVEMENT	4 (100)	SKIP-DASH	YELLOW	10' (3 m) LINE WITH 30' (9 m) SPACE
CENTERLINE ON MULTI-LANE UNDIVIDED PAVEMENT	2 4 (100)	SOLID	YELLOW	11 (280) C-C
NO PASSING ZONE LINES FOR ONE DIRECTION FOR BOTH DIRECTIONS	4 (100) 2 4 (100)	SOLID SOLID	YELLOW YELLOW	5 1/2 (140) C-C FROM SKIP-DASH CENTERLINE 11 (280) C-C OMIT SKIP-DASH CENTERLINE BETWEEN
LANE LINES	4 (100) 5 (125) ON FREEWAYS	SKIP-DASH SKIP-DASH	WHITE WHITE	10' (3 m) LINE WITH 30' (9 m) SPACE
DOTTED LINES (EXTENSIONS OF CENTER, LANE OR TURN LANE MARKINGS)	SAME AS LINE BEING EXTENDED	SKIP-DASH	SAME AS LINE BEING EXTENDED	2' (600) LINE WITH 6' (1.8 m) SPACE
EDGE LINES	4 (100)	SOLID	YELLOW-LEFT WHITE-RIGHT	OUTLINE MOUNTABLE MEDIANS IN YELLOW; EDGE LINES ARE NOT USED NEXT TO BARRIER CURB
TURN LANE MARKINGS	6 (150) LINE; FULL SIZE LETTERS & SYMBOLS (8' (2.4 m))	SOLID	WHITE	SEE TYPICAL TURN LANE MARKING DETAIL
TWO WAY LEFT TURN MARKING	2 4 (100) EACH DIRECTION 8' (2.4 m) LEFT ARROW	SKIP-DASH AND SOLID IN PAIRS	YELLOW WHITE	10' (3 m) LINE WITH 30' (9 m) SPACE FOR SKIP-DASH 5 1/2 (140) C-C BETWEEN SOLID LINE AND SKIP-DASH LINE SEE TYPICAL TWO-WAY LEFT TURN MARKING DETAIL
CROSSWALK LINES (PEDESTRIAN) A. DIAGONALS (BIKE & EQUESTRIAN) B. LONGITUDINAL BARS (SCHOOL)	2 6 (150) 12 (300) 45° 12 (300) 90°	SOLID SOLID SOLID	WHITE WHITE WHITE	NOT LESS THAN 6' (1.8 m) APART 2' (600) APART 2' (600) APART SEE TYPICAL CROSSWALK MARKING DETAILS.
STOP LINES	24 (600)	SOLID	WHITE	PLACE 4' (1.2 m) IN ADVANCE OF AND PARALLEL TO CROSSWALK, IF PRESENT; OTHERWISE, PLACE AT DESIRED STOPPING POINT. PARALLEL TO CROSSROAD CENTERLINE, WHERE POSSIBLE
PAINTED MEDIANS	2 4 (100) WITH 12 (300) DIAGONALS 45° NO DIAGONALS USED FOR 4' (1.2 m) WIDE MEDIANS	SOLID	YELLOW: TWO WAY TRAFFIC WHITE: ONE WAY TRAFFIC	11 (280) C-C FOR THE DOUBLE LINE SEE TYPICAL PAINTED MEDIAN MARKING.
GORE MARKING AND CHANNELIZING LINES	8 (200) WITH 12 (300) DIAGONALS 45°	SOLID	WHITE	DIAGONALS: 15' (4.5 m) C-C (LESS THAN 30MPH (50 km/h)) 20' (6 m) C-C 30MPH (50 km/h) TO 45MPH (70 km/h) 30' (9 m) C-C (OVER 45MPH (70 km/h))
RAILROAD CROSSING	24 (600) TRANSVERSE LINES; "RR" 15 6' (1.8 m) LETTERS; 16 (400) LINE FOR "X"	SOLID	WHITE	SEE STATE STANDARD 780001 AREA OF: "R"=3.6 SQ. FT. (0.33 m ²) EACH "X"=5.4 SQ. FT. (0.5 m ²)
SHOULDER DIAGONALS	12 (300) 45°	SOLID	WHITE - RIGHT YELLOW - LEFT	50' (15 m) C-C (LESS THAN 30MPH (50 km/h)) 75' (25 m) C-C (30 MPH (50 km/h) TO 45MPH (70 km/h)) 150' (45 m) C-C (OVER 45MPH (70 km/h))

FOR FURTHER DETAILS ON PAVEMENT MARKING REFER TO STANDARD SPECIFICATIONS FOR ROAD AND BRIDGE CONSTRUCTION AND STATE STANDARD 780001.

All dimensions are in inches (millimeters) unless otherwise shown.

REVISIONS	
NAME	DATE
EVERS	03-19-90
T. RAMMACHER	10-27-94
ALEX HOUSEH	10-09-96
ALEX HOUSEH	10-17-96
T. RAMMACHER	01-06-00

ILLINOIS DEPARTMENT OF TRANSPORTATION
DISTRICT ONE
TYPICAL PAVEMENT
MARKINGS

SCALE: NONE

DRAWN BY CADD
CHECKED BY