

F.A.P. RTE.	SECTION	COUNTY	TOTAL SHEETS	SHEET NO.
68	(5Z)I	LASALLE	10	1

**INDEX OF SHEETS**

1. COVER SHEET
2. GENERAL NOTES
3. SUMMARY OF QUANTITIES
4. TYPICAL SECTION
5. PLAN AND PROFILE
6. PAVEMENT MARKING
7. TYPICAL PAVEMENT MARKINGS
- 8 - 10. CROSS SECTIONS

**STANDARDS**

- |           |   |
|-----------|---|
| 000001-04 | STANDARD SYMBOLS, ABBREVIATIONS AND PATTERNS                                  |
| 001006    | DECIMAL OF AN INCH AND OF A FOOT  |
| 701001-01 | OFF-ROAD OPERATIONS 2L, 2W, MORE THAN 4.5 m (15') AWAY                        |
| 701006-02 | OFF-ROAD OPERATIONS 2L, 2W, 4.5 m (15') TO 600 mm (24") FROM PAVEMENT EDGE    |
| 701101-01 | OFF-ROAD OPERATIONS MULTILANE, 4.5 m (15') TO 600 mm (24") FROM PAVEMENT EDGE |
| 701106-01 | OFF-ROAD OPERATIONS, MULTILANE, MORE THAN 4.5 m (15') AWAY                    |
| 701426-02 | LANE CLOSURE, MULTILANE INTERMITTENT OR MOVING OPERATION, FOR SPEEDS ≥ 45 MPH |
| 701602-02 | URBAN LANE CLOSURE, MULTILANE, 2W WITH BIDIRECTIONAL LEFT TURN LANE           |
| 702001-06 | TRAFFIC CONTROL DEVICES   |

**STATE OF ILLINOIS  
DEPARTMENT OF TRANSPORTATION  
DIVISION OF HIGHWAYS**

**PROPOSED  
HIGHWAY PLANS**

**FAP ROUTE 68 (IL ROUTE 23)  
SECTION (5Z)I**

**LASALLE COUNTY  
C-93-069-07**

**ROADWAY PROFILE CORRECTION**

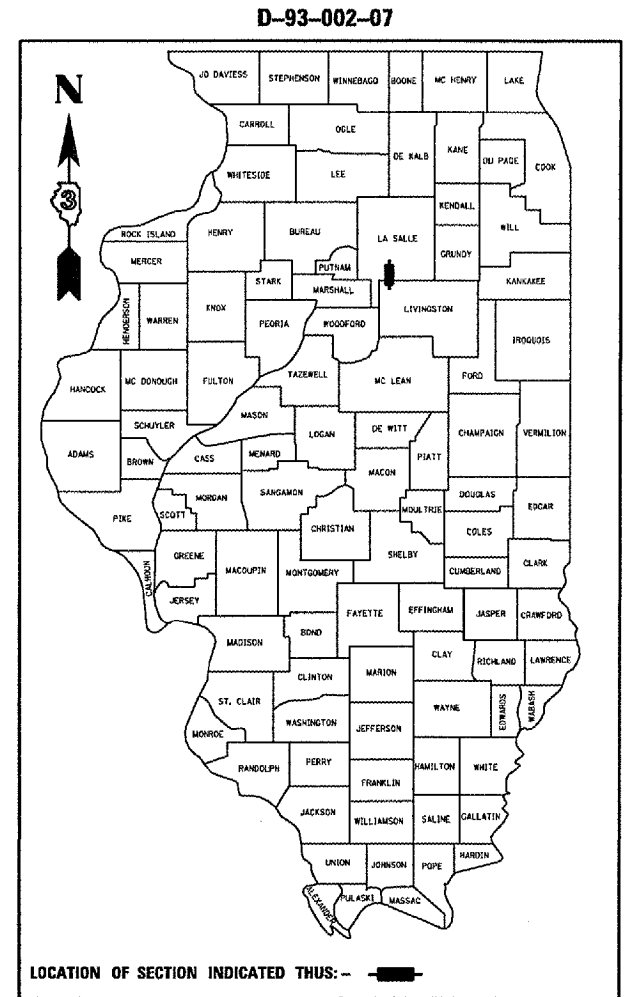

LOCATION OF SECTION INDICATED THIS: - -

**FUNCTIONAL CLASSIFICATION**  
URBAN - MINOR ARTERIAL  
F.A.P. ROUTE 68 (IL 23)  
2005 ADT = 12800  
P.V = 90.3%      M.U. = 2.3%      S.U. = 7.4%

MICROFILMED \_\_\_\_\_  
REEL NUMBER \_\_\_\_\_  
AWARDED \_\_\_\_\_  
RESIDENT ENGINEER \_\_\_\_\_  
AS BUILT CHANGES WERE MADE  
ON THE FOLLOWING SHEETS \_\_\_\_\_

**J.U.L.I.E.**  
**JOINT UTILITY LOCATION INFORMATION FOR EXCAVATION**  
PHONE: 811 OR 1-800-892-0123

**DISTRICT 3 NO. (815) 434-6131**

**PROJECT ENGINEER: JOE KANNEL  
UNIT CHIEF: RON WOODSHANK  
TOWNSHIP: BRUCE**

**CONTRACT NO. 66719**

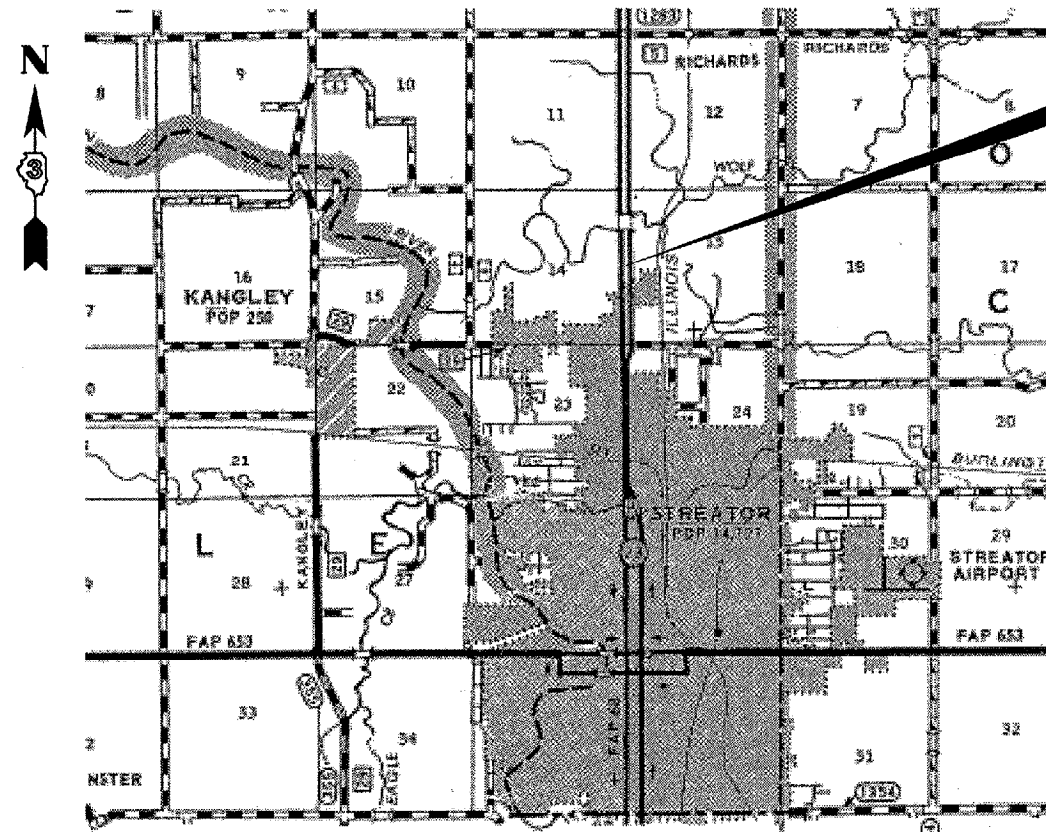

**FAP 68 (IL 23)  
200 FEET NORTH  
OF DANNY'S DRIVE  
IN STREATOR**

**LOCATION MAP**

NOT TO SCALE  
GROSS LENGTH = 282 FT. = 0.053 MI.  
NET LENGTH = 282 FT. = 0.053 MI.

STATE OF ILLINOIS  
DEPARTMENT OF TRANSPORTATION  
DIVISION OF HIGHWAYS

SUBMITTED 5/22 2007

*[Signature]*  
DEPUTY DIRECTOR OF HIGHWAYS REGION ENGINEER

June 29, 20 07  
*[Signature]*  
ENGINEER OF DESIGN AND ENVIRONMENT

June 29, 20 07  
*[Signature]*  
DIRECTOR OF HIGHWAYS, CHIEF ENGINEER

**PRINTED BY THE AUTHORITY  
OF THE STATE OF ILLINOIS**

F.A.P. RTE.	SECTION	COUNTY	TOTAL SHEETS	SHEET NO.
68	(5Z)I	LASALLE	10	2

GENERAL NOTES

PLAN DIMENSIONS AND DETAILS RELATIVE TO EXISTING ROADWAY OR STRUCTURE HAVE BEEN TAKEN FROM EXISTING PLANS AND ARE SUBJECT TO NOMINAL CONSTRUCTION VARIATIONS. IT SHALL BE THE CONTRACTOR'S RESPONSIBILITY TO VERIFY SUCH DIMENSIONS AND DETAILS IN THE FIELD AND TO MAKE NECESSARY APPROVED ADJUSTMENTS PRIOR TO CONSTRUCTION OR ORDERING OF MATERIALS. SUCH VARIATIONS SHALL NOT BE CAUSE FOR ADDITIONAL COMPENSATION FOR A CHANGE IN THE SCOPE OF THE WORK, HOWEVER, THE CONTRACTOR WILL BE PAID FOR THE QUANTITY ACTUALLY FURNISHED AT THE UNIT BID PRICE FOR THE WORK.

FOR STABILIZATION, ALL TYPE III BARRICADES SHALL REQUIRE A MINIMUM OF FOUR SAND BAGS PER BARRICADE.

THE CONTRACTOR SHALL BE RESPONSIBLE FOR PROTECTING UTILITY PROPERTY FROM CONSTRUCTION OPERATIONS AS OUTLINED IN ARTICLE 107.31 OF THE STANDARD SPECIFICATIONS. A MINIMUM OF FORTY-EIGHT (48) HOURS ADVANCE NOTICE IS REQUIRED.

THE COST OF ANY SAW CUTS MADE TO COMPLETE THE WORK AS DESCRIBED IN PLAN DETAILS, UNLESS OTHERWISE NOTED SHALL NOT BE PAID FOR SEPARATELY BUT SHALL BE INCLUDED WITH THE VARIOUS PAY REMOVAL PAY ITEMS INVOLVED.

WHERE SECTION OR SUBSECTION MONUMENTS ARE ENCOUNTERED, THE ENGINEER SHALL BE NOTIFIED BEFORE SUCH MONUMENTS ARE REMOVED. THE CONTRACTOR SHALL PROTECT AND CAREFULLY PRESERVE ALL MONUMENTS UNTIL AN AUTHORIZED SURVEYOR OR AGENT HAS WITNESSED OR OTHERWISE REFERENCED THEIR LOCATION. THE CONTRACTOR SHALL BE RESPONSIBLE FOR HAVING AN AUTHORIZED SURVEYOR REESTABLISH ANY SECTION OR SUBSECTION MONUMENTS DESTROYED BY HIS OPERATIONS.

THE THICKNESS OF HMA SHOWN ON THE PLANS IS THE NOMINAL THICKNESS. DEVIATIONS FROM THE NOMINAL THICKNESS WILL BE PERMITTED WHEN SUCH DEVIATIONS OCCUR DUE TO IRREGULARITIES IN THE EXISTING SURFACE OR BASE ON WHICH THE HMA IS PLACED.

EXCEPT AS NOTED ON THE PLANS, PAVEMENT GRADES SHOWN ARE AT THE TOP OF PAVEMENT SURFACES.

ALL ELEVATIONS REFERRING TO U.S.G.S. MEAN SEA LEVEL DATUM.

THE ENGINEER WILL BE THE SOLE JUDGE CONCERNING CURING TIME FOR THE VARIOUS BITUMINOUS LIFTS.

ANY REFERENCE TO A STANDARD IN THESE PLANS SHALL BE INTERPRETED TO MEAN THE EDITION AS INDICATED BY THE SUBNUMBER SHOWN IN THE LIST OF STANDARDS OR THE COPY INCLUDED IN THESE PLANS.

THE FOLLOWING RATES OF APPLICATION HAVE BEEN USED IN CALCULATING PLAN QUANTITIES:

BITUMINOUS MAT PRIME COAT	0.08 0.375	GAL / SQ YD OR GAL / SQ YD
AGGREGATE PRIME COAT	0.002	TONS / SQ YD
HMA RESURFACING	112	LBS / SQ YD / IN
SHORT TERM PAVEMENT MARKING	10	FT /100 FT OF APPLICATION

DATE: 5/21/07

PREPARED BY: [Signature]  
DISTRICT STUDIES & PLANS ENGINEER

EXAMINED BY: [Signature]  
DISTRICT CONSTRUCTION ENGINEER

[Signature]  
DISTRICT MATERIALS ENGINEER

[Signature]  
DISTRICT OPERATIONS ENGINEER

REVISIONS	
NAME	DATE

ILLINOIS DEPARTMENT OF TRANSPORTATION  
**GENERAL NOTES**  
FAP 68 (IL 23)  
SECTION: (5Z)I  
LASALLE COUNTY

Date: April 23, 2007  
c:/projects/cmain08/cm313/details.dgn

F.A.P. RTE.	SECTION	COUNTY	TOTAL SHEETS	SHEET NO.
68	(5Z)I	LASALLE	10	3

## SUMMARY OF QUANTITIES

CONSTRUCTION CODE TYPE: I000

URBAN  
100% STATE  
TOTAL  
QUANTITY

CODE NO.	ITEM	UNIT	TOTAL QUANTITY
40600100	BITUMINOUS MATERIALS (PRIME COAT)	GALLON	153
40600300	AGGREGATE (PRIME COAT)	TON	4
40600400	MIXTURE FOR CRACKS, JOINTS, AND FLANGEWAYS	TON	1
40600535	LEVELING BINDER (HAND METHOD), N70	TON	1
40600990	TEMPORARY RAMP	SQ YD	130
40603340	HOT-MIX ASPHALT SURFACE COURSE, MIX "D", N70	TON	161
44000155	HOT-MIX ASPHALT SURFACE REMOVAL, 1 1/2"	SQ YD	352
44000198	HOT-MIX ASPHALT SURFACE REMOVAL, VARIABLE DEPTH	SQ YD	1559
67100100	MOBILIZATION	L SUM	1
70102632	TRAFFIC CONTROL AND PROTECTION, STANDARD 701602	L SUM	1
70300100	SHORT-TERM PAVEMENT MARKING	FOOT	510
*78000100	THERMOPLASTIC PAVEMENT MARKING - LETTERS AND SYMBOLS	SQ FT	32
*78000200	THERMOPLASTIC PAVEMENT MARKING - LINE 4"	FOOT	564
*78000400	THERMOPLASTIC PAVEMENT MARKING - LINE 6"	FOOT	282

**\*SPECIALTY ITEM**

REVISIONS	
NAME	DATE

ILLINOIS DEPARTMENT OF TRANSPORTATION  
**SUMMARY OF QUANTITIES**  
FAP 68 (IL 23)  
SECTION: (5Z)I  
LASALLE COUNTY

Date: April 23, 2007  
c:/projects/cmain08/cm313/details.dgn

F.A.P. RTE.	SECTION	COUNTY	TOTAL SHEETS	SHEET NO.
68	(5Z)I	LASALLE	10	4

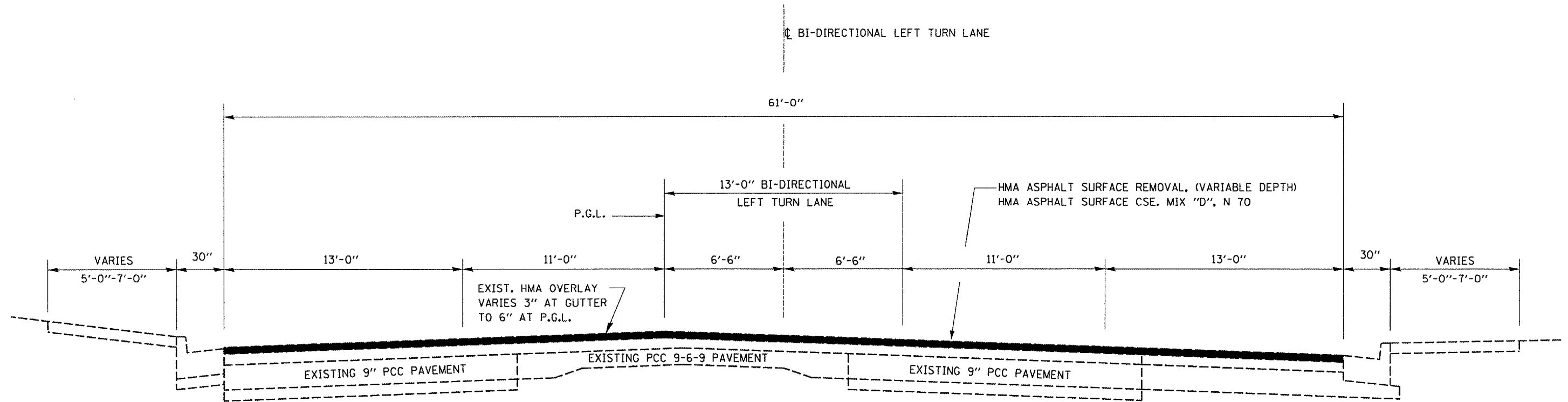

## TYPICAL SECTION

	HMA LEVEL BINDER	HMA SURFACE
PG GRADE	PG64-22	PG64-22
MAX % RAP ALLOWABLE	15%***	10%***
DESIGN AIR VOIDS	4.0% @ N70	4.0% @ N70
MIXTURE COMPOSITION	IL 9.5	IL 12.5 or IL 9.5
FRICTION AGGREGATE		MIXTURE D
DENSITY CONTROL METHOD	SATISFACTION OF ENGINEER	NUCLEAR/ CORES

••IF RAP OPTION IS SELECTED, THE ASPHALT CEMENT GRADE MAY NEED TO BE ADJUSTED. THIS WILL BE DETERMINED BY THE ENGINEER.

\*\*\* SEE RAP SPECIAL PROVISION.

REVISIONS	
NAME	DATE

ILLINOIS DEPARTMENT OF TRANSPORTATION  
**TYPICAL SECTIONS**  
FAP 68 (IL 23)  
SECTION: (5Z)I  
LASALLE COUNTY

Date: April 23, 2007  
c:/projects/cmain08/cm313/details.dgn

F.A.P. RTE.	SECTION	COUNTY	TOTAL SHEETS	SHEET NO.
68	(52)I	LASALLE	10	5

BM #1 YELLOW BOLT IN ABANDONED FOUNDATION  
SOUTHEAST CORNER AT GAS STATION  
STA. 1+23 LT ELEV. 632.56

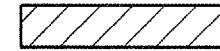
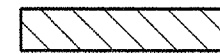
 HOT-MIX ASPHALT SURFACE REMOVAL 1 1/2"  
 HOT-MIX ASPHALT SURFACE REMOVAL, VARIABLE



PLAN	SURVEYED	DATE
	BY	
	ALIGNED	
	CHECKED	
	BY	
	NOTED	
	DATE	
	BY	
	PROF. NO.	

PROFILE	SURVEYED	DATE
	BY	
	GRADES	
	CHECKED	
	BY	
	NOTED	
	DATE	
	BY	
	PROF. NO.	

PLOT DATE = 9/21/2007  
FILE NAME = c:\p\projects\acme\88\plan\3\detail.dgn  
PLOT SCALE = 63SCALE  
USER NAME = localadmin1

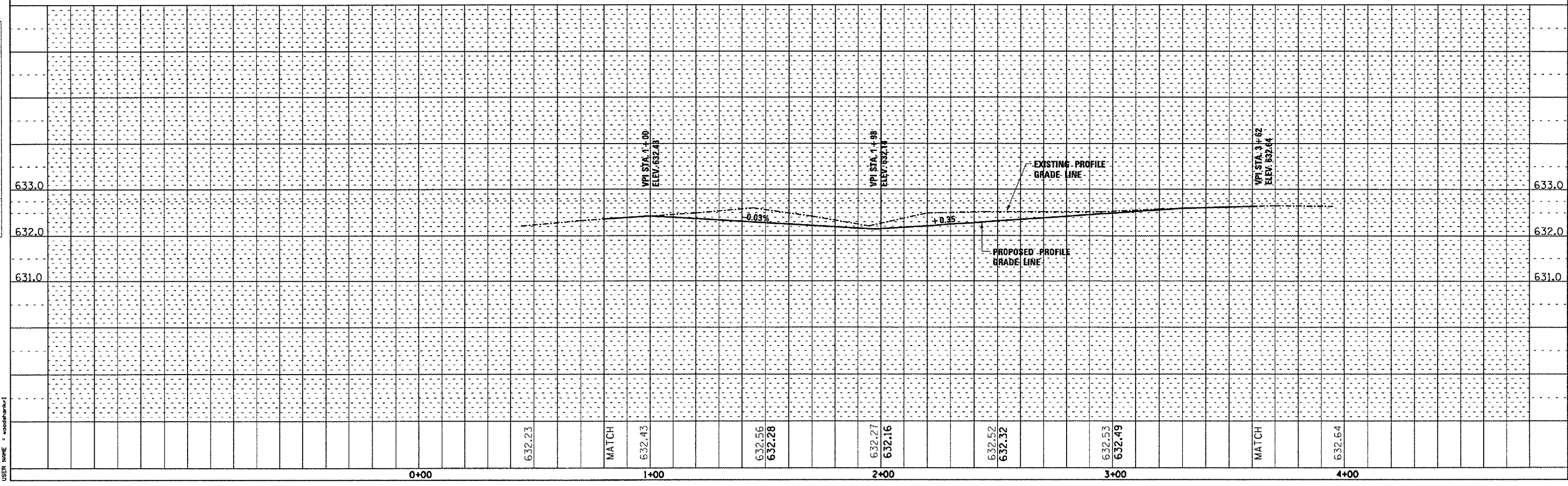
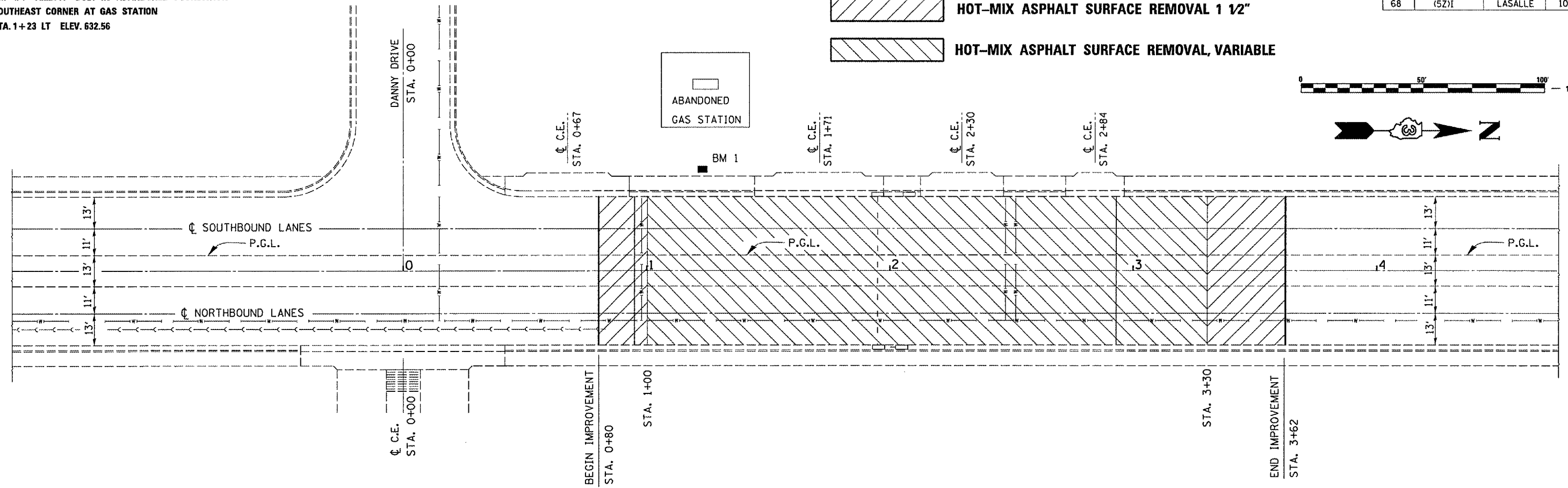

F.A.P. RTE.	SECTION	COUNTY	TOTAL SHEETS	SHEET NO.
68	(5Z)I	LASALLE	10	6

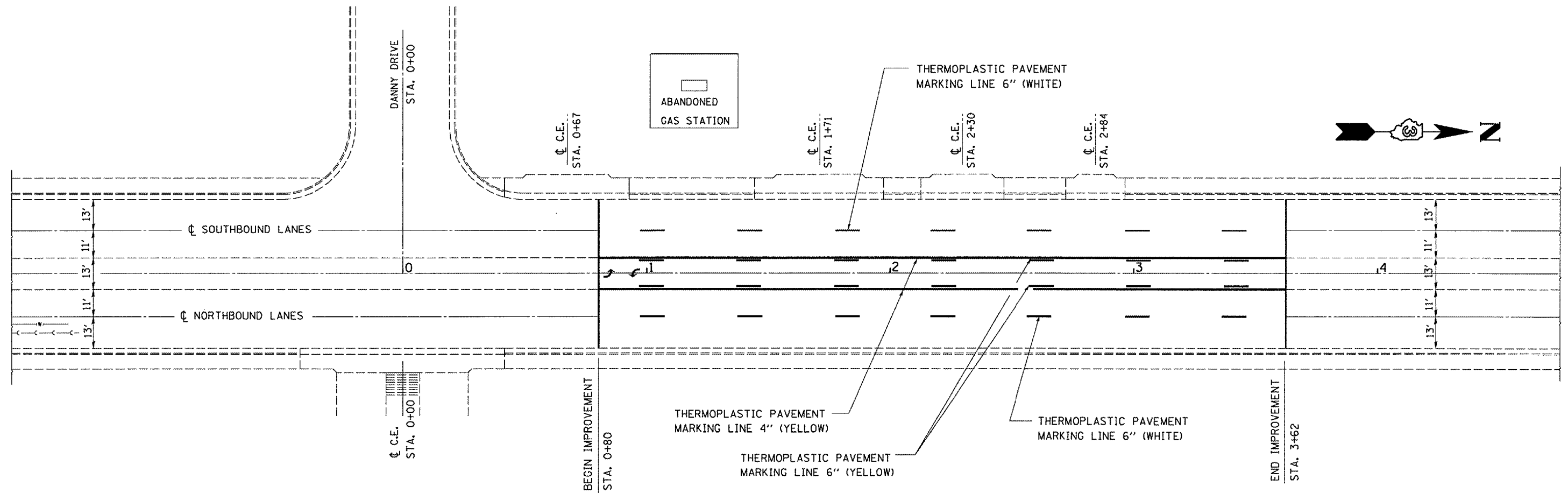

Date: April 23, 2007  
c:/projects/cmain08/cm313/details.dgn

REVISIONS	
NAME	DATE

ILLINOIS DEPARTMENT OF TRANSPORTATION  
**PAVEMENT MARKING**  
**FAP 68 (IL 23)**  
**SECTION: (5Z)I**  
**LASALLE COUNTY**

F.A.P. RTE.	SECTION	COUNTY	TOTAL SHEETS	SHEET NO.
68	(52)I	LASALLE	10	7

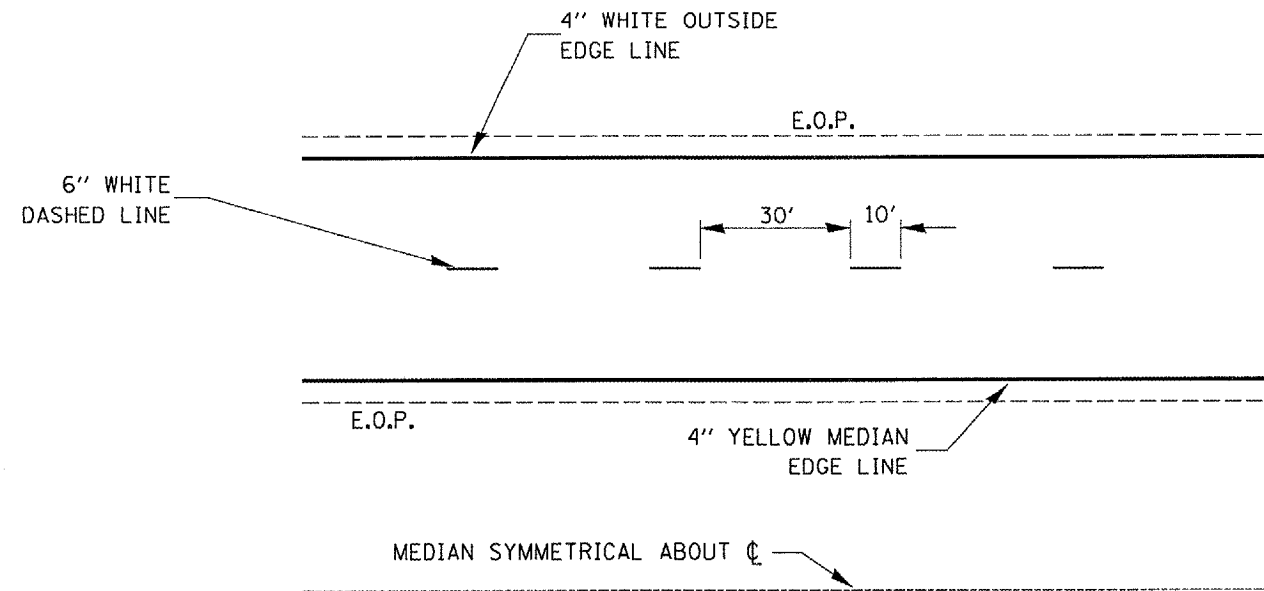

**TYPICAL PAVEMENT MARKINGS**

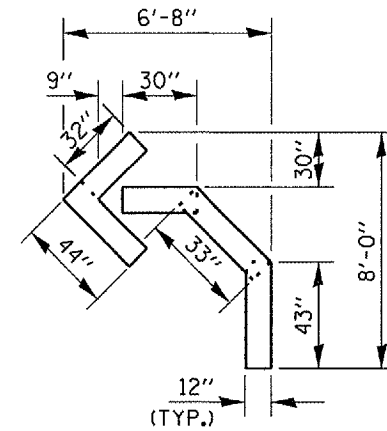

QUANTITY  
 12" LINE = 16 LIN. FT.  
 OR 4" LINE = 48 LIN. FT.

**SHORT-TERM PAVEMENT MARKING  
 FOR ARROWS**

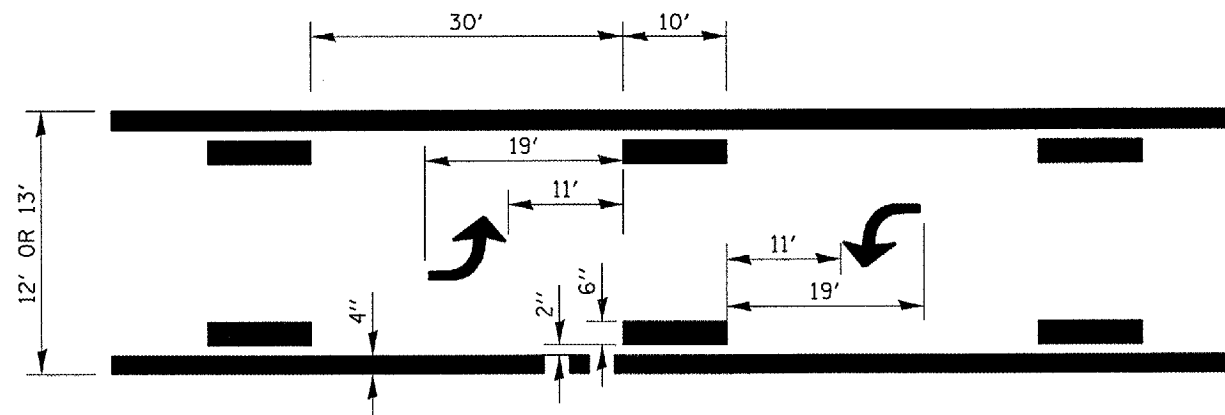

**TYPICAL APPLICATION @  
 BI-DIRECTIONAL TURN LANE**

REVISIONS	
NAME	DATE

ILLINOIS DEPARTMENT OF TRANSPORTATION  
**TYPICAL PVMT MARKING**  
 FAP 68 (IL 23)  
 SECTION: (52)I  
 LASALLE COUNTY

Date: April 23, 2007  
 c:/projects/cmain08/cm313/details.dgn

Date: April 23, 2007

c:\projects\cmaln08\cm313\details.dgn

F.A.P. RTE.		SECTION	COUNTY	TOTAL SHEETS	SHEET NO.
68		(52)	LASALLE	10	8
STA. 0+50		TO STA. 1+50			
FED. ROAD DIST. NO.		ILLINOIS			

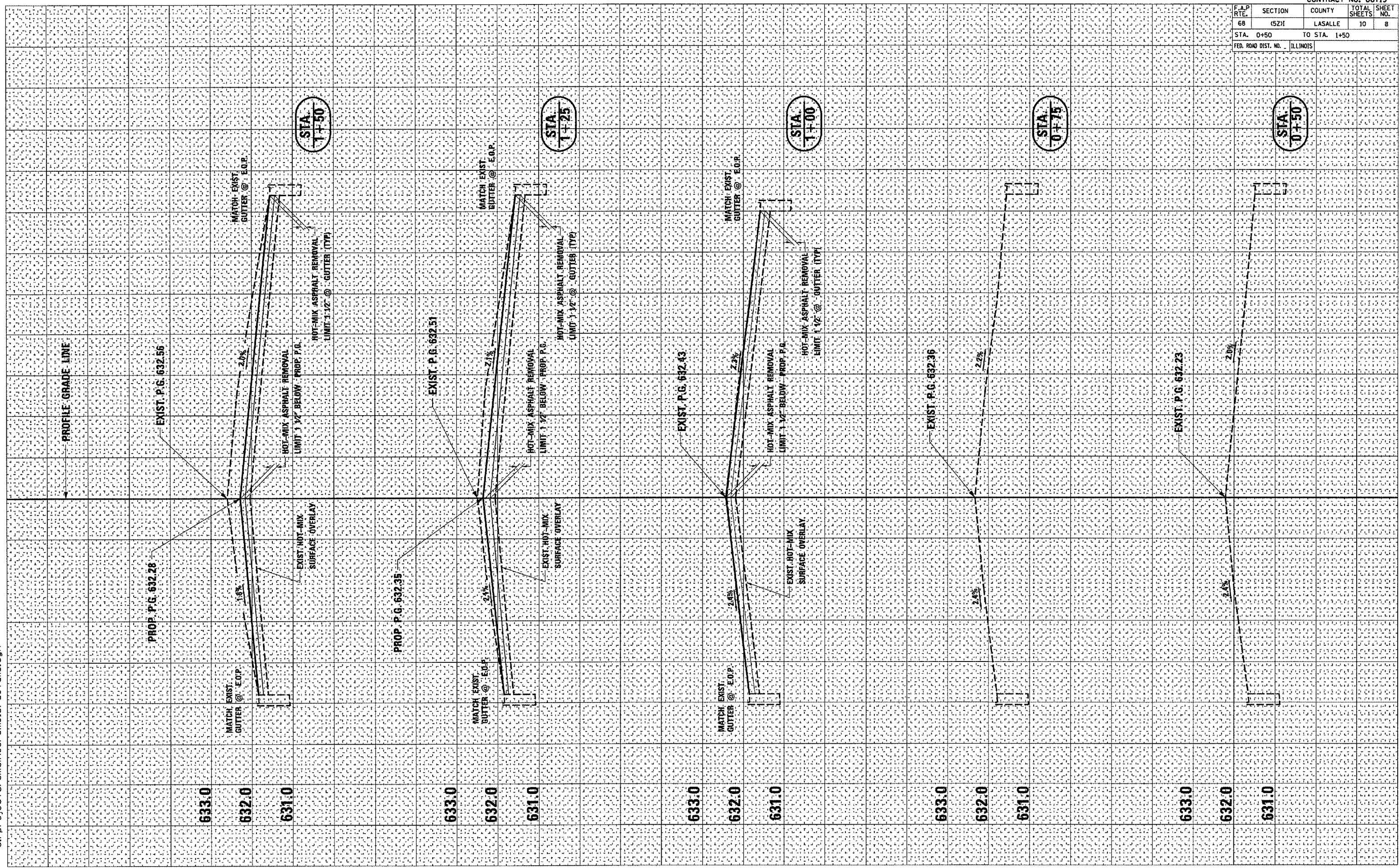

FINAL SURVEY	CONVERTED	DATE
NOTE BOOK	PLOTTED	
AREAS CHECKED	TEMPLATE	
	AREAS	
	CHECKED	



F.A.P. RTE.	SECTION	COUNTY	TOTAL SHEETS	SHEET NO.
68	(52)I	LASALLE	10	9
STA. 1+75		TO STA. 2+75		
FED. ROAD DIST. NO. ILLINOIS				

FINAL SURVEY	DATE
SURVEYED	
PLOTTED	
TEMPLATE	
NOTE BOOK	
AREAS CHECKED	
BY	

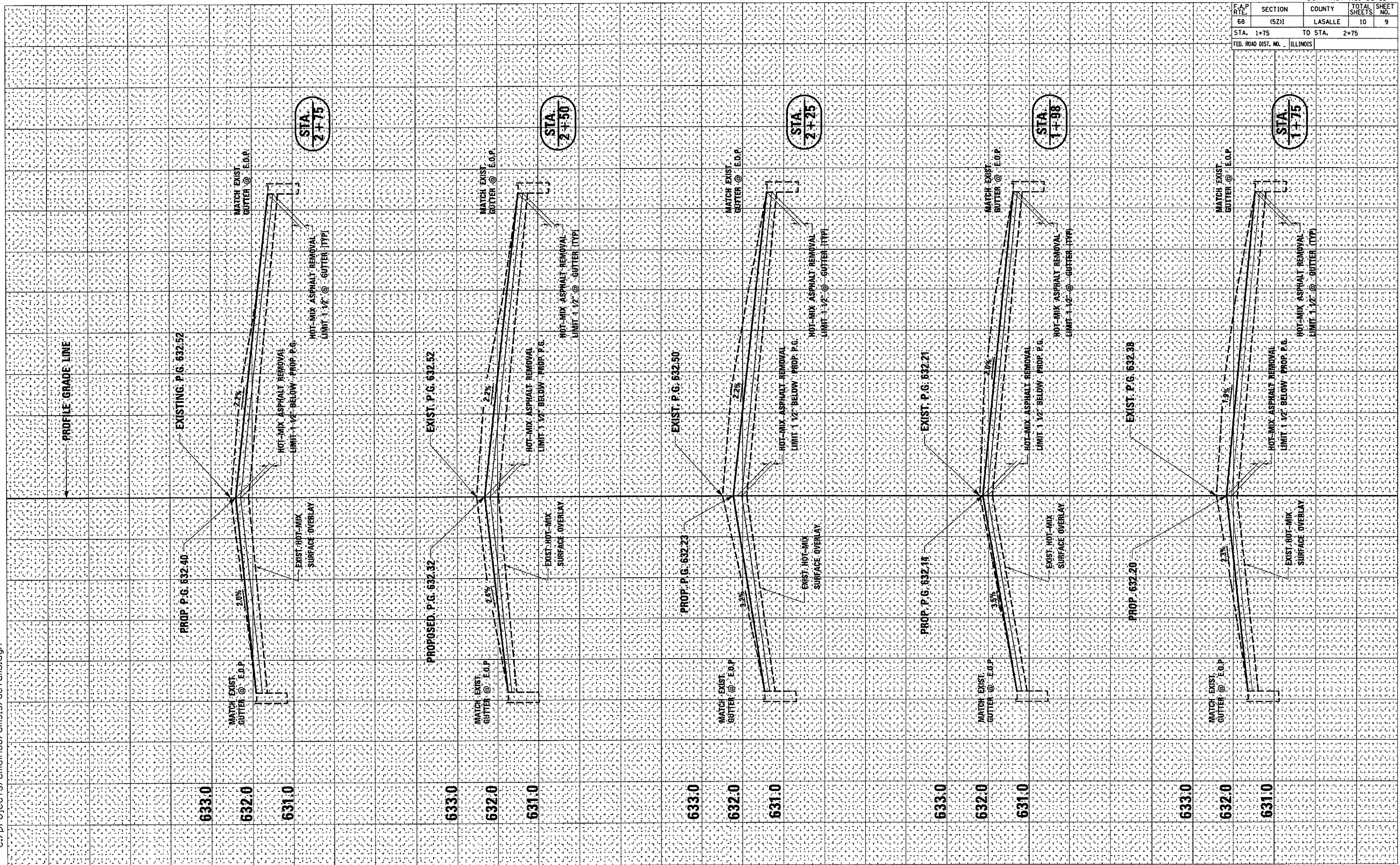

Date: April 23, 2007

c:/projects/cmain08/cm313/details.dgn

Date: April 23, 2007

c:/projects/main08/cm313/details.dgn

FINAL SURVEY	BY	DATE
REVISED		
NOTE BOOK		
TEMPLATE		
AREAS		
CHECKED		

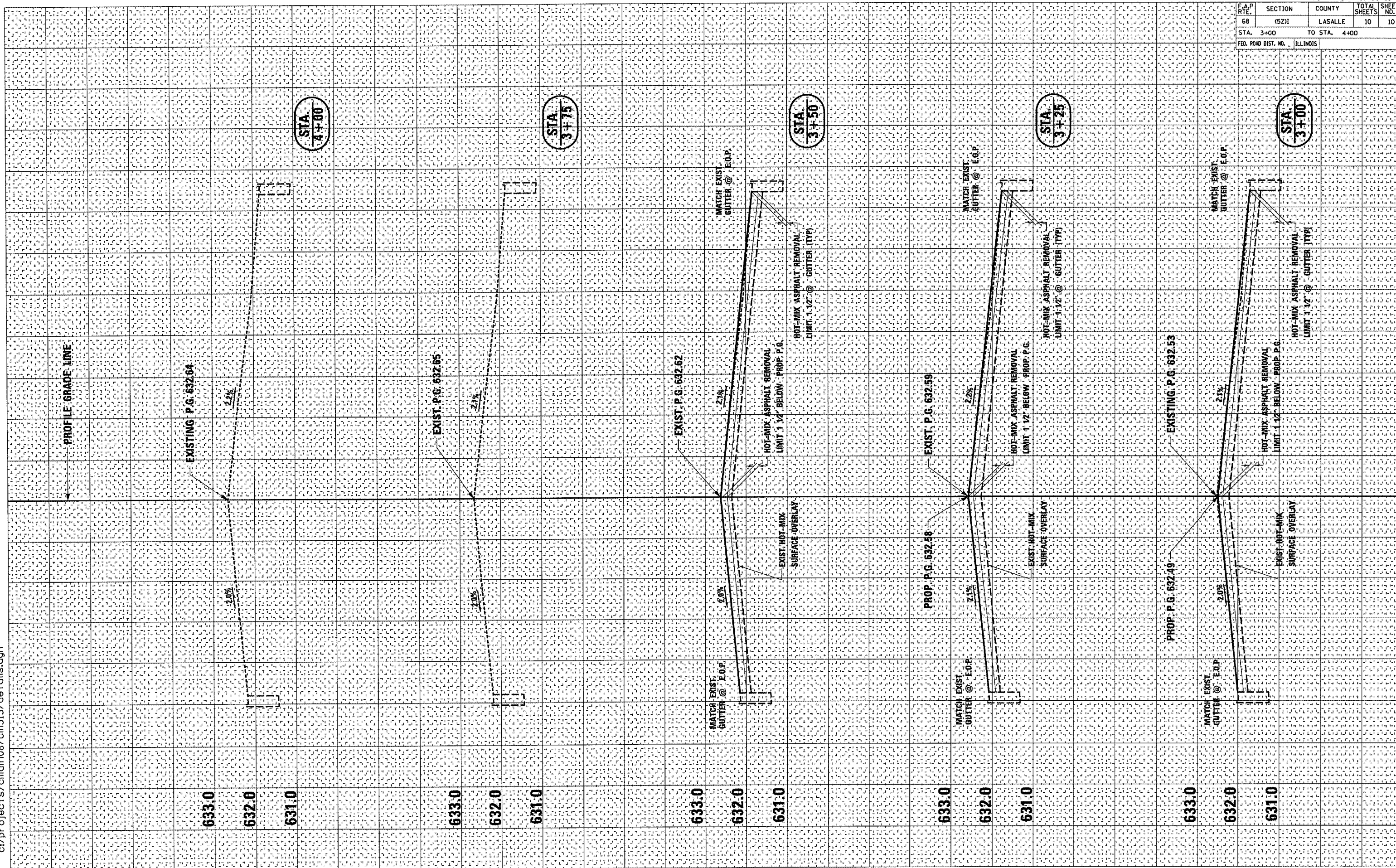

CONTRACT NO. 66719			
F.A.P. RTE.	SECTION	COUNTY	TOTAL SHEETS
68	(52)	LASALLE	10
STA. 3+00		TO STA. 4+00	
FED. ROAD DIST. NO.		ILLINOIS	