

- = MULCH METHOD 3
- = INLET PIPE PROTECTION
- = TEMPORARY DITCH CHECKS
- = RIP RAP
- = EROSION CONTROL BLANKET
- = TURF REINFORCEMENT MAT
- = PERIMETER EROSION BARRIER

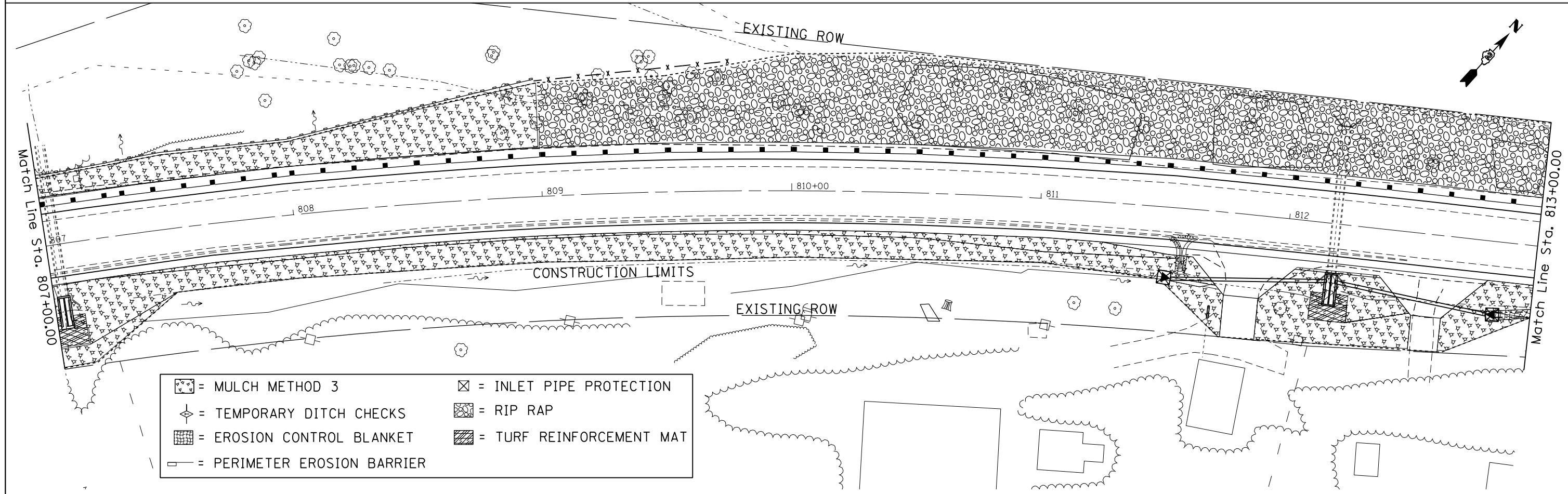

- = MULCH METHOD 3
- = INLET PIPE PROTECTION
- = TEMPORARY DITCH CHECKS
- = RIP RAP
- = EROSION CONTROL BLANKET
- = TURF REINFORCEMENT MAT
- = PERIMETER EROSION BARRIER

FILE NAME =	USER NAME = grantpm	DESIGNED -	REVISED -
es:\pw_work\p\midot\grantpm\d0261271\0207	11-sh1-eros.dgn	DRAWN -	REVISED -
	PLOT SCALE = 40.0000' / in.	CHECKED -	REVISED -
	PLOT DATE = Wed Mar 20 11:37:06 2013	DATE -	REVISED -

**STATE OF ILLINOIS
DEPARTMENT OF TRANSPORTATION**

IL ROUTE 92 EROSION CONTROL SHEETS				
SCALE:	SHEET	OF	SHEETS	STA. TO STA.

F.A.P. RTE.	SECTION	COUNTY	TOTAL SHEETS	SHEET NO.
599	(83MFT & 103MFT)W	ROCK ISLAND	340	107
CONTRACT NO. 64H11			ILLINOIS FED. AID PROJECT	