

HORIZONTAL & VERTICAL CONTROL

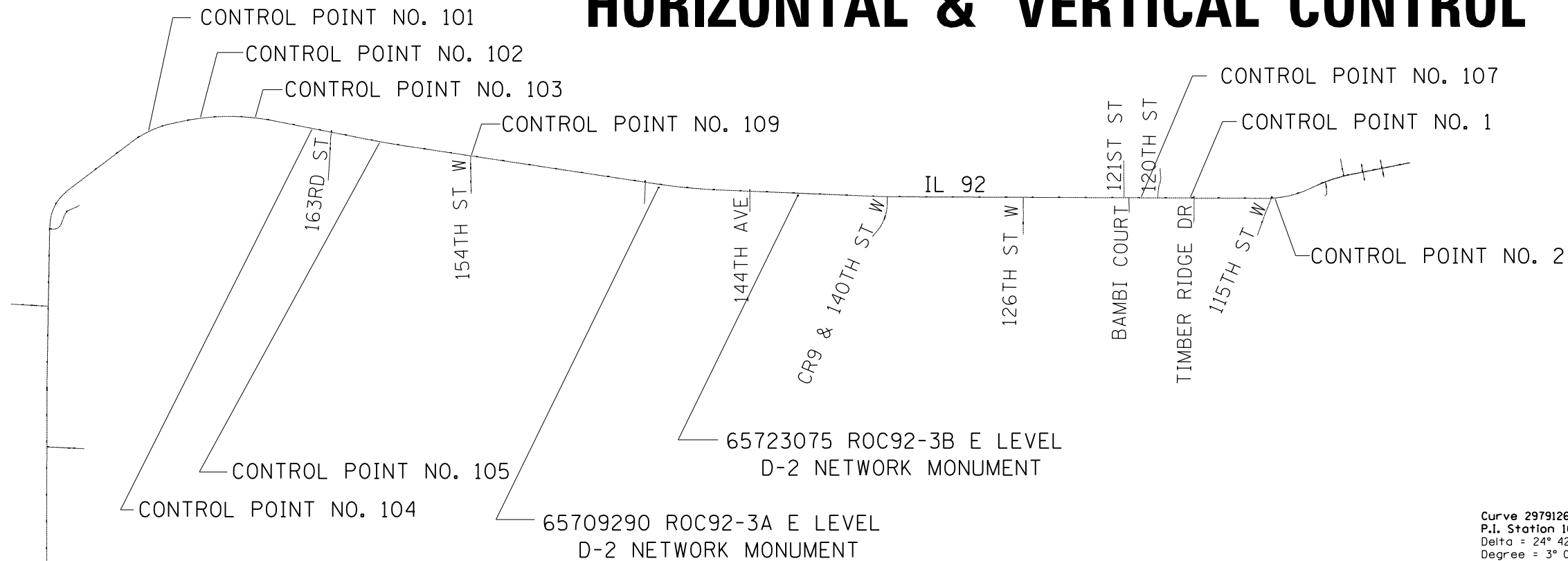

Curve Data

Curve 29791200
 P.I. Station 788+03.3965 N 1,738,200.1295 E 2,120,331.7747
 Delta = 10° 06' 09.7368" (RT)
 Degree = 4° 35' 02.6537"
 Tangent = 110.4800'
 Length = 220.3872'
 Radius = 1,249.8887'
 External = 4.8733'
 Long Chord = 220.1018'
 Mid. Ord. = 4.8543'
 P.C. Station 786+92.9165 N 1,738,119.0253 E 2,120,256.7552
 P.T. Station 789+13.3037 N 1,738,266.8168 E 2,120,419.8578
 C.C. N 1,737,270.3098 E 2,121,174.3083

Course from PT 29791200 to PC 29791210 52° 52' 14.9392" Dist 1,453.2351'

Curve Data

Curve 29791210
 P.I. Station 807+91.8689 N 1,739,400.7453 E 2,121,917.5938
 Delta = 24° 58' 57.5174" (RT)
 Degree = 2° 59' 03.4300"
 Tangent = 425.3300'
 Length = 837.1397'
 Radius = 1,919.9158'
 External = 46.5486'
 Long Chord = 830.5238'
 Mid. Ord. = 45.4468'
 P.C. Station 803+66.5389 N 1,739,144.0101 E 2,121,578.4882
 P.T. Station 812+03.6786 N 1,739,490.2401 E 2,122,333.4018
 C.C. N 1,737,613.3062 E 2,122,737.3765

Course from PT 29791210 to PC 29791220 77° 51' 12.4566" Dist 177.4690'

Curve Data

Curve 29791220
 P.I. Station 822+68.9875 N 1,739,714.3947 E 2,123,374.8613
 Delta = 23° 19' 41.1309" (RT)
 Degree = 1° 19' 55.9565"
 Tangent = 887.8400'
 Length = 1,751.0820'
 Radius = 4,300.8065'
 External = 90.6849'
 Long Chord = 1,739.0120'
 Mid. Ord. = 88.8122'
 P.C. Station 813+81.1475 N 1,739,527.5819 E 2,122,506.8977
 P.T. Station 831+32.2295 N 1,739,542.2261 E 2,124,245.8480
 C.C. N 1,735,323.0591 E 2,123,411.8421

Course from PT 29791220 to PC 29791230 101° 10' 53.5875" Dist 1,766.2660'

Curve Data

Curve 29791230
 P.I. Station 853+02.8755 N 1,739,121.2977 E 2,126,375.2900
 Delta = 2° 34' 54.9584" (LT)
 Degree = 0° 19' 09.4797"
 Tangent = 404.3800'
 Length = 808.6231'
 Radius = 17,944.1893'
 External = 4.5559'
 Long Chord = 808.5547'
 Mid. Ord. = 4.5547'
 P.C. Station 848+98.4955 N 1,739,199.7145 E 2,125,978.5861
 P.T. Station 857+07.1186 N 1,739,060.8313 E 2,126,775.1237
 C.C. N 1,756,803.2808 E 2,129,458.2963

Course from PT 29791230 to PC 29791240 98° 35' 58.6291" Dist 4,700.8764'

Curve Data

Curve 29791240
 P.I. Station 910+39.5750 N 1,738,263.4756 E 2,132,047.6293
 Delta = 6° 15' 36.7598" (LT)
 Degree = 0° 29' 45.9342"
 Tangent = 631.5800'
 Length = 1,261.9031'
 Radius = 11,549.4065'
 External = 17.2561'
 Long Chord = 1,261.2755'
 Mid. Ord. = 17.2304'
 P.C. Station 904+07.9950 N 1,738,357.9150 E 2,131,423.1499
 P.T. Station 916+69.8982 N 1,738,237.6951 E 2,132,678.6829
 C.C. N 1,749,777.4759 E 2,133,150.1185

Course from PT 29791240 to PC 29791250 92° 20' 21.8692" Dist 2,812.1003'

Curve Data

Curve 29791250
 P.I. Station 947+58.0685 N 1,738,111.6390 E 2,135,764.2794
 Delta = 2° 06' 32.0363" (LT)
 Degree = 0° 22' 55.1754"
 Tangent = 276.0700'
 Length = 552.0777'
 Radius = 14,999.1634'
 External = 2.5404'
 Long Chord = 552.0465'
 Mid. Ord. = 2.5400'
 P.C. Station 944+81.9985 N 1,738,122.9079 E 2,135,488.4395
 P.T. Station 950+34.0761 N 1,738,110.5283 E 2,136,040.3472
 C.C. N 1,753,109.5703 E 2,136,100.6908

Course from PT 29791250 to PC 29791260 90° 13' 49.8329" Dist 6,882.4138'

Curve Data

Curve 29791260
 P.I. Station 1023+32.7499 N 1,738,081.1648 E 2,143,338.9619
 Delta = 24° 42' 55.9606" (LT)
 Degree = 3° 00' 56.4158"
 Tangent = 416.2600'
 Length = 819.5703'
 Radius = 1,899.9347'
 External = 45.0651'
 Long Chord = 813.2307'
 Mid. Ord. = 44.0210'
 P.C. Station 1019+16.4899 N 1,738,082.8395 E 2,142,922.7053
 P.T. Station 1027+36.0602 N 1,738,253.6861 E 2,143,717.7875
 C.C. N 1,739,982.7588 E 2,142,930.3490

Course from PT 29791260 to PC 29791270 65° 30' 53.8723" Dist 179.8051'

Curve Data

Curve 29791270
 P.I. Station 1032+46.4853 N 1,738,465.2346 E 2,144,182.3098
 Delta = 13° 14' 05.6806" (RT)
 Degree = 2° 00' 37.7159"
 Tangent = 330.6200'
 Length = 658.2972'
 Radius = 2,849.8605'
 External = 19.1140'
 Long Chord = 656.8346'
 Mid. Ord. = 18.9866'
 P.C. Station 1029+15.8653 N 1,738,328.2073 E 2,143,881.4226
 P.T. Station 1035+74.1625 N 1,738,529.7361 E 2,144,506.5769
 C.C. N 1,735,734.6360 E 2,145,062.5632

Course from PT 29791270 to 29794528 78° 44' 59.5529" Dist 1,140.9116'

Point 29794528 N 1,738,752.3193 E 2,145,625.5657 Sta 1047+15.0741

Ending chain IL92 description

CURVE POINT NUMBERS					
CHAIN	CURVE	PI	CC	PC	PT
IL92	29791200	29791200	29791201	29791202	29791203
IL92	29791210	29791210	29791211	29791212	29791213
IL92	29791220	29791220	29791221	29791222	29791223
IL92	29791230	29791230	29791231	29791232	29791233
IL92	29791240	29791240	29791241	29791242	29791243
IL92	29791250	29791250	29791251	29791252	29791253
IL92	29791260	29791260	29791261	29791262	29791263
IL92	29791270	29791270	29791271	29791272	29791273