

Wrong Way Traffic Control for Half Diamond Interchange Exit Ramp

SIGNS MUST BE FIELD VERIFIED AND ADJUSTED AS NEEDED BY THE ENGINEER TO PROVIDE CLEAR VISIBILITY OF THE SIGNS

(OPTIONAL) ADDITIONAL PAIRS OF 'WRONG WAY' SIGNS MAY BE INSTALLED INCLUDING NEAR THE BEGINNING OF THE RAMP

SIGN CAN BE PLACED IN MEDIAN IF PRESENT



TRAILBLAZING SIGNS SHALL BE PROVIDED TO DIRECT DRIVERS TO THE CLOSEST ENTRANCE FOR RAMP MOVEMENTS NOT PROVIDED AT THIS INTERCHANGE

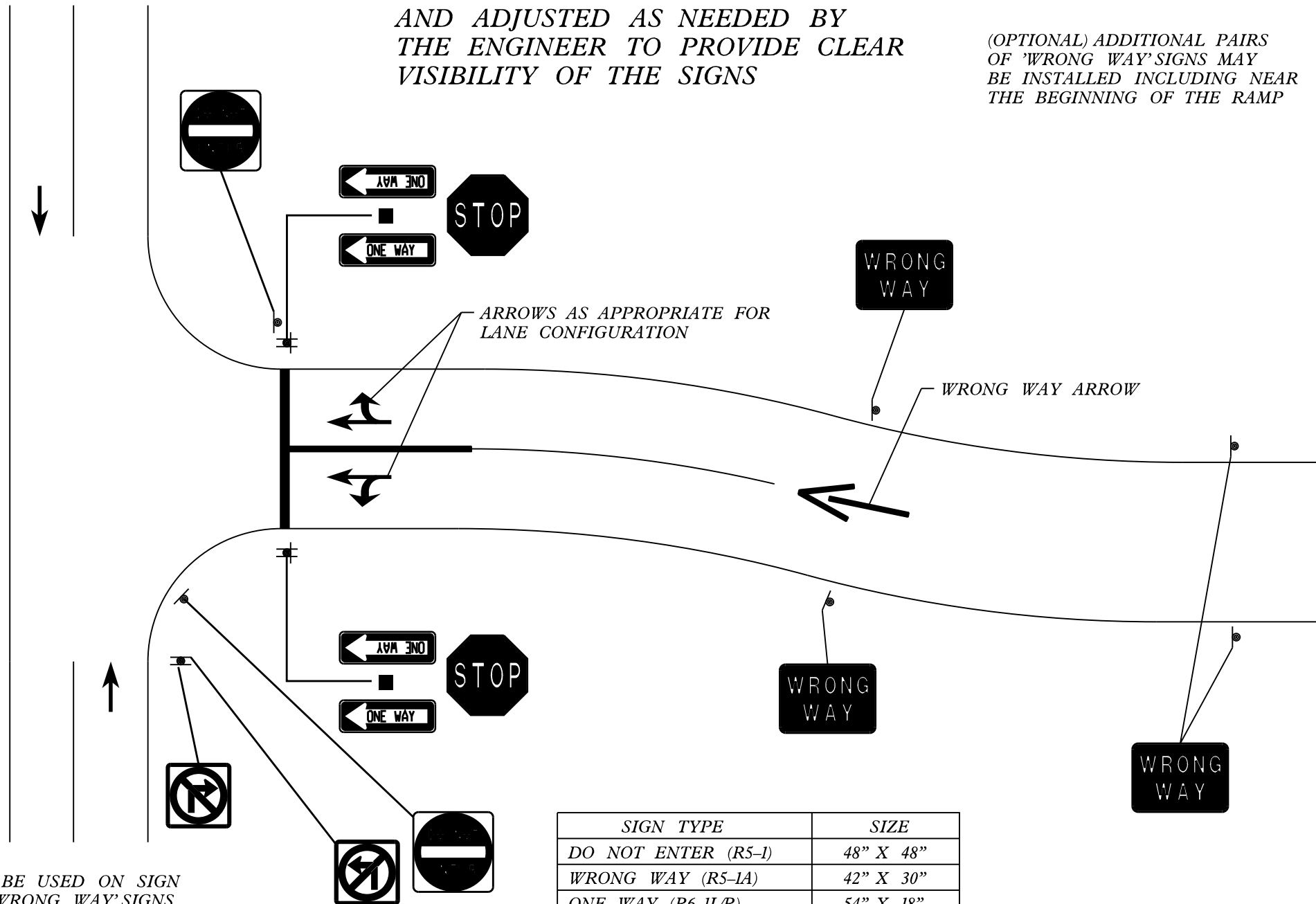

NOTES:
RETROREFLECTIVE SIGN PANEL SHALL BE USED ON SIGN SUPPORTS FOR 'DO NOT ENTER' AND 'WRONG WAY' SIGNS

SIGN TYPE	SIZE
DO NOT ENTER (R5-1)	48" X 48"
WRONG WAY (R5-1A)	42" X 30"
ONE WAY (R6-1L/R)	54" X 18"