

F.A.T. RTE.	SECTION	COUNTY	TOTAL SHEETS	SHEET NO.
9	02	003	22	1

- FAS 1909 & FAP 322
- D9 PAVEMENT PRESERVATION FY08
- JACKSON AND UNION COUNTIES

STATE OF ILLINOIS
DEPARTMENT OF TRANSPORTATION
DIVISION OF HIGHWAYS

PROPOSED HIGHWAY PLANS

FAS ROUTE 1909 & FAP ROUTE 322
SECTION D9 PAVEMENT PRESERVATION FY08

D-99-040-07

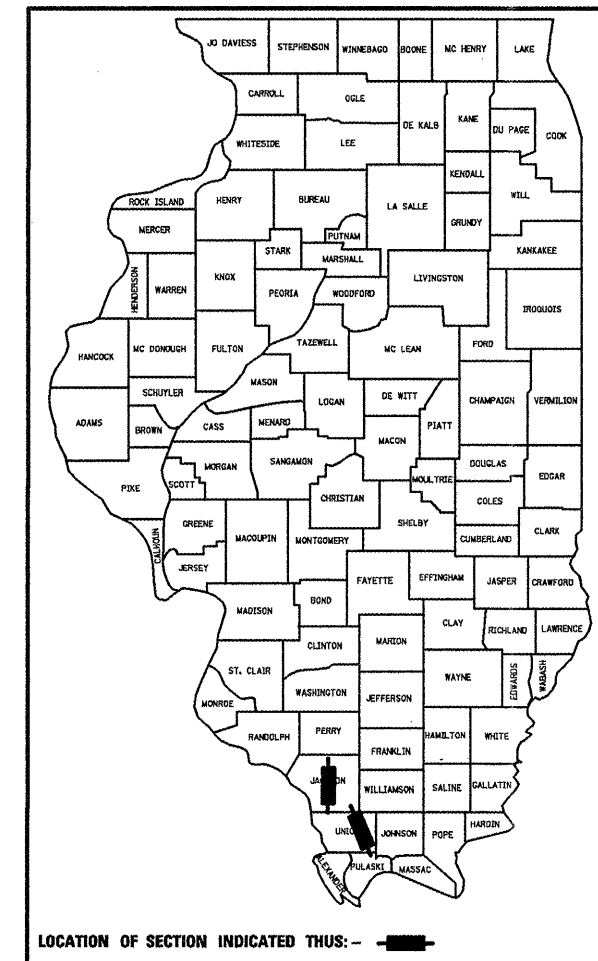

LOCATION OF SECTION INDICATED THUS: —■—

FOR INDEX OF SHEETS, SEE SHEET NO. 3

ADT:
US 51 - 4050 (2005)
MU = 125
SU = 200
TRUCKS = 8%

IL 127 - 4200 (2005)
MU = 40
SU = 100
TRUCKS = 3%

EQUATION STATIONS: US 51
EQ. STA. 1047+55.55 (BK.) = STA. 52+01.25 (AH.)
EQ. STA. 103+30.75 (BK.) = STA. 103+86.85 (AH.)
EQ. STA. 118+04.60 (BK.) = STA. 2018+04.60 (AH.)
EQ. STA. 2081+73.95 (BK.) = STA. 187+61.39 (AH.)
EQ. STA. 240+04.17 (BK.) = STA. 3040+04.17 (AH.)
EQ. STA. 3101+03.20 (BK.) = STA. 304+62.66 (AH.)

EQUATION STATIONS: IL 127
EQ. STA. 344+07.40 (BK.) = STA. 6+06.70 (AH.)
EQ. STA. 79+77.70 (BK.) = STA. 80+07.70 (AH.)
EQ. STA. 138+96.20 (BK.) = STA. 139+83.10 (AH.)

OMISSION STATIONS:
STA. 3073+50 TO STA. 3075+71 (S.N. 091-0071)

PROJECT AT FAS 1909 LOCATION 3:
STA. 335+53 TO STA. 227+32
LENGTH = 22,862.8' = 4.33 MILES

TOWNSHIPS: POMONA, ANNA, BALCOM

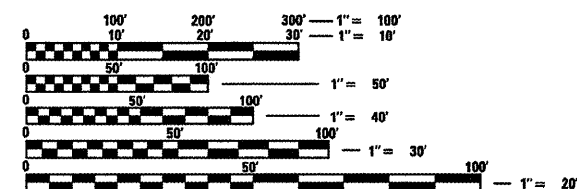

FULL SIZE PLANS HAVE BEEN PREPARED USING STANDARD ENGINEERING SCALES. REDUCED SIZED PLANS WILL NOT CONFORM TO STANDARD SCALES. IN MAKING MEASUREMENTS ON REDUCED PLANS, THE ABOVE SCALES MAY BE USED.

J.U.L.I.E.
JOINT UTILITY LOCATION INFORMATION FOR EXCAVATION
1-800-892-0123

CONTRACT NO. 78017

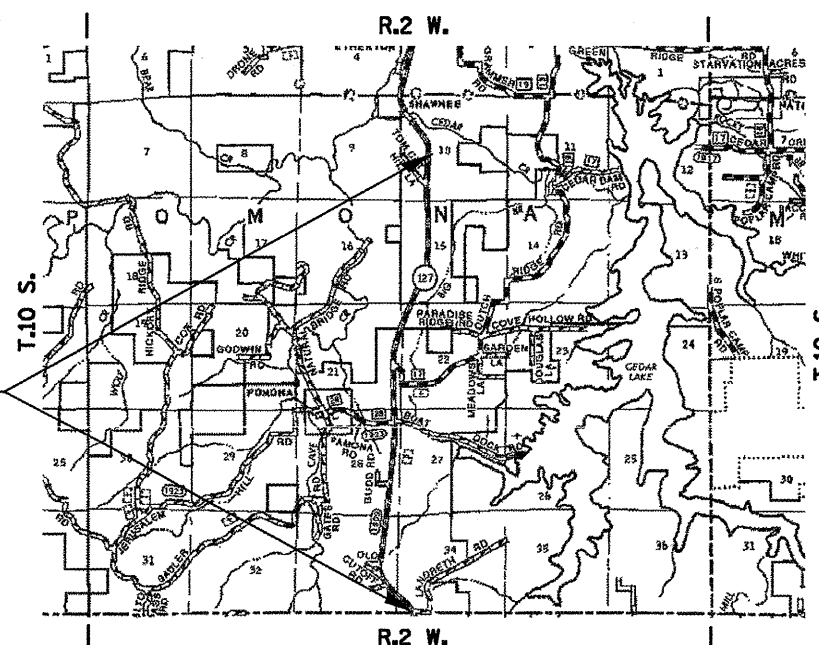

PROJECT AT US 51 LOCTION 1:
STA. 1000+33 TO STA. 238+50
LENGTH = 22,727.76' = 4.31 MILES

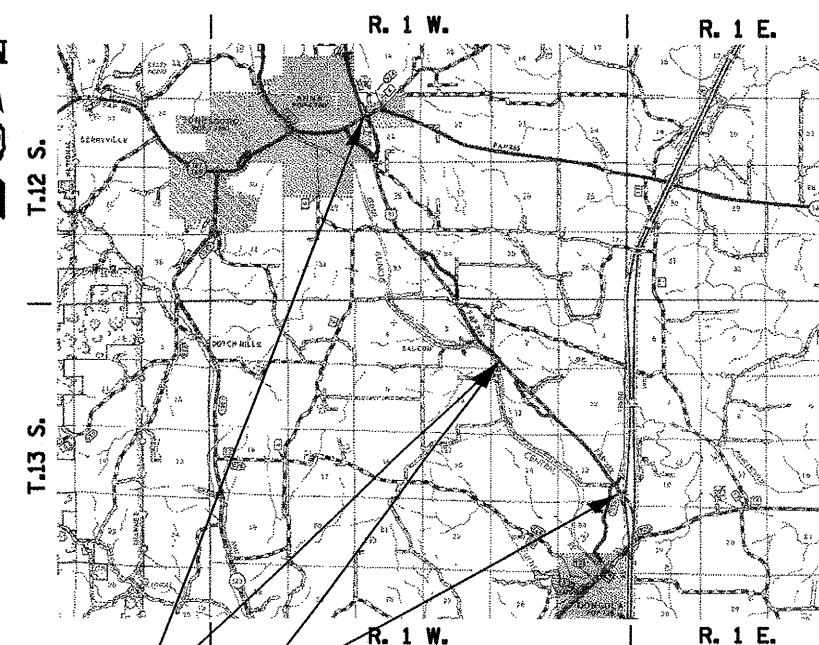

PROJECT AT US 51 LOCTION 2:
STA. 238+50 TO STA. 378+65
LENGTH = 13,434.54' = 2.54 MILES

GROSS PROJECT LENGTH = 59,246.1 = 11.22 MILES
NET PROJECT LENGTH: 59,025.1' = 11.18 MILES

STATE OF ILLINOIS
DEPARTMENT OF TRANSPORTATION
DIVISION OF HIGHWAYS

SUBMITTED Jan 23 20 08
Mary C. Amis
DEPUTY DIRECTOR OF HIGHWAYS, REGION ENGINEER

March 21 20 08
Eric E. Harnik
INTERIM ENGINEER OF DESIGN AND ENVIRONMENT

March 21 20 08
Christina M. Reed
DIRECTOR OF HIGHWAYS, CHIEF ENGINEER

PRINTED BY THE AUTHORITY
OF THE STATE OF ILLINOIS

CONTRACT NO. 78017

F.A.I. RTE.	SECTION	COUNTY	TOTAL SHEETS	SHEET NO.
2	**	***	22	2
STA.		TO STA.		
FED. ROAD DIST. NO.		ILLINOIS FED. AID PROJECT		

- FAS 1909 & FAP 322
- ** DS PAVEMENT PRESERVATION FY08
- *** JACKSON AND UNION COUNTIES

Prepared By:	<i>Joe Zdaniewicz</i> DISTRICT STUDIES & PLANS ENGINEER
Examined By:	<i>James E. Eng</i> DISTRICT LAND ACQUISITION ENGINEER
Examined By:	<i>Carrie Nelson</i> DISTRICT PROGRAM DEVELOPMENT ENGINEER
Examined By:	<i>Kevin Hammes</i> DISTRICT OPERATIONS ENGINEER
Examined By:	<i>Joseph Lugin</i> DISTRICT CONSTRUCTION ENGINEER
Examined By:	<i>Bruce W. Peck</i> DISTRICT MATERIALS ENGINEER
Examined By:	<i>Jim Swisher</i> DISTRICT PROJECT IMPLEMENTATION ENGINEER
Examined By:	<i>Ray L. Clayton</i> ASSISTANT REGIONAL ENGINEER
Approved By:	<i>Mike Crumley</i> DEPUTY DIRECTOR OF HIGHWAYS, REGION ENGINEER
	DATE <i>Jan 22 20 08</i>

SIGNATURE SHEET

PLOT DATE = 12/27/2007
FILE NAME = c:\pvc\proj\va\984687\va.scdgn
PLOT SCALE = 1/8"=1'-0"
USER NAME = mcorrad@

F.A.I. RTE.	SECTION	COUNTY	TOTAL SHEETS	SHEET NO.
*	**	***	22	3
STA. _____		TO STA. _____		
FED. ROAD DIST. NO. _____		ILLINOIS FED. AID PROJECT		

- FAS 1909 & FAP 322
- DS PAVEMENT PRESERVATION FY08
- JACKSON AND UNION COUNTIES

INDEX OF SHEETS

SHEET NO.	DESCRIPTION
1	COVER SHEET
2	SIGNATURE BLOCK
3	INDEX OF SHEETS; HIGHWAY STANDARDS; STRUCTURE RATINGS; GENERAL NOTES
4	SUMMARY OF QUANTITIES
5 - 7	TYPICAL SECTIONS FOR FAP 322 (US 51) LOCATION 1
8	TYPICAL SECTIONS FOR FAP 322 (US 51) LOCATION 2
9	TYPICAL SECTION FOR FAS 1909 (IL 127)
10	RESURFACING SCHEDULE
11 - 12	PAVEMENT MARKING SCHEDULE - LOCATION 1 AND 2
13	PAVEMENT MARKING SCHEDULE - LOCATION 3
14	RAISED REFLECTIVE PAVEMENT MARKERS SCHEDULES
15	LOCATION MAP - FAP 322 (US 51) LOCATION 1 & 2 FROM INTERSECTION OF IL. 146 SOUTH TO I-57 CONNECTOR
16	LOCATION MAP - FAS 1909 (IL. 127) FROM TOMCAT LANE SOUTH TO THE UNION/JACKSON COUNTY LINE.
17 - 20	DETAIL - PAVEMENT MARKING ON FAP 322 (US 51) LOCATION 1 FROM STA. 1000+33 TO STA. 1047+55.55.
21 - 22	DETAIL - PAVEMENT MARKING ON FAP 322 (US 51) LOCATION 2 FROM STA. 365+98 TO STA. 378+65.

GENERAL NOTES

FACTORS USED FOR ESTIMATING PLAN QUANTITIES ARE AS FOLLOWS AND SHALL NOT BE USED FOR THE BASIS OF FINAL QUANTITIES EXCEPT FOR QC/QA OF BITUMINOUS MIXTURES:

ALL BITUMINOUS CONCRETE.....2.016 TONS/CU.YD.
 ALL AGGREGATE.....2.05 TONS/CU.YD.

BITUMINOUS MATERIALS (PRIME COAT)
 ON PAVEMENT.....0.09 GAL/SQ YD

AGGREGATE (PRIME COAT).....0.0015 TONS/SQ. YD.

THE QUANTITY OF SHORT TERM PAVEMENT MARKING SHOWN IN THE PLANS WAS BASED ON ONE APPLICATION EACH FOR 1 LAYER FOR THE PRIME COAT AND 2 LAYERS OF SURFACE TREATMENT.

PRIOR TO PLACEMENT OF THE FINAL PAVEMENT MARKINGS THE RESIDENT ENGINEER SHOULD CONTACT THE BUREAU OF OPERATIONS AND ARRANGE FOR INSPECTION AND APPROVAL OF THE PAVEMENT MARKING LAYOUT.

THE CONTRACTOR SHALL PRESERVE EXISTING STAMPED STATIONING.

THE AGGREGATE TO BE USED IN THE MICRO-SURFACING SHALL BE TYPE II APPLIED AT 16 LB/SQ YD PER PASS.

BITUMINOUS MATERIAL (PRIME COAT) SHALL BE APPLIED PRIOR TO PLACING THE FIRST PASS OF MICRO-SURFACING AT A RATE OF 0.05 - 0.10 GAL/SQ. YD.

FIBER ASPHALT-CRACK FILLING SHALL ONLY BE PERFORMED ON CRACKS 3/8" WIDE AND GREATER. ALL CRACKS SHALL BE DRY AND FREE OF DIRT, VEGETATION, DEBRIS OR LOOSE FILLER BEFORE FILLING WITH THE FIBER ASPHALT.

HIGHWAY STANDARDS

701301-02	701901
701306-01	780001-01
701311-02	781001-02

STRUCTURE RATINGS

STRUCTURE NO.	INV. RATING	OPER. RATING	SUFF. RATING
FAP 322 (US 51) STA. 3074+60			
091-0071	27.7	44.5	93.8

PLOT DATE = 1/9/2008
 FILE NAME = c:\pvc\pva\98487\mno.dgn
 PLOT SCALE = 1/8"=1'-0" / IN.
 USER NAME = mcorcor

F.A.I. RTE.	SECTION	COUNTY	TOTAL SHEETS	SHEET NO.
*	**	***	22	4
STA. _____		TO STA. _____		
FED. ROAD DIST. NO. _____		ILLINOIS FED. AID PROJECT		

- FAS 1909 & FAP 322
- D9 PAVEMENT PRESERVATION FY08
- JACKSON AND UNION COUNTIES

SUMMARY OF QUANTITIES

CODE NUMBER	ITEM DESCRIPTION	UNIT	TOTAL QUANTITY	FAP 322 (US 51) IL 146 TO BODY BARN RD.	FAP 322 (US 51) BODY BARN RD. TO I-57 CONNECTOR	FAS 1909 (IL 127) TOMCAT LN. TO UNION/JACKSON CO. LINE
				LOC. 1 RURAL	LOC. 2 RURAL	LOC. 3 RURAL
				100% STATE	100% STATE	100% STATE
				MICROSURFACING UNION	MICROSURFACING UNION	MICROSURFACING JACKSON
				I000	I000	I000
				QUANTITY	QUANTITY	QUANTITY
X0325223	FIBER ASPHALT	POUND	69,330	33386	19613	16331
X4480205	MICRO-SURFACING, 2 PASSES, TYPE 2	SQ YD	198,426	84126	50792	63508
Z0040315	PILOT CAR	DAY	8	2	2	4
40600100	BITUMINOUS MATERIALS (PRIME COAT)	GALLON	17,858.2	7571.3	4571.2	5715.7
67100100	MOBILIZATION	L SUM	1	0.3	0.3	0.4
70100460	TRAFFIC CONTROL AND PROTECTION, STANDARD 701306	L SUM	1	0.3	0.3	0.4
70300100	SHORT-TERM PAVEMENT MARKING	FOOT	19,300	7841	4600	6859
70300210	TEMPORARY PAVEMENT MARKING, LETTERS ^{AND} SYMBOLS	SQ FT	254.8	182.0	72.8	
70300220	TEMPORARY PAVEMENT MARKING - LINE 4"	FOOT	210,451	79383	41841	89227
70300260	TEMPORARY PAVEMENT MARKING - LINE 12"	FOOT	1,133	694	439	
70300280	TEMPORARY PAVEMENT MARKING - LINE 24"	FOOT	66	66		
70301000	WORK ZONE PAVEMENT MARKING REMOVAL	SQ FT	75,818	28784	15326	31708
* 78000100	THERMOPLASTIC PAVEMENT MARKING - LETTERS ^{AND} SYMBOLS	SQ FT	254.8	182.0	72.8	
* 78001110	PAINT PAVEMENT MARKING - LINE 4"	FOOT	210,451	79383	41841	89227
* 78001150	PAINT PAVEMENT MARKING - LINE 12"	FOOT	1,133	694	439	
* 78001180	PAINT PAVEMENT MARKING - LINE 24"	FOOT	66	66		
* 78100100	RAISED REFLECTIVE PAVEMENT MARKER	EACH	1,012	493	229	290
78300200	RAISED REFLECTIVE PAVEMENT MARKER REMOVAL	EACH	1,012	493	229	290

* SPECIALTY ITEMS

F.A.J. RTE.	SECTION	COUNTY	TOTAL SHEETS	SHEET NO.
*	**	***	22	5
STA. _____		TO STA. _____		
FED. ROAD DIST. NO. ILLINOIS FED. AID PROJECT				

- FAS 1909 & FAP 322
- D9 PAVEMENT PRESERVATION FY08
- JACKSON AND UNION COUNTIES

FAP 322 (US 51)
LOCATION 1 TYPICALS

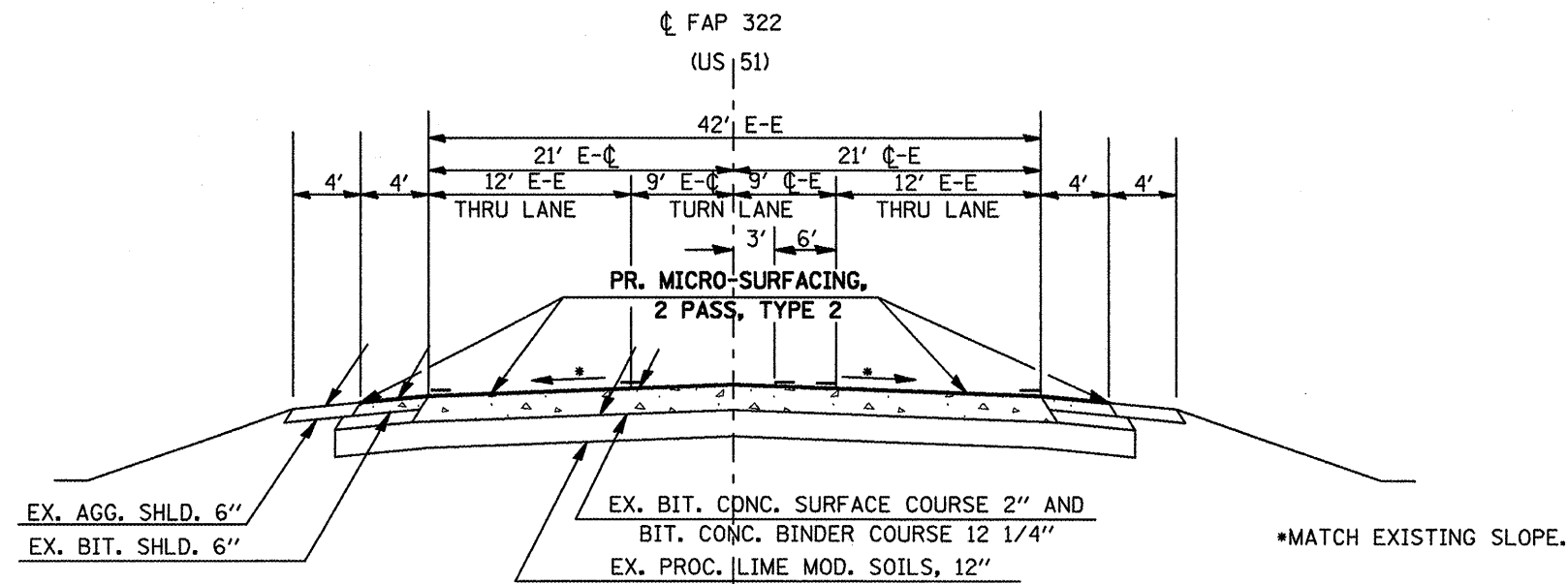

TO BE USED:
STA. 1000+33 TO STA. 1005+83 (550.0')

EQUATION STATIONS:	
EQ. STA. 1047+55.55 (BK.)	= STA. 52+01.25 (AH.)
EQ. STA. 103+30.75 (BK.)	= STA. 103+86.85 (AH.)
EQ. STA. 118+04.60 (BK.)	= STA. 2018+04.60 (AH.)
EQ. STA. 2081+73.95 (BK.)	= STA. 187+61.39 (AH.)

LOCATION 1 TOTAL LENGTH = 22,727.76' = 4.31 MILES

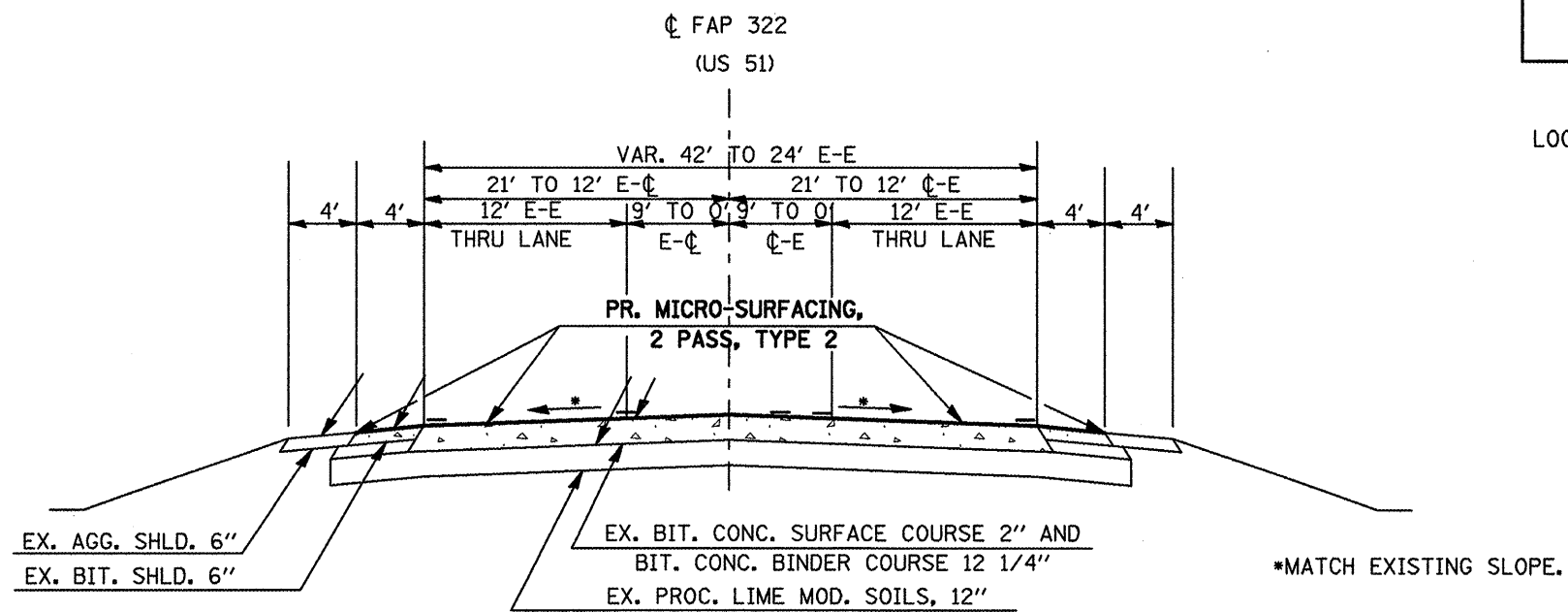

TO BE USED:
STA. 1005+83 TO STA. 1010+23 (440')

PLOT DATE = 12/27/2007
 FILE NAME = c:\projects\1005+83\1005+83.dgn
 USER NAME = jmcgovern
 USER NAME = jmcgovern

F.A. RTE.	SECTION	COUNTY	TOTAL SHEETS	SHEET NO.
*	**	***	22	6
STA. _____ TO STA. _____		FED. ROAD DIST. NO. _____ ILLINOIS FED. AID PROJECT		

- FAS 1909 & FAP 322
- D9 PAVEMENT PRESERVATION FY08
- JACKSON AND UNION COUNTIES

FAP 322 (US 51)
LOCATION 1 TYPICALS

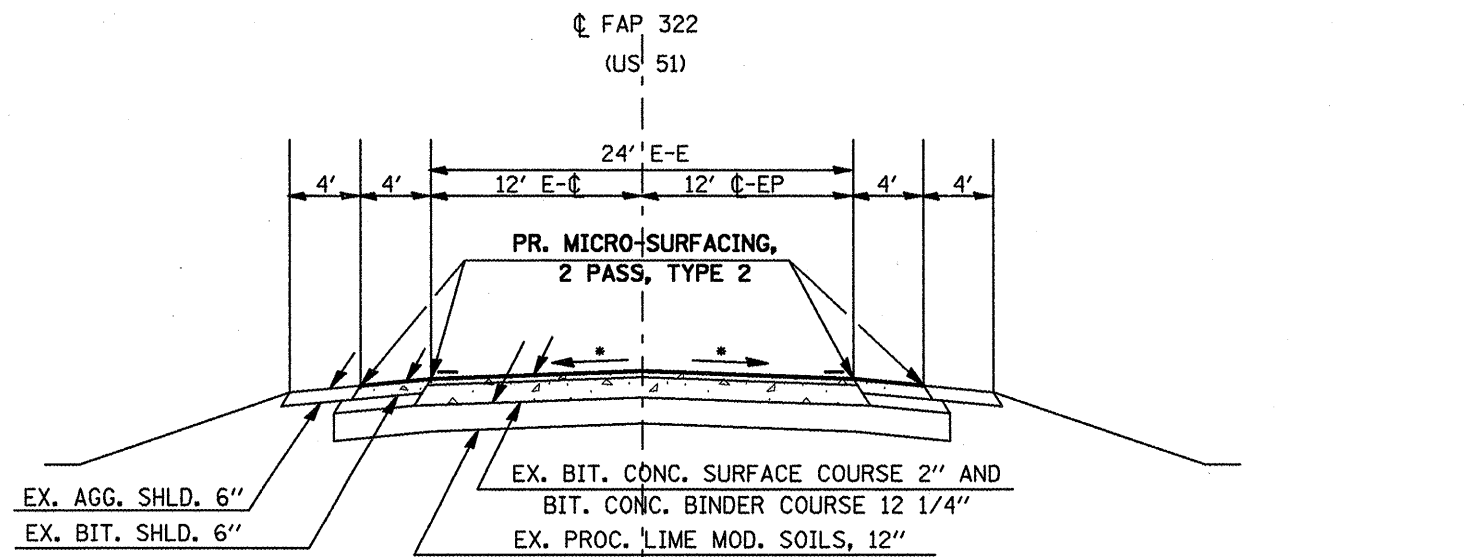

*MATCH EXISTING SLOPE.

TO BE USED:

- STA. 1010+23 TO STA. 1028+79 (1856.0')
- STA. 1044+78 TO STA. 1047+55.55 (277.55')
- STA. 52+01.25 TO STA. 103+30.75 (5129.5')
- STA. 103+86.85 TO STA. 118+04.60 (1417.75')
- STA. 2018+04.60 TO STA. 2081+73.95 (6369.35')
- STA. 187+61.39 TO STA. 238+50 (5088.61')

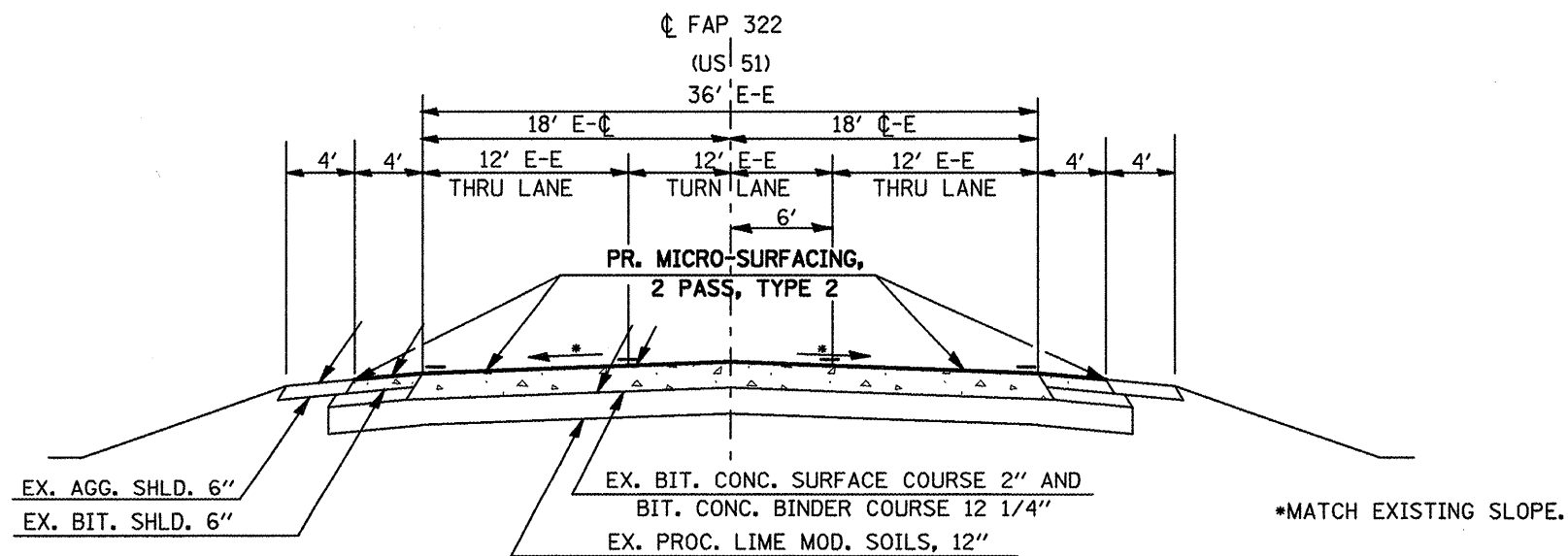

*MATCH EXISTING SLOPE.

TO BE USED:

- STA. 1031+10.21 TO STA. 1041+73 (1062.79')

PLOT DATE = 12/27/2007
 FILE NAME = c:\pvc\jms\78017\1807.mxd
 PLOT SCALE = 1/8" = 1'-0"
 USER NAME = jms

F.A.I. RTE.	SECTION	COUNTY	TOTAL SHEETS	SHEET NO.
*	**	***	22	7
STA. _____		TO STA. _____		
FED. ROAD DIST. NO. _____		ILLINOIS FED. AID PROJECT		

- FAS 1909 & FAP 322
- ** D9 PAVEMENT PRESERVATION FY08
- *** JACKSON AND UNION COUNTIES

FAP 322 (US 51)
LOCATION 1 TYPICALS

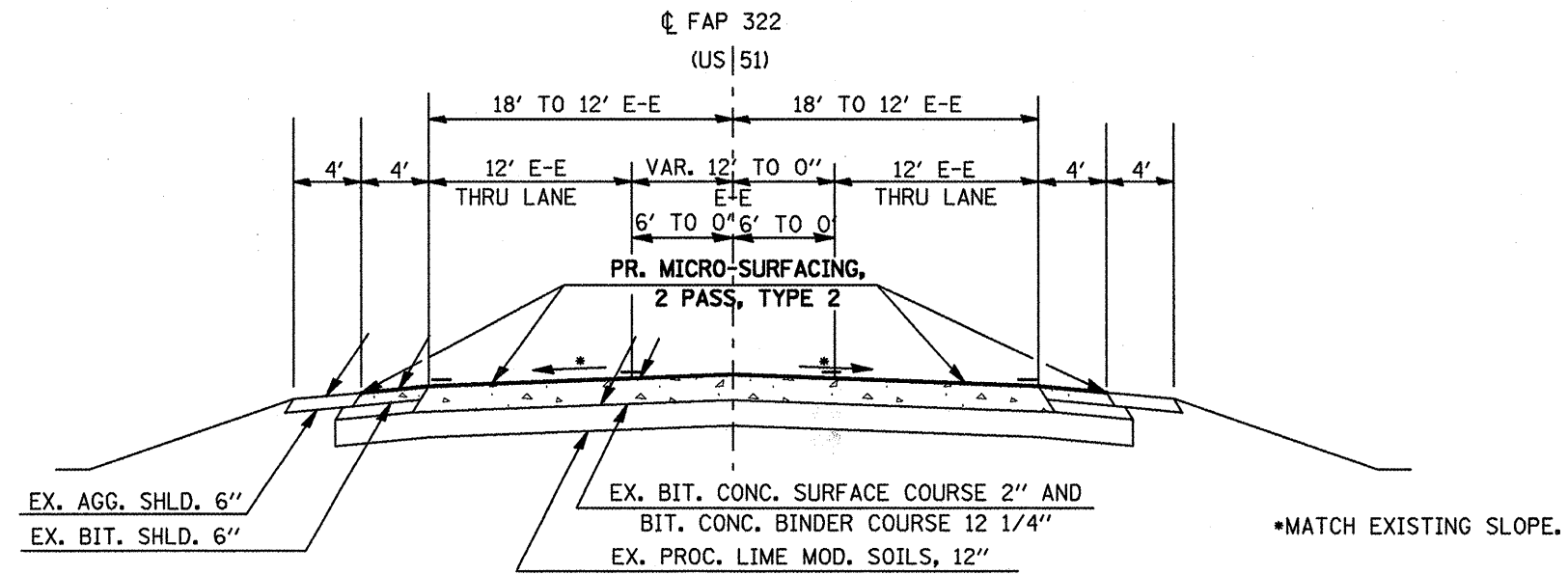

TO BE USED:
STA. 1041+73 TO STA. 1044+78 (305')

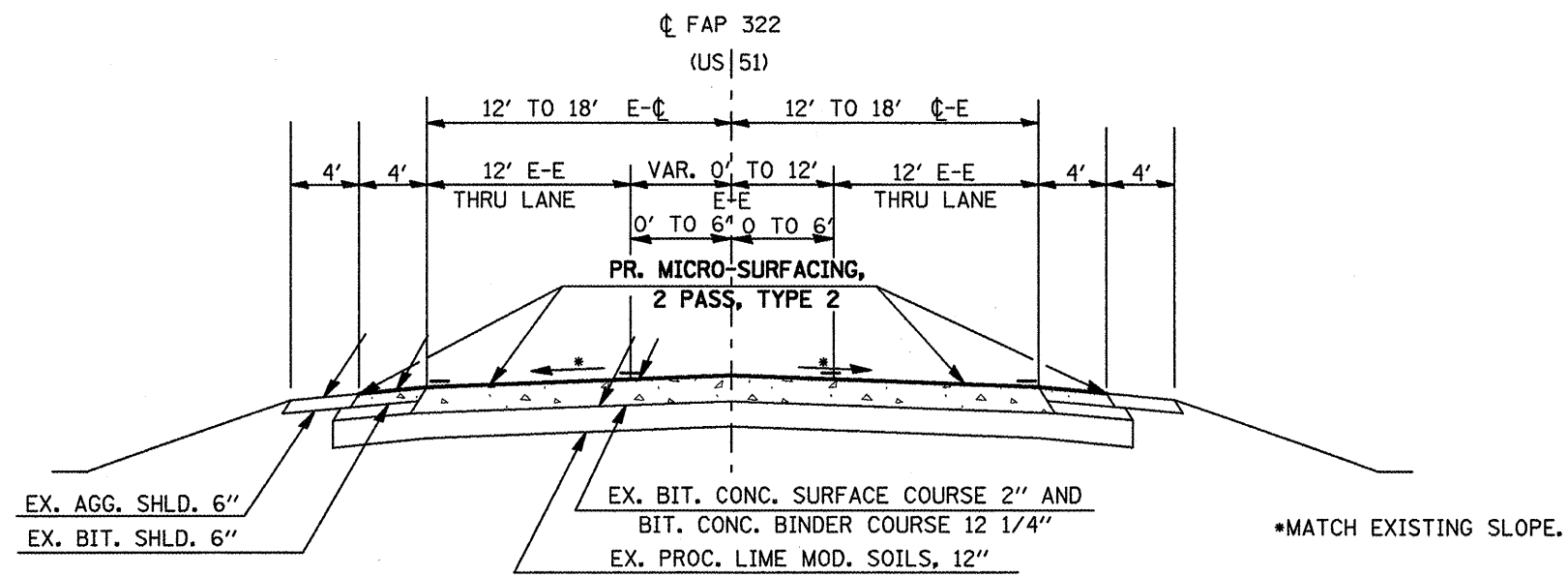

TO BE USED:
STA. 1028+79 TO STA. 1031+10.21 (231.21')

PLOT DATE
 PLOT SCALE
 PLOT NAME
 USER NAME

F.A.I. RTE.	SECTION	COUNTY	TOTAL SHEETS	SHEET NO.
*	**	***	22	8
STA. _____		TO STA. _____		
FED. ROAD DIST. NO. _____		ILLINOIS FED. AID PROJECT _____		

FAP 322 (US 51)
LOCATION 2 TYPICALS

- FAS 1909 & FAP 322
- ** D9 PAVEMENT PRESERVATION FY08
- *** JACKSON AND UNION COUNTIES

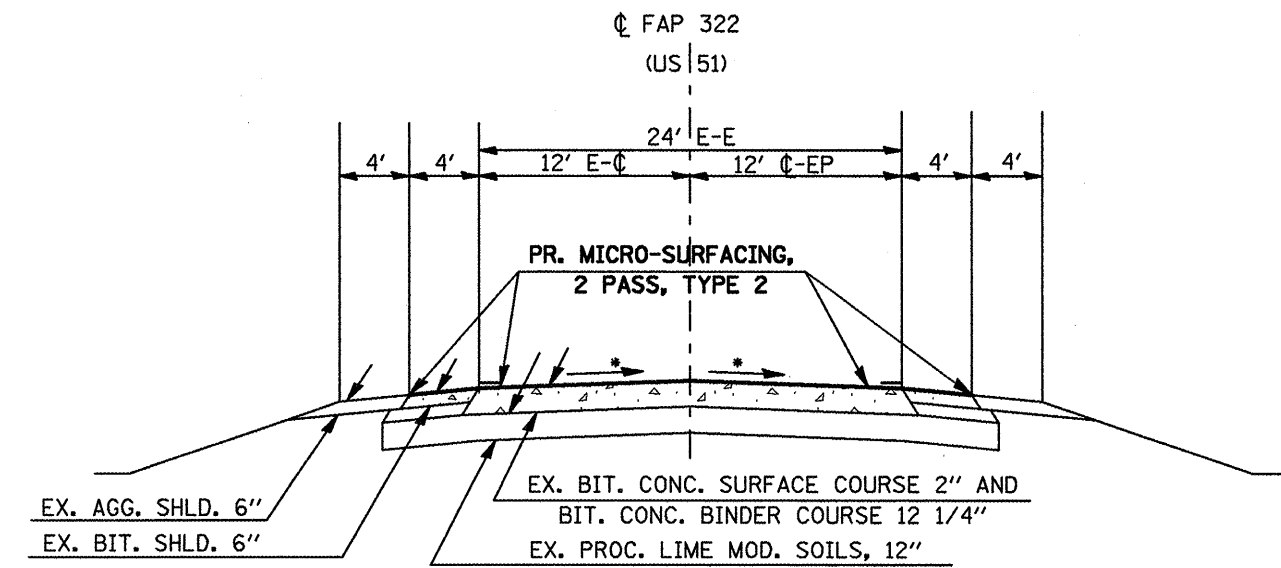

EX. AGG. SHLD. 6"
EX. BIT. SHLD. 6"

EX. BIT. CONC. SURFACE COURSE 2" AND
BIT. CONC. BINDER COURSE 12 1/4"
EX. PROC. LIME MOD. SOILS, 12"

*MATCH EXISTING SLOPE.

TO BE USED:

- STA. 238+50 TO STA. 240+04.17 (154.17')
- STA. 3040+04.17 TO STA. 3073+50 (3345.83')
- STA. 3075+71 TO STA. 3101+03.20 (2532.2')
- STA. 304+62.66 TO STA. 365+98 (6135.34')

EQUATION STATIONS:
EQ. STA. 240+04.17 (BK.) = STA. 3040+04.17 (AH.)
EQ. STA. 3101+03.20 (BK.) = STA. 304+62.66 (AH.)

OMISSION STATIONS:
STA. 3073+50 TO STA. 3075+71 (S.N. 091-0071)

LOCATION 2 TOTAL LENGTH = 13,434.54' = 2.54 MILES

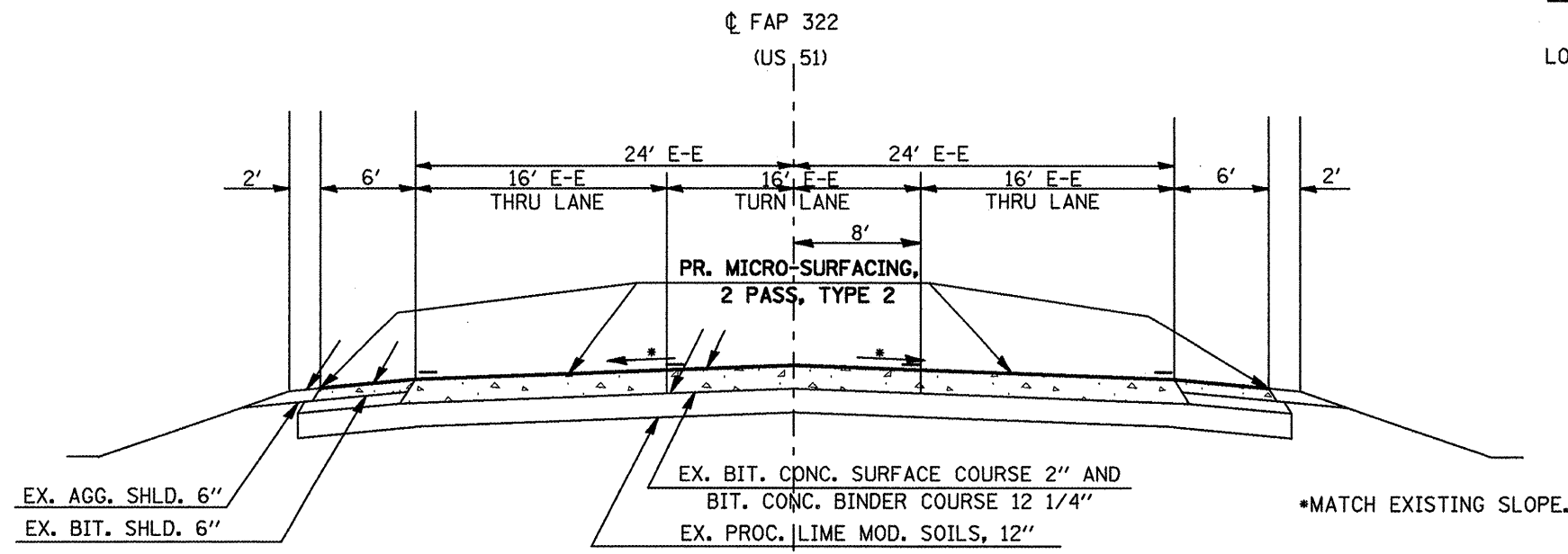

EX. AGG. SHLD. 6"
EX. BIT. SHLD. 6"

EX. BIT. CONC. SURFACE COURSE 2" AND
BIT. CONC. BINDER COURSE 12 1/4"
EX. PROC. LIME MOD. SOILS, 12"

*MATCH EXISTING SLOPE.

TO BE USED:

- STA. 365+98 TO STA. 378+65 (1267.0')

PLOT DATE = 12/27/2007
 FILE NAME = c:\pvc\pva\981487\mso.dgn
 PLOT SCALE = 1/8"=1'-0"
 USER NAME = mcorcoran

F.A.I. RTE.	SECTION	COUNTY	TOTAL SHEETS	SHEET NO.
*	**	***	22	9
STA. _____		TO STA. _____		
FED. ROAD DIST. NO. _____		ILLINOIS FED. AID PROJECT _____		

- * FAS 1909 & FAP 322
- ** D9 PAVEMENT PRESERVATION FY08
- *** JACKSON AND UNION COUNTIES

FAS 1909 (IL 127)
TYPICAL
LOCATION 3

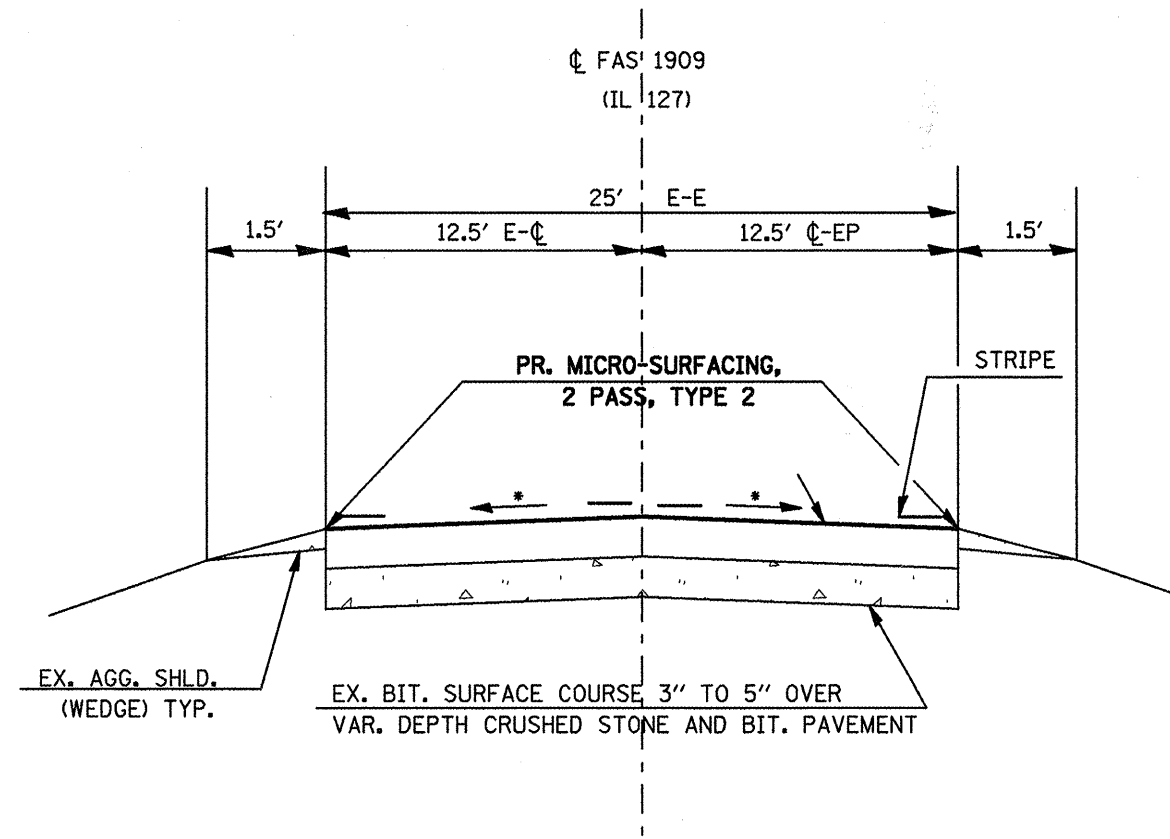

EQUATION STATIONS:
EQ. STA. 344+07.40 (BK.) = STA. 6+06.70 (AH.)
EQ. STA. 79+77.70 (BK.) = STA. 80+07.70 (AH.)
EQ. STA. 138+96.20 (BK.) = STA. 139+83.10 (AH.)

ILL. 127 TOTAL LENGTH = 22,862.8' = 4.33 MILES

TO BE USED:

- STA. 335+53 TO STA. 344+07.40 (854.4')
- STA. 6+06.70 TO STA. 79+77.70 (7371.0')
- STA. 80+07.70 TO STA. 138+96.20 (5888.5')
- STA. 139+83.10 TO STA. 227+32 (8748.9')

*MATCH EXISTING SLOPE.

PLOT DATE = 12/27/2007
PLOT SCALE = 1/8" = 1'-0"
USER NAME = masonbr

F.A.I. RTE.	SECTION	COUNTY	TOTAL SHEETS	SHEET NO.
*	**	***	22	10

STA. _____ TO STA. _____
 FED. ROAD DIST. NO. _____ ILLINOIS FED. AID PROJECT

- FAS 1909 & FAP 322
- D9 PAVEMENT PRESERVATION FY08
- JACKSON AND UNION COUNTIES

RESURFACING SCHEDULE

LOCATION - STATION TO STATION			LENGTH	ROADWAY WIDTH	ROADWAY AREA	SHOULDER WIDTH	MICRO-SURF., 2 PASS, TY. 2 SHOULDER AREA	MICRO-SURF., 2 PASS, TY. 2 PAVEMENT AREA	BIT. MATLS. (PR. CT.) (SEE NOTE 2)	FIBER- ASPHALT (SEE NOTE 1)	NOTES
			FOR INFORMATIONAL PURPOSE ONLY					(SQ YD)	(SQ YD)	(GAL)	
			(FT)	(FT)	(SQ YD)	(FT)	(SQ YD)	(SQ YD)	(GAL)	(POUND)	
FAS 1090 (IL 127) LOCATION 3											
335+53	TO	344+07	854.4	25.0	2373			2373	213.6	610	AGG. SHLDS.
6+07	TO	79+78	7371.0	25.0	20,475			20475	1842.8	5,265	AGG. SHLDS.
80+08	TO	138+96	5888.5	25.0	16,357			16357	1472.1	4,206	AGG. SHLDS.
139+83	TO	227+32	8748.9	25.0	24,303			24,303	2187.2	6,250	AGG. SHLDS.
							0.0	63,508	5715.7	16,331	
FAP 322 (US 51) LOCATION 1											
1000+33	TO	1005+83	550.0	42.0	2567	4.0	489	2,567	275.0	786	LT. TURN LN. & MEDIAN ONLY
1000+33	TO	1010+00	967.0							345	
1005+83	TO	1010+23	440.0	33.0	1613	4.0	391	1,613	180.4	629	
1010+23	TO	1028+79	1856.0	24.0	4949	4.0	1650	4,949	593.9	2,651	
1028+79	TO	1031+10	231.0	30.0	770	4.0	205	770	87.8	330	
1028+79	TO	1044+78	1599.0							571	LT. TURN LN. & MEDIAN ONLY
1031+10	TO	1041+73	1063.0	36.0	4252	4.0	945	4,252	467.7	1,519	
1041+73	TO	1044+78	305.0	30.0	1017	4.0	271	1,017	115.9	436	
1044+78	TO	1047+56	278.0	24.0	741	4.0	247	741	89.0	397	
52+01.25	TO	103+30.75	5129.5	24.0	13,679	4.0	4560	13,679	1641.4	7,328	BIT. SHLDS.
103+86.85	TO	118+04.60	1417.8	24.0	3780.7	4.0	1260	3,781	453.7	2,025	BIT. SHLDS.
2018+04.60	TO	2081+73.95	6369.4	24.0	16,985	4.0	5662	16,985	2038.2	9,099	BIT. SHLDS.
187+61.39	TO	238+50.00	5088.6	24.0	13,570	4.0	4523	13,570	1628.4	7,270	BIT. SHLDS.
							20,203	63,923	7571.3	33,386	
FAP 322 (US 51) LOCATION 2											
238+50	TO	240+04.17	154.2	24	411	4.0	137	411	49.3	220	BIT. SHLDS.
3040+04.17	TO	3073+50	3345.8	24.0	8922	4.0	2974	8922	1070.7	4,780	BIT. SHLDS.
3075+71	TO	3101+03.20	2532.2	24	6753	4.0	2251	6753	810.3	3617	BIT. SHLDS.
304+62.66	TO	365+98	6135.3	24	16,361			16,361	1472.5	4454	
365+98	TO	378+65	1267	32	4505			4505	405.4	834	
365+98	TO	371+98	600	8	533			533	48.0	179	TURN LANES
371+98	TO	378+65	667	16	1186			1186	106.7	238	TURN LANES
304+63	TO	374+78	7015			4.0	6236		561.2	5011	4' BIT. SHLDS.
374+73	TO	378+65	392			6.0	523		47.1	280	6' BIT. SHLDS.
							12,121	38,671	4571.2	19,613	
							50,792	17,858	69,330		
							198,426	17,858	69,330		

Note 1: Fiber-Asphalt is calculated using 1 lb. of material per 2.8 lineal foot. Then 2 strips on IL 127 locations and 4 strips on US 51 locations through the length of the project, unless otherwise noted on plans.

Note 2: Bituminous Materials (Prime Coat) quantity includes shoulder and pavement area.

PLOT DATE = 1/28/2008
 FILE NAME = c:\pva\mva\0964877\mva09n.dgn
 USER NAME = mva09n
 USER NAME = mva09n

FAP 322 (US 51) PAVEMENT MARKING SCHEDULE
LOCATION 1

F.A.T. RTE.	SECTION	COUNTY	TOTAL SHEETS	SHEET NO.
*	**	***	22	11
STA.		TO STA.		
FED. ROAD DIST. NO. ILLINOIS FED. AID PROJECT				
* FAS 1909 & FAP 322				
** D9 PAVEMENT PRESERVATION FY08				
*** JACKSON AND UNION COUNTIES				

STATION TO STATION	PAINT PAVEMENT MARKING					THPL PAV'T MARKING	TEMPORARY			NOTES		
	4 INCH WHITE	4 INCH YELLOW	4 INCH SKIP-DASH YELLOW	12 INCH WHITE	24 INCH WHITE	LETTERS & SYMBOLS	4 INCH	12 INCH	24 INCH		LETTERS & SYMBOLS	
	FOOT	FOOT	FOOT	FOOT	FOOT	SQ FT	FOOT	FOOT	FOOT		SQ FT	
US 51- STA. 1000+33 TO STA. 238+50												
RT	1000+41.0 TO 1000+56.0						82.0				ISLAND STRIPING	
RT	1000+50.0 TO 1010+23.0			482.0	20.0			482.0	20.0		MEDIAN STOP BAR	
RT	1001+09.0 TO 1031+44.5						3,036				EDGE LINE	
	1011+64.0 TO 1027+93.0		407				407					
	1028+79.0 TO 1032+07.0			84.0				84.0			MEDIAN	
RT	1033+07.5 TO 1037+95.0						488				EDGE LINE	
RT	1039+14.0 TO 1047+55.6						842				EDGE LINE	
	1039+93.0 TO 1044+78.0			128.0				128.0			MEDIAN	
EQ STA 1047+55.55 (BK) = STA 52+01.25 (AH)												
RT	52+01.3 TO 103+30.8						5130				EDGE LINE	
	64+21.6 TO 71+91.0			192				192				
	72+47.0 TO 81+81.0			234				234				
EQ STA 103+30.75 (BK) = STA 103+86.85 (AH)												
	103+86.9 TO 118+04.6						1418				EDGE LINE	
	116+31.0 TO 118+04.6		43					43				
EQ STA 118+04.60 (BK.) = STA. 2018+04.60 (AH.)												
	2018+04.6 TO 2081+74.0			1592			6369				EDGE LINE	
EQ STA 2081+73.95 (BK) = STA 187+61.39 (AH)												
RT	187+61.4 TO 238+50.0						5,089				EDGE LINE	
	187+61.4 TO 188+59.0			25				25				
	227+16.0 TO 238+50.0			284				284				
LT	1000+49.0 TO 1000+46.0				12.0				12.0		STOP BAR	
LT	1000+34.0 TO 1000+46.0				18.0		78				ISLAND STRIPING	
LT	1000+36.0 TO 1000+44.0				16.0				18.0		STOP BAR	
LT	1000+44.0 TO 1000+44.0								16.0		STOP BAR	
LT	1000+94.0 TO 1038+00.0						3,706				EDGE LINE	
LT	1039+12.0 TO 1047+55.6			844			844				EDGE LINE	
LT	52+01.3 TO 103+30.8			5130			5,130				EDGE LINE	
LT	103+86.9 TO 118+04.6			1418			1,418				EDGE LINE	
LT	2018+04.6 TO 2081+74.0			6369			6,369				EDGE LINE	
LT	187+61.4 TO 238+50.0			5089			5,089				EDGE LINE	
	1000+50.0 TO 1010+23.0		3,892					3,892			NO PASSING ZONE	
	1010+23.0 TO 1011+64.0		282					282			NO PASSING ZONE	
	1027+93.0 TO 1028+79.0		172					172			NO PASSING ZONE	
	1028+79.0 TO 1032+07.0		1312					1,312			NO PASSING ZONE	
	1032+50.0 TO 1038+20.0		1140					1,140			NO PASSING ZONE	
	1038+93.0 TO 1039+93.0		200					200			NO PASSING ZONE	
	1039+93.0 TO 1044+78.0		1940					1,940			NO PASSING ZONE	
LT	1044+78.0 TO 1047+55.6		278					278			NO PASSING ZONE	
LT	52+01.3 TO 72+47.0		2046					2,046			NO PASSING ZONE	
LT	81+81.0 TO 103+30.8		2150					2,150			NO PASSING ZONE	
LT	103+86.9 TO 118+04.6		1418					1,418			NO PASSING ZONE	
LT	2018+04.6 TO 2020+16.0		211					211			NO PASSING ZONE	
LT	188+59.0 TO 238+19.0		4960					4,960			NO PASSING ZONE	
RT	1044+78.0 TO 1047+55.6		278					278			NO PASSING ZONE	
RT	52+01.3 TO 64+21.6		1220					1,220			NO PASSING ZONE	
RT	71+91.0 TO 103+30.8		3140					3,140			NO PASSING ZONE	
RT	103+86.9 TO 116+31.0		1244					1,244			NO PASSING ZONE	
RT	2071+57.0 TO 2081+74.0		1017					1,017			NO PASSING ZONE	
RT	187+61.4 TO 227+16.0		3955					3,955			NO PASSING ZONE	
LT	1000+50.0 TO 1003+13.0		263.0					263.0			TURN LANE	
LT	1032+50.0 TO 1034+50.0		200.0					200.0			TURN LANE	
RT	1037+20.0 TO 1038+20.0		100.0					100.0			TURN LANE	
LT	1038+93.0 TO 1039+93.0		100.0					100.0			TURN LANE	
LT	1001+17.0					15.6				15.6	LT TURN ARROW	
LT	1001+45.0					20.8				20.8	"ONLY"	
LT	1002+67.0					15.6				15.6	LT TURN ARROW	
LT	1002+95.0					20.8				20.8	"ONLY"	
LT	1034+06.0					15.6				15.6	LT TURN ARROW	
LT	1034+34.0					20.8				20.8	"ONLY"	
RT	1037+30.0					20.8				20.8	"ONLY"	
RT	1037+58.0					15.6				15.6	LT TURN ARROW	
LT	1039+47.0					15.6				15.6	LT TURN ARROW	
LT	1039+75.0					20.8				20.8	"ONLY"	
SUB-TOTALS			45,751	30,855	2,777	694.0	66.0	182.0	79,383	694.0	66.0	182.0
TOTALS AT US 51 LOCATION 1				79,383		694	66	182.0	79,383	694	66	182.0

PLT DATE = 12/27/2007
 PLT TIME = 10:58:48 AM
 PLT SCALE = 1"=40'
 USER NAME = masonr

F.A.I. RTE.	SECTION	COUNTY	TOTAL SHEETS	SHEET NO.
*	**	***	22	12
STA.		TO STA.		
FED. ROAD DIST. NO. ILLINOIS FED. AID PROJECT				

FAP 322 (US 51) PAVEMENT MARKING SCHEDULE
LOCATION 2

- * FAS 1909 & FAP 322
- ** D9 PAVEMENT PRESERVATION FY08
- *** JACKSON AND UNION COUNTIES

STATION TO STATION	PAINT PAVEMENT MARKING					THPL PAY'T MARKING	TEMPORARY				NOTES														
	4 INCH WHITE	4 INCH YELLOW	4 INCH SKIP-DASH YELLOW	12 INCH WHITE	24 INCH WHITE	LETTERS & SYMBOLS	4 INCH	12 INCH	24 INCH	LETTERS & SYMBOLS															
	FOOT	FOOT	FOOT	FOOT	FOOT	SQ FT	FOOT	FOOT	FOOT	SQ FT															
US 51 - STA. 238+50 TO STA. 378+65																									
LT & RT	238+50.0	TO	240+04.2				308				347			EDGE LINE											
EQ STA 240+04.17 (BK.) = STA. 3040+04.17 (AH.)																									
	3040+04.2	TO	3051+50.0								286														
LT & RT	3040+04.2	TO	3073+50.0				6692				6,692			EDGE LINE											
	3058+28.0	TO	3073+50.0								381														
OMIT SN 091-0071 STA. 3073+50 TO STA. 3075+71																									
	3075+71.0	TO	3097+65.0								549														
LT & RT	3075+71.0	TO	3101+03.2				5064				5064			EDGE LINE											
	3098+84.0	TO	3101+03.2								55														
EQ STA 3101+03.20 (BK.) = STA. 304+62.66 (AH.)																									
	304+62.7	TO	331+78.0								679														
LT	304+62.7	TO	374+80.0				7017				7,017														
RT	304+62.7	TO	374+13.0				6,950				6,950			EDGE LINE											
	344+67.0	TO	367+07.0								560														
LT	375+63.0	TO	378+65.0				302				302														
RT	376+44.3	TO	378+65.0				221				221			EDGE LINE											
	3051+50.0	TO	3069+31.0								1,781			NO PASSING ZONE											
LT	3097+65.0	TO	313+29.0								1,205			NO PASSING ZONE											
LT	331+78.0	TO	344+85.0								1,307			NO PASSING ZONE											
LT	365+98.0	TO	366+98.0								100			NO PASSING ZONE											
LT	366+98.0	TO	373+78.0								1,360			NO PASSING ZONE											
LT	373+78.0	TO	374+78.0								200			NO PASSING ZONE											
LT	375+73.0	TO	376+73.0				100.0				100			LEFT TURN LANE											
	3041+83.0	TO	3058+28.0								1,645			NO PASSING ZONE											
RT	3087+30.0	TO	3098+84.0								1,154			NO PASSING ZONE											
RT	321+09.0	TO	334+67.0								1,358			NO PASSING ZONE											
RT	365+98.0	TO	366+98.0								100														
RT	366+98.0	TO	373+78.0								1,360														
RT	366+98.0	TO	373+78.0								310.0			NO PASSING ZONE											
RT	373+78.0	TO	374+78.0				100.0				100			LEFT TURN LANE											
RT	375+73.0	TO	376+73.0								200			NO PASSING ZONE											
RT	376+73.0	TO	378+65.0								768			NO PASSING ZONE											
	373+88.0										20.8			"ONLY"											
RT	374+16.0										15.6			LT TURN ARROW											
LT	376+27.0										15.6			LT TURN ARROW											
LT	376+55.0										20.8			"ONLY"											
SUB-TOTALS																									
							26,754				12,538.0			2,549.0	439.0	0.0	72.8		41,841		439.0		72.8		
TOTALS AT US 51 LOCATION 2																									
											41,841			439		0	72.8		41,841		439		0	72.8	

FAP 322 (US 51) PAVEMENT MARKING SCHEDULE
TOTALS FOR LOCATION 1 AND LOCATION 2

	PAINT PVT MRK - LINE 4"	PAINT PVT MRK - LINE 12"	PAINT PVT MRK - LINE 24"	THPL PVT MRK - LTR & SYM	TEMP PVT MRK - LINE 4"	TEMP PVT MRK - LINE 12"	TEMP PVT MRK - LINE 24"	TEMP PVT MRK - LTR & SYM
	FOOT	FOOT	FOOT	SQ FT	FOOT	FOOT	FOOT	SQ FT
TOTALS AT US 51 LOCATIONS 1 & 2	121,224.0	1,133.0	66.0	254.8	121,224.0	1,133.0	66.0	254.8

PLOT DATE = 12/27/2007
 FILE NAME = c:\pav\pave\p98\887\mmodgn
 USER NAME = mmodgn

F.A.I. RTE.	SECTION	COUNTY	TOTAL SHEETS	SHEET NO.
*	**	***	22	13
STA. _____		TO STA. _____		
FED. ROAD DIST. NO. _____ ILLINOIS FED. AID PROJECT				

- * FAS 1909 & FAP 322
- ** D9 PAVEMENT PRESERVATION FY08
- *** JACKSON AND UNION COUNTIES

FAS 1909 (IL 127) PAVEMENT MARKING SCHEDULE
LOCATION 3

STATION TO STATION	PAINT PAVEMENT MARKING			TEMPORARY	NOTES			
	4 INCH WHITE	4 INCH YELLOW	4 INCH SKIP-DASH YELLOW	4 INCH				
	FOOT	FOOT	FOOT	FOOT				
IL 127 - STA. 335+53 TO STA. 227+32								
LT & RT	335+53.0	TO	344+07.4	1,709	Edge Line			
EQ STA 344+07.4 (BK.) = STA. 6+06.7 (AH.)								
LT & RT	6+06.7	TO	79+77.7	14,742	Edge Line			
EQ STA 79+77.7 (BK.) = STA. 80+07.7 (AH.)								
LT & RT	80+07.7	TO	138+96.2	11,777	Edge Line			
EQ STA 138+96.2 (BK.) = STA. 139+83.1 (AH.)								
LT & RT	139+83.1	TO	227+32.0	17,498	Edge Line			
LT	335+53.0	TO	22+71.2	2,519	No Passing Zone			
LT	31+76.9	TO	131+96.1	9,989	No Passing Zone			
LT	142+64.7	TO	186+77.4	4,413	No Passing Zone			
LT	195+93.5	TO	227+32.0	3,139	No Passing Zone			
RT	335+53.0	TO	12+72.7	1,520	No Passing Zone			
RT	23+05.5	TO	118+55.0	9,520	No Passing Zone			
RT	128+73.6	TO	176+59.3	4,699	No Passing Zone			
RT	185+92.2	TO	227+32.0	4,140	No Passing Zone			
	12+72.0	TO	31+76.9	476				
	118+55.0	TO	128+73.6	255				
	131+96.2	TO	142+64.7	982				
	176+59.3	TO	185+92.2	933				
	186+77.4	TO	195+93.5	916				
SUB-TOTALS				45,726	39,939	3,562	89,227	
TOTALS				89,227	89,227			

PLOT DATE = 12/27/2007
 FILE NAME = c:\work\pave\1084887\mascdgn
 USER NAME = masonr

F.A.I.R. RTE.	SECTION	COUNTY	TOTAL SHEETS	SHEET NO.
*	**	***	22	14
STA. _____		TO STA. _____		
FED. ROAD DIST. NO. - ILLINOIS FED. AID PROJECT				
* FAS 1909 & FAP 322				
** D9 PAVEMENT PRESERVATION FY08				
*** JACKSON AND UNION COUNTIES				

US 51 LOCATIONS 1 & 2
RAISED REFLECTIVE PAVEMENT MARKERS

IL 127 LOCATION 3
RAISED REFLECTIVE PAVEMENT MARKERS

STATION TO STATION	RAISED REF PAVT MARKERS			NOTES
	CLEAR - ONE WAY	AMBER - ONE WAY	AMBER - TWO WAY	
	EACH	EACH	EACH	
US 51 LOCATION 1 - STA. 1000+33 TO STA. 238+50				
1000+34.0 TO 1000+46.0	3			PAINTED ISLAND
LT 1000+44.0 TO LT 1003+13.0	8			LANE LINE
RT 1000+41.0 TO RT 1000+56.0	3			PAINTED ISLAND
1000+50.0 TO 1010+23.0		53		MEDIAN
1010+23.0 TO 1011+64.0			8	CENTERLINE
1011+64.0 TO 1027+93.0			21	CENTERLINE
1027+93.0 TO 1028+79.0			6	CENTERLINE
1028+79.0 TO 1032+07.0		20		MEDIAN
RT 1032+50.0 TO LT 1038+20.0			32	MEDIAN
LT 1032+50.0 TO LT 1034+50.0	4			LANE LINE
RT 1037+20.0 TO RT 1038+20.0	6			LANE LINE
LT 1038+93.0 TO LT 1039+93.0	4			LANE LINE
RT 1038+93.0 TO RT 1039+93.0			8	
RT 1039+93.0 TO 1044+78.0		22		MEDIAN
1044+78.0 TO 1047+55.6			16	
EQ STA 1047+55.55 (BK) = STA 52+01.25 (AH)				
52+01.3 TO 64+21.6			63	CENTERLINE
64+21.6 TO 81+81.0			23	CENTERLINE
81+81.0 TO 103+30.8			28	CENTERLINE
EQ STA 103+30.75 (BK) = STA. 103+86.85 (AH)				
103+86.9 TO 116+31.0			17	
116+31.0 TO 118+04.6			3	CENTERLINE
EQ STA 118+04.60 (BK.) = STA. 2018+04.60 (AH.)				
2018+04.6 TO 2081+74.0			81	CENTERLINE
EQ STA 2081+73.95 (BK) = STA 187+61.39 (AH)				
187+61.4 TO 238+50.0			65	CENTERLINE
SUBTOTAL LOCATION 1				
	28	95	370	
TOTAL LOCATION 1				
		493		
US 51 LOCATION 2 - STA. 238+50 TO STA. 378+65				
238+50.0 TO 240+04.2			3	CENTERLINE
EQ STA 3040+04.17 (BK) = STA 3073+50 (S. N. 091-0071)				
3040+04.2 TO 3073+50.0			43	CENTERLINE
OMIT S. N. 091-0071 STA. 3073+50 TO STA. 3075+71				
3075+71.0 TO 3101+03.2			33	CENTERLINE
EQ STA 3101+03.02 (BK) = STA. 304+62.66 (AH)				
304+62.7 TO 365+98.0			78	CENTERLINE
365+98.0 TO 366+98.0			10	CENTERLINE
366+98.0 TO LT 374+78.0		36		MEDIAN
RT 373+78.0 TO RT 374+78.0	4			LANE LINE
LT 375+73.0 TO LT 376+73.0	4			
RT 375+73.0 TO 378+65.0		18		MEDIAN
SUBTOTAL LOCATION 2				
	8	54	167	
TOTAL LOCATION 2				
		229		
TOTALS AT US 51 LOCATION 2				
		722		

STATION TO STATION	RAISED REF PAVT MARKS	NOTES
	AMBER - TWO WAY FOOT	
IL 127 - STA. 335+53 TO STA. 227+32		
335+53.0 TO 344+07.4	12	Centerline
EQ STA 344+07.4 (BK.) = STA. 6+06.7 (AH.)		
6+06.7 TO 79+77.7	93	Centerline
EQ STA 79+77.7 (BK.) = STA. 80+07.7 (AH.)		
80+07.7 TO 138+96.2	75	Centerline
EQ STA 138+96.2 (BK.) = STA. 139+83.1 (AH.)		
139+83.1 TO 227+32.0	110	Centerline
TOTAL		
	290	

PLOT DATE = 1/24/2008
FILE NAME = c:\pavement\78017\mso.dgn
USER = jacobson, j
USER NAME = jacobson

F.A.I. RTE.	SECTION	COUNTY	TOTAL SHEETS	SHEET NO.
*	**	***	22	15
STA. _____		TO STA. _____		
FED. ROAD DIST. NO. ILLINOIS FED. AID PROJECT				

FAP 322 (US 51) LOCATION 1 & 2 MAP
FROM INTERSECTION OF IL 146 SOUTH
TO THE CONNECTOR FOR FAI 57

- FAS 1909 & FAP 322
- DS PAVEMENT PRESERVATION FY08
- JACKSON AND UNION COUNTIES

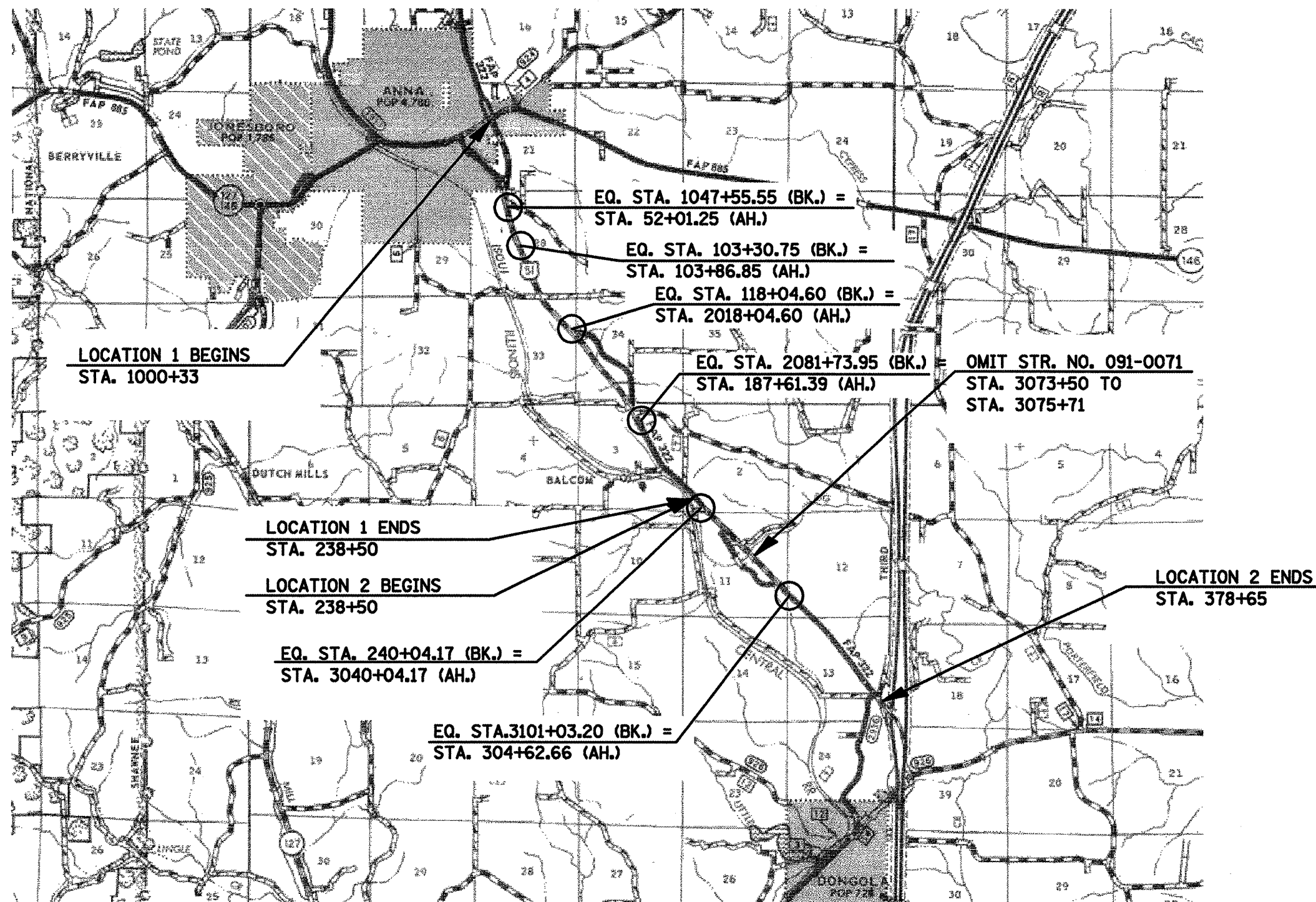

PLOT DATE = 12/27/2007
 PLOT SCALE = 1"=400'
 USER NAME = masondr

F.A.I. RTE.	SECTION	COUNTY	TOTAL SHEETS	SHEET NO.
*	**	***	22	16
STA.		TO STA.		
FED. ROAD DIST. NO. - ILLINOIS FED. AID PROJECT				

FAS 1909 (IL 127) LOCATION MAP
FROM TOMCAT HILL LN. TO JACSKON/UNION CO. LINE

- FAS 1909 & FAP 322
- D9 PAVEMENT PRESERVATION FY08
- JACKSON AND UNION COUNTIES

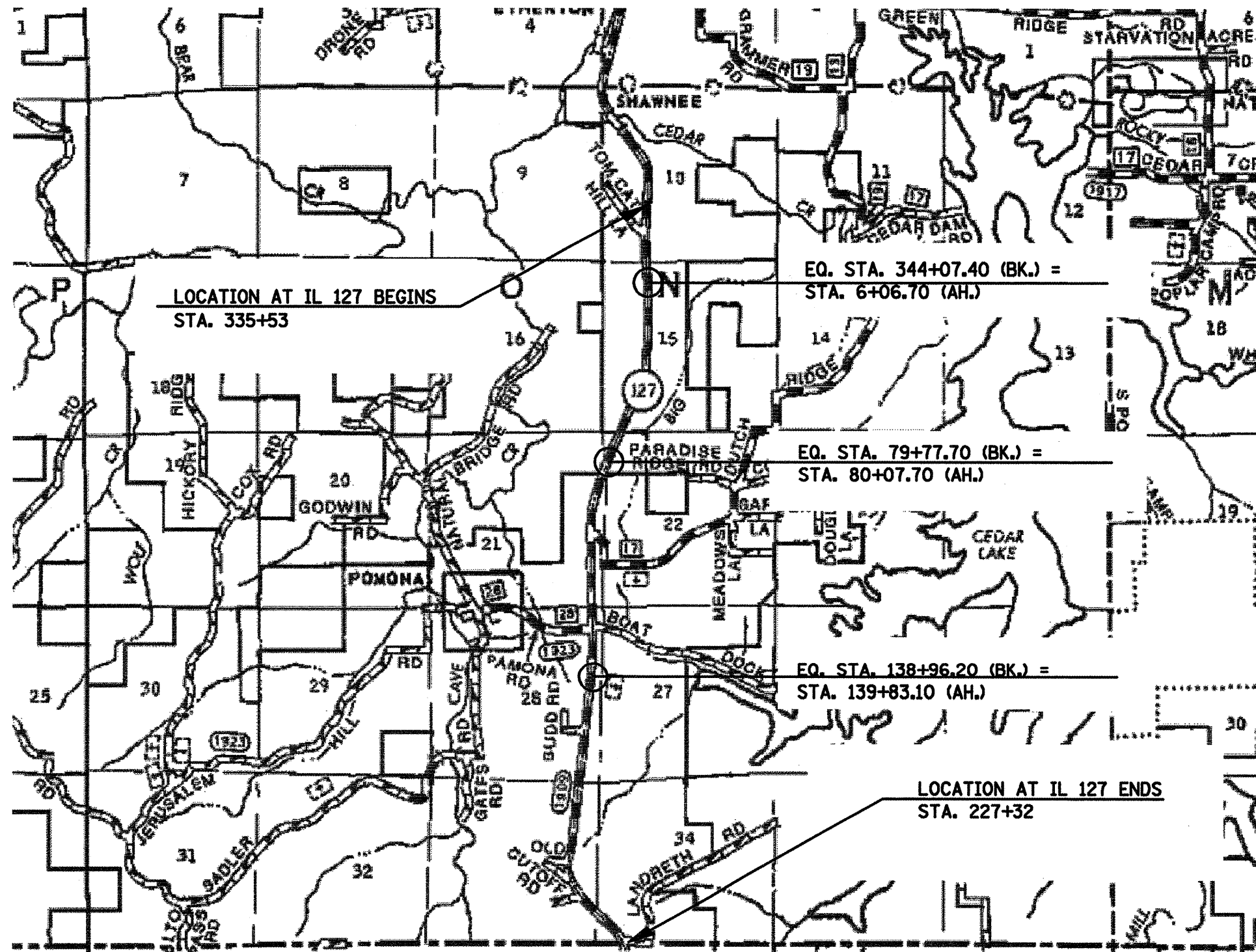

PLOT DATE = 12/27/2007
FILE NAME = c:\projects\7801z\loc3\loc3.dgn
USER NAME = mrcr

F.A.I. RTE.	SECTION	COUNTY	TOTAL SHEETS	SHEET NO.
•	••	•••	22	11
STA. _____ TO STA. _____		FED. ROAD DIST. NO. - ILLINOIS FED. AID PROJECT		

- FAS 1909 & FAP 322
- D9 PAVEMENT PRESERVATION FY08
- JACKSON AND UNION COUNTIES



DETAIL OF LANE WIDTHS

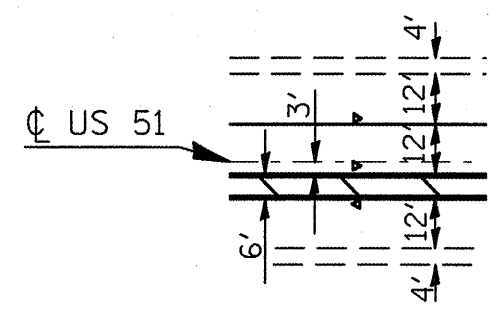

**PAVEMENT MARKING DETAIL
FAP 322 (US 51) LOCATION 1
STA. 1000+33 TO STA. 1010+44**

**PAINTED ISLAND DETAIL
SOUTHEAST QUAD**

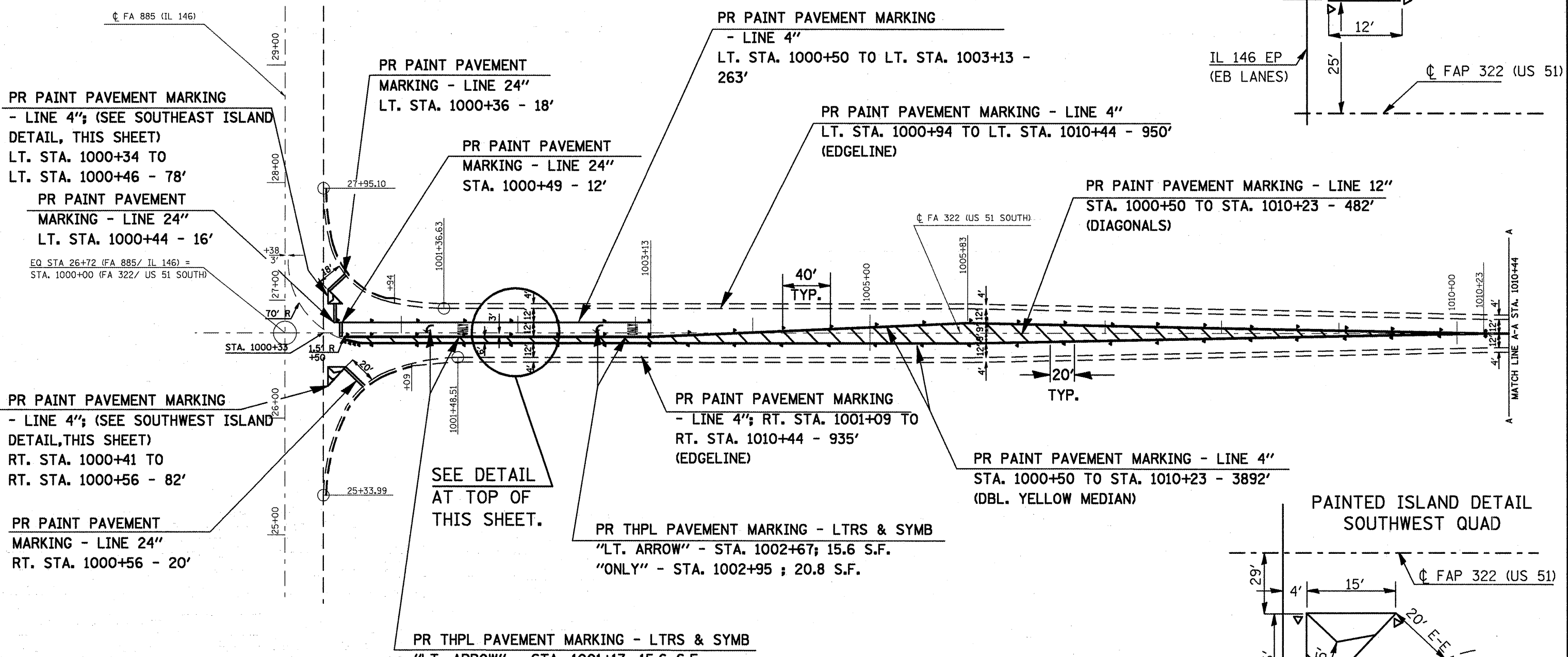
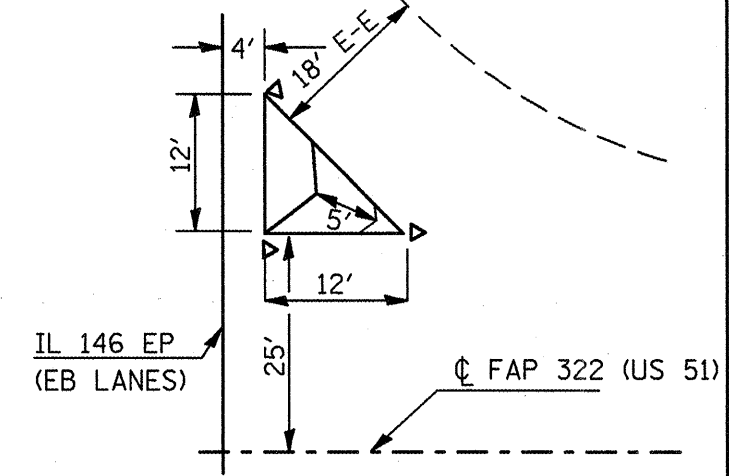

NOTE:
FOR RAISED REFLECTIVE PAVEMENT MARKERS,
SEE SCHEDULE ON SHEET 14.

PR PAINT PAVEMENT MARKING
- LINE 4"; (SEE SOUTHEAST ISLAND
DETAIL, THIS SHEET)
LT. STA. 1000+34 TO
LT. STA. 1000+46 - 78'
PR PAINT PAVEMENT
MARKING - LINE 24"
LT. STA. 1000+44 - 16'

PR PAINT PAVEMENT
MARKING - LINE 24"
LT. STA. 1000+36 - 18'

PR PAINT PAVEMENT
MARKING - LINE 24"
STA. 1000+49 - 12'

PR PAINT PAVEMENT MARKING
- LINE 4"
LT. STA. 1000+50 TO LT. STA. 1003+13 -
263'

PR PAINT PAVEMENT MARKING - LINE 4"
LT. STA. 1000+94 TO LT. STA. 1010+44 - 950'
(EDGELINE)

PR PAINT PAVEMENT MARKING - LINE 12"
STA. 1000+50 TO STA. 1010+23 - 482'
(DIAGONALS)

PR PAINT PAVEMENT MARKING
- LINE 4"; (SEE SOUTHWEST ISLAND
DETAIL, THIS SHEET)
RT. STA. 1000+41 TO
RT. STA. 1000+56 - 82'

PR PAINT PAVEMENT MARKING
- LINE 4"; RT. STA. 1001+09 TO
RT. STA. 1010+44 - 935'
(EDGELINE)

PR PAINT PAVEMENT MARKING - LINE 4"
STA. 1000+50 TO STA. 1010+23 - 3892'
(DBL. YELLOW MEDIAN)

SEE DETAIL
AT TOP OF
THIS SHEET.

PR THPL PAVEMENT MARKING - LTRS & SYMB
"LT. ARROW" - STA. 1002+67; 15.6 S.F.
"ONLY" - STA. 1002+95 ; 20.8 S.F.

PR THPL PAVEMENT MARKING - LTRS & SYMB
"LT. ARROW" - STA. 1001+17; 15.6 S.F.
"ONLY" - STA. 1001+45 ; 20.8 S.F.

**PAINTED ISLAND DETAIL
SOUTHWEST QUAD**

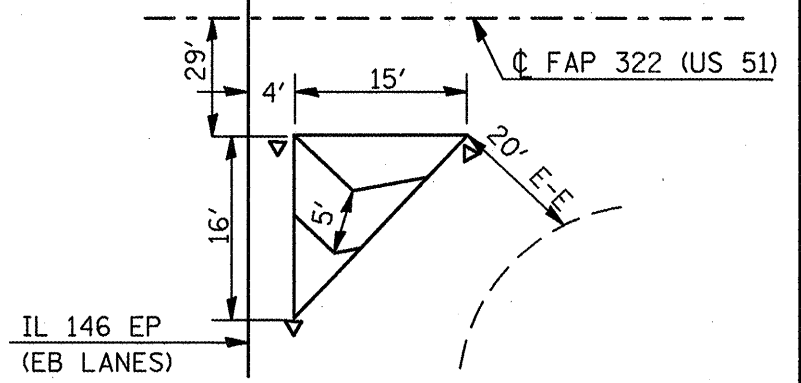

PLOT DATE = 1/24/2008
 FILE NAME = c:\pwork\78q17\78q17.dwg
 PLOT SCALE = 8.07891 / IN
 USER NAME = mcorbett

F.A. RTE.	SECTION	COUNTY	TOTAL SHEETS	SHEET NO.
2	22	22	18	
STA. _____		TO STA. _____		
FED. ROAD DIST. NO. _____		ILLINOIS FED. AID PROJECT		

PAVEMENT MARKING DETAIL
 FAP 322 (US 51) LOCATION 1
 STA. 1010+44 TO STA. 1022+39

- FAS 1909 & FAP 322
- D9 PAVEMENT PRESERVATION FY08
- JACKSON AND UNION COUNTIES

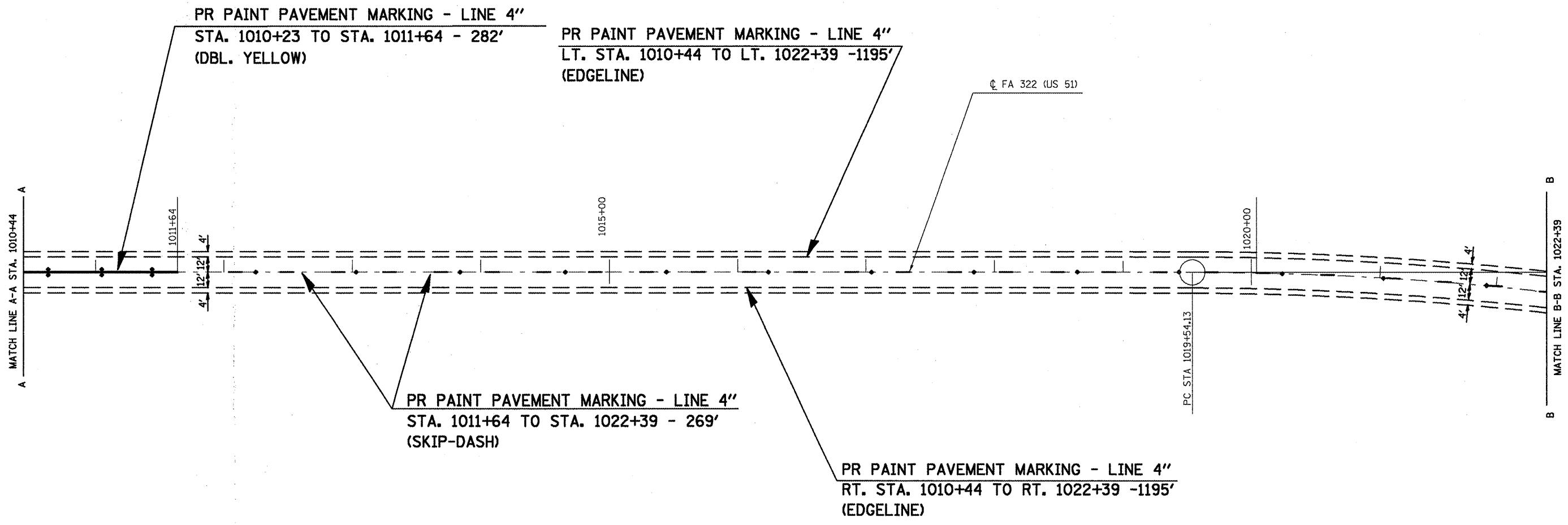

NOTE:
 FOR RAISED REFLECTIVE PAVEMENT MARKERS,
 SEE SCHEDULE ON SHEET 14.

PLLOT DATE = 1/24/2008
 FILE NAME = c:\pvc\pava\1801z\1801z\1801z.dgn
 PLOT SCALE = 84.7853 / IN
 USER NAME = mcorbett

F.A.I. RTE.	SECTION	COUNTY	TOTAL SHEETS	SHEET NO.
*	**	***	22	19
STA. _____		TO STA. _____		
FED. ROAD DIST. NO. _____		ILLINOIS FED. AID PROJECT		

- FAS 1909 & FAP 322
- D9 PAVEMENT PRESERVATION FY08
- JACKSON AND UNION COUNTIES

PAVEMENT MARKING DETAIL
 FAP 322 (US 51) LOCATION 1
 STA. 1022+39 TO STA. 1036+00

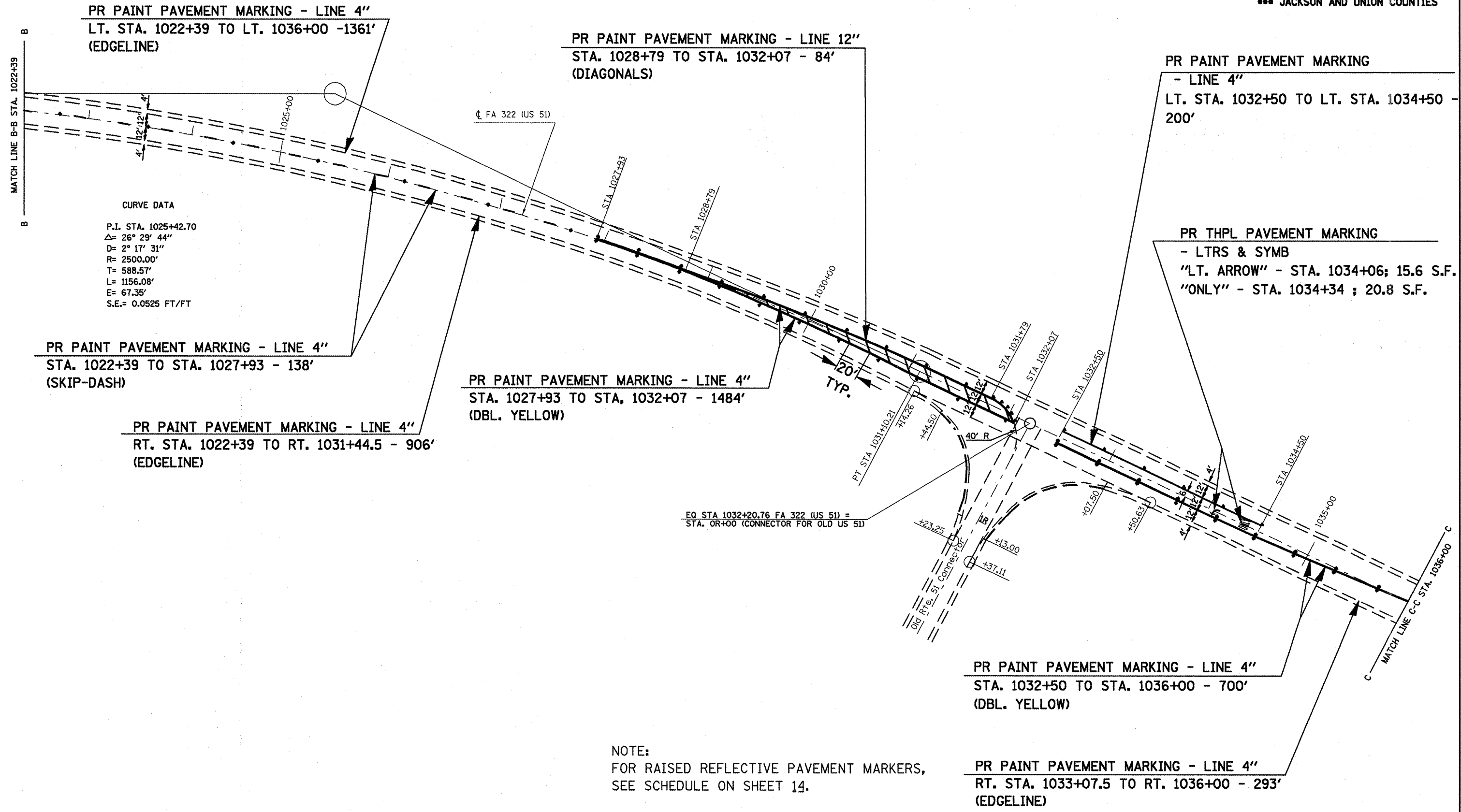

NOTE:
 FOR RAISED REFLECTIVE PAVEMENT MARKERS,
 SEE SCHEDULE ON SHEET 14.

PLOT DATE = 1/24/2008
 FILE NAME = c:\projects\7bq17\19\19.dwg
 USER NAME = mrcardr

F.A.I. RTE.	SECTION	COUNTY	TOTAL SHEETS	SHEET NO.
*	**	***	22	20
STA. _____ TO STA. _____				
FED. ROAD DIST. NO. _____ ILLINOIS FED. AID PROJECT				

- FAS 1909 & FAP 322
- D9 PAVEMENT PRESERVATION FY08
- JACKSON AND UNION COUNTIES

PAVEMENT MARKING DETAIL
 FAP 322 (US 51) LOCATION 1
 STA. 1036+00 TO STA. 1047+55.55

PR PAINT PAVEMENT MARKING - LINE 4"
 STA. 1036+00 TO STA. 1038+20 - 440'
 (DBL. YELLOW)

PR PAINT PAVEMENT MARKING - LINE 4"
 LT. STA. 1036+00 TO LT. STA. 1038+00 - 200'
 (EDGE LINE)

PR THPL PAVEMENT MARKING
 - LTRS & SYMB
 "ONLY" - STA. 1037+30 ; 20.8 S.F.
 "LT. ARROW" - STA. 1037+58; 15.6 S.F.

CURVE DATA
 P.I. STA. 1043+13.91
 $\Delta = 20^{\circ} 27' 49''$
 $D = 2^{\circ} 17' 31''$
 $R = 2500.00'$
 $T = 451.26'$
 $L = 892.90'$
 $E = 40.40'$
 $S.E. = 0.0525 \text{ FT/FT}$

PR PAINT PAVEMENT MARKING
 - LINE 4"
 LT. STA. 1038+93 TO LT. STA. 1039+93 - 100'

PR PAINT PAVEMENT MARKING - LINE 4"
 LT. STA. 1039+12 TO LT. STA. 1047+55.55 - 844'
 (EDGE LINE)

PR PAINT PAVEMENT MARKING - LINE 4"
 STA. 1038+93 TO STA. 1047+55.55 - 2418'
 (DBL. YELLOW MEDIAN)

PR PAINT PAVEMENT MARKING - LINE 4"
 RT. STA. 1037+20 TO RT. STA. 1038+20 - 100'

PR PAINT PAVEMENT MARKING - LINE 4"
 RT. STA. 1036+00 TO RT. STA. 1037+95 - 195'
 (EDGE LINE)

PR THPL PAVEMENT MARKING
 - LTRS & SYMB
 "LT. ARROW" - STA. 1039+47; 15.6 S.F.
 "ONLY" - STA. 1039+75 ; 20.8 S.F.

PR PAINT PAVEMENT MARKING - LINE 12"
 STA. 1039+93 TO STA. 1044+78 - 128'
 (DIAGONALS)

PR PAINT PAVEMENT MARKING - LINE 4"
 RT. STA. 1039+14 TO RT. STA. 1047+55.55 - 842'
 (EDGE LINE)

NOTES:
 FOR RAISED REFLECTIVE PAVEMENT MARKERS,
 SEE SCHEDULE ON SHEET 14.
 FOR PAVEMENT MARKING BEYOND
 STATION 52+01.25,
 SEE SCHEDULE ON SHT. 12.

PLOT DATE = 1/24/2008
 FILE NAME = s:\projects\1047+55.55\1047+55.55.dgn
 PLOT SCALE = 84.7893 / IN.
 USER NAME = msoondc

F.A.I. RTE.	SECTION	COUNTY	TOTAL SHEETS	SHEET NO.
*	**	***	22	21

STA. _____ TO STA. _____
 FED. ROAD DIST. NO. _____ ILLINOIS FED. AID PROJECT

- FAS 1909 & FAP 322
- D9 PAVEMENT PRESERVATION FY08
- JACKSON AND UNION COUNTIES

PAVEMENT MARKING DETAIL
 FAP 322 (US 51) AT LOCATION 2
 STA. 365+98 TO STA. 378+65

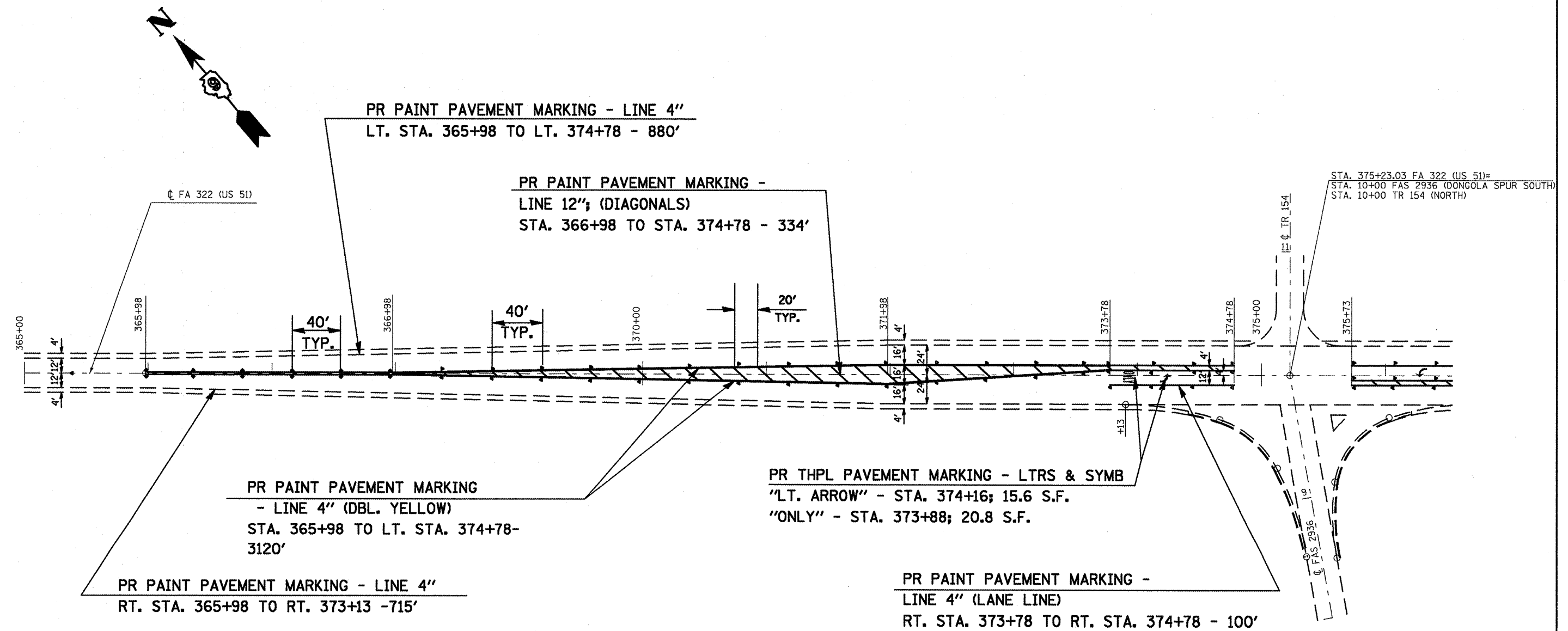

PR PAINT PAVEMENT MARKING - LINE 4"
 LT. STA. 365+98 TO LT. 374+78 - 880'

PR PAINT PAVEMENT MARKING -
 LINE 12"; (DIAGONALS)
 STA. 366+98 TO STA. 374+78 - 334'

PR PAINT PAVEMENT MARKING
 - LINE 4" (DBL. YELLOW)
 STA. 365+98 TO LT. STA. 374+78-
 3120'

PR PAINT PAVEMENT MARKING - LINE 4"
 RT. STA. 365+98 TO RT. 373+13 -715'

PR THPL PAVEMENT MARKING - LTRS & SYMB
 "LT. ARROW" - STA. 374+16; 15.6 S.F.
 "ONLY" - STA. 373+88; 20.8 S.F.

PR PAINT PAVEMENT MARKING -
 LINE 4" (LANE LINE)
 RT. STA. 373+78 TO RT. STA. 374+78 - 100'

NOTES:
 FOR RAISED REFLECTIVE PAVEMENT MARKERS,
 SEE SCHEDULE ON SHEET 14.
 FOR PAVEMENT MARKING BEFORE STATION 365+98,
 SEE SCHEDULE ON SHT. 12.

PLOT DATE = 1/24/2008
 FILE NAME = c:\pav\pav\18017\mroad.dgn
 USER NAME = mroad.dgn

F.A.I. RTE.	SECTION	COUNTY	TOTAL SHEETS	SHEET NO.
•	••	•••	22	22
STA. _____		TO STA. _____		
FED. ROAD DIST. NO. - ILLINOIS FED. AID PROJECT				

- FAS 1909 & FAP 322
- D9 PAVEMENT PRESERVATION FY08
- JACKSON AND UNION COUNTIES

PAVEMENT MARKING DETAIL
 FAP 322 (US 51) AT LOCATION 2
 STA. 365+98 TO STA. 378+65

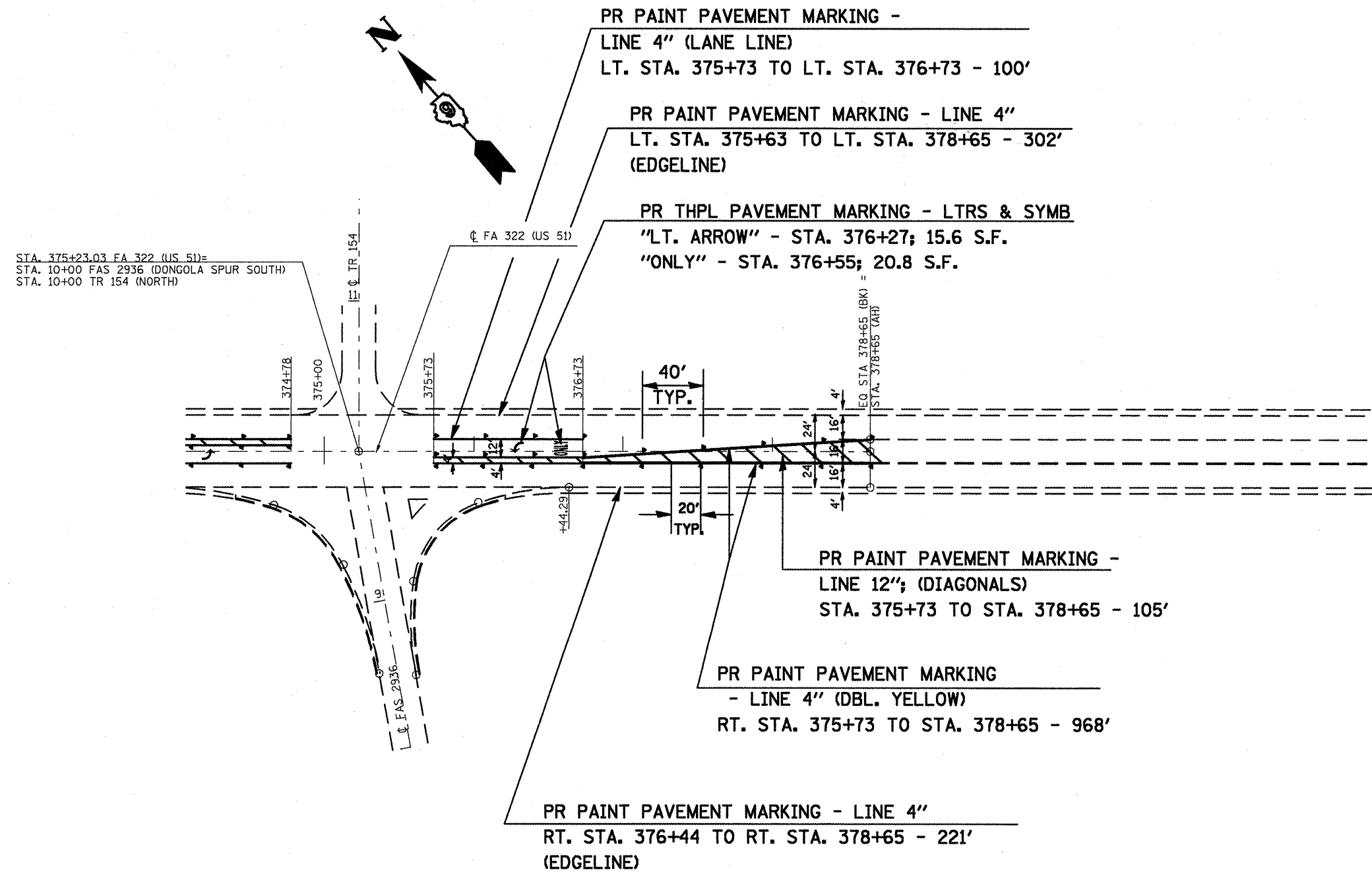

NOTE:
 FOR RAISED REFLECTIVE PAVEMENT MARKERS,
 SEE SCHEDULE ON SHEET 14.

PLOT DATE = 1/24/2008
 FILE NAME = c:\p\1000\1000\1000.dgn
 PLOT SCALE = 84.765 / IN.
 USER NAME = mcorcoran