

F.A.P. RTE.	SECTION	COUNTY	TOTAL SHEETS	SHEET NO.
326	(111CS) W&S-21	GRUNDY	85	51
STA. 26+00		TO STA. 52+00		
FED. ROAD DIST. NO. ILLINOIS FED. AID PROJECT				
CONTRACT NUMBER: 66720				

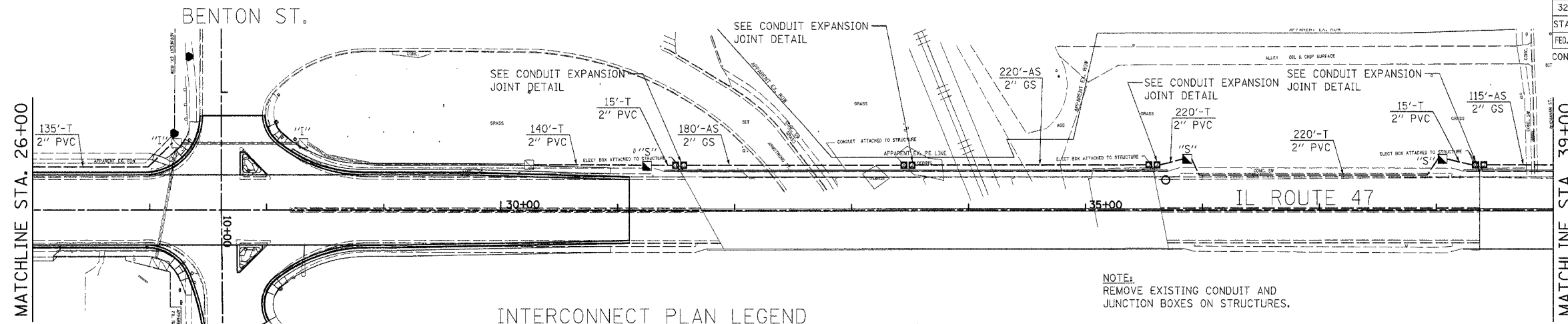

**INTERCONNECT PLAN LEGEND**

		CONTROLLER
		HANDHOLE
		DOUBLE HANDHOLE
CONDUIT: "T" TRENCHED, "P" PUSHED, "AS" ATTACHED TO STRUCTURE		
"S"		"S" SYSTEM
"I"		"I" INTERSECTION

NOTE:  
REMOVE EXISTING CONDUIT AND  
JUNCTION BOXES ON STRUCTURES.

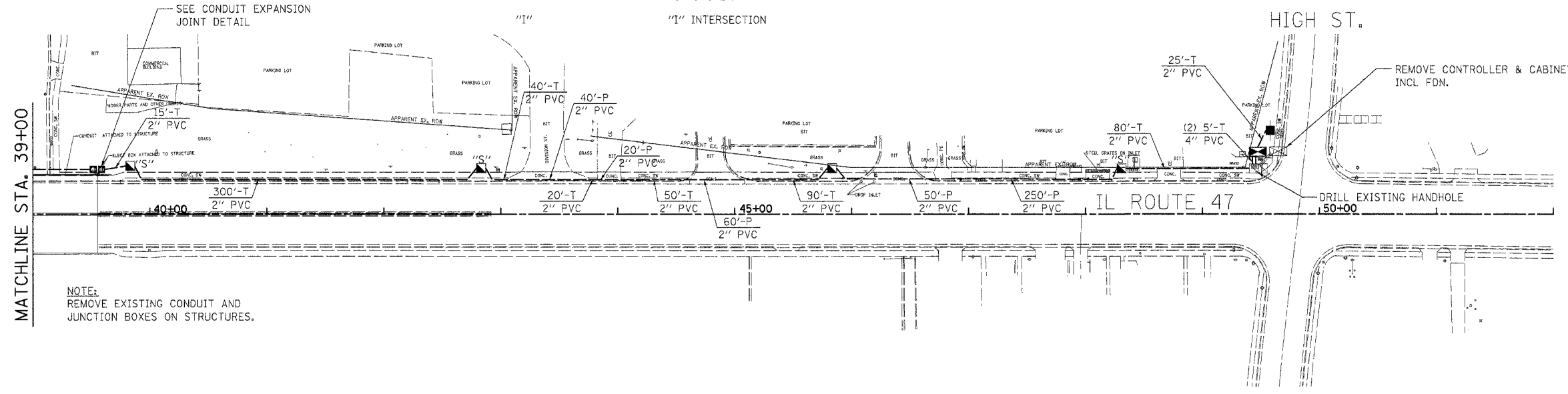

NOTE:  
REMOVE EXISTING CONDUIT AND  
JUNCTION BOXES ON STRUCTURES.

24 IN. X 24 IN. X 10 IN. JUNCTION BOX, STAINLESS STEEL, ATTACHED TO OUTSIDE FACE OF PARAPET WALL (2 PER JOINT)

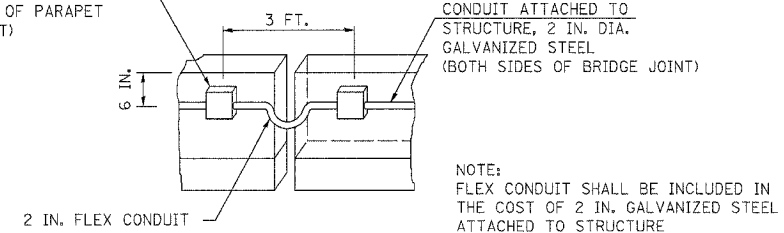

**CONDUIT EXPANSION JOINT DETAIL**  
NOT TO SCALE

NOTE:  
CONDUIT SHALL BE ATTACHED TO STRUCTURE IN ACCORDANCE WITH SECTION 8.11.03(B) OF THE STANDARD SPECIFICATIONS

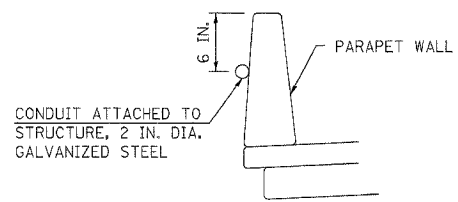

**CONDUIT ATTACHMENT TO STRUCTURE DETAIL**  
NOT TO SCALE

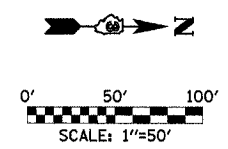

REVISIONS	
NAME	DATE

ILLINOIS DEPARTMENT OF TRANSPORTATION

**INTERCONNECT PLAN**  
IL. RTE. 47 (DIVISION ST.)  
SHEET 2 OF 3

SCALE: 1"=50'  
DATE: JANUARY 2008

DRAWN BY: JVR  
CHECKED BY: FML

**INTERCONNECT PLANS - IL ROUTE 47**