

F.A.P. RTE.	SECTION	COUNTY	TOTAL SHEETS	SHEET NO.
326 (111CS) W&S-21		GRUNDY	85	42
STA. 18+00		TO STA. 24+10		
FED. ROAD DIST. NO. 1		ILLINOIS FED. AID PROJECT		
CONTRACT NUMBER: 66720				

TRAFFIC SIGNAL LEGEND

- HANDHOLE
- DOUBLE HANDHOLE
- CONTROLLER AND CABINET
- SIGNAL HEAD WITH BACKPLATE
- POWER SERVICE INSTALLATION
- PEDESTRIAN SIGNAL HEAD
- PEDESTRIAN PUSH BUTTON
- SIGNAL POST
- STEEL COMBINATION MAST ARM ASSEMBLY AND POLE WITH LUMINAIRE, SODIUM VAPOR, 250 WATT
- CONDUIT: "T" TRENCH, "P" PUSHED
- DETECTOR LOOP
- LIGHT DETECTOR
- CONFIRMATION BEACON

SCHEDULE OF SIGNAL HEAD QUANTITIES

LOCATION	ITEM	UNIT	QUANTITY
1,2,6,7,9,10,14,15	SH, 1F, 3S, MAM	EACH	8
4,8,12,16	SH, 1F, 3S, BM	EACH	4
5,13	SH, 1F, 5S, MAM	EACH	2
3,11	SH, 1F, 5S, BM	EACH	2

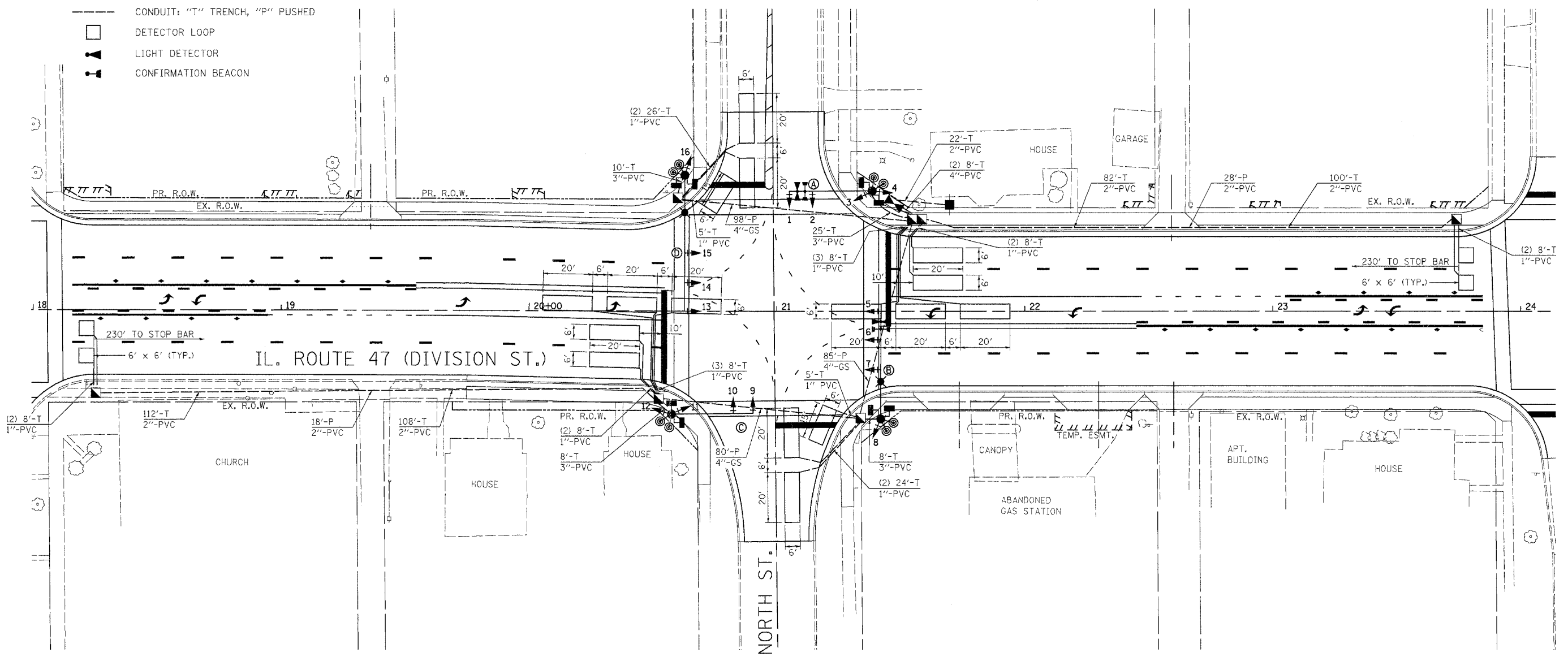

SCHEDULE OF POLE/MAST ARM ASSEMBLIES

LOCATION	LENGTH
A	34' S. M.A.A. & POLE
B	44' S. COMB. M.A.A. & POLE
C	32' S. M.A.A. & POLE
D	55' S. COMB. M.A.A. & POLE

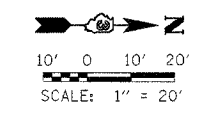

REVISIONS	
NAME	DATE

ILLINOIS DEPARTMENT OF TRANSPORTATION
PROPOSED TRAFFIC SIGNAL MODERNIZATION
 IL. 47 (DIVISION ST.) / NORTH ST.
 SCALE: 1"=20'
 DATE: JANUARY 2008
 DRAWN BY: JVR
 CHECKED BY: FML

C:\p11\plans\North_Plan.dgn 3/17/2008 5:03:40 PM