

RTE	SECTION	COUNTY	TOTAL SHEETS	SHEET NO.
338	114R-1	WILL	355	113
STA. 467+25 TO STA. 479+00				
STA. 3051+00 TO STA. 3337+00				
FED. ROAD DIST. NO. 7 ILLINOIS FED. AID PROJECT				

PLAN	SURVEYED	DATE
	PLOTTED	
	CHECKED	
	BY	
	NO. OF PAID CHECKS	
	NO.	

PROFILE	SURVEYED	DATE
	PLOTTED	
	CHECKED	
	BY	
	NO. OF PAID CHECKS	
	NO.	

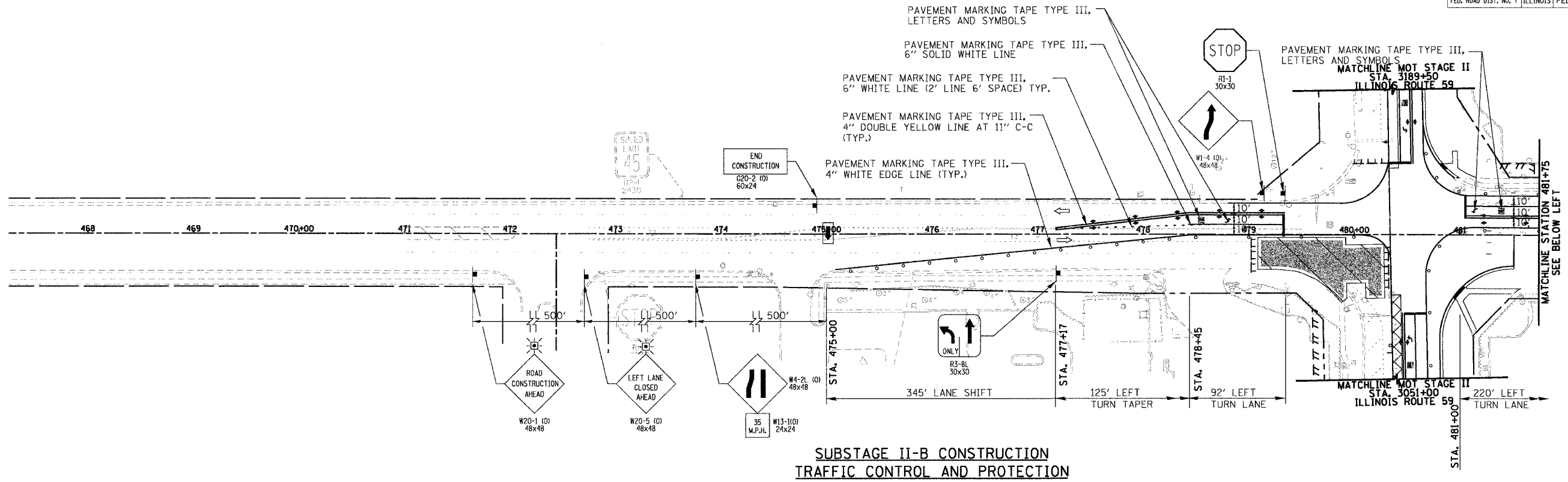

**SUBSTAGE II-B CONSTRUCTION  
TRAFFIC CONTROL AND PROTECTION**

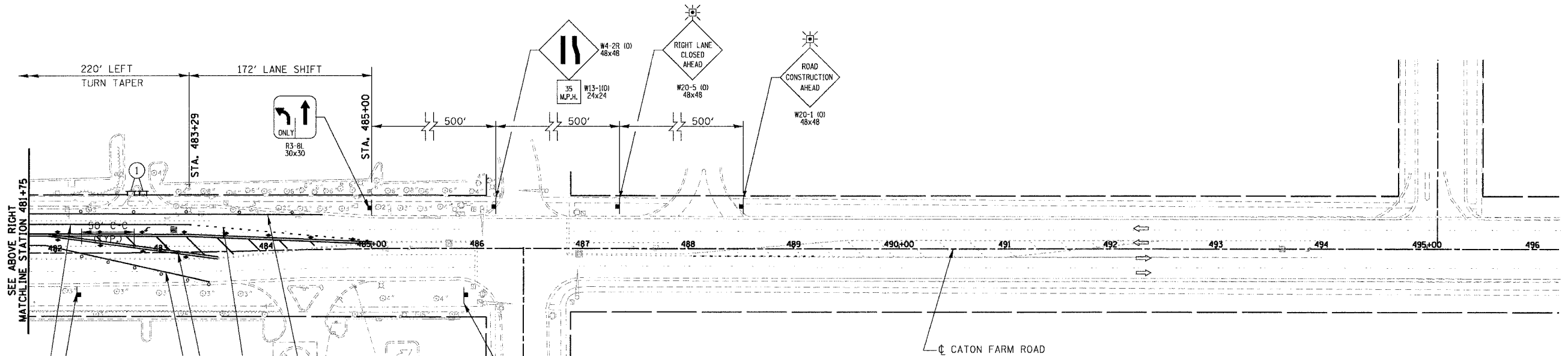

**SUBSTAGE II-B CONSTRUCTION  
TRAFFIC CONTROL AND PROTECTION**

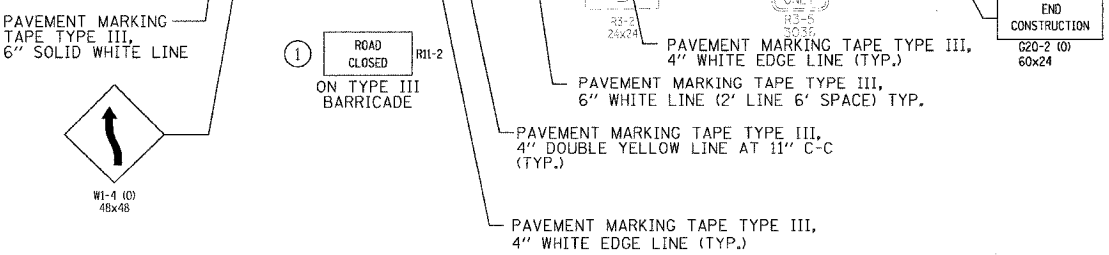

FOR LEGEND  
SEE SHEET NO. 81

REVISIONS	
NAME	DATE

ILLINOIS DEPARTMENT OF TRANSPORTATION  
**SUGGESTED CONSTRUCTION PROCEDURE  
AND MAINTENANCE OF TRAFFIC STAGE II**  
CATON FARM ROAD SUBSTAGE II-B

50 0 50  
SCALE IN FEET

DATE 3/18/08  
DRAWN BY: NM, RM  
CHECKED BY: AS