

RTE	SECTION	COUNTY	TOTAL SHEETS	SHEET NO.
338	114R-1	WILL	355	110

STA. 88+00 TO STA. 112+00 (THEODORE ST.)
 STA. 3134+00 TO STA. 3136+50 (IL-59)
 FED. ROAD DIST. NO. 7 ILLINOIS FED. AID PROJECT

PLAN	DATE
SURVEYED	BY
CLOSED	BY
NOTED	BY
STRUCTURE	NOTATIONS
NO.	FILE NAME

PROFILE	DATE
SURVEYED	BY
CLOSED	BY
NOTED	BY
STRUCTURE	NOTATIONS
NO.	FILE NAME

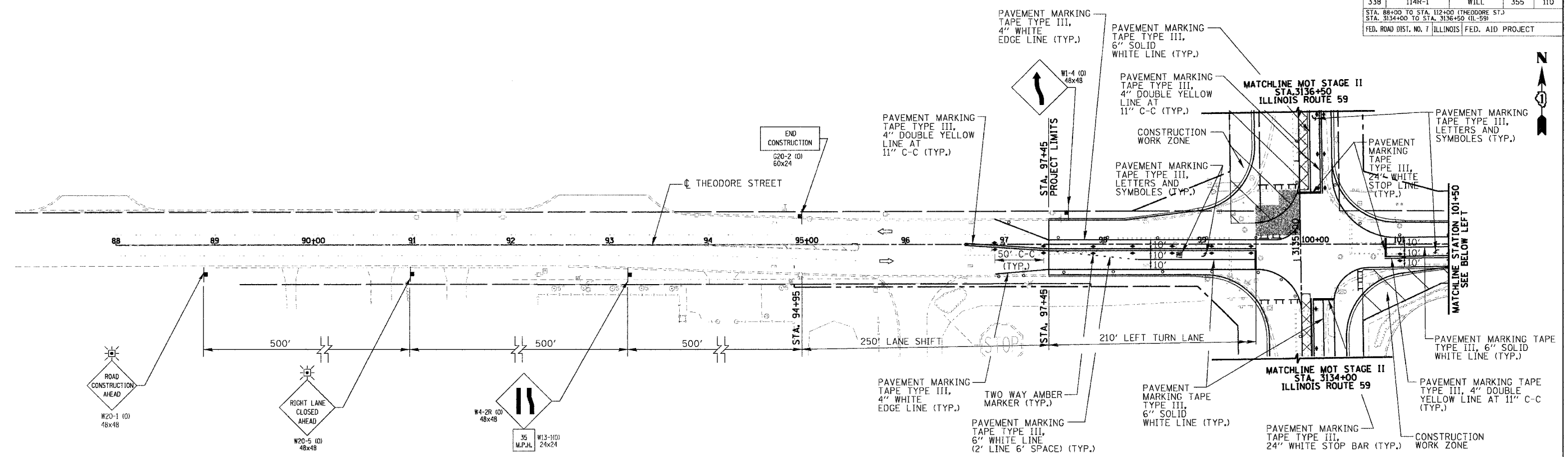

**STAGE II-B CONSTRUCTION
TRAFFIC CONTROL AND PROTECTION**

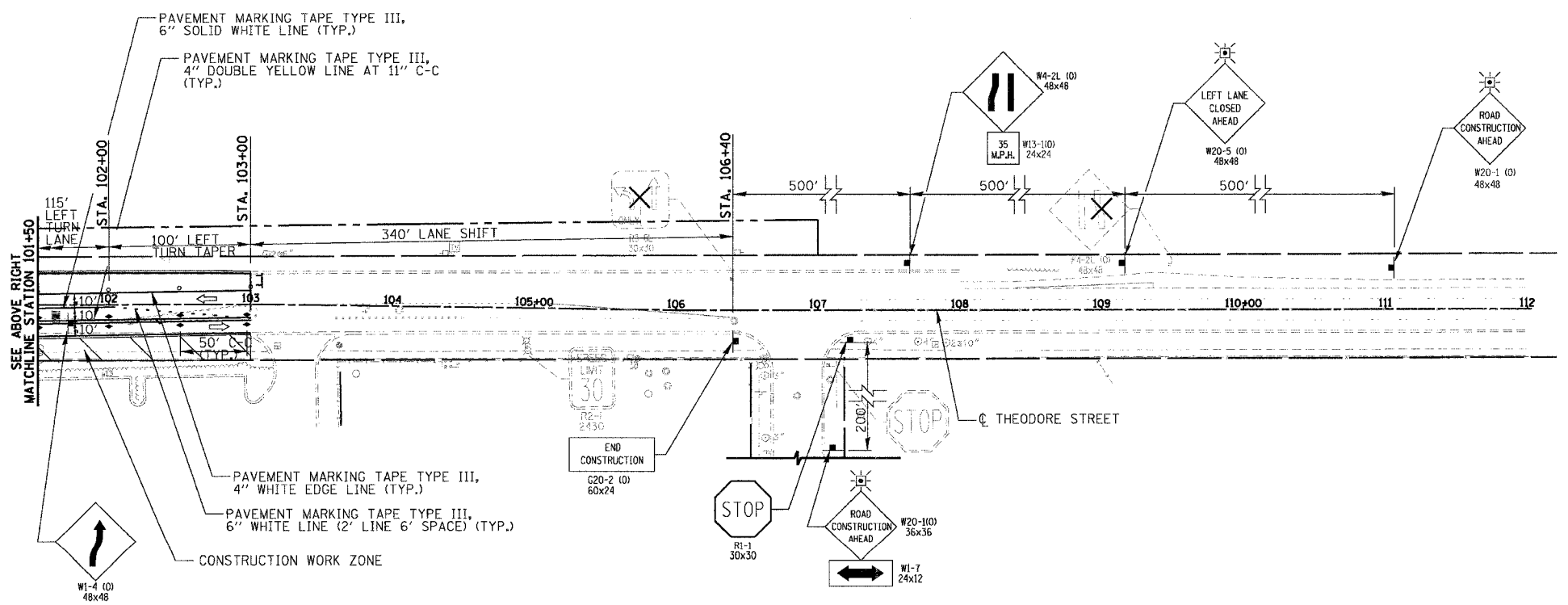

**STAGE II-B CONSTRUCTION
TRAFFIC CONTROL AND PROTECTION**

FOR LEGEND
SEE SHEET NO. 81

REVISIONS		ILLINOIS DEPARTMENT OF TRANSPORTATION SUGGESTED CONSTRUCTION PROCEDURE AND MAINTENANCE OF TRAFFIC STAGE II	
NAME	DATE	THEODORE STREET SUBSTAGE II-B	

DATE: 3/18/08
 DRAWN BY: NM, RM
 CHECKED BY: AS

SCALE IN FEET: 0, 50, 50